



Key Features

- Portable and flexible manual cutting machine
- For straight, curve, and circle cuts, as well as for strip cutting
- For bevel cutting - (one torch) and multi bevel cutting - (two torches)
- Digital controlled speed – adjustable 0–60 in/min
- For all fuel gases
- Machine Torches & nozzles sold separately

Scorpion Track Torch System

Part No. FT-STT

Base System Includes:

	Part No.	Item
Standalone Torch Machine	77795001	1
Power Cord, 110V US	77795002	2
Arm, 21 Inch	77795003	3
Precise Machine Torch Holder, 1-3/8" (35mm)	77795006	4
Counterweight 2.8 lb	77795004	5

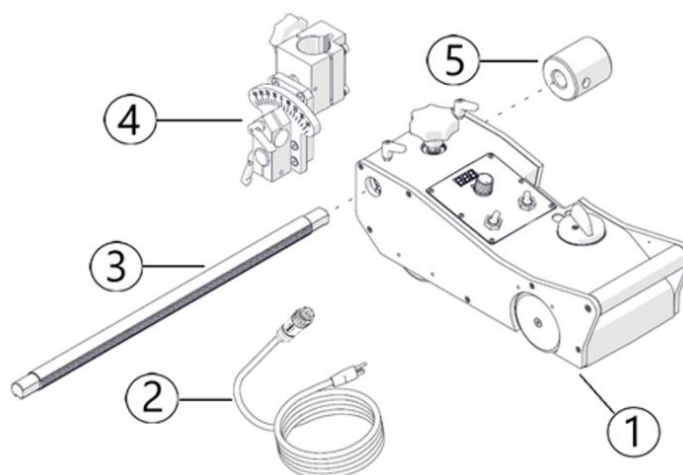

[FT-STT Manual Link](#)

FLAME TECH® Heavy Duty Scorpion Track Torch System

Key Features

- Holds Torches up to 2-inch diameter
- Heavier counterweight
- Longer 40-inch Arm

Heavy Duty Scorpion Track Torch System

Part No. FT-STT-HD

Base System Includes:

	Part No.	Item
Standalone Torch Machine	77795001	1
Power Cord, 110V US	77795002	2
Arm, 40 Inch	77795009	3
Torch Clamp Block	77795016	4
Counterweight 5.7 lb	77795010	5
Guide Arm Assembly for Hoses	77795007	6
HD Universal Mount	77795020	7
Bottom Heat Shield	77795015	8

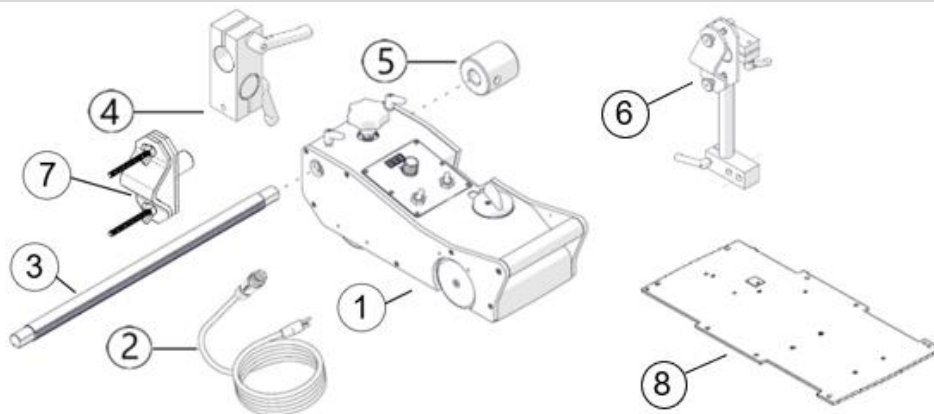

SEPARATELY SOLD ACCESSORIES

1. V-Groove Track Section, 70"

Track assemblies can interconnect to form various lengths
Part Number: 77795008

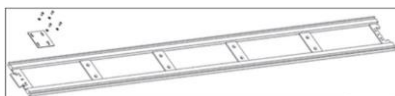

2. Manifold, 2 in x 3 out, CGA B

Input and output for hoses with on/off valve.
Part Number: 77795013

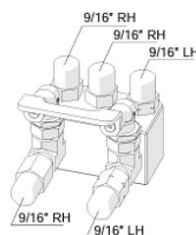

3. Oxygen and Fuel Hoses with Strain Guard, 4'

Connects to the torch and the manifold
Part Numbers:

71838041 (Oxy, Green)
71838042 (Fuel, Red)

