

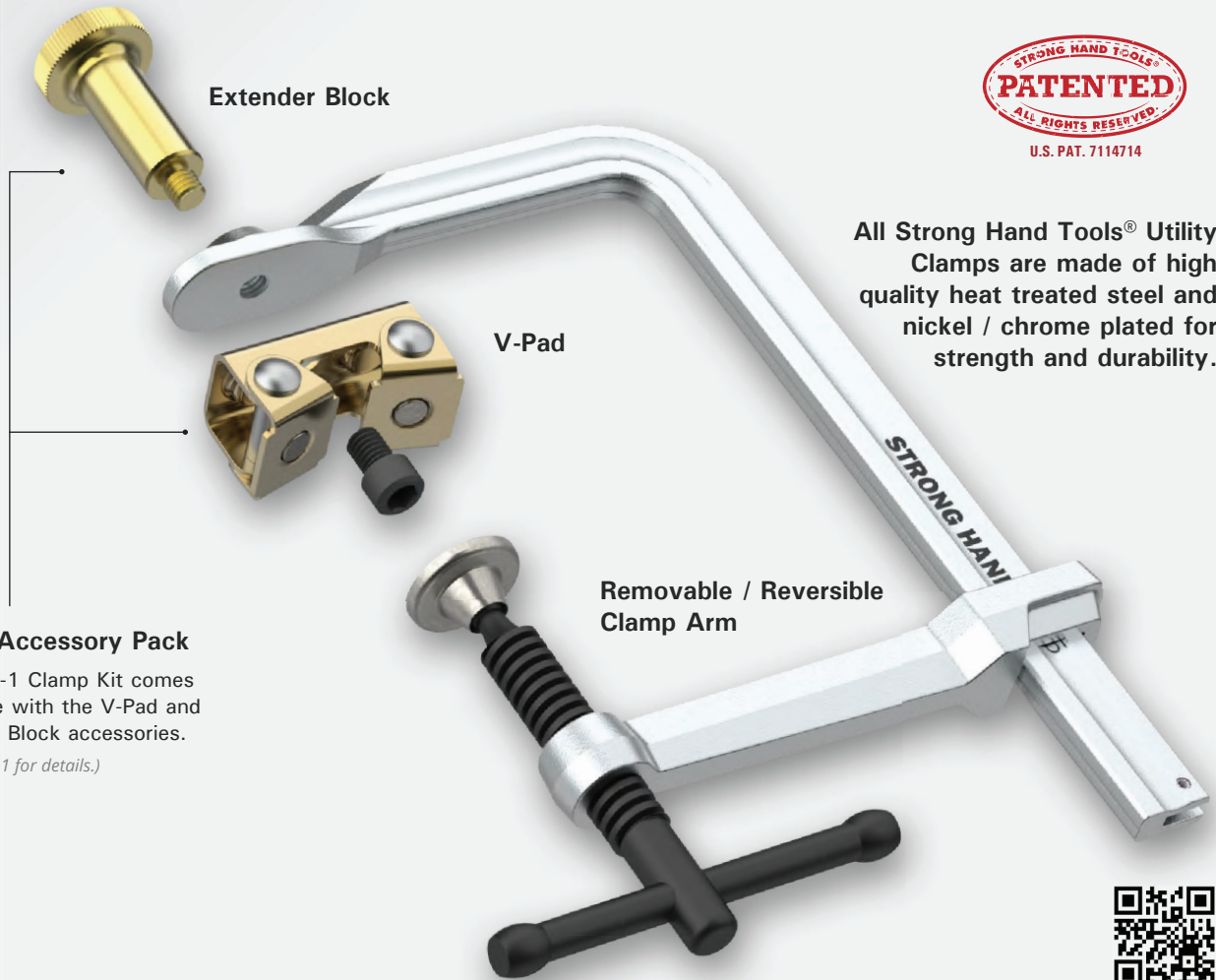

# 4-IN-1™ Utility Clamping System

The most versatile Sliding Arm Clamps in the market.



All Strong Hand Tools® Utility Clamps are made of high quality heat treated steel and nickel / chrome plated for strength and durability.

**4-in-1 Accessory Pack**  
The 4-IN-1 Clamp Kit comes complete with the V-Pad and Extender Block accessories.  
*(See page 11 for details.)*



## 4 functions in 1 Clamp

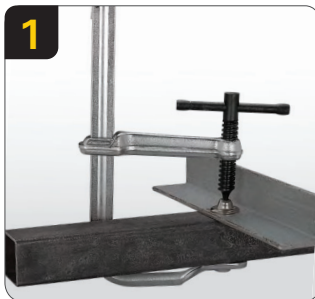

**1 Standard**  
Sliding Arm Clamps are 10x faster than a C-Clamp!



**2 Pipe**  
Add the exclusive V-Pad to create a Pipe Clamp!

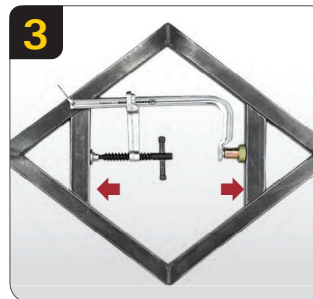

**3 Spreader**  
Reverse the clamp arm and create a Spreader Clamp.



**4 Step-Over**  
Add the Extender Block to create a Step-Over Clamp.

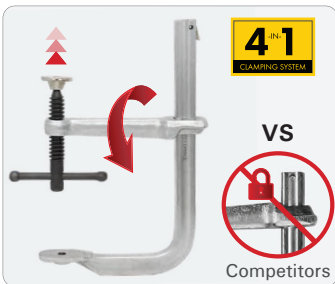
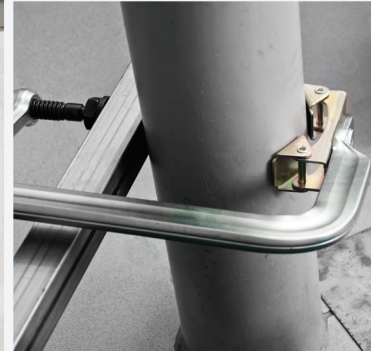

Clamp Arm  
**- Removable**  
**- Reversible**

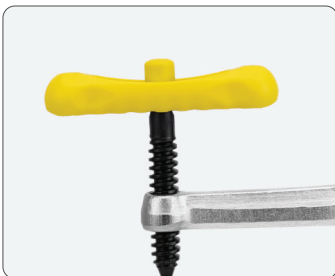

**Ergonomic Comfort Handle**  
included with G/M Rail clamps.

UG Models: Plastic Handle + Cap  
UM Models: Plastic handle ONLY



**UD Models:**  
Remove the Key Ring.



**UE, UF, UG, UM Models:**  
**Quickest Removal:** Press the Spring Stop to slide the clamp arm ON & OFF



**UP Models:**  
Removable Fasteners



Standard Pad



*Self-aligning*  
Replaceable Heavy  
Duty Pad



**Tapped Hole - (D)**  
For attaching accessories  
such as the V-Pad or  
Extender Block.

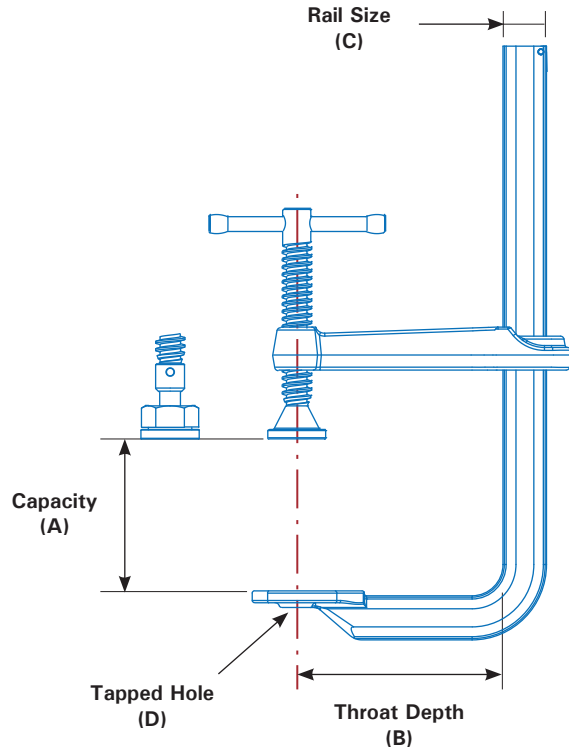

**4-IN-1™ UTILITY CLAMPING SYSTEM**

Part No.	Capacity - A (in)	Throat Depth - B (in)	Clamping Pressure (lb)	Pads	Rail Size - C (in)	Tapped Hole - D	Weight (lb)
UD45-C3	4-1/2	3-1/4	500	Standard	5/8 x 5/16	5/16-18	1.3
UD65-C3	6-1/2	3-1/4	500	Standard	5/8 x 5/16	5/16-18	1.6
UF65-C3	6-1/2	4-3/4	1,000	Standard	7/8 x 7/16	3/8-16	2.9
UG85-C3	8-1/2	4-3/4	1,200	Standard	1 x 15/32	3/8-16	4.1
UG125-C3	12-1/2	4-3/4	1,200	Standard	1 x 15/32	3/8-16	4.5
UG1257-C3	12-1/2	<sup>7</sup> <i>*Deep Throat</i>	800	Standard	1 x 15/32	3/8-16	6.5
UM85P-C3	8-1/2	5-1/2	2,400	Standard	1-3/16 x 9/16	3/8-16	6.6
UM105P-C3	10-1/2	5-1/2	2,400	Standard	1-3/16 x 9/16	3/8-16	7.4
UM125-C3 <i>*BEST SELLER</i>	12-1/2	5-1/2	2,400	Heavy Duty	1-3/16 x 9/16	3/8-16	7.6
UM165-C3	16-1/2	5-1/2	2,400	Heavy Duty	1-3/16 x 9/16	3/8-16	8.7
UM205-C3	20-1/2	5-1/2	2,400	Heavy Duty	1-3/16 x 9/16	3/8-16	9.8
UP205-C3	20-1/2	<sup>7</sup> <i>*Deep Throat</i>	4,800	Heavy Duty	1-9/16 x 3/4	3/8-16	16.1

# Utility Clamps

Utility Clamps set-up 10x faster than a C-Clamp!



## LIGHT & MEDIUM DUTY

Clamping Pressure: 500 - 1,200 lb

Standard Pads



UD Series with Key Ring Stop



UE, UF, UG Series with Spring Stop

Part No.	Capacity - A (in)	Throat Depth - B (in)	Clamping Pressure (lb)	Rail Size - C (in)	Tapped Hole - D	Weight (lb)
UD45	4-1/2	3-1/4	500	5/8 x 5/16	5/16-18	1.0
UD65	6-1/2	3-1/4	500	5/8 x 5/16	5/16-18	1.1
UD85	8-1/2	3-1/4	500	5/8 x 5/16	5/16-18	1.2
UE85	8-1/2	4	850	25/32 x 3/8	3/8-16	2.3
UE125	12-1/2	4	850	25/32 x 3/8	3/8-16	2.5
UF65	6-1/2	4-3/4	1,000	7/8 x 7/16	3/8-16	2.4
UF100	10	4-3/4	1,000	7/8 x 7/16	3/8-16	2.8
UG85	8-1/2	4-3/4	1,200	1 x 15/32	3/8-16	3.6
UG125	12-1/2	4-3/4	1,200	1 x 15/32	3/8-16	4.0
UG205	20-1/2	4-3/4	1,200	1 x 15/32	3/8-16	4.8
UG1257	12-1/2	7 Deep Throat	800	1 x 15/32	3/8-16	5.0
UG1657	16-1/2	7 Deep Throat	800	1 x 15/32	3/8-16	5.3

## REGULAR DUTY

Clamping Pressure: 2,400 lb

Standard Pads



Clamping Pressure: 2,400 lb



\* Heavy Duty Replaceable Pads

Part No.	Capacity - A (in)	Throat Depth - B (in)	Clamping Pressure (lb)	Rail Size - C (in)	Tapped Hole - D	Weight (lb)
UM85P	8-1/2	5-1/2	2,400	1-3/16 x 9/16	3/8-16	5.7
UM105P	10-1/2	5-1/2	2,400	1-3/16 x 9/16	3/8-16	6.3
UM125P	12-1/2	5-1/2	2,400	1-3/16 x 9/16	3/8-16	6.4

Part No.	Capacity - A (in)	Throat Depth - B (in)	Clamping Pressure (lb)	Rail Size - C (in)	Tapped Hole - D	Weight (lb)
UM65	6-1/2	5-1/2	2,400	1-3/16 x 9/16	3/8-16	5.4
UM85	8-1/2	5-1/2	2,400	1-3/16 x 9/16	3/8-16	5.9
UM105	10-1/2	5-1/2	2,400	1-3/16 x 9/16	3/8-16	6.4
UM125	12-1/2	5-1/2	2,400	1-3/16 x 9/16	3/8-16	7.0
UM165	16-1/2	5-1/2	2,400	1-3/16 x 9/16	3/8-16	7.6
UM205	20-1/2	5-1/2	2,400	1-3/16 x 9/16	3/8-16	8.7

# Utility Clamps

Utility Clamps set-up 10x faster than a C-Clamp!

## HEAVY DUTY

Clamping Pressure: 4,800 lb



\* Heavy Duty Replaceable Pads

Part No.	Capacity - A (in)	Throat Depth - B (in)	Clamping Pressure (lb)	Rail Size - C (in)	Tapped Hole - D	Weight (lb)
UP125	12-1/2	7	4,800	1-9/16 x 3/4	3/8-16	12.3
UP165	16-1/2	7	4,800	1-9/16 x 3/4	3/8-16	13.6
UP205	20-1/2	7	4,800	1-9/16 x 3/4	3/8-16	15.0
UP245	24-1/2	7	4,800	1-9/16 x 3/4	3/8-16	16.5
UP405	40-1/2	7	4,800	1-9/16 x 3/4	3/8-16	22.0
UP605	60-1/2	7	4,800	1-5/8 x 3/4	3/8-16	28.0

## J-CLAMP STEP-OVER



UD, UF, UG Series



UM Series

\* Heavy Duty Replaceable Pads

Part No.	Capacity - A (in)	Throat Depth - B (in)	Clamping Pressure (lb)	Rail Size - C (in)	Tapped Hole - D	Weight (lb)
UD45J	4-1/2	3-1/4 (2)	500	5/8 x 5/16	3/8-16	1.2
UF100J	10	4-3/4 (3)	1,000	7/8 x 7/16	3/8-16	3.2
UG105J	10-1/2	4-3/4 (3)	1,200	1 x 15/32	3/8-16	5.0
UM125J	12-1/2	5-1/2 (4)	2,400	1-3/16 x 9/16	3/8-16	8.1
UM205J	20-1/2	5-1/2 (4)	2,400	1-3/16 x 9/16	3/8-16	9.2

## SLIDE-ON SIDEKICKS

Mount onto sliding arm clamps to gain side clamping abilities. Stroke and reach of clamp can be modified by changing the pad with a longer or shorter fastener.

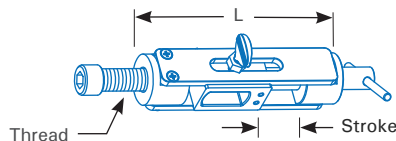

Part No.	L (in)	Stroke (in)	Thread	For Clamps	Weight (lb)
XDS	3-1/8	1	3/8-16	UD Series	0.6
XFS	4-3/8	1-3/8	1/2-13	UF Series	1.2
XGS	4-3/8	1-3/8	1/2-13	UG Series	1.2
XMS	4-3/8	1-3/8	1/2-13	UM Series	1.2