



PROJECT HIGHLIGHT

THE PICKLEBALL CLUB, PORT SAINT LUCIE, FL.

PROJECT LOCATION:
455 NW Enterprise Drive,
Port St Lucie, FL.

OWNER/SPONSOR:
The Pickleball Club

CONSTRUCTION DATE:
Jan 2023 – June 2024

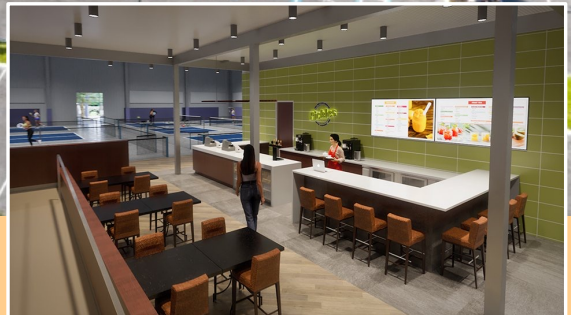

SCOPE OF WORK

- Project Manager / Owners Rep for millwork provider.
- Hired and managed the installation team.
- Worked with Millwork vendor and managed the production and installation schedule, and installation of all millwork at the club.
- Procured and managed the installation of the Quartz tops for all areas including upstairs and downstairs bar areas, bathroom vanities, condiment stations, breakroom,

Colli CG was appointed as the contract project management and installation firm to work closely with the millwork production vendor, overseeing and coordinating all aspects of the project. This included managing the production schedule, ensuring timely delivery, hiring and supervising the installation team, and ultimately ensuring the successful completion of the millwork project within the designated timeframe and budget. The exceptional outcome of the project has led the millwork supplier to extend an offer to Colli CG to take on the management, production, and installation of numerous upcoming multi-million dollar millwork projects.