

TOXIN SENSORS

TOXIN SENSORS

User's Guide

CM-2000

Carbon Monoxide
Detector

CM-2000

Carbon Monoxide
Detector

toxinsensors.com

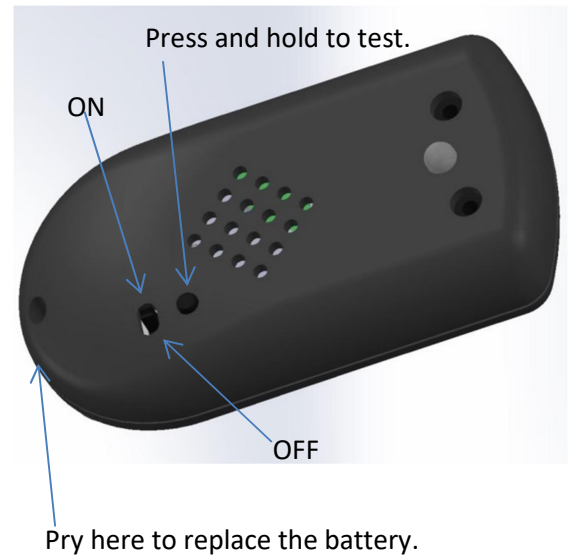

The CM-2000 can be left ON continuously and the battery will last many years. Turn OFF the CM-2000 if extreme temperatures (>50°C/122°F or <-10°C/14°F) are anticipated. Check the battery before use by: turning ON, wait 4 seconds, **press and hold** the test button (up to 4 seconds may be necessary). The alarm will not flash and sound if the battery needs replacing.

Record your date of purchase: _____. Discard the CM-2000 after 10 years.

When needed the CR2032 battery can be replaced by opening the enclosure. Gently pry it open with your thumb nail or similar object in the slot at the top (near the key ring hole, no need to remove the key ring). If using a hard object wrap it with a piece of cloth to prevent cosmetic damage to the enclosure. Push the old battery out of its holder with a small object. Insert the new battery with the + side upwards. Snap the enclosure back together.

More information about the harmful effects of carbon monoxide can be found at:

https://www.osha.gov/OshDoc/data_General_Facts/carbonmonoxide-factsheet.pdf

<https://www.epa.gov/indoor-air-quality-iaq/carbon-monoxides-impact-indoor-air-quality>

<https://www.cdc.gov/niosh/topics/co-comp/>

Alarm levels:

- 25 to 99 ppm, industry standard T4 signal for carbon monoxide. 4 fast beeps/flashes followed by a 5 second pause. Repeats until the carbon monoxide levels are below 25 ppm.
- 100 to 199 ppm, T4 plus 1 lower pitch longer beep.
- 200 to 299 ppm, T4 plus 2 lower pitch longer beeps.
- 300 to 399 ppm, T4 plus 3 lower pitch longer beeps.
- ≥400 ppm, T4 plus 4 lower pitch longer beeps.

Warning:

This device is not intended as a residential carbon monoxide detector. Residential carbon monoxide detectors in accordance with UL 2034 purposefully delay their response for hours at low carbon monoxide levels. The CM-2000 has a response time of less than 60 seconds and begins alerting at only 25ppm. Alerting faster and at lower levels allows individuals to know about their exposure and take appropriate actions sooner.

Warranty:

One year from the date of purchase to the original purchaser for defects in materials and workmanship. The product will be replaced or repaired at the discretion of Toxin Sensors. Like any electronic device the CM-2000 should never be exposed to water. This warranty does not cover damage caused by abuse. For more information contact us at toxinsensors.com.