

Drill Hole No 4

32+00 W @ 14+00 S

drilled grid North @ -45°

collar elevation 635'

elevation differences by clinometer  
 " " " " " "

15 from 165	+3°	.052	+5.2'	16	616
14 " 15	+8°	.1205	+14.1	155-	621
13 " 12	+3°	.052	+5.2	14-	635
12 - 13	0°	0	0	13-	640
11 - 12	+10°	.1763	+17.6	12	640
10 - 11	+20°	.3640	+36.4	11	658
9 - 10	+22°	.40403	+40.4	10	694
				9	734

Scale 1" = 10'

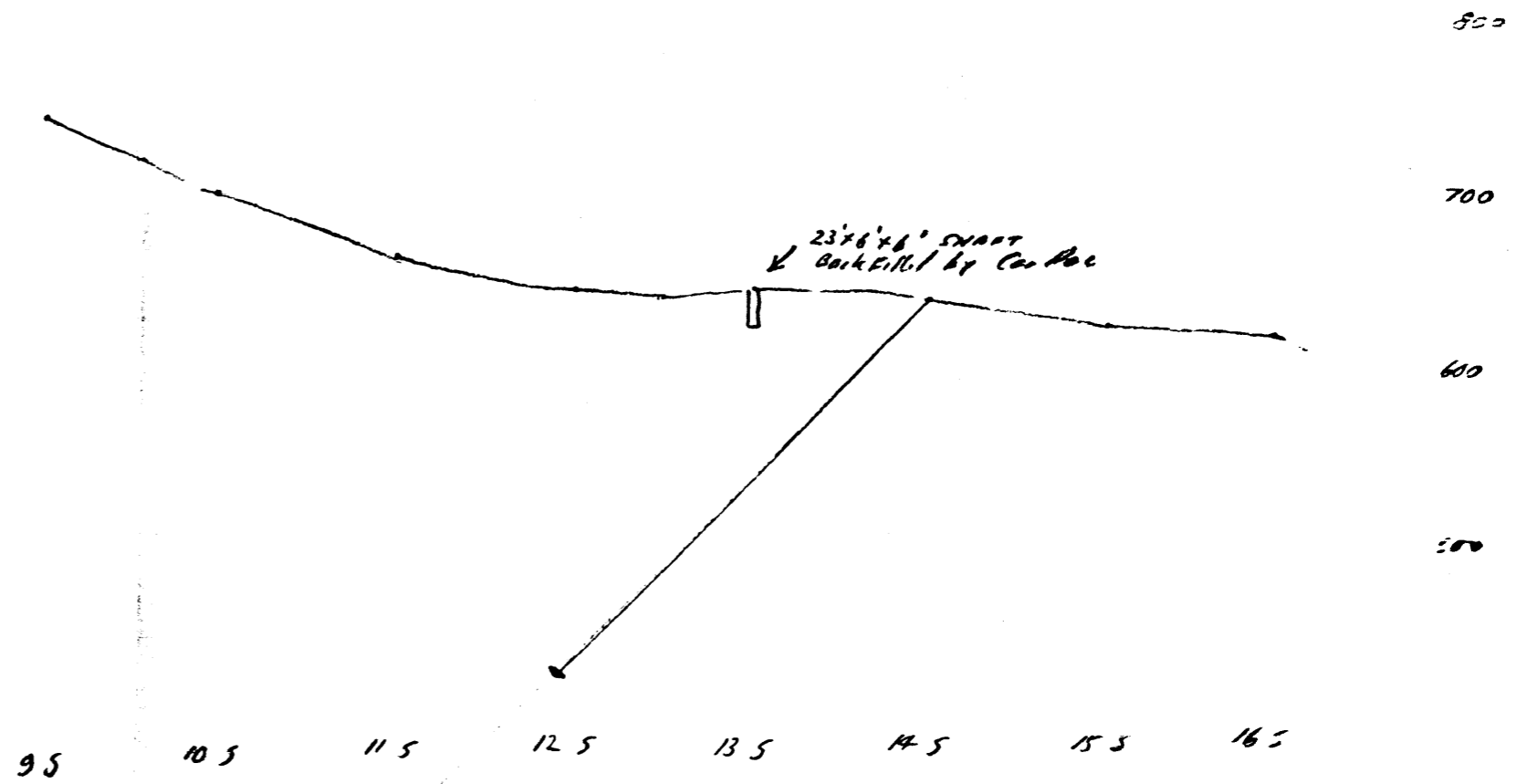
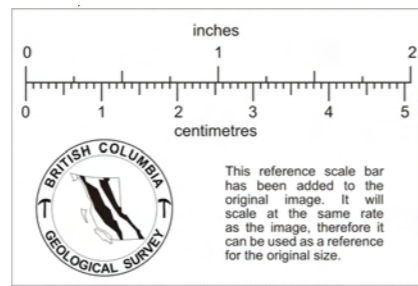

MT Richards  
Drill Hole N° 3

52W - ~~46~~ 4+605  
drilled grid North @ -45°  
collar elevation 955'

Elevation differences by clinometer  
" control " altimeter

Scale 1" = 10'

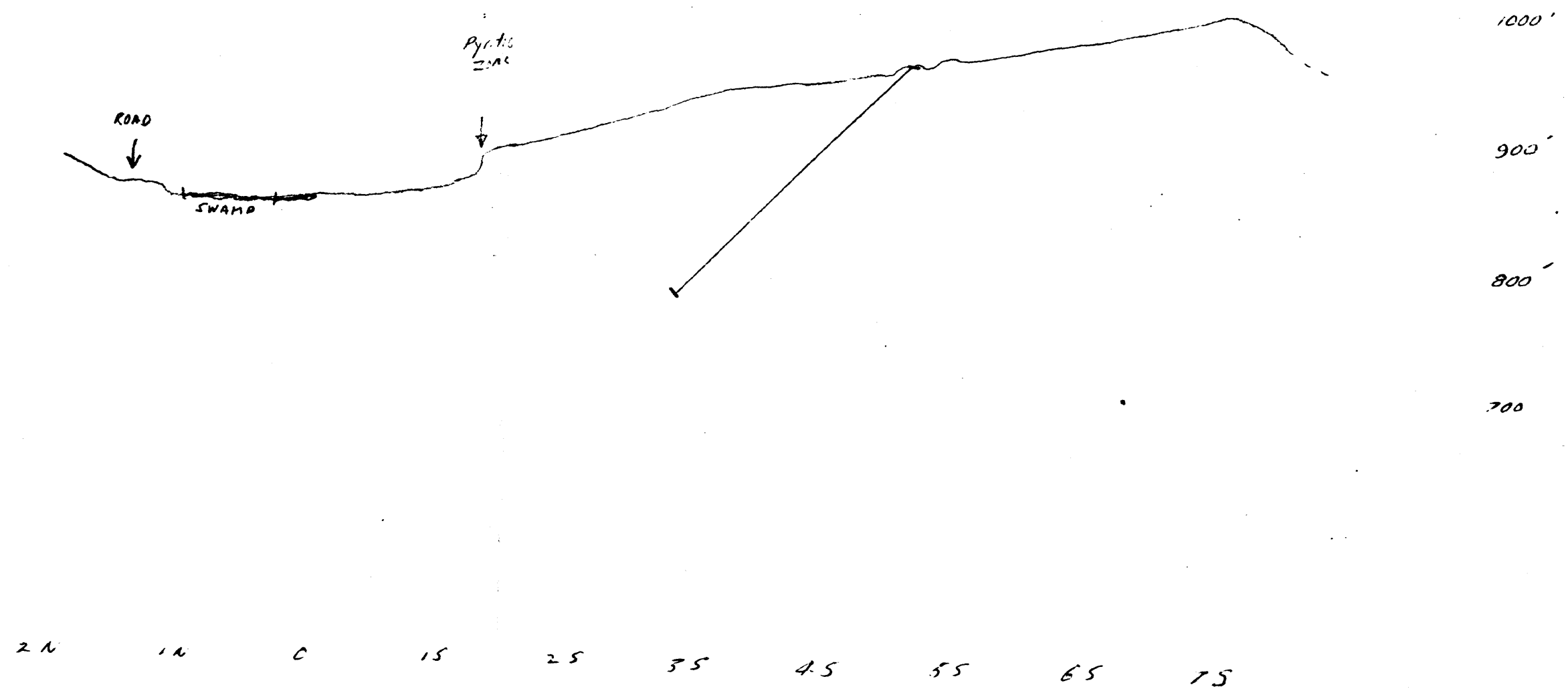
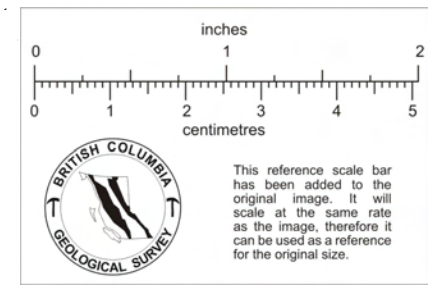

M Richards VI

DRILL HOLE N° 2

COLLAR 67+95W  
21+82N

- 45° GRID NORTH

COLLAR ELEVATION 562' ——— But Altimetry suggests 705' — this better agrees  
BY CLINOMETER ON GRID LINE with contours  
BASE ELEVATION STADIA STA 74E, elev 430'

92 B/13 - East

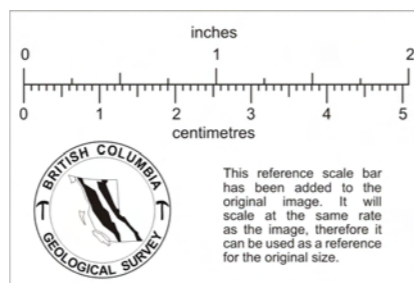

GRID NORTH

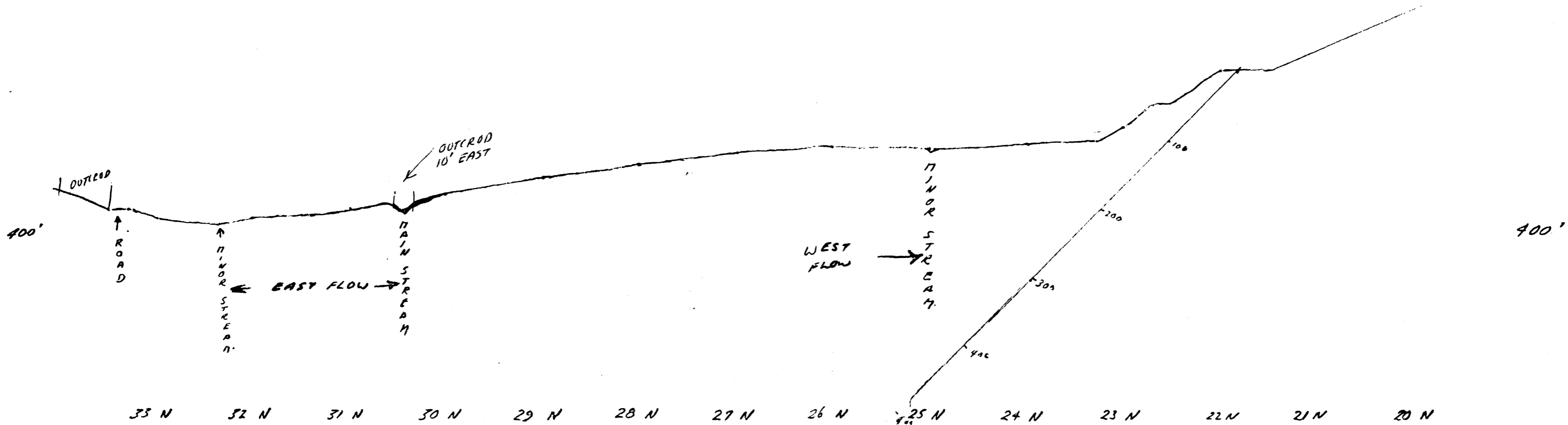

MT Richards VI  
 DRILL HOLE N° 1

COLLAR 81+95 W  
 39+95 N  
 - 45° Grid North

COLLAR ELEVATION 574.4' —  
 BY CLINOPIETER & MEASURING TAPE  
 BASE ELEVATION STADIA  
 STATION 110 E, elev 5828'

SCALE 1" = 100'

But Altimeter suggests 725' - this better  
 agrees with contours 92 B/13 - East

600'  
 500'  
 400'  
 300'

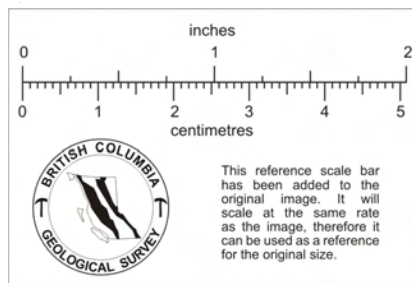

GRID NORTH.

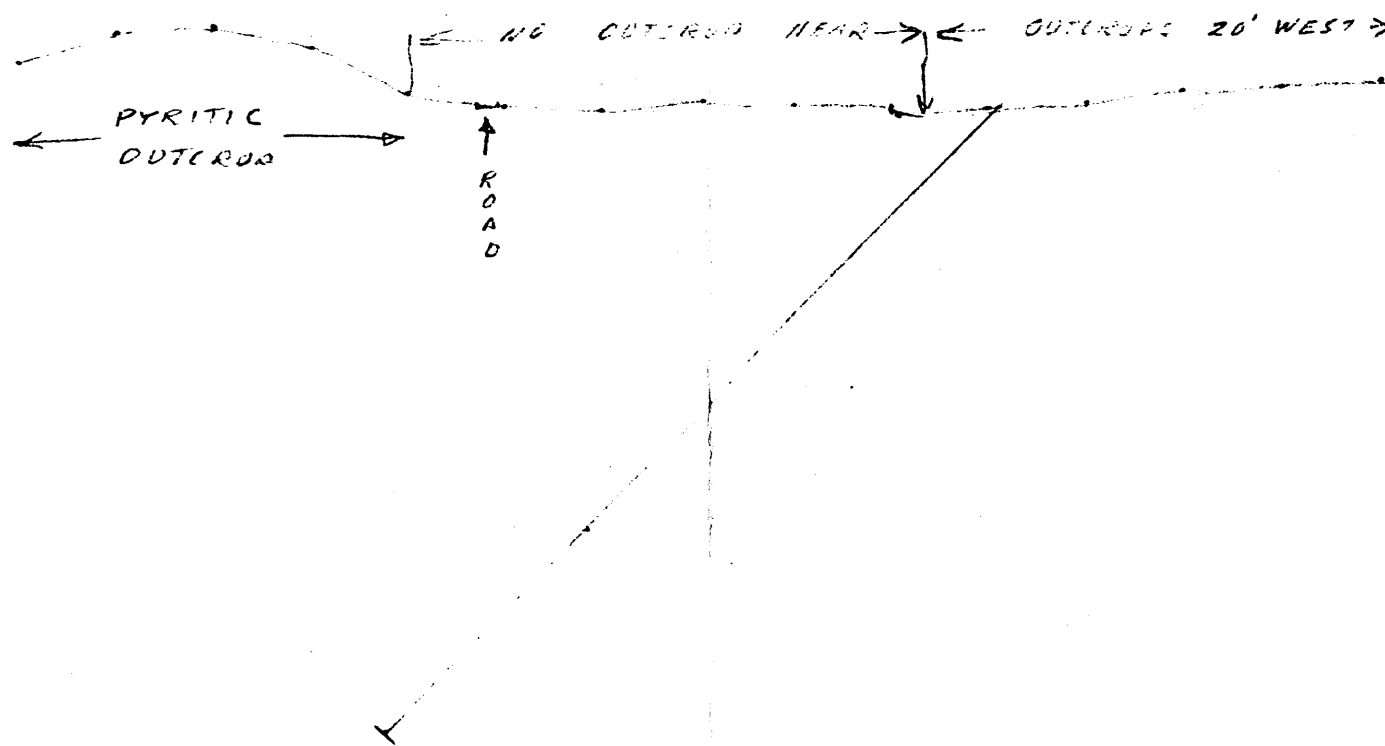

45 N 44 N 43 N 42 N 41 40 N 39 N 38 N 37 N