

JUNE, 2020 THE KMA SPEC

Architectural Products & Furnishings
NEW INTRODUCTIONS!



Bringing you up to date on KMA's unique architectural product collection!



Well, it is June and typically, many of us would be off to Chicago attending NeoCon seeing and learning about all the new products our manufacturers are introducing. But not this year. Are you disappointed?

Regardless of NeoCon, there are still many new products to see and KMA & Associates have much to be excited about! The Covid-19 world now means that we will just have to find alternate ways to share the new product collections. **Please let us know what types of presentations appeal to you? If not in-person, we can do webinar updates, outdoor tailgate presentations, sidewalk-table tops? We can adapt to your preferences!**

Sandler Seating has got it together. NeoCon or not, with their exciting **Virtual Showroom!** See all the latest and greatest seating products: Visit: <https://www.sandlerseating.com/neocon> and click the arrow buttons for your virtual tour. It's almost as good as seeing in-person but without the sore feet! The most exciting news is that the virtual showroom will be featuring collections from **InSpec Seating**, now a brand new division of Sandler, offering a wide range of innovative designs targeting the corporate market. The signature Scandinavian style speaks to truth in materials and industrial production. We're confident you'll find the right seating for the right project.

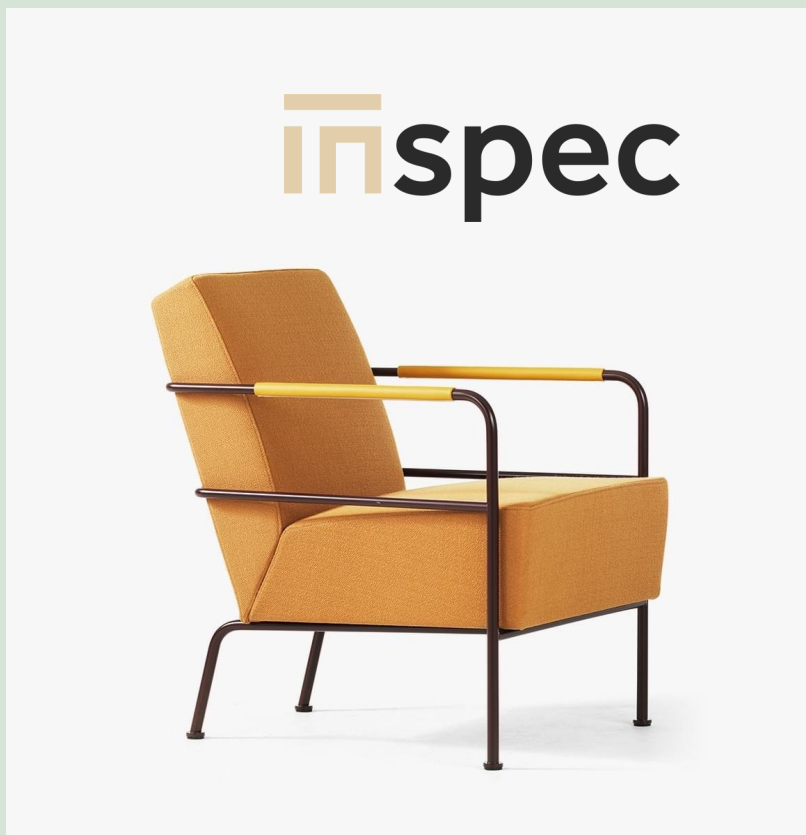

Below: "Area", part of the Lamhults Collection designed by Anya Sebton.

- An upholstered lounge collection of 8 pieces allows for endless configurations using the patented magnetic linking device.
- High and low back options available, "Area" encourages the user to participate in the creative process of seating!

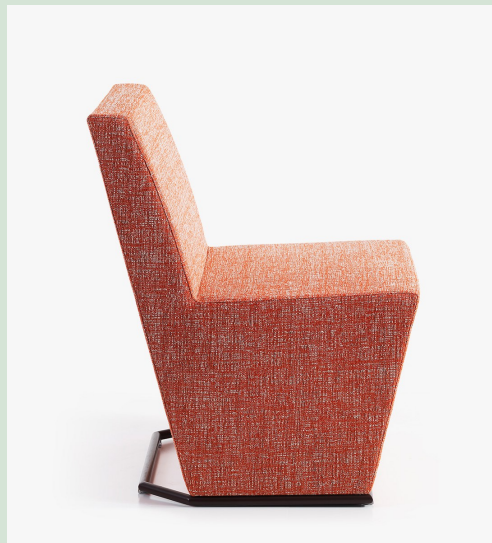

Above: "Cinema", a "sports car" of a lounge chair with leather stitching and strong supportive comfort! **VROOMMM!!**

nienkämper

Nienkamper has been busy with product development this past year and is now ready to unveil some awe-inspiring products too!

At Right: "The Patkau Cocoon"

Patkau Architects has designed The "Patkau Cocoon". The organic sculptural form, combined with the feeling of natural materials, provides a poetic type of presence. Each element is made of curved plywood and wood veneer. The spartan interior is inviting with fixed seat and is fitted with ecooustic panels providing a quiet space for solitude. These Cocoons are completely unexpected and would make a welcome retreat for a modern workplace.

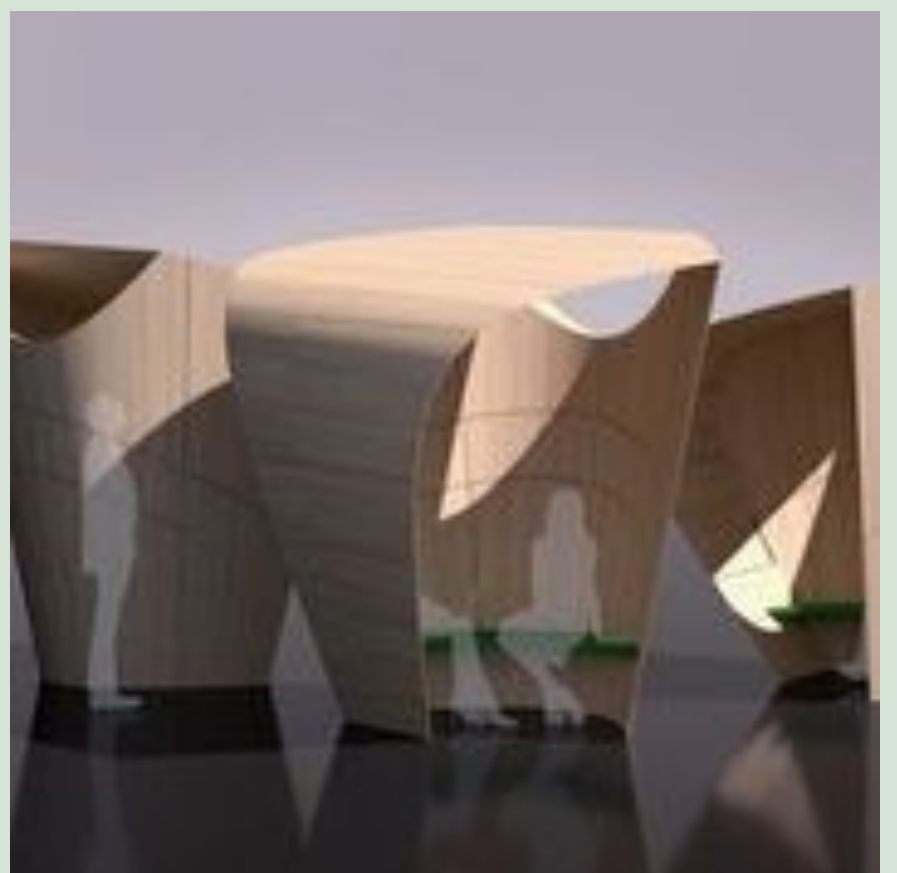

More new items from Neinkamper:



Left: Patkau Bench design: Patkau

The Patkau Bench is comprised of two solid wood sections which emphasizes the natural beauty of the wood variations and is separated by a central gap, interconnected with a seemingly sculptural stainless steel disc. Comfort is achieved by the gentle slope of the two angled solid wood sections resting on stainless steel hairpin legs. Minimal and understated, this piece is ideal for galleries and public spaces alike.

Right: Exhale Bench. design: busk + hertzog

An oasis in public spaces, the Exhale bench offers two levels of comfortable seating. Reminiscent of stepping stones, Exhale has two informal and multipurpose elements cantilevered at overlapping heights allowing for two or more people to relax in tandem. From informal waiting areas to break-out zones Exhale boasts maximum comfort with a minimal footprint making Exhale a refreshing alternative to traditional bench seating. Available with black or silver metal base.



Left: Need acoustical enhancement? Need lighting too? Meet "Trumpet" by Unika Vaev!

"It is not an acoustic panel with LED lighting. It's a lamp with acoustic properties", states Cutu Mazuelos, who designed Trumpet together with Eva Prego from Stone Designs. Trumpet is characterized by simplicity and a careful attention to the detail, which become obvious when you have a close look. Here, the designers use the iconic shape of the music instrument to both direct the light and to make a subtle connection to the space below the lamp. Trumpet has a solid wood body and an acoustic core made from recycled waste fabrics and worn-out PET bottles. Trumpet is remarkably thin, which gives the product a certain elegance. Yet, it makes a huge difference when it comes to noise!

Below: More lighting options from Unika Vaev! Introducing "Lily". This noise dampening light fixture by Unika Vaev address both sound and visual distraction.

The felt prototypes resembled the beautiful and tranquil leaves of lily pads, thus the name. Intended for large and more intimate spaces alike, whether a single lamp or a grouping of several, the result is a visual and acoustical calm in a space. As a lamp, Lily is supplied with a 236" (approx. 19') electrical cord, a 10 watt dimmable LED light (900-1100 lumens). The plug will need to be added by a licensed electrician.

unika vaev

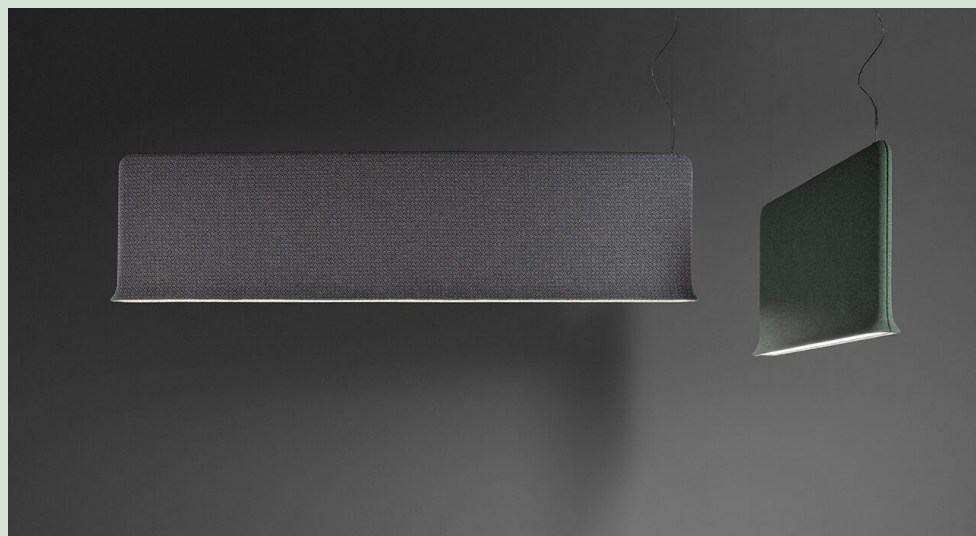

Please reach out to us anytime we can be helpful! Contact us by our individual email addresses or contact Rose, in our Customer Service Dept: 216-221-9755. Email: rstoicoiu@kma.bz

Thanks for your support!

