



**Hope's Mission is to teach God's Word and Share Christ's love with all.**

### **Frequently Asked Questions – LCEF and Building Campaign**

1. What are the current ministry and mission goals of Hope Lutheran Church and School?

Hope Lutheran Church has an active and growing Pre-School thru 8<sup>th</sup> Grade elementary school. In keeping with the church's mission statement, the current ministry and focus is to share the Word as well as teach it. Hope views the school as a mission field. Not only does it serve its current families, but also strives to reach the unchurched and bring the Word to those in the surrounding community.

2. Who is LCEF?

The Lutheran Church Extension Fund (LCEF) is a Recognized Service Organization (RSO) of the Lutheran Church - Missouri Synod. They specialize in assisting churches with projects such as our building campaign.

3. Why are we doing the campaign with them?

We have had a wonderful relationship with LCEF for many years and as a result, we have trust in LCEF. The combination of LCEF's expertise and trustworthiness makes them the best partner for us to partner in this building campaign and for future funding needs.

The existing loan we have is held through LCEF. Prior loans have also been through LCEF. They have also been very helpful in assisting us with needs such as refinancing.

4. New building will be dedicated to Don Simpson and George Martinek  
Don Simpson

Don Simpson's legacy at Hope Lutheran Church and School is one of unwavering dedication and heartfelt service. As the original principal in 1960, he helped lay the foundation for the high standard of education that continues to this day. Beyond his role as an educator, Don enriched the church community

as a devoted teacher, a skilled organist, and an active participant in the men's Bible study. His commitment to nurturing both the academic and spiritual growth of students and members alike has left an indelible mark on our church and school. The new classrooms dedicated in his honor will stand as a testament to his lifelong devotion and the countless lives he has touched.

### George Martinek

George Martinek was a devout member of his Lutheran parish and attended Lutheran church schools all his life. He completed his undergraduate degree at Concordia University in Chicago. George Martinek taught biology at Lutheran parochial schools. He earned his master's degree at Cal State Los Angeles and his doctoral degree at UCLA. He also served on the Hope Lutheran School and Lutheran High School boards of education.

Martinek, who taught at Cal Poly Pomona from 1967 to 1996, was an active member of the campus community. His teaching extended beyond the biological sciences department and included science education courses in the College of Education & Integrative Studies.

Martinek also took on administrative positions, including biology section coordinator and assistant department chair, and he served as director of the Center for Science and Math Education for five years. He was also director of the College of Science Advisory, advisor to both the Science Education Enhancement Services and the biology student honor society Beta Beta Beta. He also served in the Academic Senate for four years and chaired the appropriations committee.

"He was among our most unselfish, gentle and loving faculty," says Len Troncale, emeritus professor of biological sciences.

#### 5. Why do we need a new building?

When the original building plans were developed, a 2-story structure was planned for the space where the modulares were previously located. At the last minute, from what members can recall, this part of the new campus was canceled. Leaving the church campus short of classrooms/multi-purpose rooms.

In 1992, Hope Lutheran School was growing, and additional classrooms were necessary to support the increasing enrollment. The City of Glendora granted Hope Lutheran Church and School the temporary permits to install 2 Modular Classrooms. The permits have expired (1995), but because of Hope Lutheran's due diligence and care of the modulares, the City of Glendora allowed the modulares to stay.

6. What will the new building be used for?

Hope Lutheran Church and School is facing an additional growth in school attendance and needs to replace the 2 outdated modular classrooms. Due to permits, maintenance, expenses and age, it is no longer feasible to continue using them.

As of 09/2024 the new building will consist of 3 rooms. Most likely the 3 classrooms will occupy the 4<sup>th</sup>, 5<sup>th</sup> and 6<sup>th</sup> grades. Our current 5<sup>th</sup> grade classroom will be converted to our multi-purpose room for after school daycare, youth group, bible study and other specialty classes and studies.

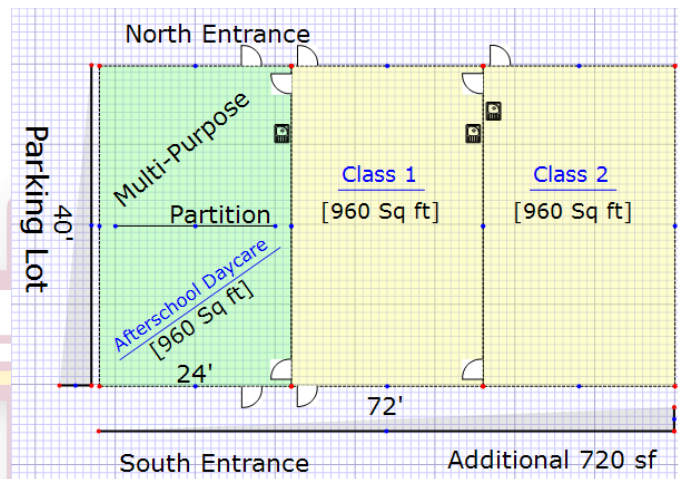

7. What is the building fund being used for?

- The building fund will be used to finance the construction of the new classrooms and multi-purpose room.
- The funds will also be used to upgrade the facility, and do maintenance as needed to improve the campus.
- It will also be used to increase our social media presence.

How will the school manage the loss of the modulares during construction?

The fellowship hall has been converted into two classrooms and a library/meeting room. Once the new classrooms have been completed, the fellowship hall be returned to its originally intended use.

When will the construction begin?

The proposal is to have the plans into the City during September 2024 and approved by the end of 2024.

Once approved, our goal is to start construction in the January to March timeframe,

If the construction is begun as planned, completion is planned for September 2025.

8. What is the fundraising goal for the Campaign?

The financial goal of \$1,500,000 is what has been chosen by the church council. Jesus states, our mission is to go and make disciples. With your help we can fulfill the mission of Christ, bringing and teaching God's message to more people.

9. How will the congregation know what is going on and where we are in the process?

Inform events – an opportunity to ask questions and provide feedback

Church Services, Bible Study, School bulletins

Email – [fulfillingthepromise@hopelutheran.org](mailto:fulfillingthepromise@hopelutheran.org)

10. What is the timeline for the Campaign? The building fund campaign is scheduled to last 3 months. Sept 15<sup>th</sup> – Dec 20<sup>th</sup>

i. Inform - Sept 15<sup>th</sup> – Oct 12<sup>th</sup>

ii. Inspire - Oct 13<sup>th</sup> – Dec 8<sup>th</sup>

iii. Commit - Dec 8<sup>th</sup> – Dec 20<sup>th</sup>

11. Is the Campaign giving above and beyond regular giving? Yes.

Your commitment is over a 3-year period and will be in addition to your regular financial support.

12. Why is it important for all members to participate in the Campaign?

Every person, every prayer, every talent, everyone's time and gift are important. The success of our Campaign relies on everyone. This is not about equal giving but giving according to one's ability.

i. Participate

ii. Pray

iii. Contribute

13. Will school families be invited to participate in our capital campaign?

Yes.

Every school family will be approached. The education at Hope Lutheran School is unparalleled in the community. Alumni often reflect on their early high school years and how equipped they were to manage their new demands.

- In what ways can I help?

Participate - School families can earn participation hours

Contribute

Pray

14. When giving, is there a designation to be made when writing a check or donating online?

Yes.

For checks, write “**Fulfilling the Promise**” on the memo line.

For on-line, designate “**Fulfilling the Promise**” in Vanco

15. Will campaign pledges be made public?

No.

Pledge donors and amounts will not be made public. Total pledges will be shared in amount only – no names. Pledge donors and amounts will only be seen by the Campaign finance team for documentation purposes.

