

ISHPEMING TOWNSHIP CHICKEN APPLICATION
1575 US 41 W
Ishpeming, MI 49849

Date of Application: _____ Phone Number: _____

Property Owner Name: _____

Address: _____

Zoning District: _____ Lot #: _____ Size of Lot: _____

Number of Chickens Proposed: _____

Permit Fee: \$100.00

Special Meeting Fee: \$250.00

Initial Inspection: \$50.00

Violation of Ordinance Inspection: \$50.00

R1 & R2 District: 6 chickens maximum

R11 District: 6 chickens plus 3 additional chickens per acre over 2 acres

R3 & R4 Districts: No chickens allowed

Location of chicken coop on lot: Backyard only

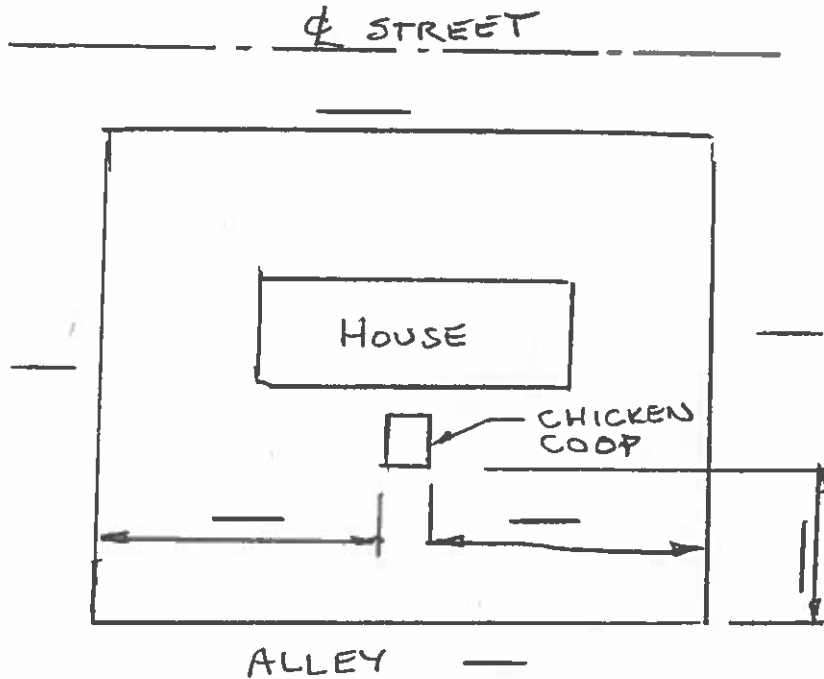

Fee Amount: \$ _____ Date Paid _____ Cash/Check _____

Approved: _____ Disapproved: _____ Remarks: _____

Zoning Administrator: _____