

NO CREDIT CHECK!

Lofted Barn Cabin ^{LBC}



Standard Features: New 6' Deep Porch with Increased Porch Height - 6' from Porch Front to Wall, Three 2'x3' Windows with Latches/Screens, 6'6" Under Rear Loft Height, Two Reinforced Loft Spaces Located on Opposite Ends of Interior, 78" 9-Lite Door with Lock and Keys.

Lofted Barn Cabin ^{PLBC PREMIER®}



Standard Features: New 6' Deep Porch with Increased Porch Height - 6' from Porch Front to Wall, 6'6" Under Rear Loft Height, Two Reinforced Loft Spaces Located on Opposite Ends of Interior, Four 2'x3' Windows with Latches/Screens with New Optimal Cross Wind Location on Both Sides of the Building, 78" 9-Lite Door with Lock and Keys.

Cabin ^C



Standard Features: New 6' Deep Porch with Increased Porch Height, Low Pitched Gable Roof, 92" Interior Wall Height, Three 2'x3' Windows with Latches/Screens, and 9-Lite 36"x78" Door with Lock and Keys. 8' model does not have railing.

Center Cabin ^{CC}

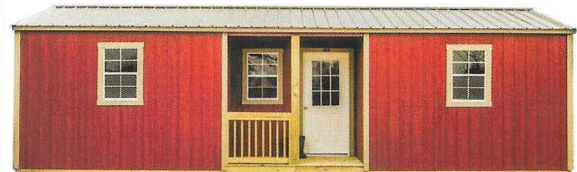

Standard Features: The Center Cabin includes 8' Wide Porch (option to upgrade to a 12' Wide Porch) with Increased Porch Height, Low Pitched Gable Roof, 92" Interior Wall Height, Three 2'x3' Windows with Latches/Screens, and 9-Lite 36"x78" Door with Lock and Keys. Center porch location creates a great natural separation inside. Add some special touches to your own Center Cabin today! Also available in Center Lofted Barn Cabin ask your dealer for details.

Premier Cottage Shed ^{PCS} Premier Garden Shed ^{PGS}

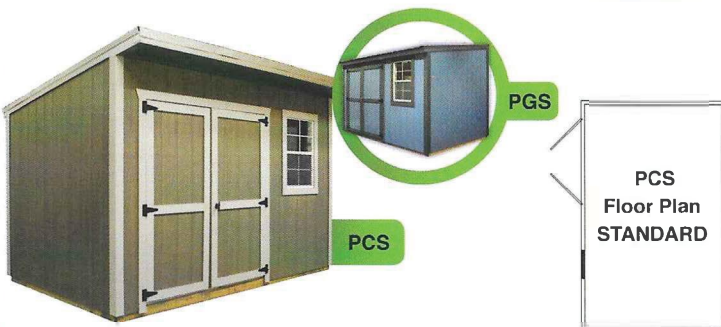

Standard Features: 75" Rear Wall & 89" Front Wall. 70" Door Opening with Double Wooden Entry Doors. One 2'x3' Window, Door Lock and Keys, High-end Hinges, Spring Latch Hooks Top and Bottom of Left Door Ensures Security. Not Available in Metal.

Premier Tool Shed ^{MTS}

Discontinued

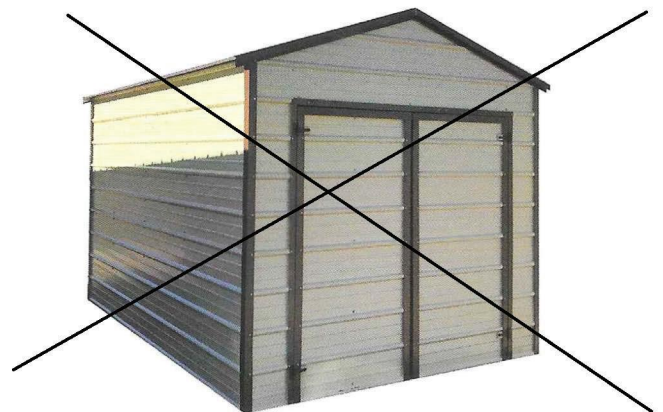

Standard Features: 2'x6' Treated Floor, LP 5/8" Tongue and Groove Flooring, 75" 2'x4' Studs. Double Doors with Door Lock and Keys, Spring Latch Hooks Top and Bottom with a Diamond Treadplate.

Lofted Barn ^{LB}



Standard Features: 6'6" Under Loft Height, Two Reinforced Lofts Located on Opposite Ends of Interior, 70" Door Opening & Double Wooden Doors (Optional Fiberglass Doors Shown), Door Lock and Keys, High-End Durable Hinges, and Spring Latch Hooks Top and Bottom of Left Door Ensures Security.

Side Lofted Barn ^{SLB}



Standard Features: 6'6" Under Loft Height, Two Reinforced Lofts Located on Opposite Ends of Interior, Two 2'x3' Windows with Latches/Screens, 70" Door Opening & Double Wooden Doors, Door Lock and Keys, High-End Durable Hinges, Spring Latch Hooks Top and Bottom of Left Door Ensures Security.

Lofted Garage ^{LG}



Standard Features: New Window and Door Configuration! Two 3'x3' Windows with Latches/Screens, One 36"x70" 4-Lite Outswinging Door, One 9'x7' Roll-Up Door, 6'6" Under Loft Height, Two 4' Reinforced Lofts Located on Opposite Ends of Interior, and Premier's New Premium 3/4" Flooring.

Garage ^G



Standard Features: Our Classic Low Pitched Gable Roof Garage with New Window and Door Configuration! Two 3'x3' Windows with Latches/Screens, One 36"x78" 4-Lite Outswinging Door, One 9'x7' Roll-Up Door, and Premier's New Premium 3/4" Flooring.

Utility ^{UTX}



Standard Features: Low Pitched Gable Roof, 92" Interior Wall Height, 70" Door Opening & Double Wooden Doors, Door Lock and Keys, High-End Durable Hinges, Spring Latch Hooks Top and Bottom of Left Door Ensures Security.

Side Utility ^{SUTX}

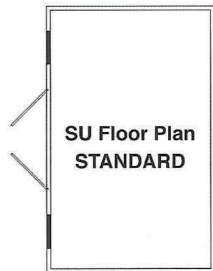

Standard Features: Low Pitched Gable Roof, 92" Interior Wall Height, Two 2'x3' Windows with Latches/Screens, 70" Door Opening & Double Wooden Doors, Door Lock and Keys, High-End Durable Hinges, Spring Latch Hooks Top and Bottom of Left Door Ensures Security. Shown in optional Two Tone.