

T25N - R20E
 SECTION 22 & 23
 VINITA, OKLAHOMA

V34



2-2-2015
REVISED 8-18-2021
 CRAIG COUNTY E911

SEE PAGE 26

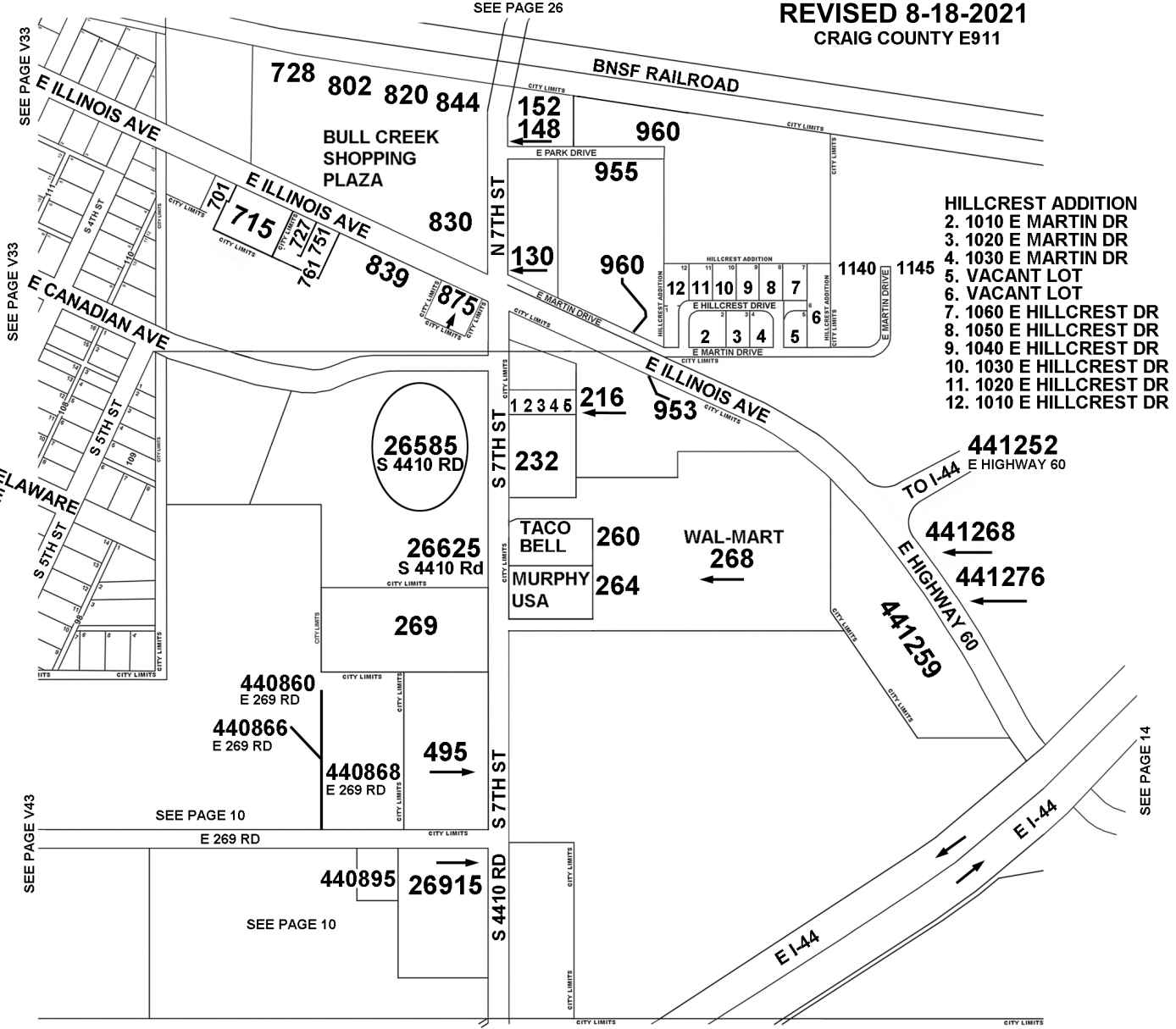

- HILLCREST ADDITION**
2. 1010 E MARTIN DR
 3. 1020 E MARTIN DR
 4. 1030 E MARTIN DR
 5. VACANT LOT
 6. VACANT LOT
 7. 1060 E HILLCREST DR
 8. 1050 E HILLCREST DR
 9. 1040 E HILLCREST DR
 10. 1030 E HILLCREST DR
 11. 1020 E HILLCREST DR
 12. 1010 E HILLCREST DR

SEE PAGE V33

SEE PAGE V33

SEE PAGE V33

SEE PAGE V43

SEE PAGE 10

SEE PAGE 10

SEE PAGE 14

SEE PAGE 14