

T24N-R21E

CRAIG COUNTY, OKLAHOMA

4

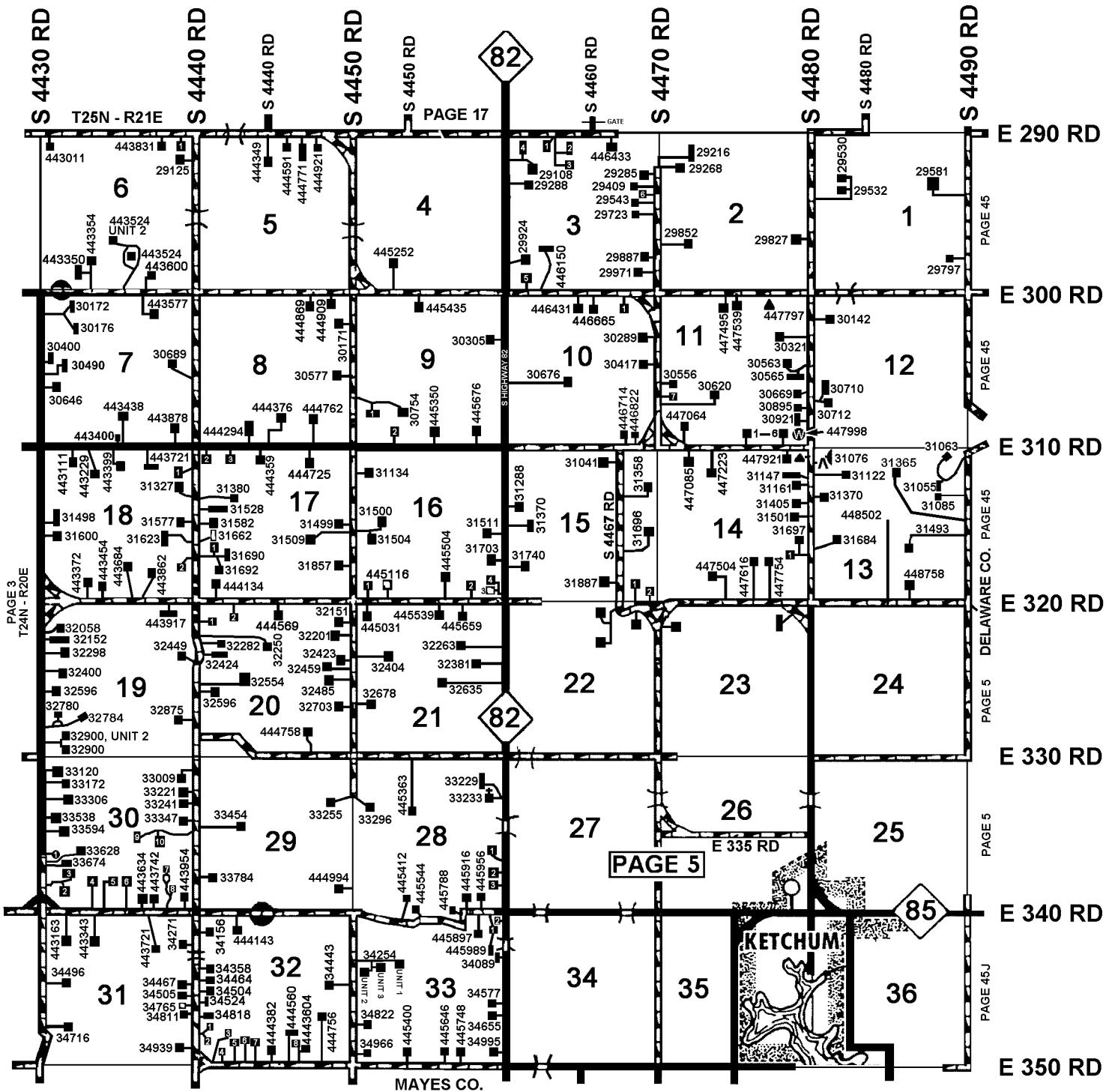

SECTION 3

1. 446349
2. 446355
3. 446359
4. 29104
5. 446110
6. 29509

SECTION 6

1. 443897

SECTION 9

1. 30754, UNIT 2
2. 445136

SECTION 10

1. 446799

SECTION 11

1. 447486
2. 447624
3. 447664
4. 447840
5. 447860
6. 447864
7. 30584

SECTION 14

1. 31697, UNIT 2

SECTION 15

1. 446862
2. 446998

SECTION 16

1. 445030
2. 445742
3. 31913
4. 31911

SECTION 17

1. 31688
2. 444031
3. 444185

SECTION 18

1. 31051
2. 31699

SECTION 20

1. 32188
2. 44241

SECTION 28

1. 33711
2. 33925
3. 33955

SECTION 30

1. 33667
2. 33858
3. 3386
4. 443334
5. 443394
6. 443488
7. 443844
8. 443846
9. 33473 UNIT 2
10. 33473

SECTION 32

1. 34846
2. 34850
3. 444078
4. 444220
5. 444268
6. 444310
7. 444332
8. 444586

SECTION 3

1. 34023
2. 445987

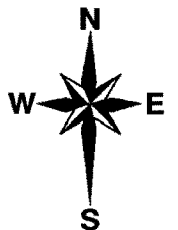

2-10-1994
 REVISED 5-27-2026
 CRAIG COUNTY E-911