

NBHS DANCE & BOOSTER CLUB PRESENTS



HILL COUNTRY CHAMPIONSHIP

PACKET ENCLOSURES:

- **LETTER FROM DIRECTOR, MEGAN COLON**
- **CONTEST CLEANING AGREEMENT**
- **CONTEST PRE-ORDER MEAL INFO**
- **LAYOUT OF NEW BRAUNFELS HS**
- **PARKING ROUTES - BUS, SPECTATOR, PROP**
- **ROUTE TO BACK PARKING LOT.**

DIRECTOR

FEBRUARY 21ST, 2026



Dear Directors,

I am very pleased to be co-hosting the HTEDance Competition at New Braunfels High School on Saturday, February 21, 2026. The New Braunfels Monoceras, Mystics & Sapphires have hosted this competition for many years and are truly looking forward to another great year. I believe you will be very pleased with the facilities at NBHS.

Please make a special note of the team arrival and registration area, the spectator entrances and the availability for parking, which are all indicated on the school map. Please make the necessary directions and the general information contained in this letter available to your team members and their families in order to make their arrival and departure as smooth as possible.

The contest performances will be in 1 gym. The gym is a wood surface with regulation markings for volleyball and basketball.

IMPORTANT NOTE:

In the Main Gym all dancers will enter on judges' left (back corner) and exit on judges' right (back corner).

We will provide one warm up/practice area located in the Auxiliary Gym. All teams are allowed 5 minutes at a time.

All Props must be approved by the booster club prop coordinator or it will not be allowed on the floor. We realize you have already paid an HTEDance entry fee so please make sure your prop is appropriate.

The following information is the general facility use schedule for the competition. HTEDance will be supplying a detailed competition schedule with your group's performances times. The schedule will also be available on the HTEDance website.



NBHS CONTEST SCHEDULE/CAMERA AND FOOD RULES

Registration/ Team Check-in begins at **6:00 a.m.** Please do not plan to arrive before this.

Professional video cameras will be allowed on both performance areas; however, due to fire code regulations, tripods and electrical extension cords are not permitted. All cameras must be hand held and work off battery packs. In addition, this policy will help maximize seating as well as minimize complaints from audience members about obstruction of view due to cameras and their operators. Please inform your team's parents of this policy to avoid any problems.

The New Braunfels Dance Booster Club has planned many things for you and your team in order to help the day run smoothly. Concessions will be offered for breakfast, lunch, dinner and snacks throughout the day. Pre-order meal forms are included as well, for lunch and dinner.

NOTE: ABSOLUTELY NO OUTSIDE FOOD OR DRINKS WILL BE ALLOWED. THOSE ATTEMPTING TO DO SO WILL BE DENIED ENTRANCE INTO THE SCHOOL. NBHS DANCE WILL HAVE PARENTS, ADMINISTRATION AND ROTC STATIONED AT EVERY ENTRANCE TO ENSURE THIS DOES NOT OCCUR. PLEASE INFORM ALL PARENTS OR GUESTS FROM YOUR SCHOOL OF THIS.

Each team will receive a private classroom to be used as a dressing area.

PLEASE keep your area clean and **remember no food or drink allowed in the building.**

I look forward to seeing you on February 21st!

Megan Colon
Monoceras, Mystics & Sapphires Director
mcolon@nbisd.org
(830) 627-6183



NBHS Dressing Area Cleaning Agreement & Guidelines

PLEASE FILL OUT THE FORM USING THE LINK BELOW!

<https://forms.gle/sPnMNGyUSVQCjQ9m8>

Each team will be assigned a private dressing area. Rooms will be assigned according to registration with HTE and in consideration of your team's size. The larger classrooms may have more than one assigned to the area. **Please make sure your dressing area is clean by the conclusion of the contest.** Please understand that many of the dressing areas are classrooms, and the teachers are being gracious in allowing us to use them for this purpose.

Absolutely NO food or drink allowed in the classrooms!

The dressing areas are not secured. Each team is responsible for the care and keeping of personal and team items. The NBHS Dance teams, the Dance Team Booster Club and HTEDance cannot be held responsible for damaged items.

Please clean and clear your dressing area to the best of your ability. This involves picking up all discarded bobby pins, safety pins, trash etc. Every team will be given one trash bag upon arrival for this purpose and may ask their NBHS Dance buddy for more should they so need.

Due to time constraints on the janitorial staff, you will need to clean and clear your dressing area prior to awards.

A cleaning fee of **\$100.00** will be charged for each room that is not considered clean and clear by the custodial staff and myself upon final walk through after the contest. It is imperative that all rooms be left in good condition so that I may continue to offer private dressing areas to our team participants in the future.

Thank you in advance for your cooperation!

Megan Colon,

Director, NBHS Monoceras, Mystic and Sapphires

TEAM MEALS Pre-Order Form
New Braunfels HS - HTE Dance Competition 2/21/26
PLEASE SUBMIT THE GOOGLE FORM BY FRIDAY, February 13th

Link to the google form for Meals & Questionnaire

<https://forms.gle/kJ3xKypHxSYwzMLu7>

Meal options

Lunch (All lunches \$13)

- Chick-fil-A Sandwich Box Meal (chips, cookie & water)
- Chick-fil-A 8 count Nugget Box Meal (chips, cookie & water)
- Chick-fil-A Grilled Cobb Salad (water)
- Chick-fil-A Cobb Salad W/O Chicken (water)

Dinner (Price varies)

- Mattenga's 10" Cheese Pizza (water) - \$12
- Mattenga's 10" Pepperoni Pizza (Water) - \$12
- Mattenga's Chicken Alfredo (water) - \$12
- Mattenga's Alfredo W/O Chicken (water) - \$10
- Chick-fil-A Grilled Cobb Salad (water) - \$13

Please email all question and order forms to: nbhsdanceboosters@gmail.com

If there is any dietary need, please let us know

PAYMENT MUST BE RECEIVED UPON ARRIVAL. Meals will not be provided without payment.

Please make checks payable to **NBHS Dance Booster Club**.

*PLEASE NOTE THAT NO OUTSIDE FOOD OR DRINKS MAY BE BROUGHT INTO THE SCHOOL
Concession Stand will provide for purchase, food, snack items, Water, Gatorade, Soda & Tea*

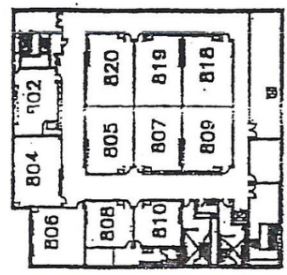

Second Floor Plan

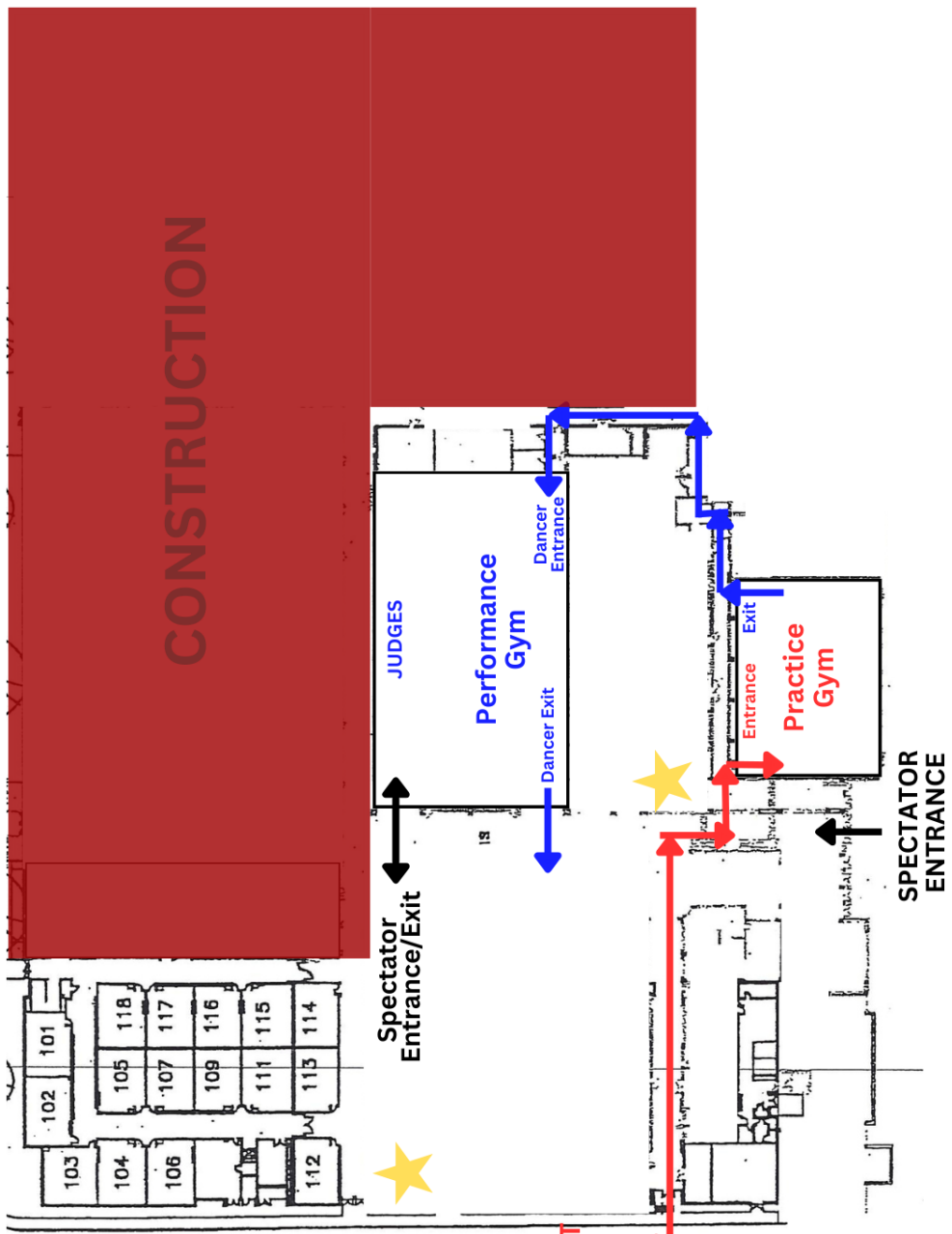

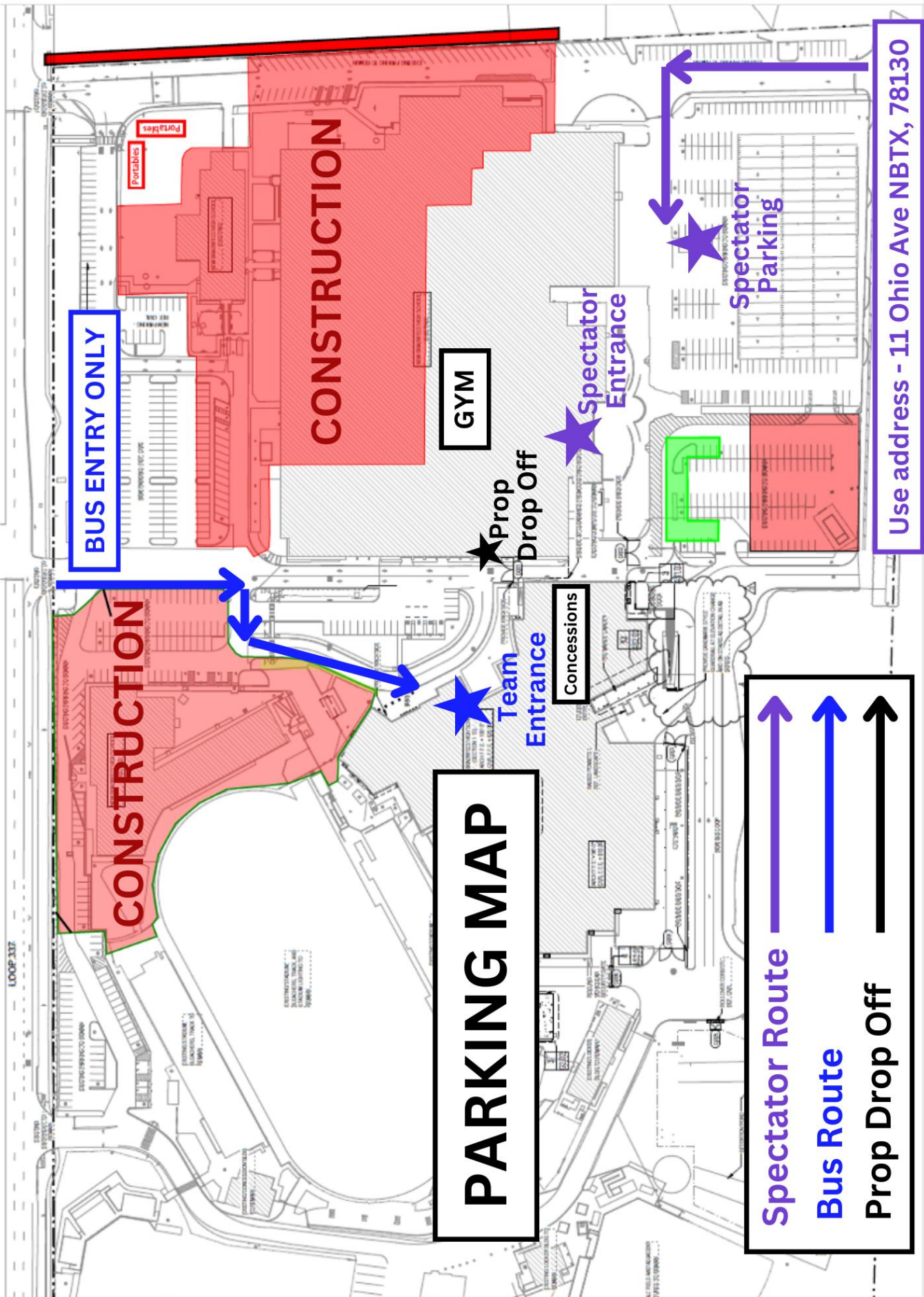

BUS ENTRY ONLY

CONSTRUCTION

CONSTRUCTION

PARKING MAP

GYM

Team Entrance

Concessions

Prop Drop Off

Spectator Entrance

- Spectator Route** — (purple arrow)
- Bus Route** — (blue arrow)
- Prop Drop Off** — (black arrow)

Use address - 11 Ohio Ave NBTX, 78130

Spectator Parking

LOOP 337

Portables

SPECTATOR PARKING LOT

Our School is currently under construction, so getting to our SPECTATOR parking lot can be tricky. Here is a map to share with parents or dancers who will be driving to attend. Use the following address to get to the back parking lot.

11 Ohio Ave New Braunfels, TX 78130

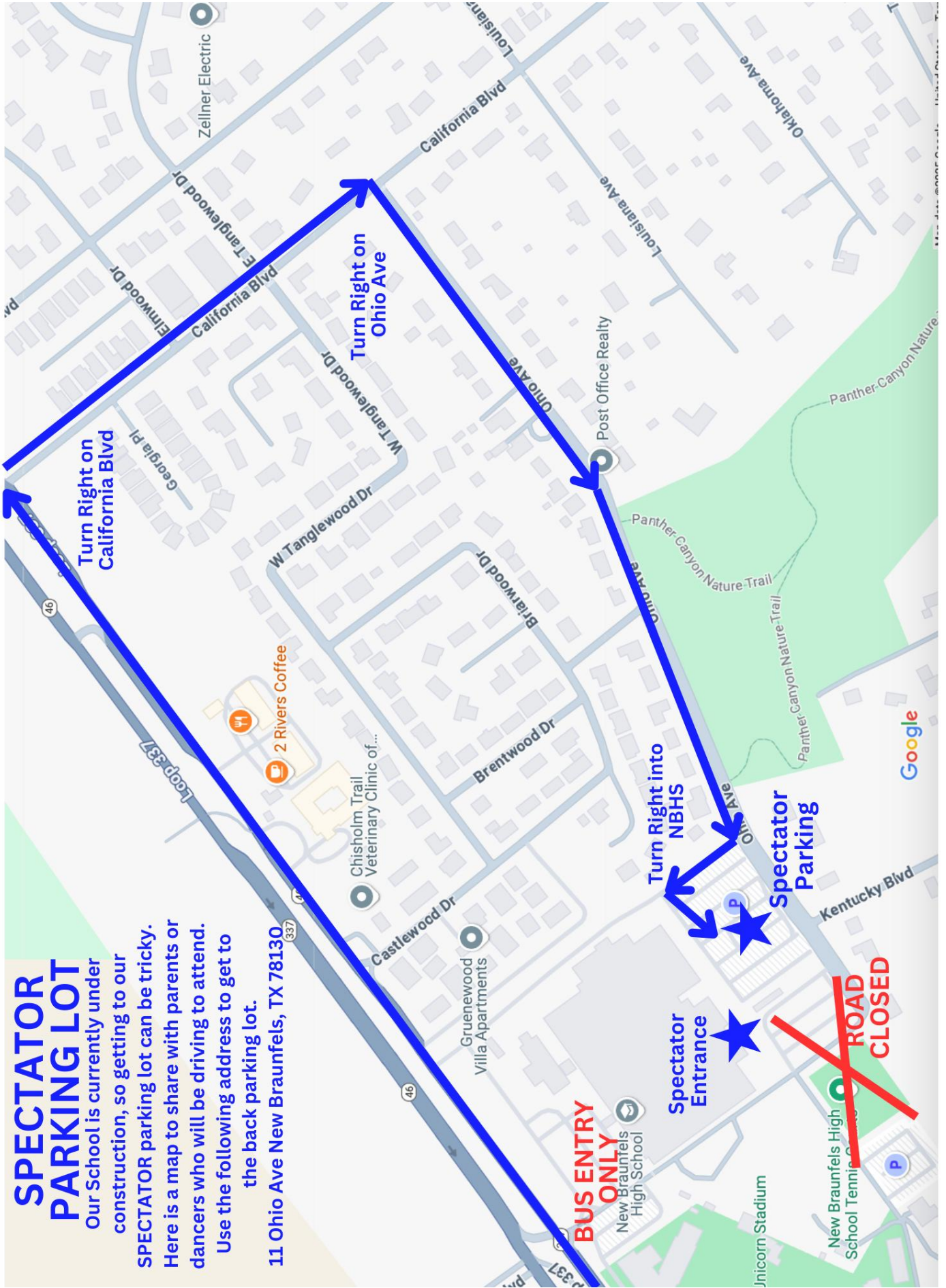

BUS ENTRY ONLY

From Loop 337



Team Entrance

ENTRANCE/EXIT from New Building to Gyms

ENTRANCE/EXIT from Gyms to Concessions

CONCESSIONS

TEAM MEALS

Spectator Entrance/Exit

Performance Gym

Dancer Entrance

Prop Storage

Prop Drop Off

Practice Gym

SPECTATOR ENTRANCE

SPECTATOR PARKING

From 11 Ohio Ave. NBTX 78130

F15