

A Quarterly Publication
Of the Hardin County
Historical Society, a
Non-Profit Organization.
Originated in 1931

Bits and Pieces

OF HARDIN COUNTY HISTORY

www.hardinkyhistoricalsociety.org

Sherrill Williams, Researcher
Michael L. Bell, Compiler
mike@glendalecc.org

VOL. MMXXI NO. 2

ISSN 1536-1867

Spring 2021

Sand Spring

By Meranda Caswell

On January 2015, Jerome Dawson took me on a trip on US 31W to see the area once known as **Sand Spring**. He lived here as a child and had many fond memories of the area.

Where is Sand Spring? I searched for clues in the Hardin County deed records. So far, I have not been able to find an early deed with the words “Sand Spring.” The early deeds continuously refer to East Rhudes Creek.

I have reviewed maps to determine the actual spring called Sand Spring. The



area identified by Jerome Dawson is near East Rhudes Creek. The spring may be an off shoot of the East Rhudes Creek; East Rhudes Creek empties into Sportsmans Lake.

According to Jerome Dawson, one location is identified as Sand Spring Church. Today this same church is the **Dorsey Chapel Missionary Baptist Church**.

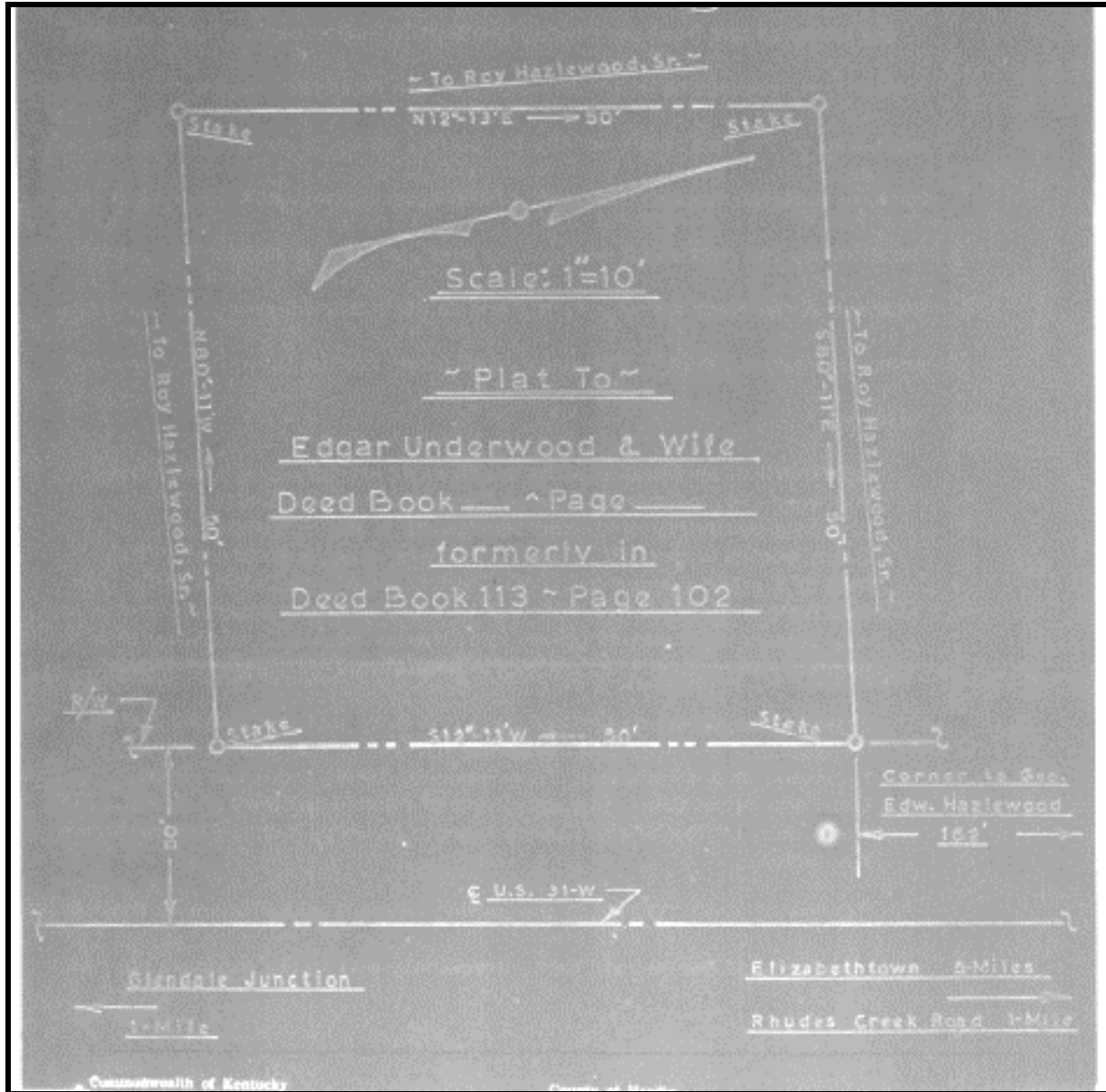

The drinking water for the area was from the spring behind the church. When you looked at the bottom of the spring, you saw only sand because it was so clear. Jerome, as a child, had carried water from that spring.

The Dorsey Chapel is located at S. Dixie Highway, Glendale, Kentucky 42740. It is not identified with an actual street address. It is in between 5234 S. Dixie Highway and 5326 S. Dixie Highway. The property is on the west side of U. S. Highway 31W, approximately five miles south of Elizabethtown, and being approximately one mile south of East Rhudes Creek Road. Hardin County Property Valuation Assessor's office identifies it by a map id or parcel id number 224-00-00-013. The church is on 0.06 acres.

When the church was organized in 1968, the following were the trustees: Dwyetty Edgar Underwood, Virginia Underwood, Clarence Cook and Margie Cook. In 1973 when the church sold the property to Hubert Riggs and Spurgeon Riggs, the trustee for the church was Edgar Underwood. Some tidbits of information found about the membership of the church are the following: In 2012 Dorsey Chapel Church's pastor was Ernie Priddy, according to the ad to the right, from the News-Enterprise on March 20, 2012.

GLENDALE
CALVARY MISSION CHURCH OF GOD
6827 S. Dixie Hwy., 369-7946
Brenda Nelson, Pastor
DORSEY CHAPEL MISSIONARY BAPTIST CHURCH
South Dixie Hwy., 879-8256
Ernie Priddy, Pastor

When the church was organized in 1968, the following were the trustees: Dwyetty Edgar Underwood, Virginia Underwood, Clarence Cook and Margie Cook. In 1973 when the church sold the property to Hubert Riggs and Spurgeon Riggs, the trustee for the church was Edgar Underwood. Some tidbits of information found about the membership of the church are the following: In 2012 Dorsey Chapel Church's pastor was Ernie Priddy, according to the ad to the right,



from the News-Enterprise on March 20, 2012.



The deacon, Gerald C. Riggs died in 2011. Gerald Riggs was the son of Reverend Hubert Owen Riggs and Viola Pansy (Miles) Riggs. Rev. Hubert Owen Riggs, once a pastor of Dorsey Chapel, died in 2009. April Lee Crain, granddaughter of Gerald Riggs, was a member of the church. She died on August 24, 2011.

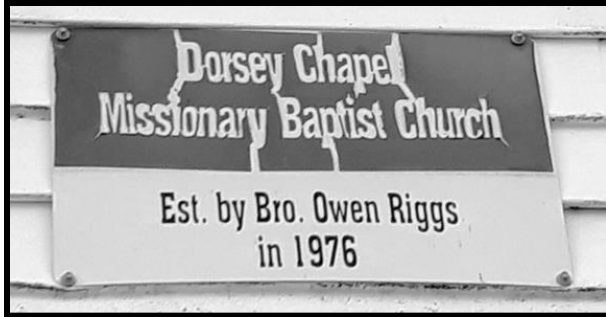

The following is a list of owners of the church property using land records:

1. To Gerald and Brenda Riggs (4/5 interest) (2009) Deed Book 1298 Page 40
2. To Hubert Riggs and Weller Spurgeon Riggs (1973) Deed Book 255 Page 483
3. To Church of Interdenominational Gospel Inc (1969) Deed Book 219 Page

157

- | | |
|---|------------------------------------|
| 4. To Church of God of Prophecy (1944) | Deed Book 113 Page 102 |
| 5. To Arthur and Virgie Lambert (1942) | Deed Book 113 Page 101 |
| 6. To Altha and P. L. Showalters (1941) | Deed Book 104 Page 457 |
| 7. To Ed and Carrie Hazelwood (1929) | Deed Book 93 Page 583 |
| 8. To Harvey and Belle Johnson (1905) | Deed Book 54 Page 120 |
| 9. To J. H. and Sallie Chism (1902) | Commissioners Deed Book 1 Page 506 |

A more in-depth search will need to be conducted to find the previous century (1800-1900) land records. The last deed book does not have a deed source or a name of the previous owner.

On the 1924 Oil and Gas Map of Hardin County, there is a school called Sand Spring. Carolyn Wimp had transcribed the **1924 Hardin County, KY School Census**. (This book is available for purchase from Ancestral Trails Historical Society, www.aths.com.) This transcription includes the parents or guardians of the children as well as the children's names and ages.

Parents/Guardians

- | | |
|---------------------|------------------------|
| 1. Bush, George | 11. Hazelwood, William |
| 2. Cofer, Quin | 12. Hundley, J. H. |
| 3. Dale, William | 13. Johnson, Henry |
| 4. Dailey, John | 14. Payton, Irwin |
| 5. Durrett, Henry | 15. Payton, Maxie B. |
| 6. Gordon, Rulene | 16. Self, D. L. |
| 7. Hill, Isaac | 17. Spencer, Dock |
| 8. Haney, Horace | 18. Vaughn, Ray |
| 9. Robert Hazelwood | 19. Warren, Zack |
| 10. Hazelwood, Ed | |

Some of the children listed are the following: Paulene Brown, born April 6, 1915, was the granddaughter of Henry Derit (Durrett). Luther L. Brown, born November 17, 1914 and his brother Thomas Brown, born February 8, 1917, were under the guardianship of Isaac Hill or Hall. The mother of Luther and Thomas Brown is Bertha A. (Dailey) Brown, according to the 1920 Hardin County Census. The other children listed in the 1924 school census are either children or grandchildren of the names listed above.

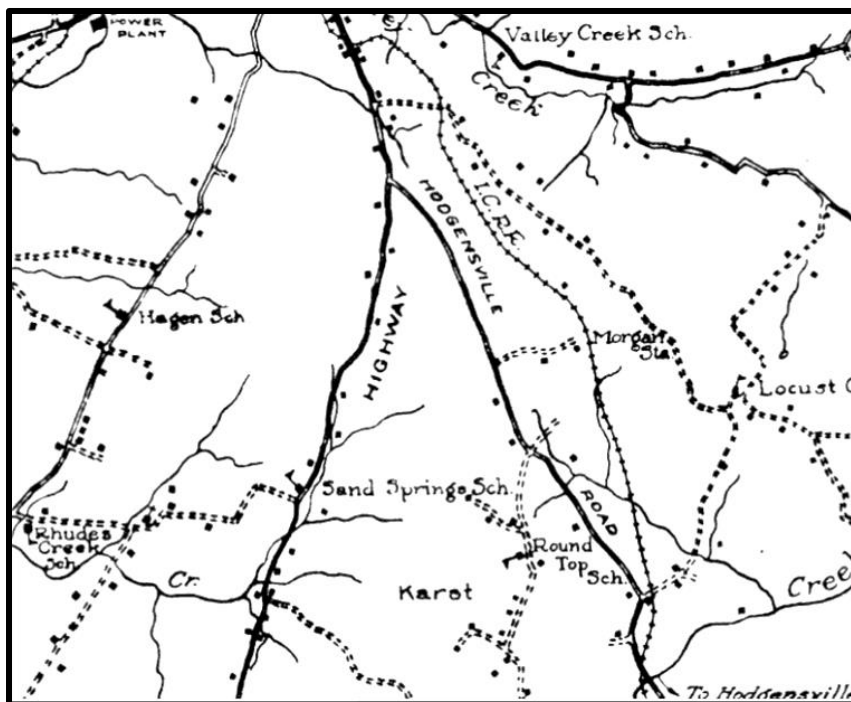

1924 Hardin County, KY Oil and Gas Map

In the book *Early Schools in Hardin County, KY* compiled by Carolyn Wimp, the Sand Spring school is discussed in detail. The last year for this school was 1934-1935 before the students were transported to Glendale. There are superintendent reports for 1891, 1895, 1896, 1902, 1903, 1905 through 1908. In the given reports, there are anywhere between 41 to 52 children who attended the school. A new schoolhouse had been built in 1915. The old schoolhouse building had been sold at auction on July 10, 1915 for \$37.50. A list of teachers is in the book. The school reopened in 1943 with Mrs. Hilary McGuffin as the schoolteacher. There is no further information about the Sand Spring School after 1943 in this book. [This book is available for purchase from Ancestral Trails Historical Society, too. www.aths.com]

In the 1937 Hardin County, KY map, the new US 31W was created on the map. Prior to this year, the US 31W was Sportsman Lake Rd. It is parallel to US 31W.

In the 1955 map below, you can see the East Rhudes Creek Church near the place once called Sand Spring School. Today this church is called New Horizon Baptist Fellowship. It is located at 864 West Rhudes Creek Road, Glendale, Kentucky 42740

The Hazelwood family members from Sand Spring school are buried here, too. Many of the parents and their children from the Sand Spring school are buried here at the East Rhudes Creek Church cemetery.

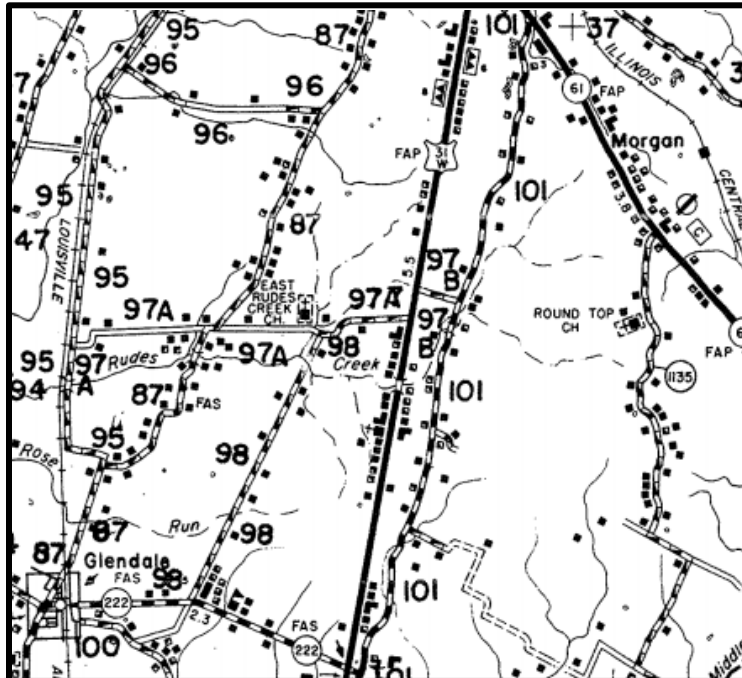

1955 Ky Hwy Map of Hardin Co, KY

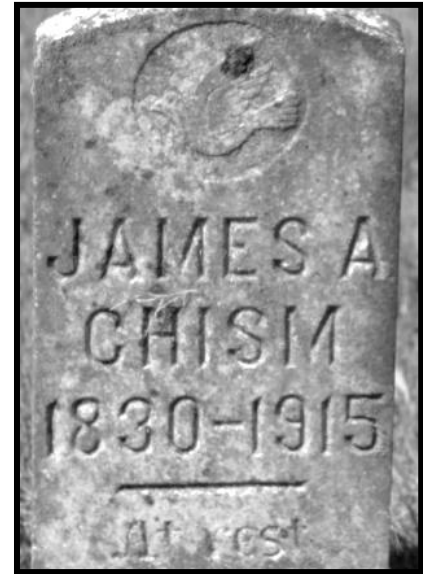

Thanks Miranda for a most interesting article. MLB

NEWS - NOTES

Elizabethtown News Feb 15, 1915

John W. Woodring died yesterday at his home in Elizabethtown of hardening of the arteries. He was born near Glendale on July 18, 1839. He lived on a farm near Glendale until 10 years ago when he moved to E'town. He spent much time with his daughter, Mrs. L. W. VanMeter of Pensacola, Fla. He was a soldier in the Union Army and a member of the Democratic party. He served as a magistrate of Hardin County as well as a member of the Elizabethtown City Council. Member of the Christian Church. Survived by his wife, a son, Wm. Woodring and a daughter, Mrs. L. W. VanMeter. Burial at the Glendale Christian Church cemetery today.

THE BROWN PUSEY HOUSE WILL CELEBRATE THEIR 100TH ANNIVERSARY DURING 2022. THERE WILL BE SPECIAL EVENTS THROUGH OUT THE YEAR. PLAN ON CHECKING OUT THE EVENTS.

Dear Members:

I hope the spring has treated everyone well. As most of you know, I am an avid “arrowhead” hunter. Spring is the best season, as the rare (these days) field is plowed, and occasionally the Nolin River floods. A flood was my luck this year, and I found what appears to be a civil war bullet! This was a first for me, as I have not metal detected. It turned out to be a banner day for Catherine and I as we found several artifacts in our amateur archeological adventures! (Mrs. Bailey, my former English teacher will appreciate my use of alliteration). We will not meet in April, but the plan currently is to meet again in July.



Josh Cooper, President

HARDIN COUNTY HISTORICAL SOCIETY
P. O. Box 381
Elizabethtown, Kentucky 42702