

# The Easton • Milwaukee, Wisconsin



**Owner:**  
Klein Development

**Architect:**  
EUA

**Market:**  
Multi-Family

**Building Details:**  
166,000 SF  
96 Units  
161 Parking Stalls

**Website:**  
<https://theeastonapartments.com/>

**The Easton** is a five-story luxury apartment building that is conveniently located on a one-acre lot just south of Milwaukee's best restaurants and attractions on Brady Street.

The spacious building features high ceilings throughout, and each one and two-bedroom unit includes an attached balcony and ample natural light.

Bright common spaces and an equipped club room provide a sense of community. Fantastic amenities include a pool table room, multiple beautiful lobbies with fireplaces, large yoga and fitness rooms, conference room, outdoor patio and grill station and a large club room great for entertaining.

Underground and surface parking is conveniently located on the site to minimize congestion.

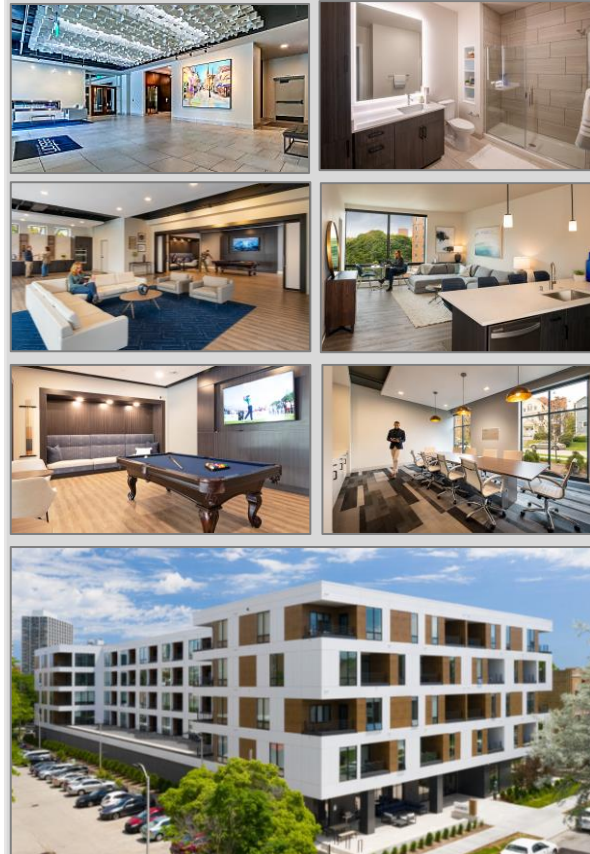

**Oxeland Group, LLC**

10001 Innovation Drive, Suite 100  
Wauwatosa, WI 53226  
[www.oxeland.com](http://www.oxeland.com)