

INSTRUCTION MANUAL

Dehumidifier

VG270

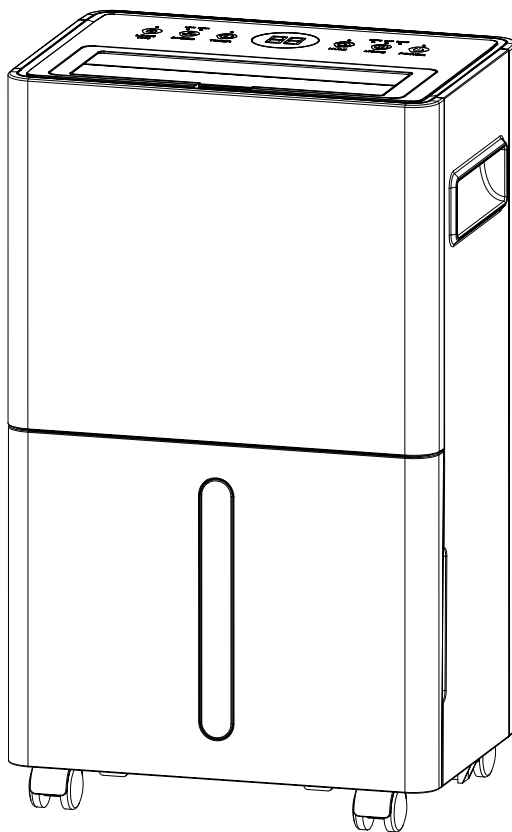

Please read this instruction manual carefully before operating and save it for future reference.

CONTENTS

IMPORTANT SAFETY INSTRUCTIONS	1
• Warning	1
• How to Use a Dehumidifier Effectively	2
MACHINE CONSTRUCTION	4
• Mainframe	4
OPERATION INSTRUCTION	5
• Key Description	5
• Function Set	6
• Precautions	8
• Drain Indication	8
• Use of the Water Tank	8
• Empty the Water Tank	9
• Continuous Drainage	9
• Filter Cleaning	10
• Fault Phenomenon	11
SAFETY PRECAUTIONS	12
SPECIFICATIONS	13



PLEASE DO NOT RETURN THIS ITEM TO THE PLACE OF PURCHASE

If you are missing any parts, experiencing ANY issues while operating the item, in need of a replacement, wish to return it, or require any assistance, please contact us at:



support@pluscent.shop



www.pluscent.shop

We assure you that we will respond within 24 hours.

01 IMPORTANT SAFETY INSTRUCTIONS

To prevent injury and property damage, the following instructions must be followed when using the dehumidifier.

Warning

- ▶ Do not place the dehumidifier near a heater.
- ▶ Do not use the dehumidifier near flammable gas or combustibles, such as gasoline, benzene, thinner, etc
- ▶ Always plug into a grounded outlet properly.
- ▶ Do not use it if the power cord is broken or damaged.
- ▶ Do not use the socket if it is loose or damaged.
- ▶ Do not modify its power cord length or share the outlet with other dehumidifiers.
- ▶ Never try to take apart or repair the dehumidifier by yourself.
- ▶ Do not place a heavy object on the power cord and make sure that the cord is not compressed.
- ▶ Do not place flower vases or other water containers on top of the dehumidifier.
- ▶ Do not operate or turn off the dehumidifier by plugging in or unplugging the dehumidifier. Use the control panel instead.
- ▶ Make sure to turn off and unplug the dehumidifier before cleaning.
- ▶ Do not clean the dehumidifier with water. If water enters the dehumidifier, turn off the dehumidifier immediately.
- ▶ Care should be taken when using the dehumidifier in a room: infants, children, and the elderly.
- ▶ Disconnect the power if strange sounds, odors, or smoke come from the dehumidifier.
- ▶ Hold the plug by the head when taking it out.
- ▶ Turn off and disconnect the power when not using the dehumidifier for a long time.
- ▶ Use a soft cloth to clean. Do not use wax, thinner, or a strong detergent.
- ▶ Be sure to replace the bucket properly after emptying it to prevent water from dripping on the floor.
- ▶ Do not climb on or sit on the dehumidifier.
- ▶ Never insert your finger or other foreign objects into grills or openings. Take special care to warn Children of these dangers.
- ▶ Children should be supervised to ensure that they do not play with the appliance.
- ▶ This appliance is not intended for use by persons (including children) with reduced physical, sensory, or mental capabilities or a lack of experience and knowledge, unless they have been given supervision or instructions for the use of the appliance by a person responsible for their safety.

■ How to Use a Dehumidifier Effectively

1. Before First Use

- The dehumidifiers may have been tilted or placed upside down during shipping. Leave the dehumidifier to stand upright for 24 hours so the oil in the compressor can settle from the move, not doing so can affect the performance or lifespan of the dehumidifier, as shown in the figure.
- Place the dehumidifier on a smooth, level floor that is strong enough to support the dehumidifier with a full bucket of water.
- The functioning temperature range is between 41°F(5°C) and 95°F(35°C).

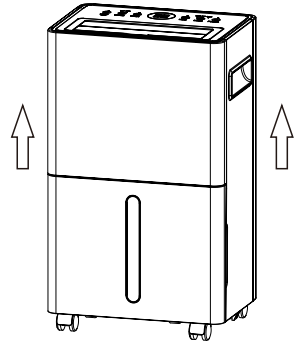

2. Make sure that the windows and doors are closed while the dehumidifier is operating.

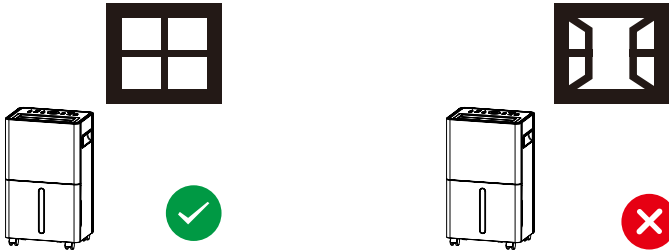

3. By placing the dehumidifier in the center of the room, you allow the air to circulate around the unit. Ideally, you should aim for about 18 inches of space around all sides of the unit.

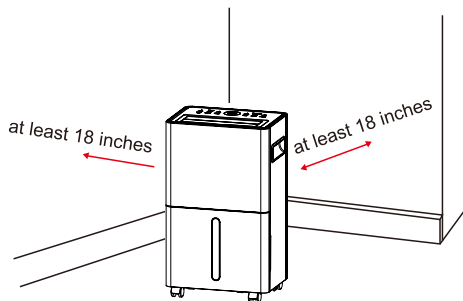

4. Don't place your dehumidifier too close to any furniture. This can further restrict the airflow around the unit.

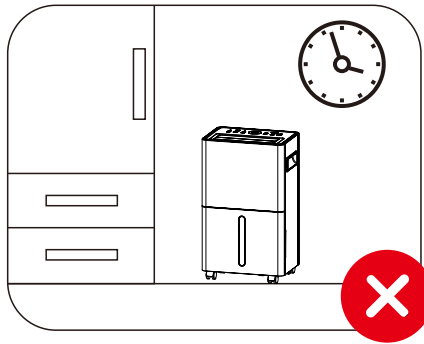
**IMPORTANT:**

The effectiveness of the dehumidifier can be influenced by different factors. One factor is the rate at which new, moisture-laden air enters the room and the amount of air circulating in and out of the area to be dehumidified.

For example, if a door to a basement is constantly opened, letting new, moisture-laden air into the room, dehumidification will take longer than if the door were kept closed. If the dehumidifier is in a room with a storage closet or cabinets, it will have little or no effect on drying the inside of the storage closet or cabinets unless there is adequate circulation of air in and out of these spaces. To dehumidify these spaces, open the storage doors or cabinet doors to allow air circulation. You may find that installing a second dehumidifier may be required for larger enclosed areas.

02 MACHINE CONSTRUCTION

■ Mainframe

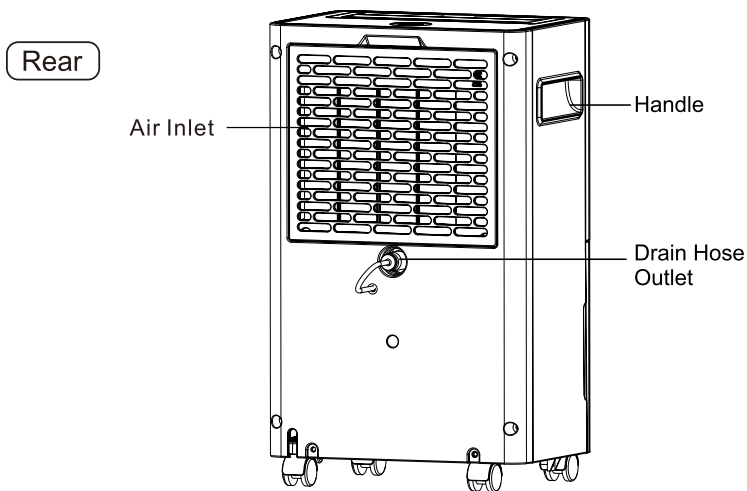
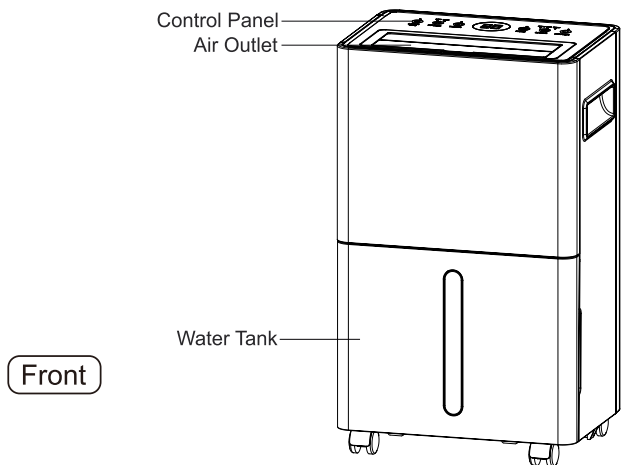

 NOTE: Do not cover or block the air inlet or outlet.

03 OPERATION INSTRUCTION

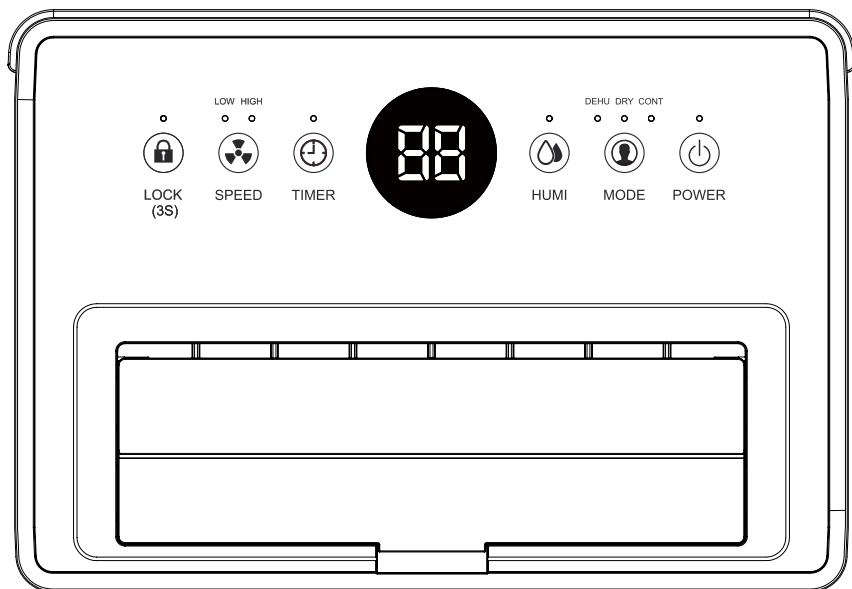

■ Key Description



Child lock key

For activation and deactivation of the child lock function.



Mode key

To choose the working mode.



Fan speed key

To switch the fan speeds.



Humidity key

For setting the humidity level.



Timing key







To set the time on the device, the setting range is 1~24h.





Power button

To turn the machine on/off.

■ Function Set

- ▶ **Power button:** This button is used to turn the machine ON/OFF with the indicator light showing "ON" or "OFF" when the corresponding mode is chosen (when the indoor humidity reaches the set value, the compressor will stop running, and the running indicator will flash at this time).
- ▶ **Fan speed setting:** There are two types of fan speed: high and low fan speed. When the device is turned on, press the  key to switch the fan speeds. The humidity and fan speed cannot be set in the drying mode, and the high fan speed is automatically selected.
- ▶ **Mode setting:** The device has three working modes: dehumidifying mode, drying mode, and continuous dehumidifying mode. In the power-on state, press the  button and the device will cycle through the dehumidifying, drying, and continuous dehumidifying modes. The working mode can be switched according to feature preference:
 - Dehumidification mode: humidity and fan speed can be set.
 - Drying mode: humidity and fan speed cannot be set.
 - Continuous dehumidification mode: the humidity cannot be set, but the fan speed can be set.
- ▶ **Humidity setting:** In dehumidification mode (other modes are invalid), press the  key once to enter the set humidity viewing state; " 88 " flashes to display the set humidity value. During the flashing period of " 88 ", press  to set the humidity value. The setting range is 30-80% RH, which can be set cyclically. Press the  key once, and the set humidity value will increase by 5%RH. After 5 seconds of no key operation or pressing other keys, it will automatically confirm and exit, and " 88 " displays the current ambient humidity. When the set humidity value is 30%RH, the continuous dehumidifying mode is activated.
- ▶ **Child lock settings:** In the on or off state, long press the  button for 3 seconds to control the activation and deactivation of the child lock. After entering the child lock state, all other key operations stop working. You can only release it by long pressing the  button for 3 seconds.
- ▶ **Power-down memory function:** If the equipment is suddenly powered off during normal operation, once it is turned back on, it will automatically return to the settings before the power off.

- **Timing settings:** If the timer is set when the device is off, the timer will be set to turn on; if it is set when the device is on, the timer will be set to turn off the device.
Press the  to set the timer. Each time you press it, the timer increases by 1h. The setting range is 1~24h, which can be set cyclically. Press and hold the  for a few seconds to continuously adjust the timer; when the timer is 00, it is invalid.
When the timer is valid, the indicator light "o" above the timing button will be on.
Press the  once, the display screen can show the remaining time on the timer, and the current humidity value will be automatically displayed after a few seconds.
- **Water full protection:** When the water tank is full, the compressor will immediately stop running. The indicator light "o" on the power button will flash, and after approximately 3 minutes, the water tank icon will appear on the display screen, flashing as a reminder. The device will emit a beep sound, and the fan will also stop running. Eventually, the device will automatically power off. Once the water tank is emptied and correctly placed back, the device will restart again.

Notice:

1. The water tank needs to be properly placed back, otherwise it will lead to water full protection.
2. During normal dehumidification, if the machine detects that the water tank is full, the compressor will immediately stop working. After approximately 3 minutes, the fan will also stop running, and the device will automatically power off.

- **Display status:** After the device is powered on, in standby (shutdown) mode, only the power light is on.
Timer status indicator "o": When the timer is set and valid, it will be on. However, if the timer becomes invalid, it will turn off.
Low fan indicator "o": When the fan speed is set to low, it will be on, otherwise it will be off.
High fan indicator light "o": When the fan speed is set to high, it will be on, otherwise it will be off.
Dehumidifying mode indicator "o": When the dehumidifying mode is selected and it is running, this indicator will be on, otherwise it will be off.
Drying mode indicator "o": When the drying mode is selected, it will be on, otherwise it will be off.

Continuous dehumidification mode indicator "o": When the continuous dehumidification working mode is selected, it will be on, otherwise it will be off.

When the ambient humidity reaches the set humidity level, the device will enter a standby mode and display the current humidity value on the screen, which will flash as an indicator.

Water full indicator "o": When the water tank is full, the indicator light " o " on the power button will flash, and about 3 minutes later, the water tank icon will appear on the display screen and flash as a reminder. Otherwise, the water tank icon will disappear.

During normal operation, " 88 " displays the current ambient humidity value.

■ Precautions

- ▶ The dehumidifier should not operate at a humidity setting higher than the ambient humidity.
- ▶ When the water full indicator is on, pour out the water in the water tank. Then put the emptied water tank back to its original position, and the machine can continue to work.
- ▶ When the machine stops, wait at least 3 minutes before restarting to avoid damage to the compressor.
- ▶ The usable ambient temperature range is 41 ~ 95 ° F (5 ~ 35 ° C).
- ▶ When the dehumidifier is operating, the operating compressor will generate heat, which will make the room temperature higher, which is a normal phenomenon.
- ▶ When you need to move this product, please lift it facing the front of the product, as shown in Figure a.

■ Drain indication

Drained water can be stored in a tank or externally drained using a hose.

■ Use of the water tank

The water dehumidified by this machine will automatically flow into the water tank.

When the water tank is full, the compressor will immediately stop running. The indicator light " o " on the power button will start flashing, and after approximately 3 minutes, the water tank icon will appear on the display screen, flashing as a reminder. The device will emit a beep sound. The fan will also stop running, and the device will automatically power off. At this point, please empty the water from the water tank.

■ Empty the water tank

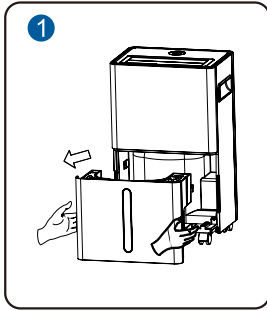

Hold the grooves on the left and right sides of the water tank with both hands at the same time, gently pull out the water tank. Please pay attention to keeping the water tank stable to avoid spillage.

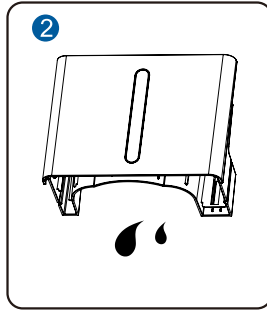

Invert the tank to empty the water.

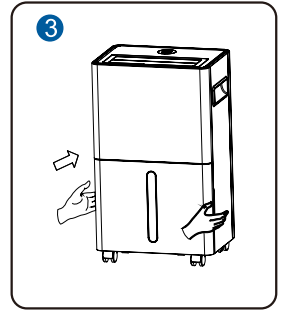

Put the tank back in place.

■ Continuous drainage

When you want to use this function, please unplug the power supply, pull out the rubber stopper, insert the water pipe into the continuous drain outlet, connect the power supply and start the machine. The water outlet of the water pipe should be more than 3.9inches (10cm) lower than the continuous drainage outlet, and the water pipe should not be bent to ensure smooth drainage.

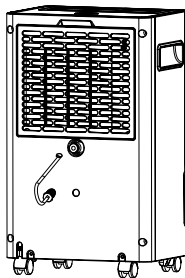

Rubber Stopper

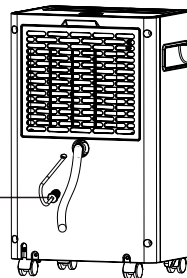

■ Filter cleaning

- ▶ Hold the filter screen as shown in the image and pull down the filter screen.
- ▶ Clean the filter: Use a vacuum cleaner to gently absorb the dust on the surface of the filter. If the filter is very dirty, wipe it with warm water and a mild detergent and dry it completely.
- ▶ As shown in the picture, insert the filter from bottom to top and insert it into the filter slot in the front shell.

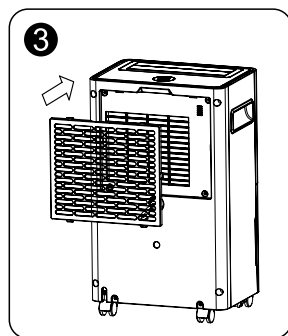
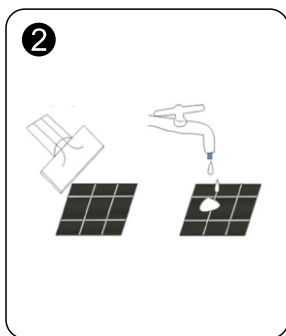
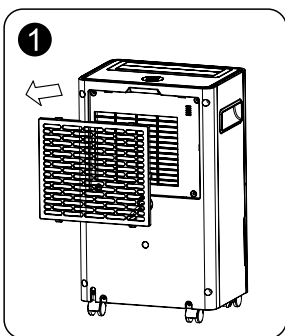

Fault Phenomenon

Fault Phenomenon	Cause Analysis	Approach
The machine is not running.	Is the power cord connected properly?	Connect the plug into the socket.
	Is the water tank in the proper position?	Drain the water from the tank and put it back in the correct position on the body.
	Is the room temperature above 95°F (35°C) or below 41°F(5°C)?	Because this product is not suitable for extreme environments, the machine will automatically protect and turn off, which is a normal phenomenon.
	Is the room temperature between 68°F (20°C) and 95°F(35°C)?	The machine will cool automatically, which is normal.
Poor dehumidification efficiency	Poor air flow?	There should be about 7.9 inches(20cm) of space around the product.
	Is the ambient humidity too low?	A normal phenomenon.
Loud noise when running	Air intake blocked?	Clean any dirt from the air inlet and outlet of the product.
	Is the machine placed at an angle?	Move the machine to a level surface.
The drain hose was properly connected and Water leakage or the water still drained to the tank.	Connected to the hose without pulling out the gray rubber plug of the water outlet.	Pull out the grey rubber plug of the water outlet before connecting the water pipe (please refer to the schematic diagram of continuous drainage function page in the manual for details)
	The pipe is not connected properly, the other end of the pipe is blocked and the water cannot be discharged properly.	Ensure that both ends of the water pipe are unimpeded after connecting the water pipe. Keeping the water pipe in an inclined state is more conducive to gravity drainage.
The dehumidifier is started but doesn't work.	The tank is full or not installed properly.	Empty the tank and reinstall it in place.
	The sensor float in the tank got stuck and didn't reposition properly.	Push the float down to the lowest position for the correct float position.
	The dehumidifier is in the defrosting process, it is normal the compressor ceases while defrosting process.	The defrosting process may take 15 to 20 minutes. When the defrosting is complete, the dehumidifier automatically starts to continue the dehumidification process.

Notice:

Please make sure that the air outlet is open before starting the machine, otherwise the machine will overheat. Never stop the machine directly by unplugging the power cord. If the problem persists, please shut down and unplug the power plug, and send it back to our company for repair.

04 SAFETY PRECAUTIONS



1. During usage, Do not place the machine on soft and uneven ground to avoid vibration or movement.

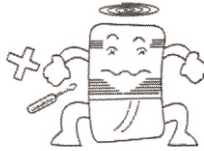

2. Do not use thin rods or hard objects to insert into the fuselage to avoid malfunction and danger.



3. When using, please keep the machine away from heat sources such as heaters and electric kettles to save electricity.



4. When using, please close all doors and windows to achieve the best dehumidifier effect.

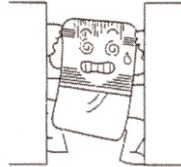

5. Do not place items at the front and back of the machine. If ventilation is blocked, the dehumidifier's effect will be diminished.



6. In case of power failure or long-term non-use, please unplug the power cord.



7. When cleaning the fuselage, gently wipe it with a damp cloth. Do not spray water directly.



8. Do not place any objects on the fuselage.



9. Please clean the filter once every two weeks (do not use hot water above 104°F(40 °C), alcohol, gasoline or any other fluid).



10. During continuous drainage, the drainage pipe must be placed horizontally, and must not be uneven and entangled.



11. After the filter is cleaned, please do not place it in direct sunlight to dry as this may cause deformation.



12. Before moving or transporting the machine, please pour out the accumulated water in the water tank.

05 SPECIFICATIONS

DEHUMIDIFIER	
MODEL	VG270
POWER SOURCE	120V~60Hz
RATED POWER	160W
RATED CURRENT	1.6A
MOISTURE REMOVAL CAPACITY(65°F,60%RH)	5.00 Pints/Day
MOISTURE REMOVAL CAPACITY(80°F,60%RH)	8.0 Pints/Day
MOISTURE REMOVAL CAPACITY(86°F,80%RH)	14 Pints/Day
MOISTURE REMOVAL CAPACITY(95°F,90%RH)	21 Pints/Day
MOTOR FLA	0.5A
MOTOR COMPRESSOR	RLA:1.5A LRA:8.5A
REFRIGERANT	R134a/80g(2.82ozs)
MAXIMUM ALLOWABLE PRESSURE	4.6MPa
MAXIMUM OPERATING PRESSURE HIGH	1.7MPa
MAXIMUM OPERATING PRESSURE LOW	0.7MPa

