

Solar NEO Flood Light



FEATURES

- Single or Double Flood Light Solar Assembly
- Dark Gray finish
- Wide lighting distribution
- Solar Panel Remote Mounted up to Thirty (30) feet
- Charge Duration Six (6) Hours
- Fifteen (15) Hour Output Duration
- Various Solar Panel Mounting Options

APPLICATIONS

- Signage
- Wall Washing
- Security

CONSTRUCTION

The Solar Neo Flood Light is made with an Aluminum Alloy housing with a Dark Gray finish. Paired with a Lithium Iron Phosphate Battery and remote Solar Panel, this assembly is perfect for all your solar flood lighting needs.

WARRANTY

- Limited Ten (10) Year Warranty standard

For more information regarding the limited warranty please contact the factory at (844) 202-5606 or email Customer Service at LEDCustService@dascom.com.

ORDERING GUIDE

SERIES	WATTAGE	BEAM ANGLE	CRI	CCT	FINISH	VOLTAGE	ASSEMBLY ¹	FLOOD OPTIONS	PANEL MOUNT
SFL-5	040 40W 060 60W	W 100 DEGREE	8 ≥80	40 4000K 50 5000K	DG DARK GRAY	L 12-24V	M1 SINGLE ASSEMBLY M2 DOUBLE ASSEMBLY	- TRUNNION MOUNT SPF 2-3/8" SLIPFITTER GS GROUND STAKE SHD GLARE SHIELD	WM WALL MOUNT TPM TOP OF POLE MOUNT

¹ "M2" option only available for 40W model.



www.sonarayled.com

PROJECT

DATE

TYPE

NOTES

REV: 24 0101 0000

Solar NEO Flood Light

SPECIFICATIONS

LED SPECIFICATION			4000K		5000K		FIXTURE EPA* (ft²)	SOLAR PANEL EPA* (ft²)	BUG	FIXTURE WEIGHT (lbs.)	SOLAR PANEL WEIGHT (lbs.)
MODEL	WATTS	OPTIC	LUMENS	EFFICACY	LUMENS	EFFICACY					
SFL-5040	40	W	5,440	136 lm/W	5,680	142 lm/W	0.87	5.37	B2-U1-G0	7.0	25.0
SFL-5060	60	W	8,160	136 lm/W	8,460	141 lm/W	0.87	9.28	B3-U1-G0	7.0	43.0

* EPA Ratings listed assume fixture is mounted horizontally. EPA rating will vary based on mounting angle.

BATTERY SPECIFICATION	SFL-5040-M1	SFL-5040-M2	SFL-5060-M1
BATTERY TYPE	Lithium Iron Phosphate		
NOMINAL CAPACITY (AH)	30	60	40
BATTERY LIFE	Three (3) Years		
CYCLE LIFE	> 80% @ 25°C @ 2000		
NOMINAL VOLTAGE (V)	12.8		
STANDARD DISCHARGE CURRENT (A)	6.0	12.0	12.0
DISCHARGE CUT-OFF VOLTAGE (V)	8.0		
MAX CHARGE VOLTAGE (V)	21.6	20.4	20.4
OVERCHARGE DETECTION VOLTAGE (V)	3.9	3.65	3.65
OVERDISCHARGE DETECTION VOLTAGE (V)	2.0	2.35	2.35
OVERDISCHARGE DETECTION CURRENT (A)	20-40	36-50	36-50

PANEL SPECIFICATION	SFL-5040-M1	SFL-5040-M2	SFL-5060-M1
SOLAR PANEL RATED POWER (W)	65	115	115
NUMBER of SOLAR PANELS	1	1	1
MAXIMUM POWER VOLTAGE (Vmp V)	18	17	17
MAXIMUM POWER CURRENT (Imp I)	3.61	6.76	6.76
SHORT-CIRCUIT CURRENT (Voc)	21.6	20.4	20.4
SHORT-CIRCUIT CURRENT (Isc)	3.9	7.3	7.3
SYSTEM VOLTAGE (V)	1000	1000	1000
TOLERANCE	+/-3%	+/-3%	+/-3%
NUMBER OF SOLAR CELLS	34	22	22
DIMENSIONS (INCHES)	42.4 x 15.2 x 1.2	73.3 x 15.2 x 1.2	73.3 x 15.2 x 1.2

SPECIFICATION		VALUE
PERFORMANCE	Power Consumption (W)	40 / 60
	Lumens Delivered (lm)	5,440 - 8,460
	Efficacy (lm/W)	136 - 142
	CRI	≥80
	Color Temperature (K)	4000 / 5000
	Full Charge Duration (hr)	6
	Lighting Output Duration (hr)	15
OPTICS	Input Voltage	12-24V
	Dimming	Non-dimmable
	Photocell Sensor	Yes, integrated in Solar Panel
	Motion Sensor	Yes
OPTICS	Beam Angle	100
	Glare Shield	Yes, optional
INSTALLATION	Standard Mount	Aluminum Yoke Mount
	Optional Mount	Ground Stake Mount, Slipfitter Various Solar Panel Mounts
	Tilt	180°+ Vertically
CERTIFICATIONS	IP	65
	Environment	Outdoor / Wet
	Charging Operating Temp.	-20°C ~ +55°C / -4°F ~ +131°F
	Discharging Operating Temp.	-30°C ~ +60°C / -22°F ~ +140°F
	Warranty	10 year

Solar NEO Flood Light

FLOOD LIGHT MOUNTING

SPF - 2-3/8" SLIPFITTER ADAPTER

Slipfitter adapter helps mount flood light to a broad range of poles and tenons.



GS - GROUND STAKE

A pair of 6" Ground Stake Spikes help securely mount the Flood Light in soft surfaces.



SHD - GLARE SHIELD

Glare Shield to focus light and eliminate unwanted uplight.

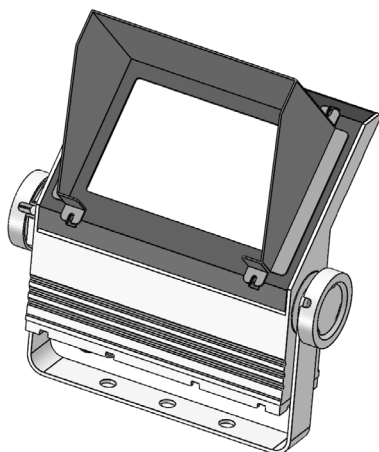

SOLAR PANEL MOUNTING

TPM - TOP OF POLE MOUNT

The TPM includes an arm piece for mounting the assembly on a pole. Both the flood mount and solar panel mount slip over any 2-3/8" or less tenon.



WM - WALL MOUNT

Two-piece mounting bracket to install the flood light and solar panel on any wall or flat surface.



Solar NEO Flood Light

DIMENSIONAL DRAWINGS

SFL-5040 & SFL-5060

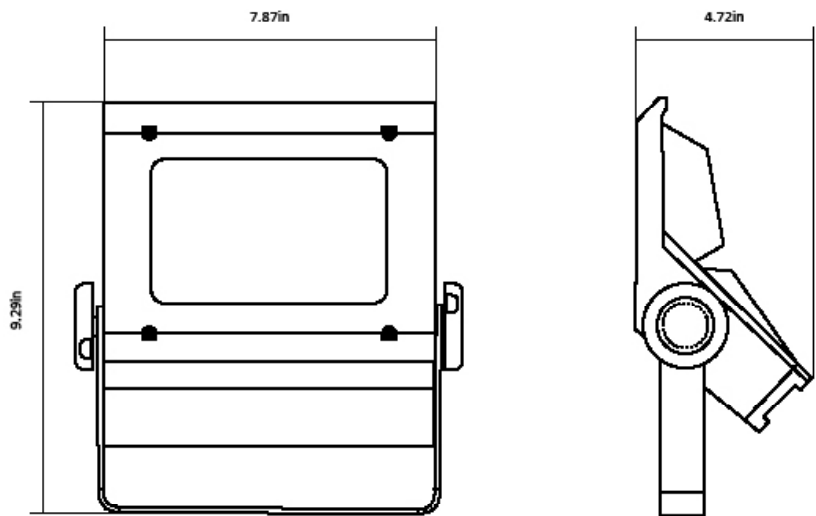

65W SOLAR PANEL

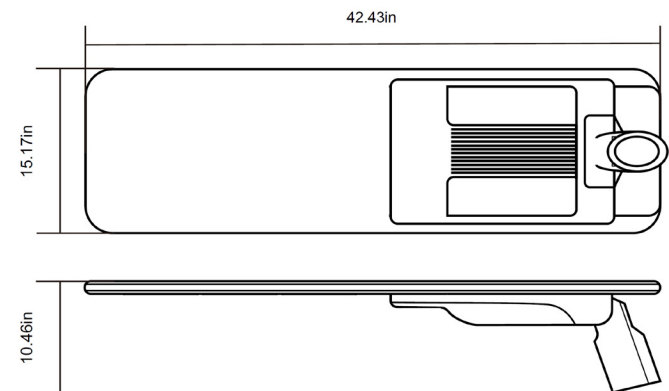

115W SOLAR PANEL

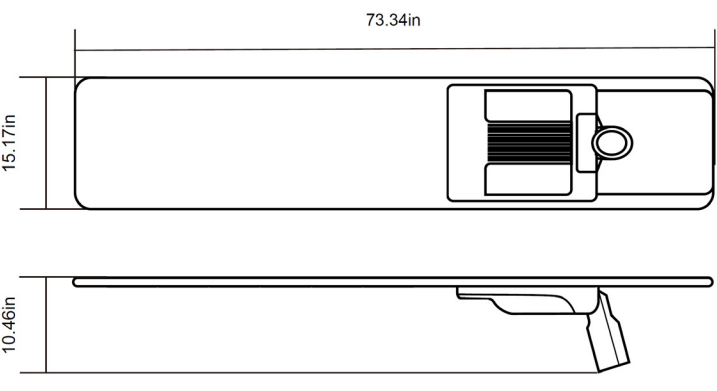

PHOTOMETRICS

SFL-5040

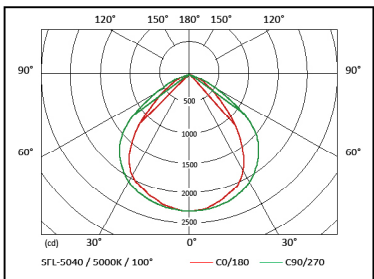

SFL-5040 / 5000K / 100°		
1	2364	193
2	591	387
3	263	580
4	148	773
5	95	966
H (m)	F (lx)	D (cm)

SFL-5060

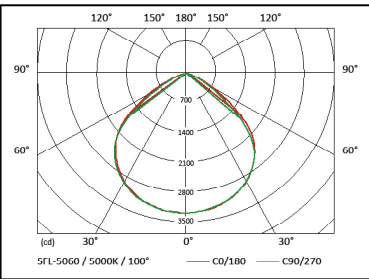

SFL-5060 / 5000K / 100°		
1	3361	252
2	840	504
3	374	755
4	210	1007
5	135	1259
H (m)	F (lx)	D (cm)

Solar NEO Flood Light

CONTROLLER



1. Magnet Power Switch

Before mounting this unit onto a pole, remove the magnetic button from the sensor.



2. Battery Power Indicators

The (4) blue LEDs in the upper row represent battery level.
1 indicator = < 25%
2 indicators = 26% - 50%
3 indicators = 51% - 75%
4 indicators = 76% - 100%



3. Status Indicators

SOLAR CONTROLLER STATUS INDICATORS		
Indicator Light	Status	Description
(1) YELLOW (Motion)	ON	Motion Detected
	OFF	No Motion Detected
(2) GREEN (LED)	ON	Light ON
	OFF	Light OFF
	FLICKER	LED Short Circuit
(3) BLUE (Battery)	ON	Battery Charged
	OFF	Battery Not Charged
	FLICKER	Battery Undervoltage
(4) RED (Panel)	ON	Battery Charged 100%
	OFF	Solar Panel Without Output
	FLICKER	Solar Panel Charging
(5) RED & GREEN & BLUE	CYCLE	Poor Cable Connection



Solar NEO Flood Light

REMOTE CONTROL

The Solar NEO Flood Light is equipped with a 433 remote controller. Each controller can reach a distance of 75 feet no matter the obstacles in between. A single controller can also manage multiple solar units.

Four lighting modes are available for the Solar NEO Flood Light. The mode should be selected according to the season for optimal charge and output.



User Manual for Remote Controller

DEMO: No matter the time of day, the light will turn ON for 1 minute.

OFF: No matter the time of day, the light will turn OFF.

L: At night, the light will turn on for (15) hours at 100% output.

T: At night, the light will turn on for (4) hours at 100% + (11) hours at 25%.

M: At night, (15) hours using motion sensor control.

U: At night, (4) hours at 100% + (11) hours using motion sensor control.

A: Cycle through CCT options 3000K – 4000K – 5000K

B: Jump to 4000K CCT

