



## TECHNICAL BULLETIN | RE: Surfaces Series Fabric Wrapped Acoustical Panels

### PRODUCTS COVERED

Surfaces Series Fabric Wrapped Acoustical Panels

### Installation

1. Layout the panel location on the wall.
2. Fasten impaling clips to the wall. Note: Impaling clips only need to hold the panel in place for 48 hours while the adhesive cures.
3. Use only water-based, heavy-bodied adhesive. Suggested types are Titebond GREENchoice™ Acoustical Ceiling Tile Adhesive, WW Henry 440 Cove Base Adhesive or similar. It is recommended to do a “test bond” with scrap materials and mounting surfaces. **Do not** apply adhesive in a “ribbon” pattern.
4. Walls must be primed or painted with no grease, dust or dirt. High gloss paints should be sanded to ensure bonding of adhesive. Walls should be even, with no protruding nails or screws.
5. Before proceeding with next steps, the panels can be attached to the impaling clips to “test fit” positions. Panels can then be removed to apply the adhesive following steps described below.
6. With a putty knife, “prime” the back of the panel by applying a thin coat of adhesive, approximately 4”x4” square, 18” O.C. across the back of the panel. NOTE: Use only heavy-bodied, water-based adhesive.
7. Place adhesive dabs (about the size of a large egg) on each 4”x4” sized area.
8. Position the wall panel at the installation location. Press the panel straight to the wall, ensuring that the clips are embedded in the back.
9. Due to variation in fiberglass thickness, some shimming may be required to align the panel edges.

**Contractor’s Tip:** When mounting panels to the wall, it is best to start with the top row and work your way down. This will help avoid any adhesive/materials from falling onto fresh finished panels, if there happens to be any installation errors.

*(See next page for materials illustrations...)*

## Impaling Clip

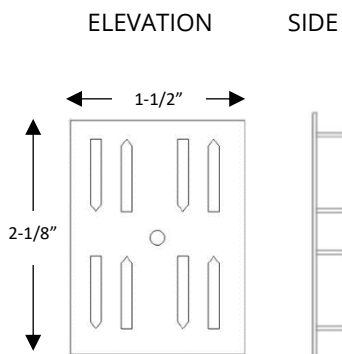

## Adhesive

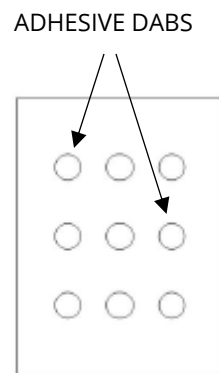

## Cross Sections

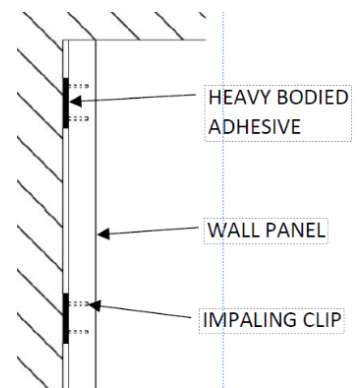

## Limitations

1. Surfaces Acoustic Panels are intended for interior use only.
2. Panels must not be used to support any other materials or equipment, including light fixtures, speakers, air diffusers, or security cameras.
3. Installation of the products shall be carried out where the temperature is between 32°F (0°C) and 85°F (30°C) and relative humidity levels not to exceed 80%. These temperature conditions must also be met throughout the lifetime of the warranty. It is necessary for the installed space to be enclosed and for the HVAC systems to be functioning and in continuous operation. All wet work (plastering, concrete, etc.) must be complete and dry. Such installations shall not be exposed to abnormal conditions including, but not limited to: fire, smoke, chemical fumes, vibrations, presence of standing water, or moisture and excessive humidity coming into direct contact with the ceiling, such as could result from building leaks, condensation, splashing of water or any other sources of abnormal conditions.

## Job Site Handling and Storage

1. Prior to installation, Surfaces Acoustic Panels must be stored in a dry and clean area, enclosed and protected from possible damage by rain, snow, and excessive moisture, and kept between 32° F and 85° F.
2. Surfaces Acoustic Panels must be stored flat on the floor and level. DO NOT STACK OR STORE ON END OR EDGE DAMAGE MAY OCCUR.