

CAST-IN SOCKET FOR FIXING & FASTENING

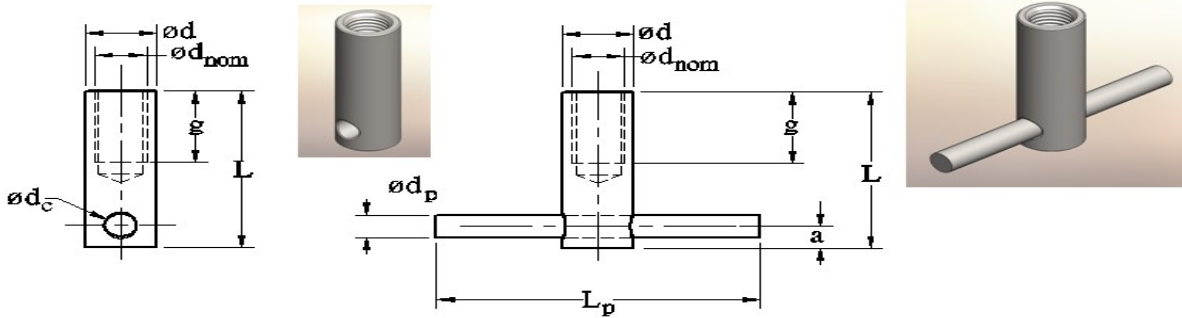

Table 1. Product Specification

Anchor Size	Φd (mm)	L (mm)	Thread d_{nom} (mm)	g (mm)	a (mm)	Φd_p (mm)	Lp (mm)	S.W.L (KN)	Packing Qty
37xx-06-40	10	40	M6x1.0	16	6	4		2	200
37xx-06-40-CP							40		
37xx-08-40	12	40	M8x1.25	16	8	6		3	200
37xx-08-40-CP							40		
37xx-10-44	16	44/50	M10x1.5	16/22	9	8		4	100
37xx-10-50									
37xx-10-44-CP							40/50		
37xx-10-50-CP									
37xx-12-55	18	55	M12x1.75	25	10	8		5	100
37xx-12-55-CP							60		
37xx-14-60	20	60	M14x2.0	28	10	10		8	50
37xx-14-60-CP							100		
37xx-16-70	22	70	M16x2.0	32	11	10		12	50
37xx-16-70-CP							100		
37xx-20-80	25	80	M20x2.5	38	12	12		20	40
37xx-20-80-CP							100		
37xx-24-100	32	100	M24x3.0	50	12	12		25	20
37xx-24-100-CP							100		
37xx-30-120	42	120	M30x3.5	60	12	12		40	10
37xx-30-120-CP							120		

*Remark: For material code, xx = 40, 50, 55, 60 & 80 etc