

1

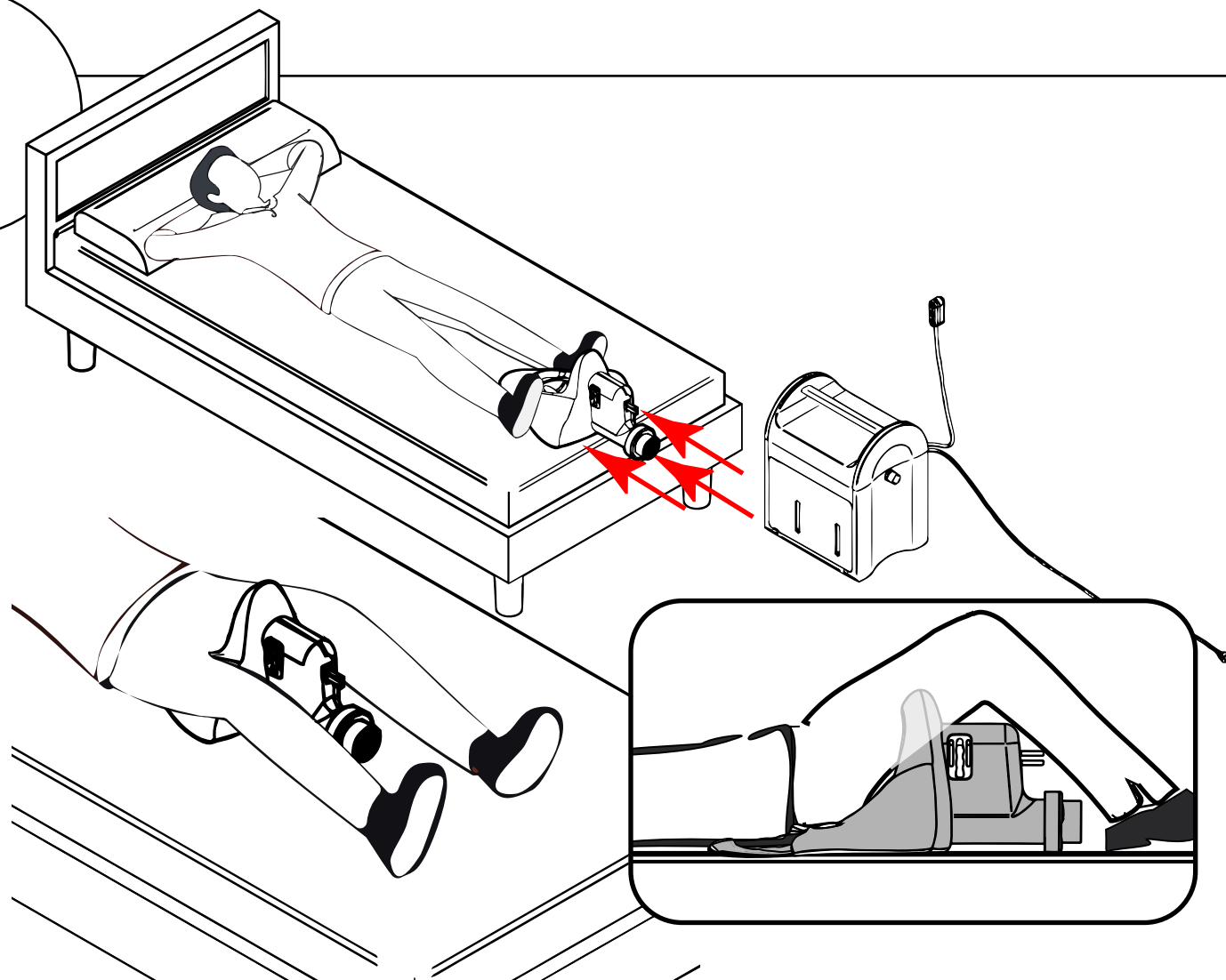

With slightly raised legs, slide the wedge of the Bedet under the user

2

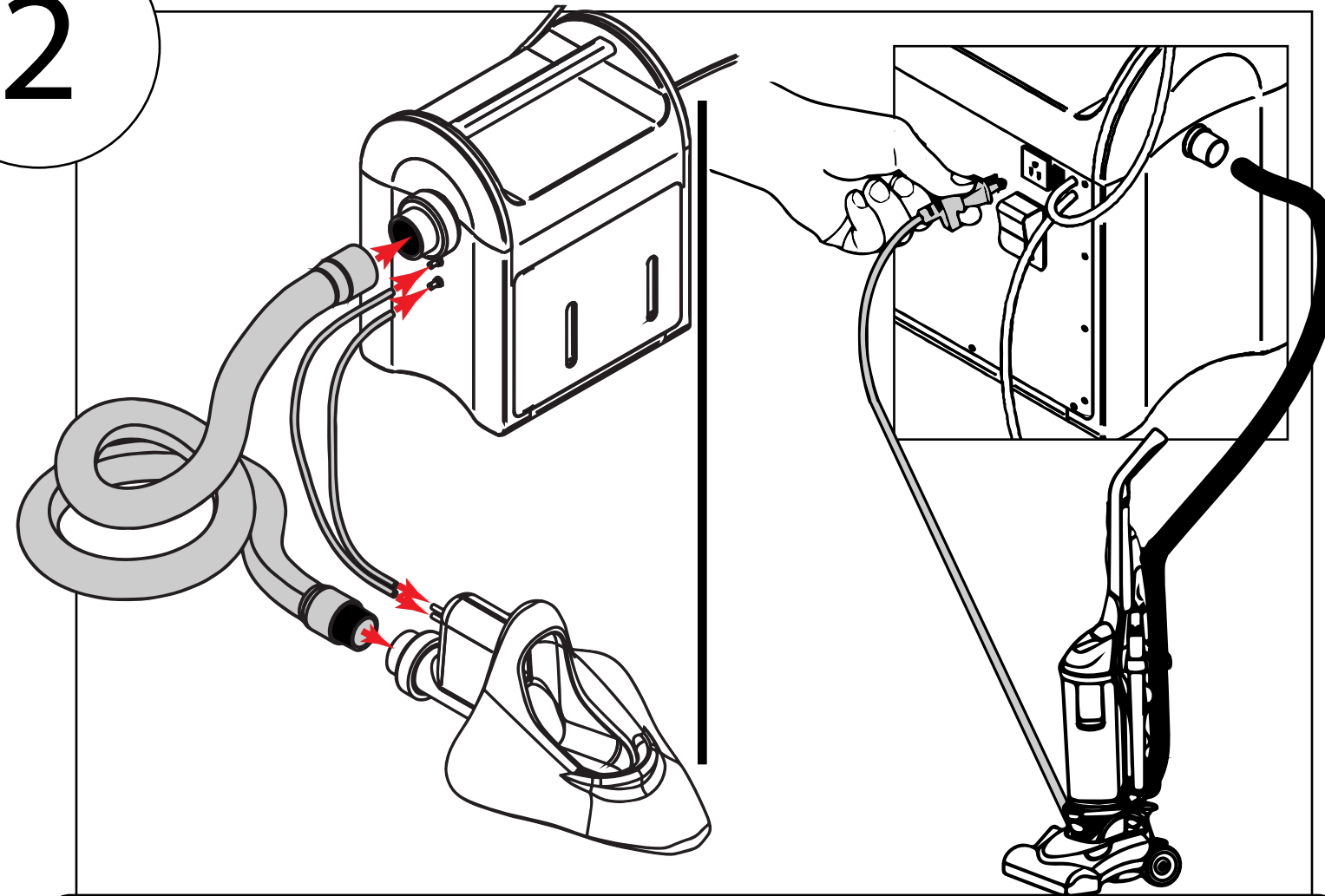

Connect the hoses to the bedpan, plug in any generic vacuum to back power outlet

3

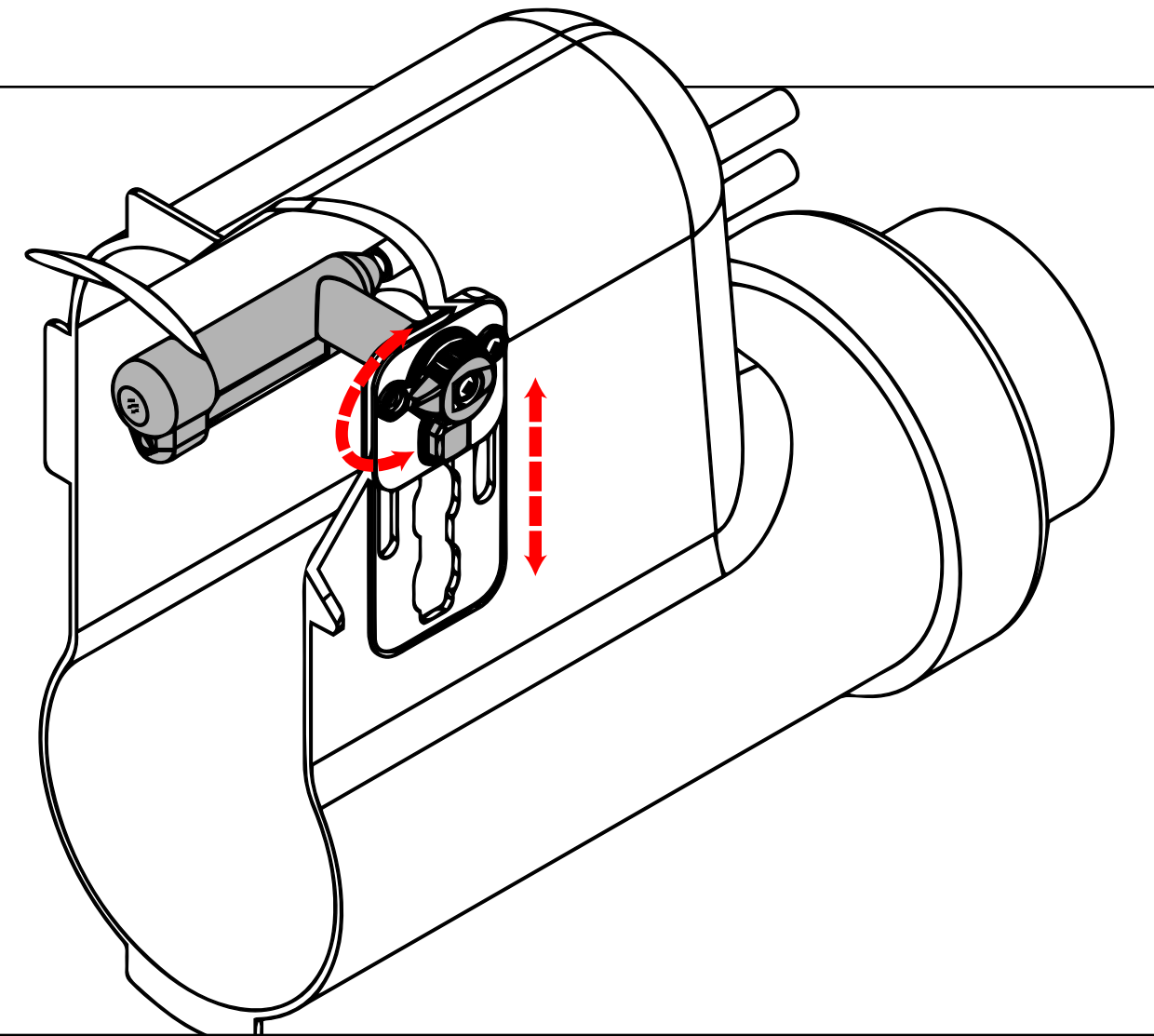

Adjust the angle and elevation of the nozzle

4

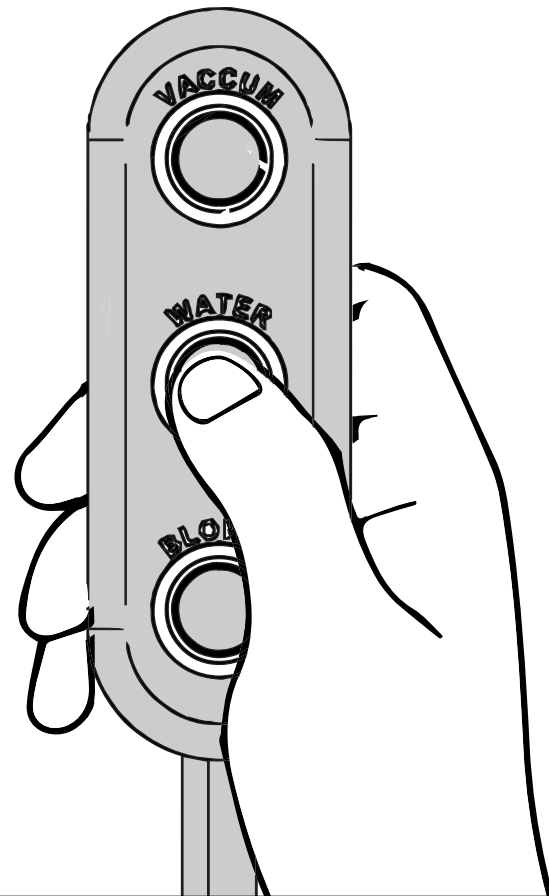

With remote in hand, provide privacy as needed. Turn on the vacuum to direct the flow of waste to a portable container

5

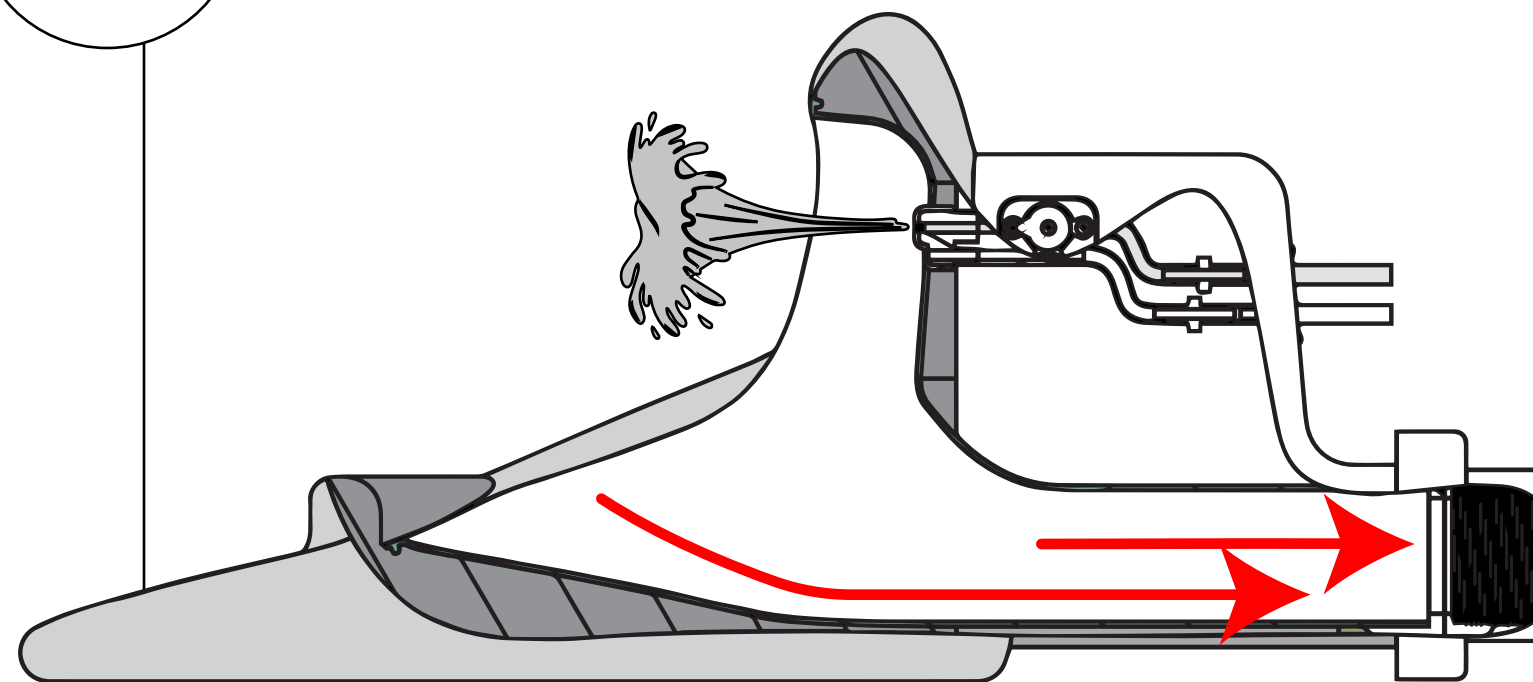

Activate water and air-drying features when finished for a fresh clean

6

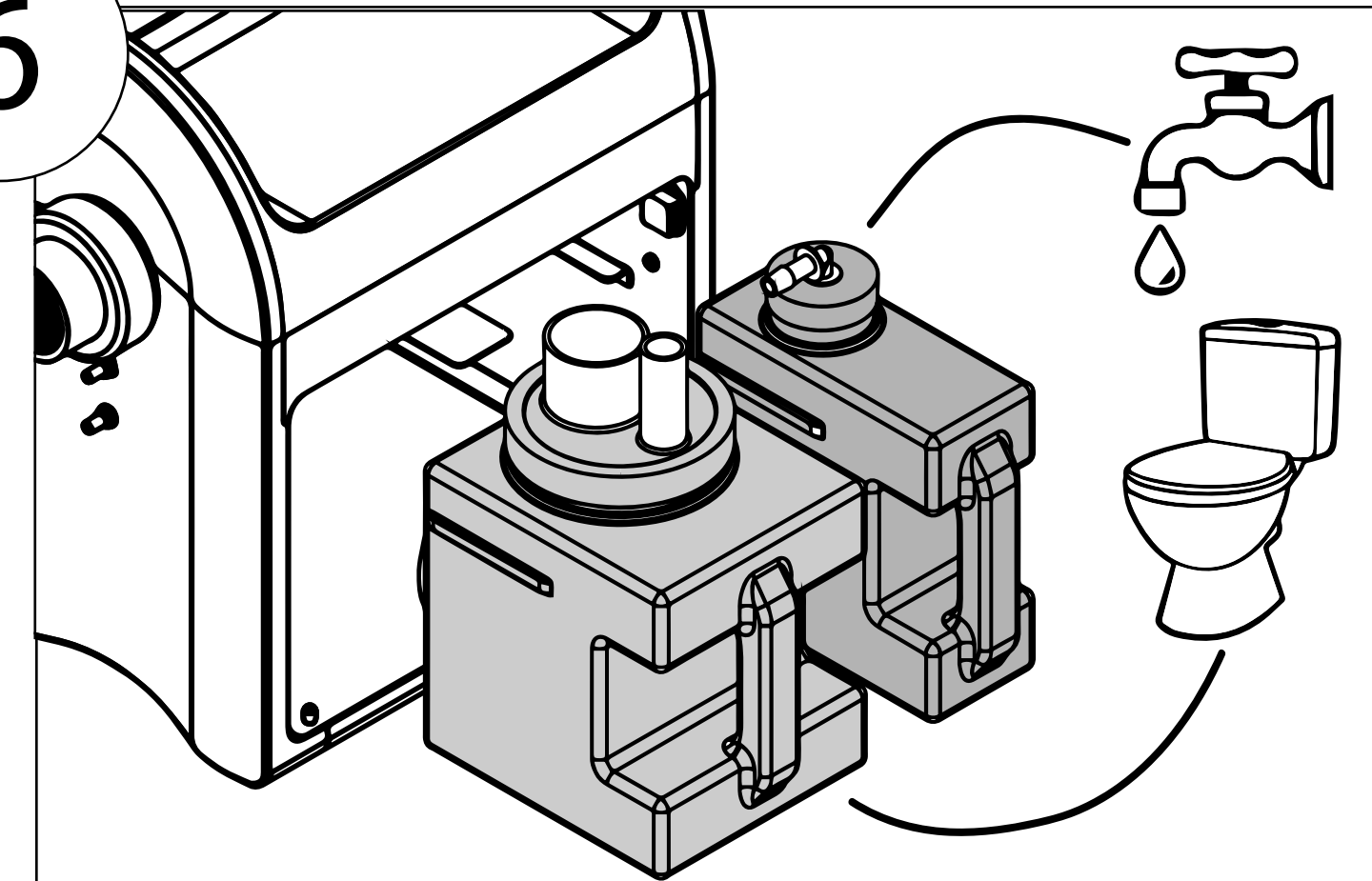

When done, remove the bedpan, empty waste as needed, and refill the clean water