



OFFSHORE MARINE CONTRACTORS, INC.

Toll Free: 877-632-7927 | Local: 985-632-7927

- [Home](#)
- [Liftboat Overview](#)
- [Liftboat Calc](#)
- [Liftboat Fleet](#)
- [Safety](#)
- [Gallery](#)
- [Employment](#)
- [Announcements](#)
- [Contact Us](#)

Main Office

133 West 113th St.
Cut Off, LA 70345
Phone: 985-632-7927
Fax: 985-632-3704

Tram Shipyard

24964 Hwy. 1
Golden Meadow, LA 70357



L/B Jamie Eymard

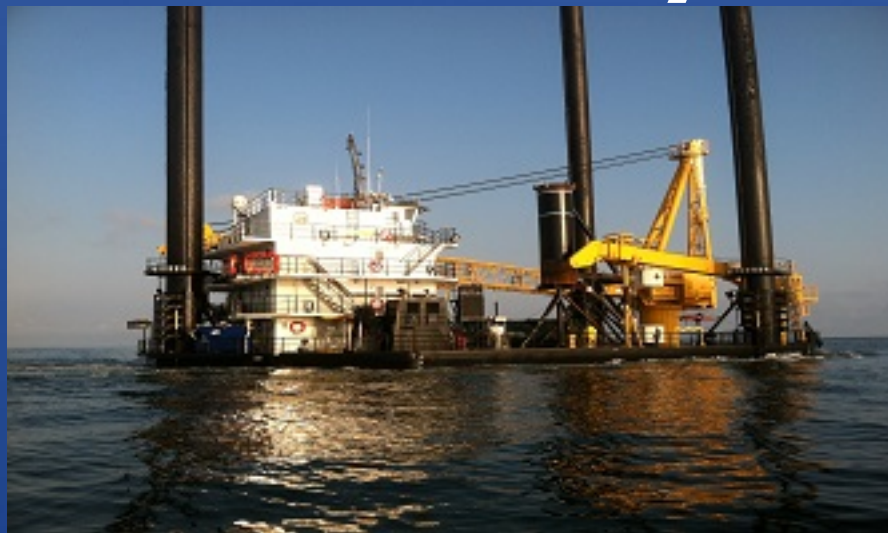

Dimensions

- Length (overall): 137'0"
- Beam (Overall): 74'0"
- Depth (Barge Only): 10"
- Design Draft: 7.57'

Hull Characteristics

- Tonnage: Under 200 tons
- Usable Deck Area: Approx 6,000 Sq Ft
- Deck Load: 1,000,000 lbs

Legs

- Number: 3
- Length: 215ft
- Diameter: 72"

Cranes

- Main: 175 ton w/ 100' boom
- Aux: 50 ton w/ 100' telescoping boom

Living Quarters

- Berths: 36 (Not Including Crew)

Capacities

- Fuel: 16,303 US Gal
- Potable Water: 18,992 US Gal

Engines

- Main: C32/1,000 hp
- Generators: 2 ea CAT C 6.6 199Kw
- Est. Speed: 6 Kts in Max 5ft Seas

Jacking

- Max Water Depth: 175' with 15' air gap
- Jacking Speed: 8ft per minute
- Max Sea Conditions: 5ft Seas

Misc. Equipment

- Sewerage: Seahorse
- Air Compressor: 2ea 80 gal Receivers

Certifications

- U.S. Coast Guard 46CFR Subchapter "L"
- Lloyds Load Line

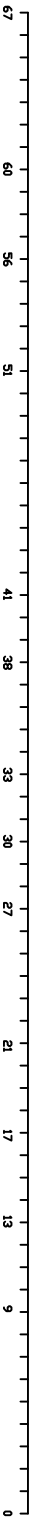

GENERAL ARRANGEMENT MAIN DECK

SCALE 3/16" = 1'-0"

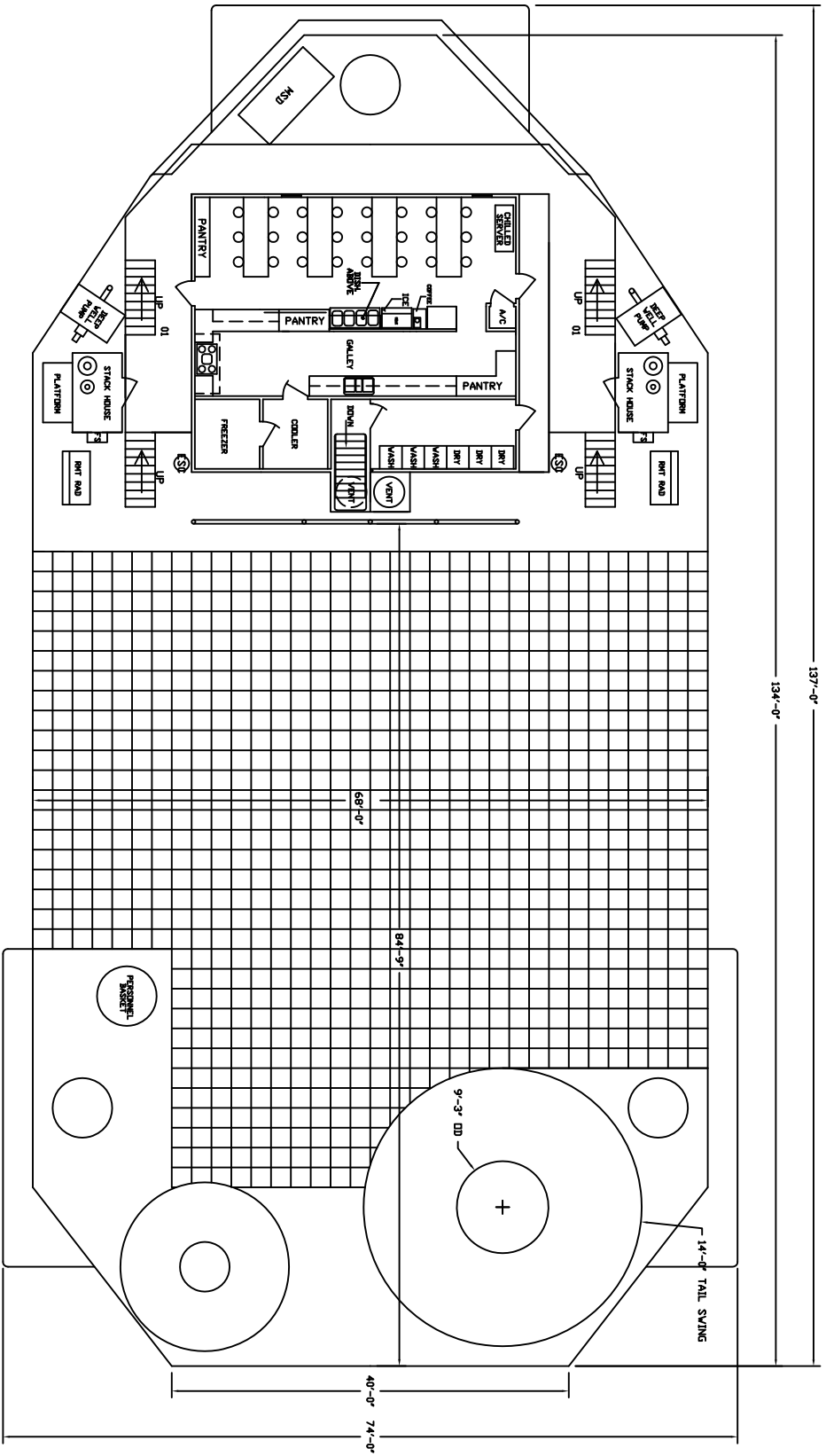

DYNAMICS MARINE, INC. 1000 W. WILSON, MS 39191 GALVESTON, TX 77550-2869	
MARINE INDUSTRIAL FABRICATION	
OFFSHORE MARINE CONTRACTORS	
CLASS 215 LIFTBOAT	
GENERAL ARRANGEMENT MAIN DECK	
DATE: 2MAR11	APPV: _____
BY: GILLY	NO: GA-03

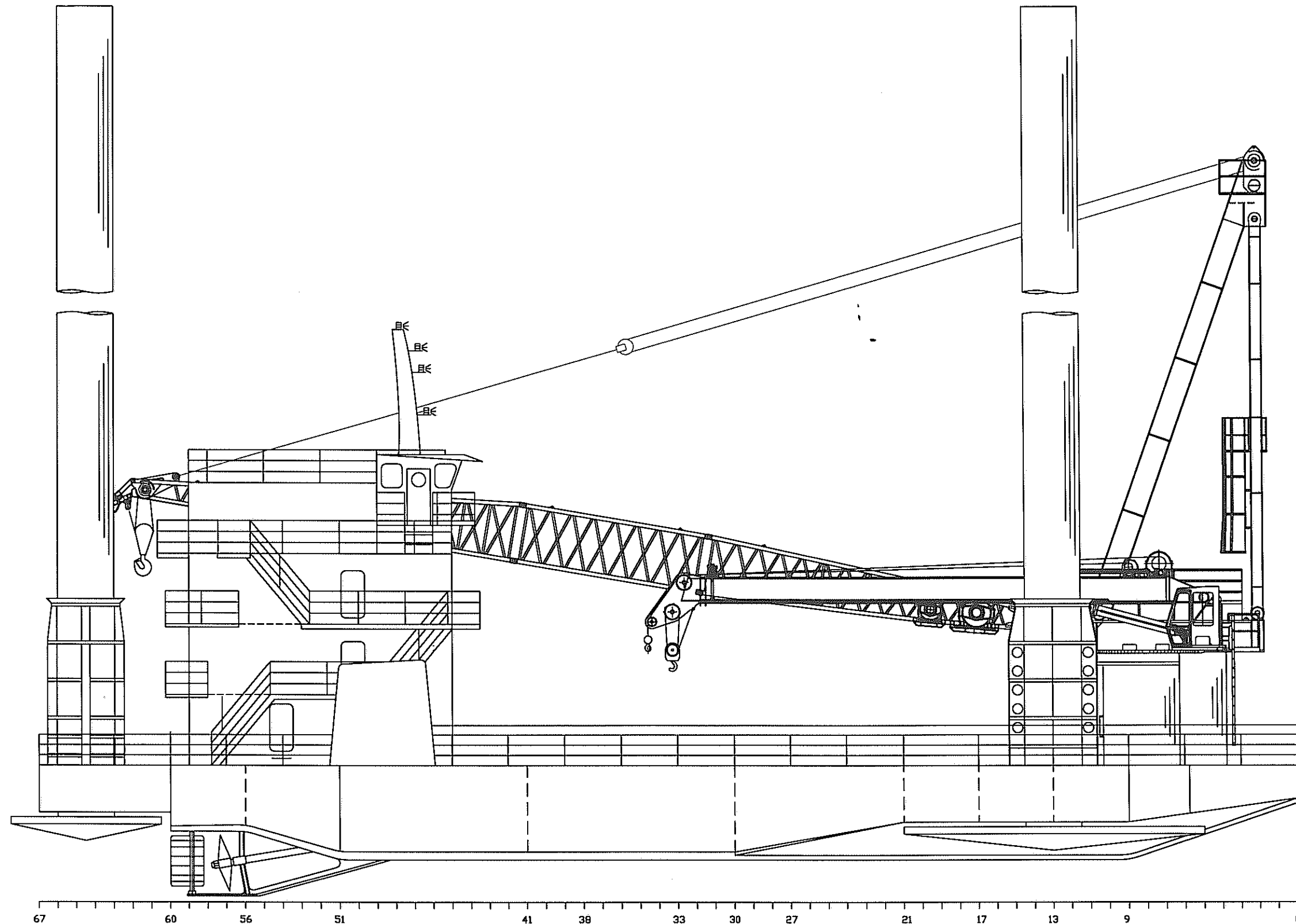

GENERAL ARRANGEMENT MAIN DECK

SCALE 3/16" = 1'-0"

GENERAL INFORMATION

HULL LENGTH	120'-0"
HULL WIDTH	68'-0"
HULL DEPTH	10'-0"
LENGTH OVERALL	137'-0"
WIDTH OVERALL	74'-0"
FOOTING LENGTH	32'-0"
FOOTING WIDTH	16'-0"
FOOTING DEPTH	2'-6"
LEG LENGTH OVERALL	215'-0"
LEG DIAMETER	72"
LEG THICKNESS	1"
LEG MATERIAL	API 5L-X65
JACKS PER LEG	QTY TEN
JACKING RATING / JACK	65.75 S-TONS
HOLDING RATING / JACK	87.67 S-TONS
JACKING RATING / LEG	657.50 S-TONS
HOLDING RATING / LEG	876.7 S-TONS
TOTAL JACKS	QTY 30
TOTAL JACKING RATING	1972.5 S-TONS
TOTAL HOLDING RATING	2630.0 S-TONS
FUEL OIL CAPACITY	14,753 GAL
POTABLE WATER CAPACITY	18,992 GAL
JACKING HYDRAULIC OIL	3688 GAL
CRANE HYDRAULIC OIL	3714 GAL
ACCOMMODATION CREW	8 MEN
ACCOMMODATION VIP	2 MAN
ACCOMMODATION PACS	34 MEN
ACCOMMODATION TOTAL	44 MEN

REVISIONS

DYNAMICS MARINE, INC.
2483 LITTLE LANE- NE, WESSON, MS 39191
601-695-4363

MARINE INDUSTRIAL FABRICATION

DYNAMICS MARINE, INC. CLASS 215
CLASS 215 LIFTBOAT
GENERAL ARRANGEMENT MAIN DECK

DATE: 2MAR11	APPV:
BY: GILLY	NO: GA-03

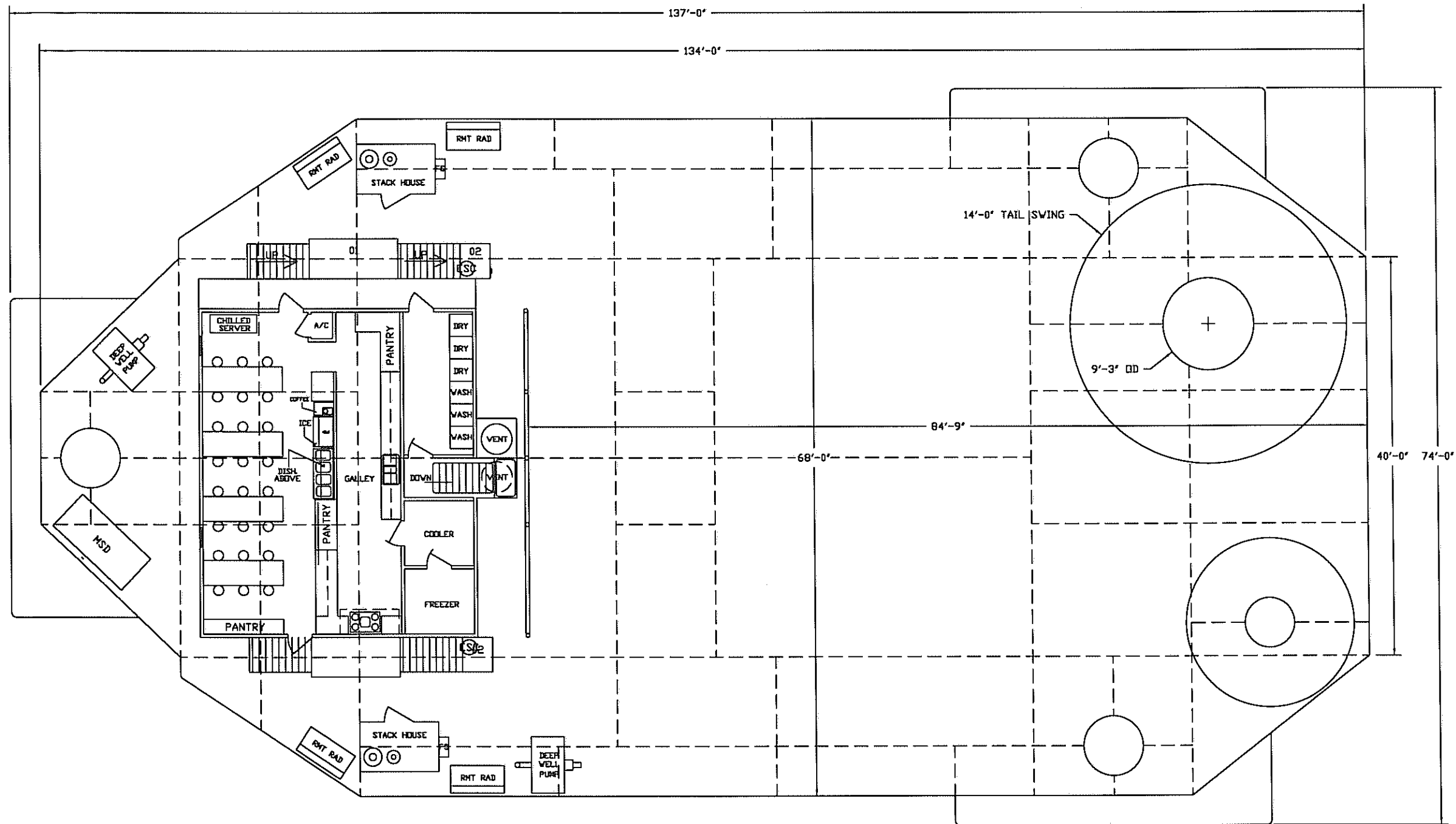

67 60 56 51 41 38 33 30 27 21 17 13 9 0

GENERAL ARRANGEMENT MAIN DECK

SCALE 3/16" = 1'-0"

REVISIONS

DYNAMICS MARINE, INC.
2483 LITTLE LANE - NE, WESSON, MS 39191
601-695-4363

MARINE INDUSTRIAL FABRICATION

DYNAMICS MARINE, INC. CLASS 215
CLASS 215 LIFTBOAT
GENERAL ARRANGEMENT MAIN DECK

DATE: 2MAR11 APPV:

BY: GILLY NO: GA-03 

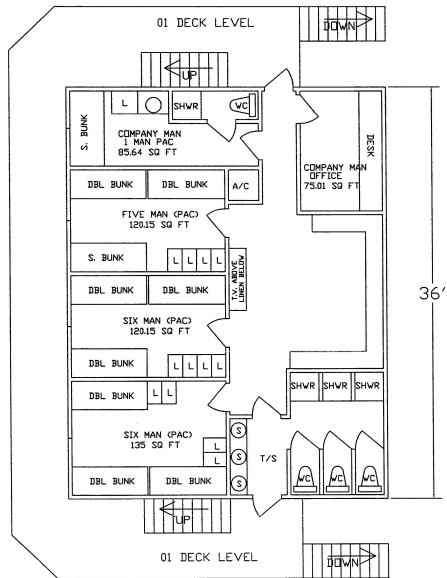

GENERAL ARRANGEMENT 01 LEVEL

SCALE 1/4" = 1'-0"

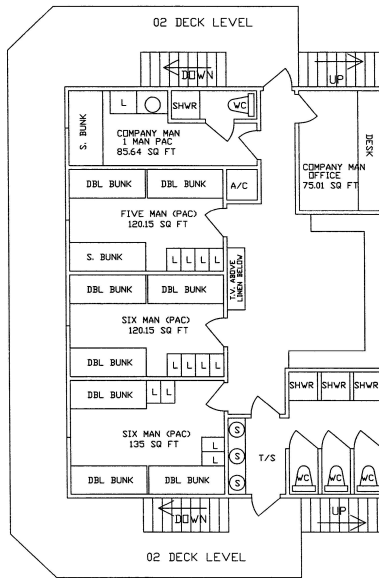

GENERAL ARRANGEMENT 02 LEVEL

SCALE 1/4" = 1'-0"

REVISIONS

DYNAMICS MARINE, INC.
2483 LITTLE LANE - NE, VESSION, MS 39191
601-695-4363

MARINE INDUSTRIAL FABRICATION

DYNAMICS MARINE, INC. CLASS 215
CLASS 215 LIFTBOAT
GENERAL ARRANGEMENT 01 AND 02 DECKS

DATE: 20NOV13 APPV:

RY: GILLY ND: GA-04

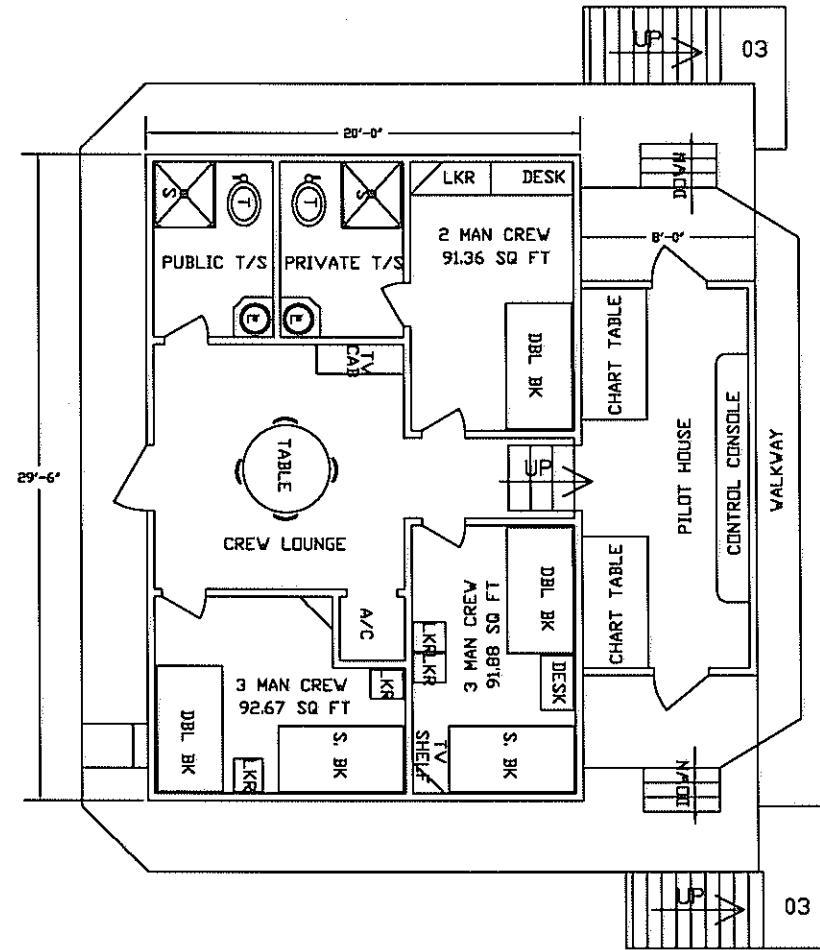

GENERAL ARRANGEMENT 03 LEVEL
SCALE 1/4" = 1'-0"

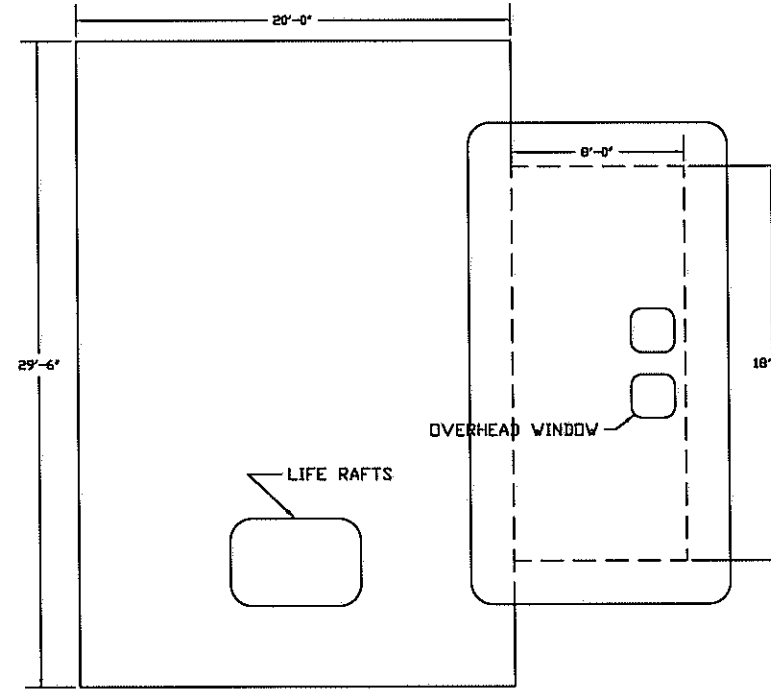

GENERAL ARRANGEMENT 04 LEVEL
SCALE 1/4" = 1'-0"

REVISIONS

DYNAMICS MARINE, INC.
2483 LITTLE LANE- NE, WESSON, MS 39191
601-695-4363

MARINE INDUSTRIAL FABRICATIION

DYNAMICS MARINE, INC. CLASS 215

CLASS 215 LIFTBDAT
GENERAL ARRANGEMENT 04, 05, & 06 DECKS

DATE: 2MAR11 APPV:

BY: GILLY NO: GA-05 △

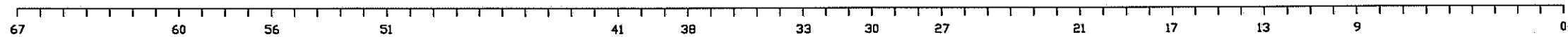
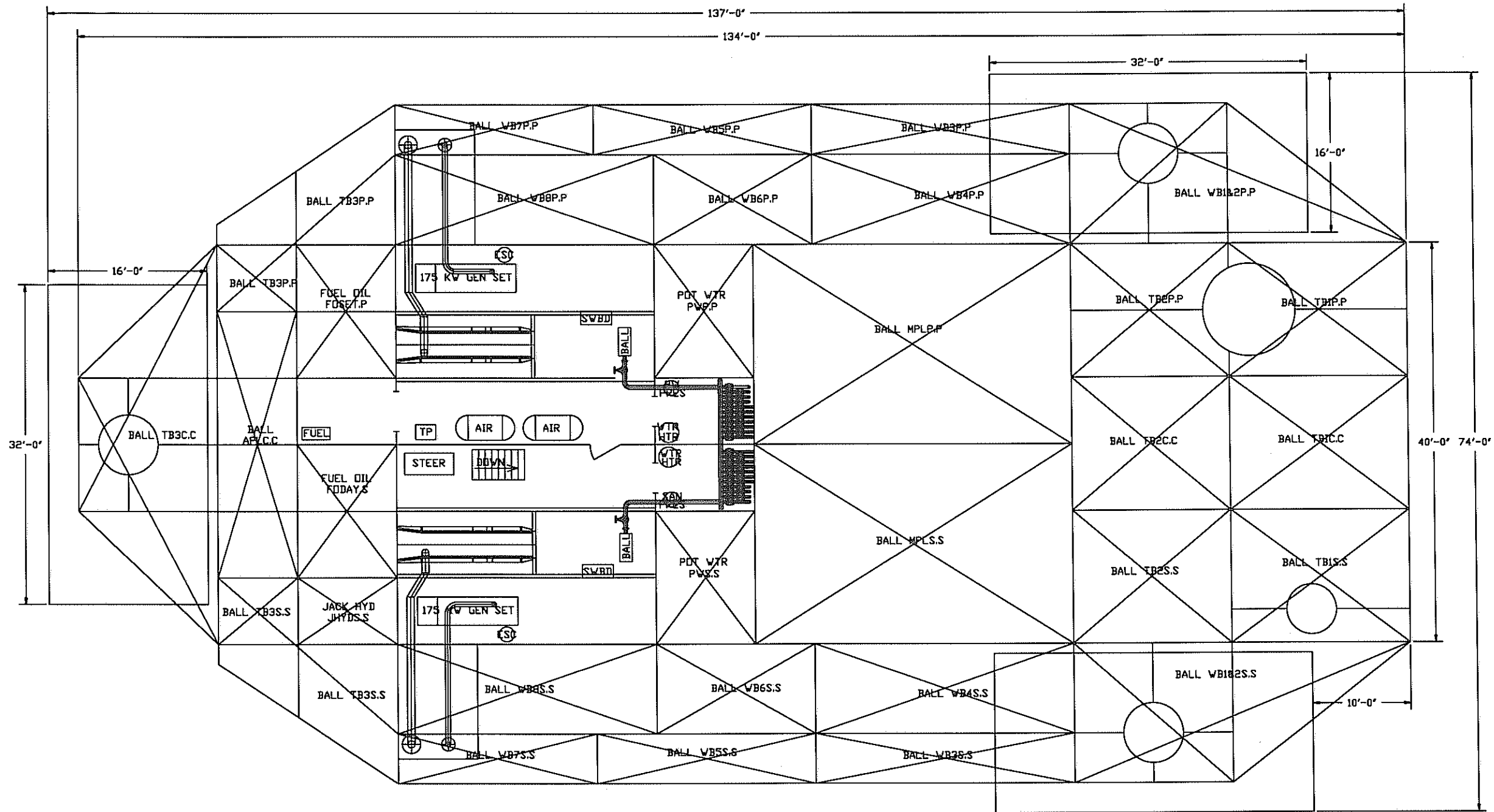

GENERAL ARRANGEMENT HOLD

SCALE 3/16" = 1'-0"

REVISIONS

DYNAMICS MARINE, INC.
2483 LITTLE LANE- NE, WESSON, MS 39191
601-695-4363

MARINE INDUSTRIAL FABRICATION

DYNAMICS MARINE, INC. CLASS 215
CLASS 215 LIFTBOAT
GENERAL ARRANGEMENT HOLD

DATE: 2MAR11	APPV:
BY: GILLY	NO: GA-02



MAIN HOIST
RAM 175 TON 100 FT BOOM
MAXIMUM SAFE WORKING LOAD
"MICHAEL EYMARD"
Serial No. 175-010-3294

BOOM RADIUS (ft)	BOOM ANGLE (degrees)	ONBOARD RATING (X 1000 lbs)	OFFBOARD RATING (X 1000 lbs)
26	78	350.000	233.333
30	76	350.000	233.333
35	73	350.000	233.333
40	70	350.000	233.333
45	67	318.000	212.000
50	64	283.726	189.151
55	60	255.685	170.457
60	57	232.320	154.880
65	54	212.551	141.701
70	50	195.609	130.406
75	46	180.928	120.619
80	42	168.084	112.056
85	38	151.884	101.256
90	33	136.959	91.306
95	27	122.382	81.588
100	21	107.329	71.553
105	11	89.106	59.404
107	0	72.427	48.285

AUXILIARY HOIST

- MAXIMUM SAFE WORKING LOAD 18,000 LBS AT ALL RADII.
- PERSONNEL RATING ALL RADII. 3,500 LBS
- PERSONNEL HANDLING MAX. WAVE HEIGHT 6 FT

BASIS OF RATING:

- LOAD CHART BASED ON DEFAULT DYNAMIC METHOD
- MAIN HOIST PERSONNEL RATING ALL RADII. 3,500 LBS
- MAIN HOIST OFFBOARD MAX. WAVE HEIGHT 2.33 FT
- ONBOARD RATINGS ARE FOR LIFTING AND LANDING LOADS ON THE PLATFORM.
- OFFBOARD RATINGS ARE FOR LIFTING AND LANDING LOADS ON A FLOATING VESSEL.
- RATING DOES NOT INCLUDE WEIGHT OF SLINGS AND RIGGING
- LOAD CHART RADIUS FROM CENTER OF ROTATION TO CENTER OF GRAVITY OF LOAD

**MAIN HOIST
RAM 50 TON 100 FT BOOM
FULLY EXTENDED
MAXIMUM SAFE WORKING LOAD
"MICHAEL EYMARD "
Serial No. 050-010-3293**

BOOM RADIUS (ft)	BOOM ANGLE (degrees)	ONBOARD RATING (X 1000 lbs)	OFFBOARD RATING (X 1000 lbs)
15	82	38.953	25.969
20	79	34.666	23.111
25	76	31.351	20.901
30	73	28.581	19.054
35	70	26.213	17.475
40	67	24.285	16.190
45	64	22.635	15.090
50	60	21.182	14.121
55	57	19.942	13.295
60	53	18.850	12.567
65	50	17.185	11.457
70	46	15.541	10.361
75	41	14.197	9.465
80	37	12.891	8.594
85	31	11.659	7.773
90	25	10.334	6.889
95	16	9.160	6.107
99	1	8.452	5.635

AUXILIARY HOIST

- ONBOARD MAXIMUM SAFE WORKING LOAD 6,800 LBS AT ALL RADII.
- PERSONNEL RATING ALL RADII. 2,300 LBS
- PERSONNEL HANDLING MAX. WAVE HEIGHT 6 FT

BASIS OF RATING:

- LOAD CHART BASED ON DEFAULT DYNAMIC METHOD
- MAIN HOIST PERSONNEL RATING ALL RADII. 3,500 LBS
- MAIN HOIST OFFBOARD MAX. WAVE HEIGHT 4.7 FT
- ONBOARD RATINGS ARE FOR LIFTING AND LANDING LOADS ON THE PLATFORM.
- OFFBOARD RATINGS ARE FOR LIFTING AND LANDING LOADS ON A FLOATING VESSEL.
- RATING DOES NOT INCLUDE WEIGHT OF SLINGS AND RIGGING
- LOAD CHART RADIUS FROM CENTER OF BOOM HEEL PIN TO CENTER OF GRAVITY OF LOAD

**MAIN HOIST
RAM 50 TON 58 FT BOOM
FULLY RETRACTED
MAXIMUM SAFE WORKING LOAD
" MICHAEL EYMARD "
Serial No. 050-010-3293**

BOOM RADIUS (ft)	BOOM ANGLE (degrees)	ONBOARD RATING (X 1000 lbs)	OFFBOARD RATING (X 1000 lbs)
9	81	100.000	66.667
10	80	100.000	66.667
15	75	100.000	66.667
20	69	84.687	56.458
25	64	67.888	45.259
30	58	54.639	36.426
35	52	45.141	30.094
40	46	38.051	25.367
45	38	32.529	21.686
50	29	28.088	18.725
55	14	24.499	16.333
57	1	23.534	15.689
0	0	0.000	0.000

AUXILIARY HOIST

- MAXIMUM SAFE WORKING LOAD 6,800 LBS AT ALL RADII.
- PERSONNEL RATING ALL RADII. 2,300 LBS
- PERSONNEL HANDLING MAX. WAVE HEIGHT 6 FT

BASIS OF RATING:

- LOAD CHART BASED ON DEFAULT DYNAMIC METHOD
- MAIN HOIST PERSONNEL RATING ALL RADII. 3,500 LBS
- MAIN HOIST OFFBOARD MAX. WAVE HEIGHT 4.7 FT
- ONBOARD RATINGS ARE FOR LIFTING AND LANDING LOADS ON THE PLATFORM.
- OFFBOARD RATINGS ARE FOR LIFTING AND LANDING LOADS ON A FLOATING VESSEL.
- RATING DOES NOT INCLUDE WEIGHT OF SLINGS AND RIGGING
- LOAD CHART RADIUS FROM CENTER OF BOOM HEEL PIN TO CENTER OF GRAVITY OF LOAD





MICHAEL EYMARD

OMC

OMC







4
LIFE JACKETS
INSIDE
EMERGENCY
EXIT
INSIDE
BUNKS 6-9

FIRE
EXTINGUISHER



EXIT



WATERTIGHT DOOR
KEEP CLOSED





EMERGENCY
EXIT

HAL...
Bel...
Four...



EMERGENCY
EXIT

TILT
ALARM

Call the
Alarm
Company
Get The Alarm
Off The Alarm

BUNN







LOVE

Stainless Steel Tumbler



