

# **ISBVI and ISD Co-Location Campus Town Hall**

# Agenda

1. What's been done to-date
2. Where are we now
3. Schematic Design Review

**01.**  
WHAT'S BEEN DONE TO-DATE

---

# What's been done to-date:

## 2019

- Capitol Needs Assessment of each campus (ISBVI & ISD)

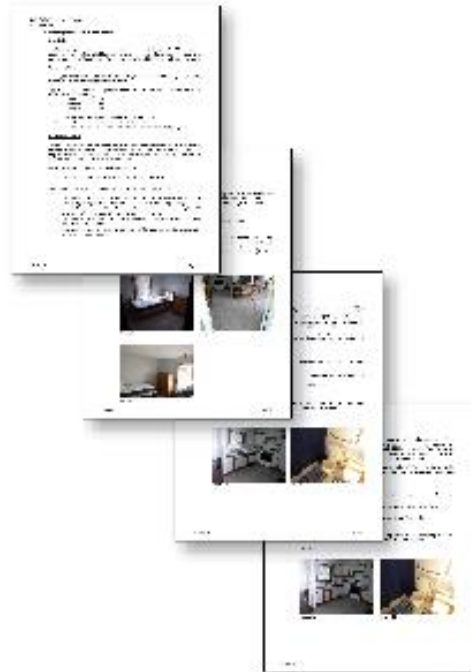

## 2020

- Feasibility study of an ISBVI & ISD Co-Location Campus outside of the city limits
- Feasibility study of using either existing school campus as the ISBVI & ISD Co-Location Campus
- ISBVI is selected as the Co-Location Campus
- Activities
  - **Meetings with each school to determine the number of buildings and area needed**
  - Visiting and studying various sites outside of I-465

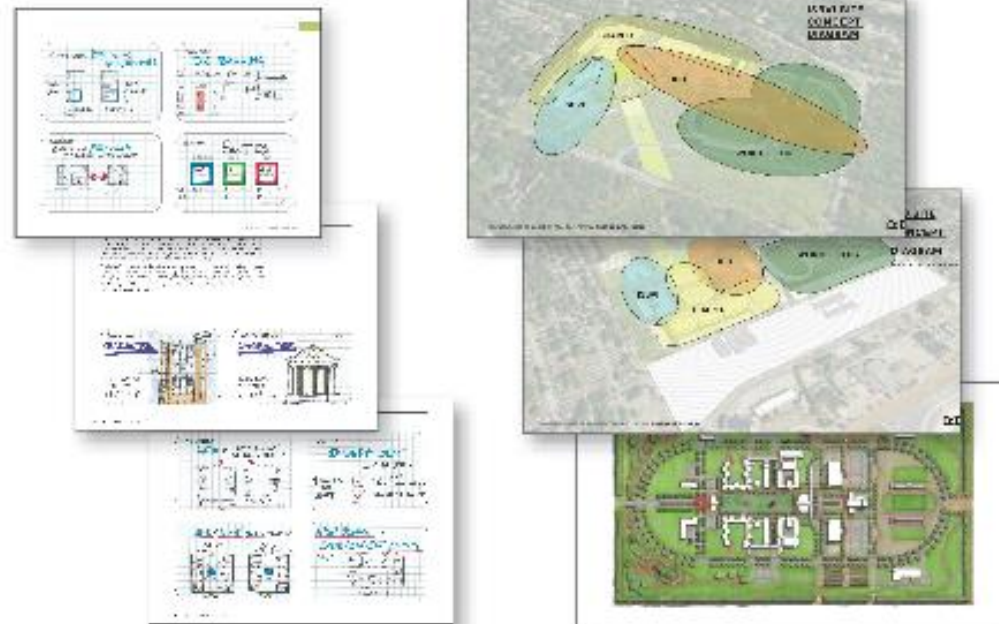

## 2021

## 2022

- Program Verification and Framework Plan Design
- Activities
  - **Meetings with each School Administration**
  - **Focus Groups with School staff, faculty, and students**
  - **Community Town Halls**
    - Alumni
    - Parents
    - Neighbors
    - Community Alliances



## 2023

- Schematic Design
- Activities
  - **Meetings with each School Administration**
  - Precedent field trips
  - Surveys
  - Research and studies





**02.**

WHERE ARE WE NOW

---

# Last Town Hall Update

## Where We Are Now

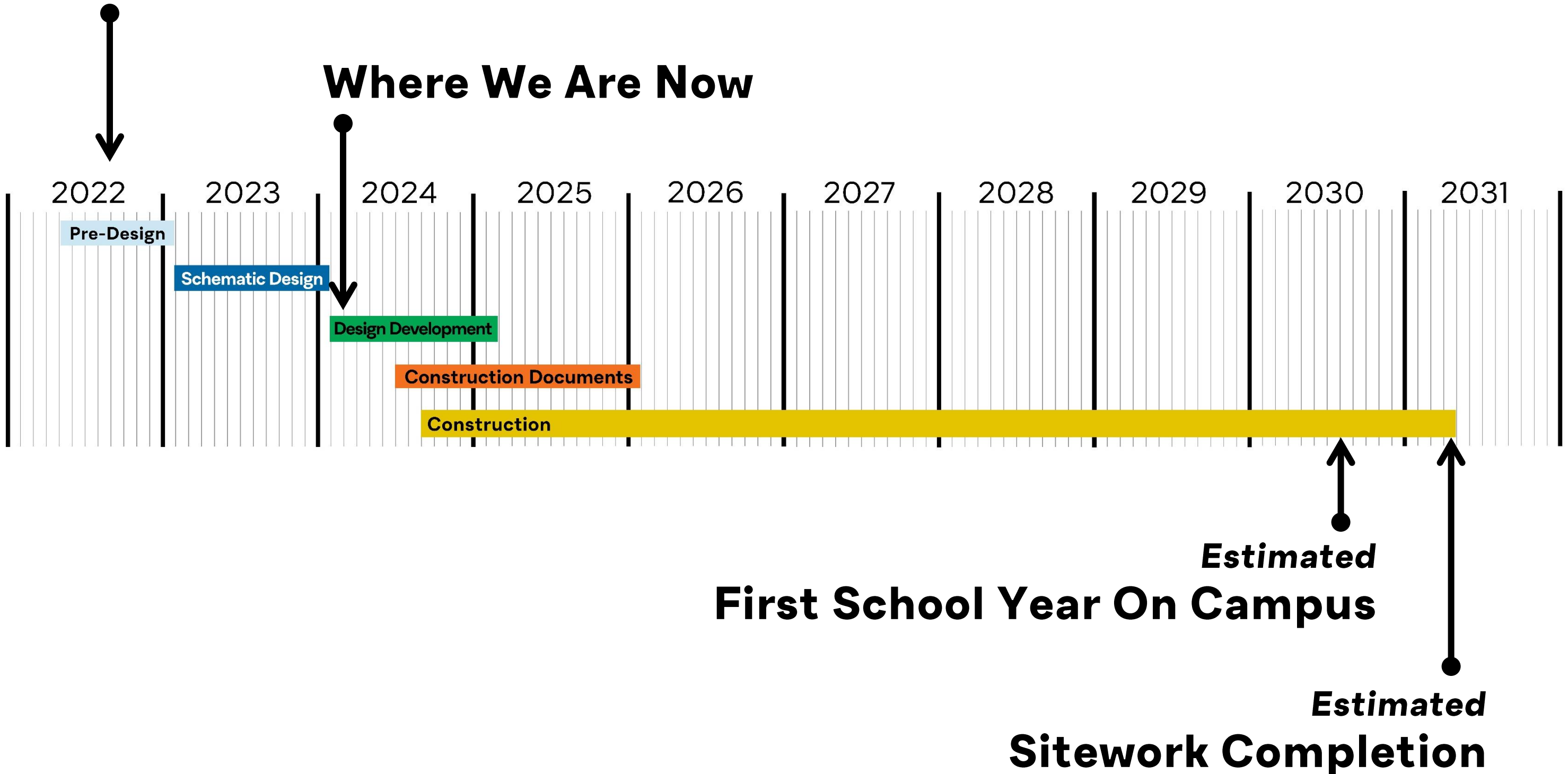

# Design Development Activities

- Meetings with each Schools' Administration
- Meetings with School Staff, Faculty, and Students
- Community Town Halls
- State Agency Approvals
- Adding detail to conceptual drawings

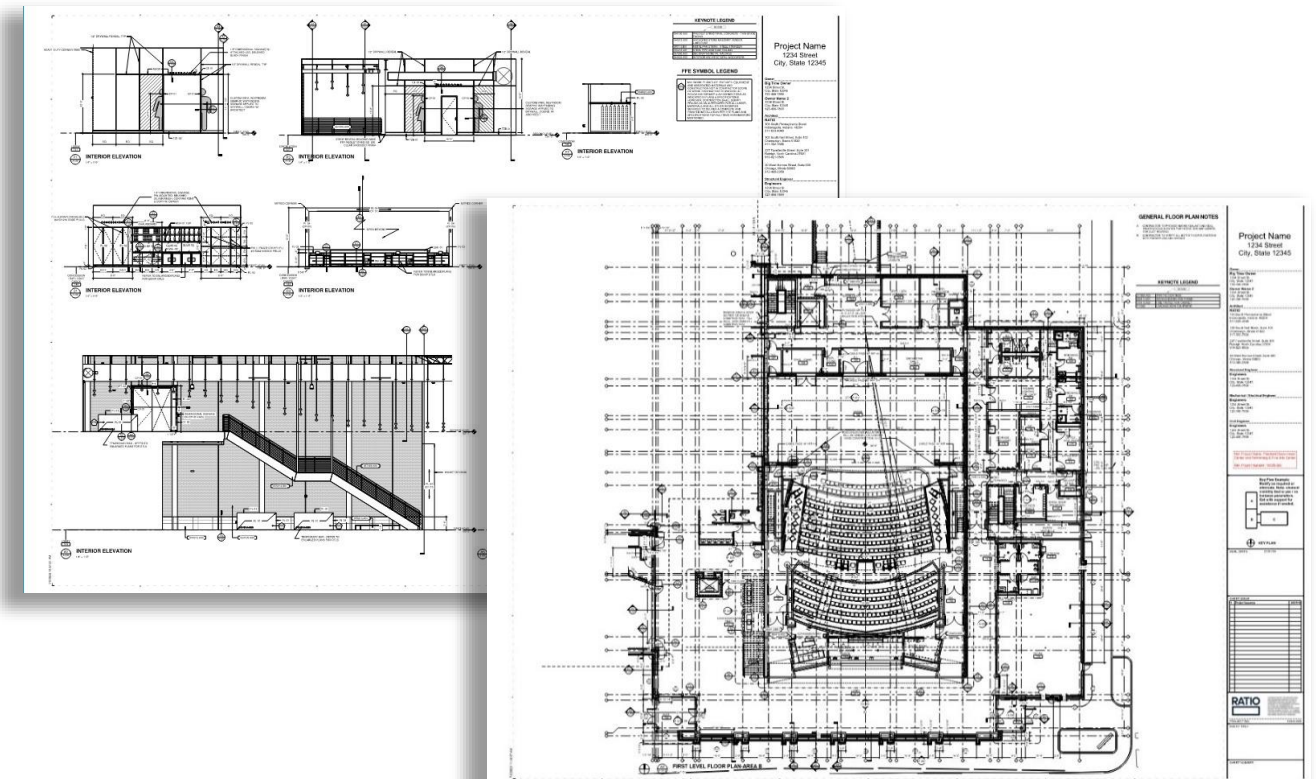
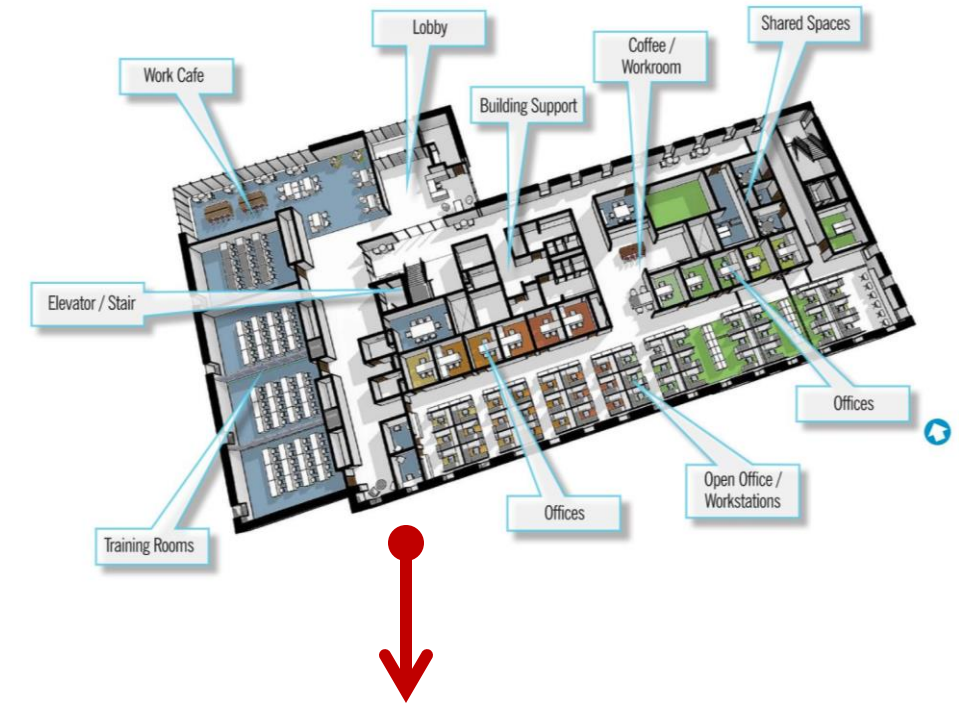

## 03. SCHEMATIC DESIGN REVIEW

---

# Campus Principles

1. Co-Location not Combination: One Campus, Two Unique Identities
2. A World Class Model for Education, Purposefully Designed to Meet the Unique Needs and Develop the Unique Strengths of the Student
3. Maintain and Enhance the Natural Landscape
4. Student Safety First
5. Fun, Joy, Discovery
6. Connection to Community



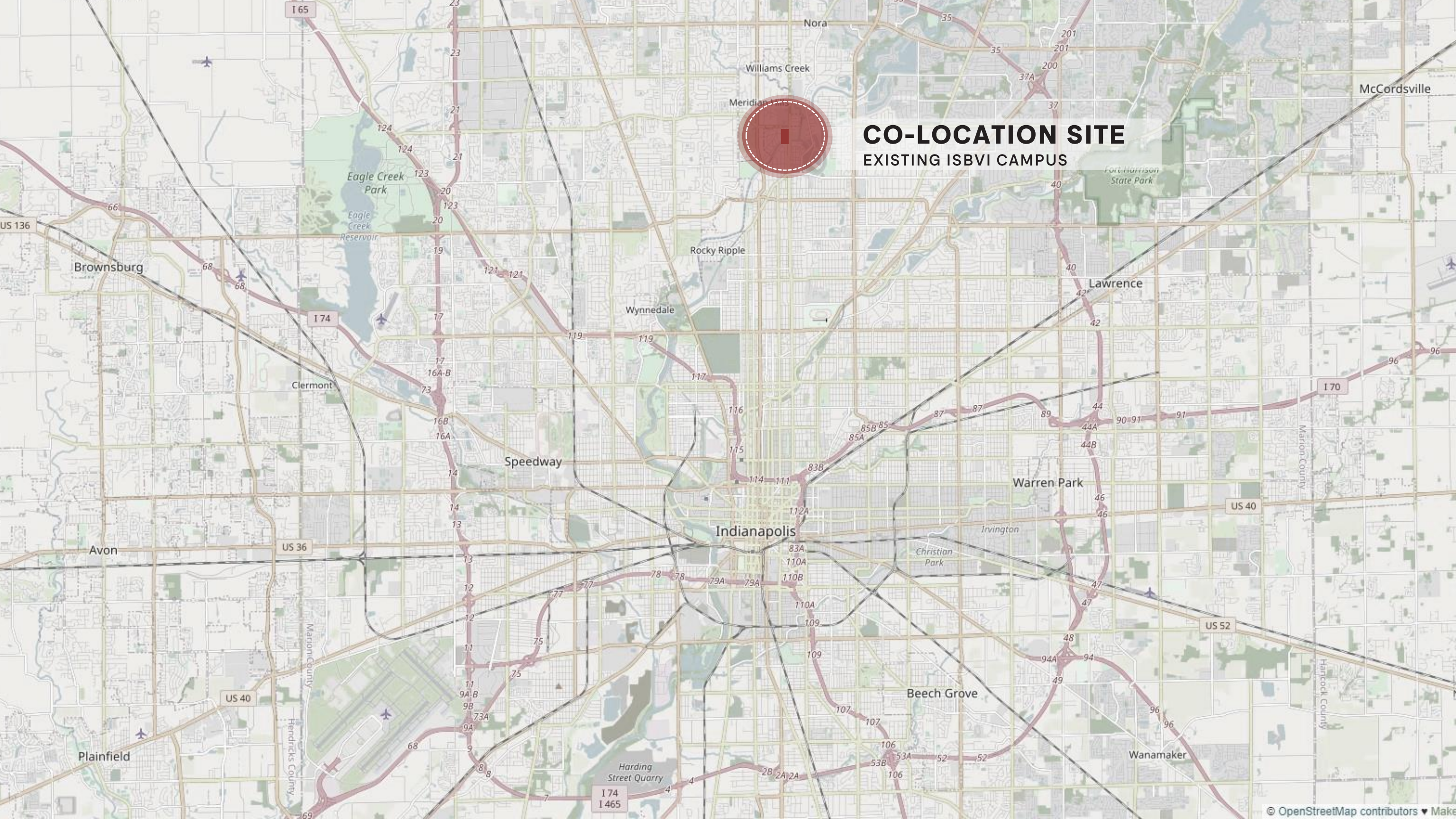

**CO-LOCATION SITE**  
**EXISTING ISBVI CAMPUS**





**EXISTING CONDITIONS**



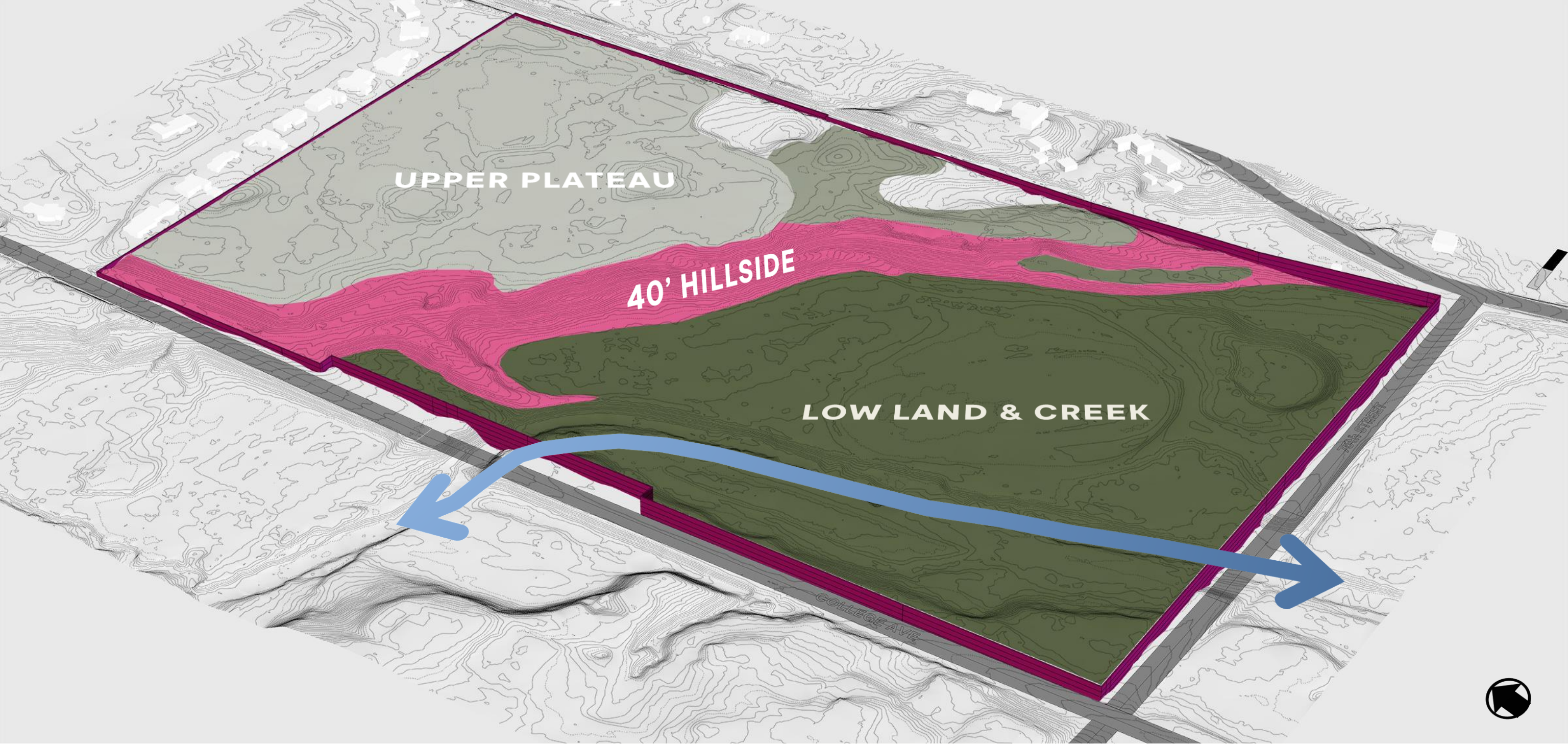

**EXISTING CONDITIONS – SITE TOPOGRAPHY**



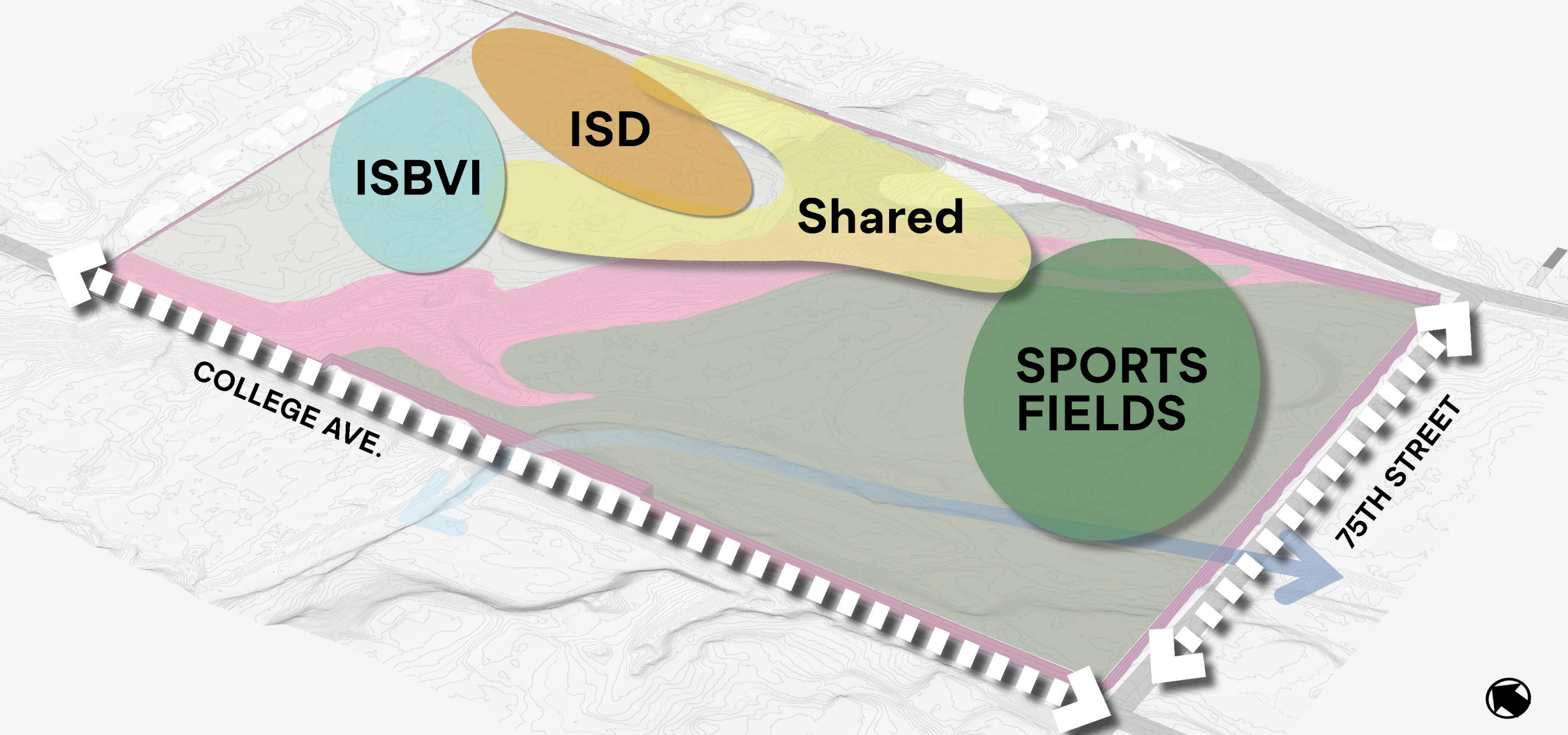

**CAMPUS PROGRAM**



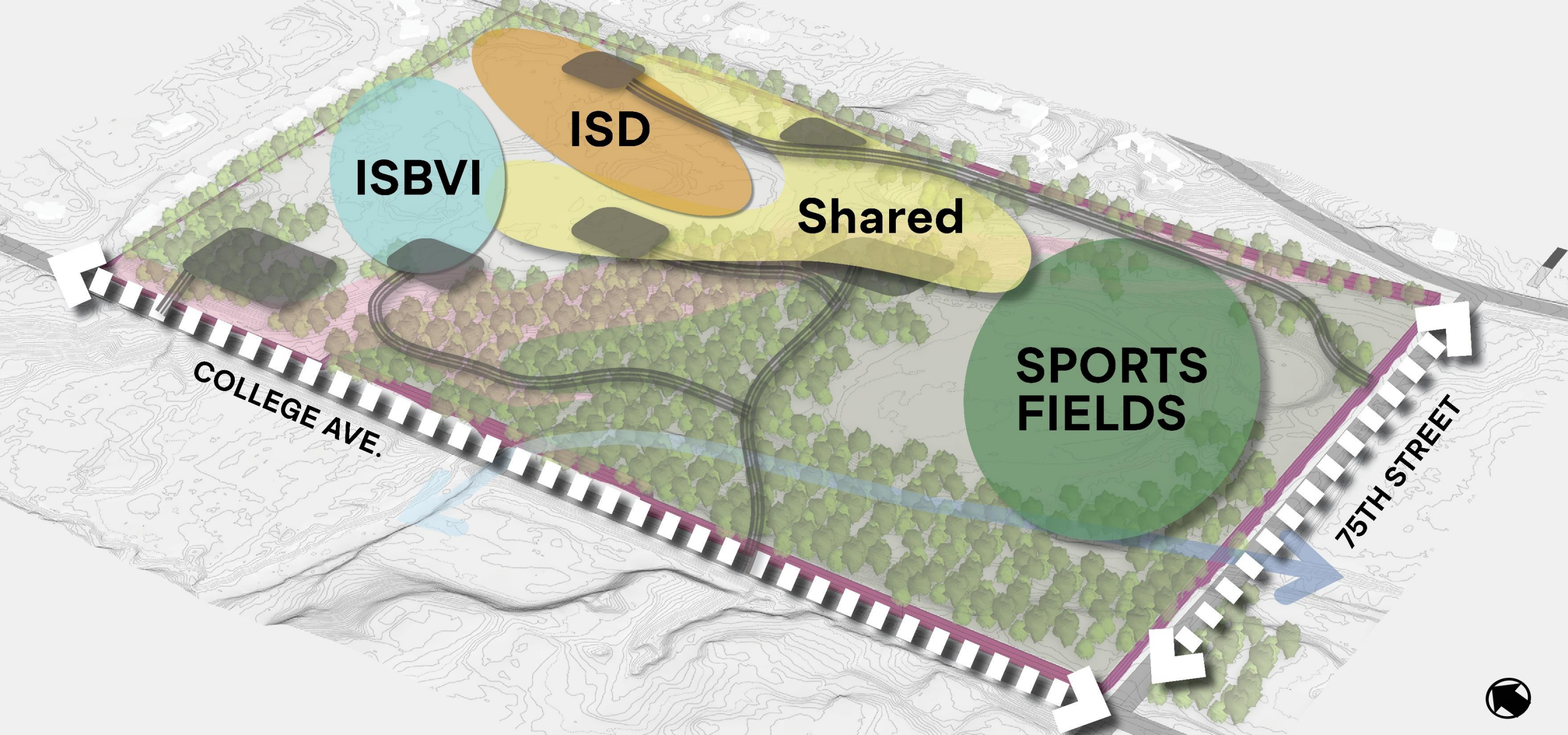

**CAMPUS PROGRAM – ROAD NETWORK AND PARKING**





**ISBVI**



**ISD**

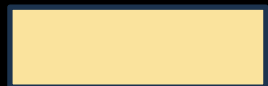

**Shared**



**Road Network and Parking**





ISD RESIDENCE

NATATORIUM

ISBVI RESIDENCE

GREENHOUSE

FIELDHOUSE

CUP

IERC

ISBVI EDUCATION

ISD EDUCATION

DINING

CAMPUS CENTER





ISBVI RESIDENCE

ISD RESIDENCE

ISBVI ELEMENTARY

NATATORIUM

ISD ELEMENTARY

GREENHOUSE

DINING

ISBVI MEDIA CENTER

ISD MEDIA CENTER

FIELDHOUSE

ISBVI MS/HS

CAMPUS CENTER

ISD MS/HS

ISBVI VISITOR ENTRY

ISBVI ADMINISTRATION

ISD VISITOR ENTRY

ISD ADMINISTRATION



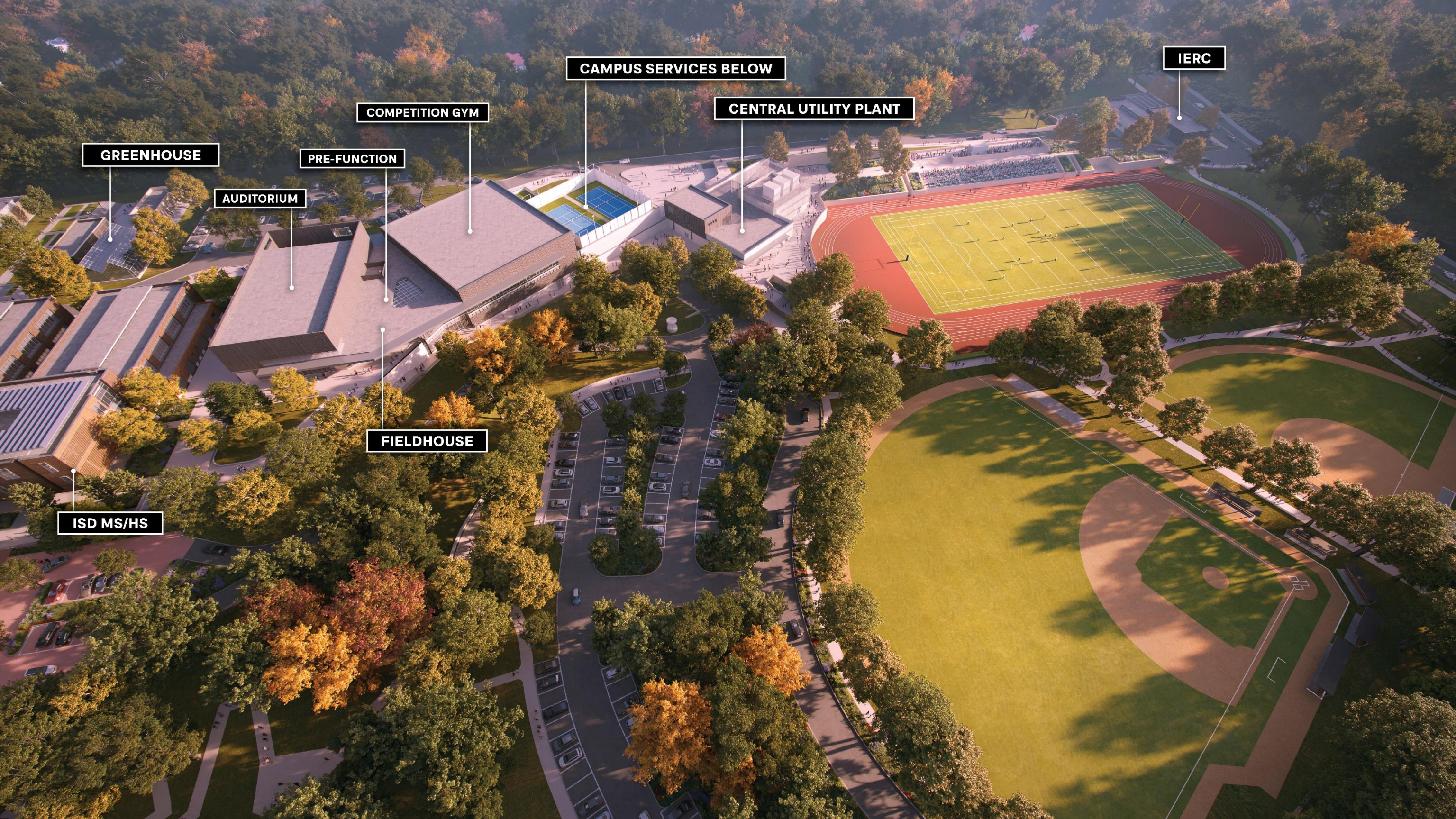

CAMPUS SERVICES BELOW

IERC

CENTRAL UTILITY PLANT

COMPETITION GYM

PRE-FUNCTION

GREENHOUSE

AUDITORIUM

FIELDHOUSE

ISD MS/HS





ISBVI MS/HS

ISBVI ELEMENTARY

ISBVI RESIDENCE

ISD RESIDENCE

ISD ELEMENTARY

DINING

ISBVI MEDIA CENTER

ISBVI VISITOR ENTRY

ISBVI ADMINISTRATION

CAMPUS CENTER



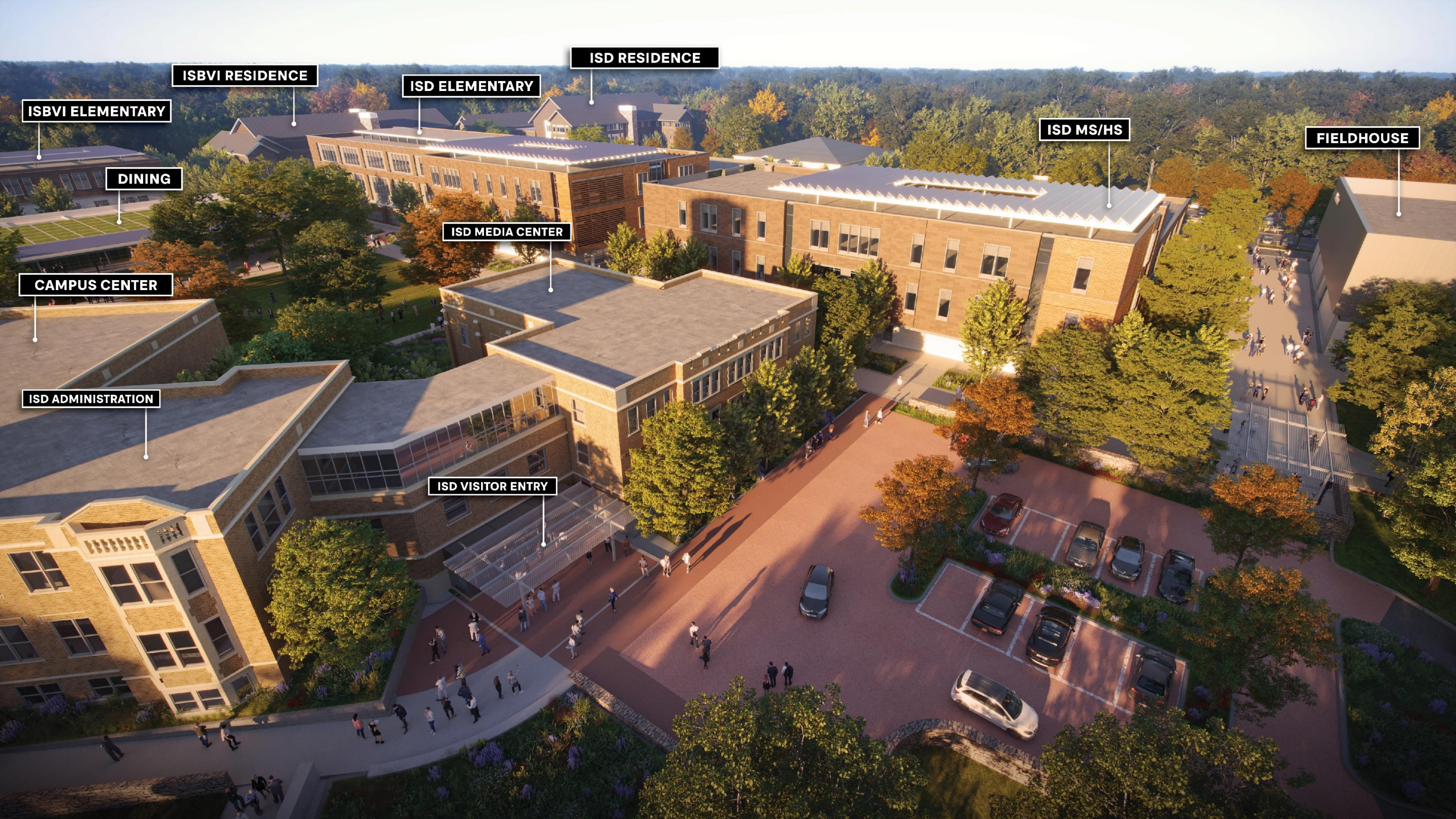

ISBVI ELEMENTARY

DINING

CAMPUS CENTER

ISD ADMINISTRATION

ISBVI RESIDENCE

ISD ELEMENTARY

ISD MEDIA CENTER

ISD RESIDENCE

ISD MS/HS

FIELDHOUSE

ISD VISITOR ENTRY



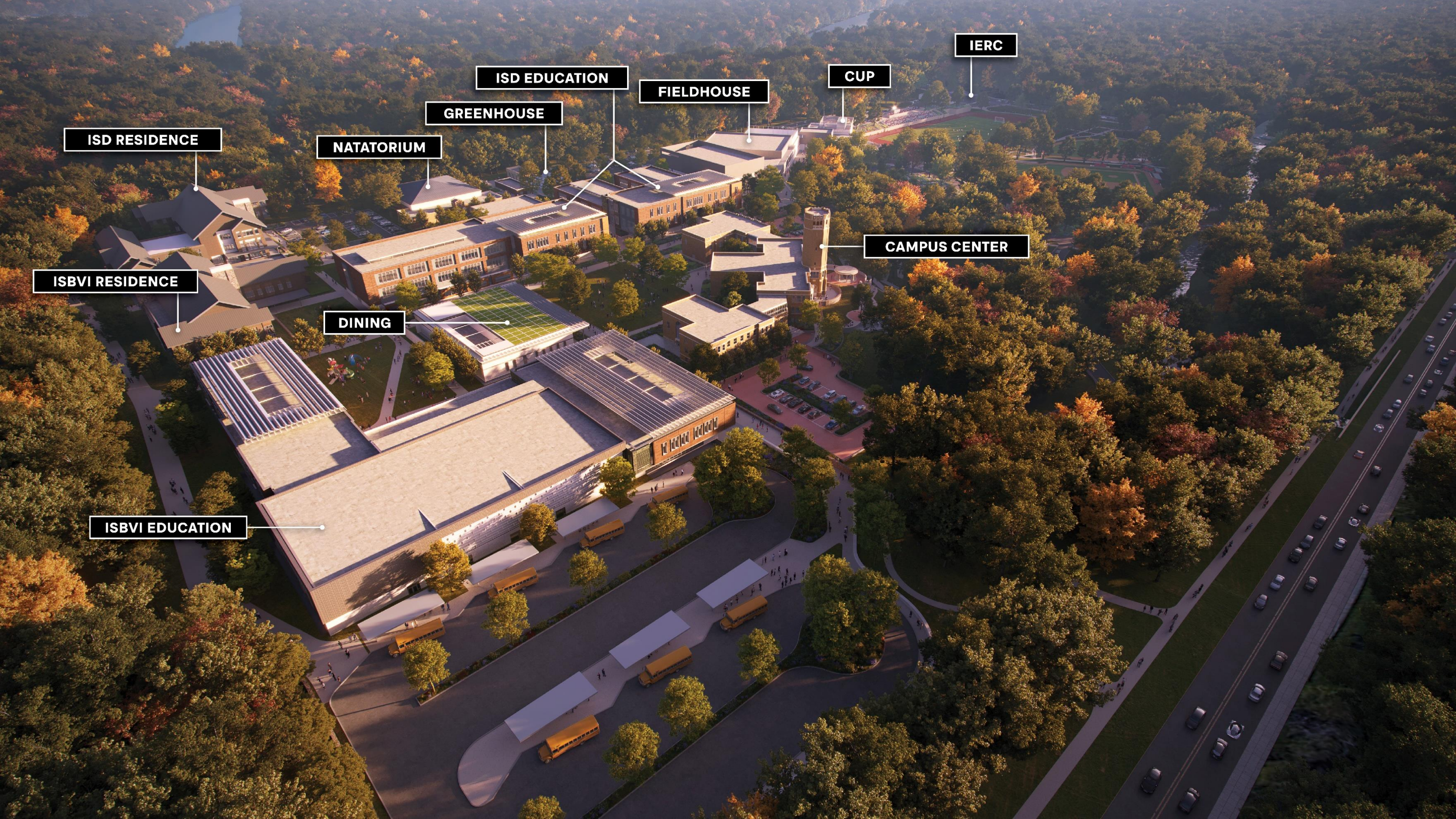

IERC

CUP

FIELDHOUSE

ISD EDUCATION

GREENHOUSE

NATATORIUM

ISD RESIDENCE

ISBVI RESIDENCE

DINING

CAMPUS CENTER

ISBVI EDUCATION



# Thank You!

**PROJECT WEBSITE:**

<https://collegeavenuecolocation.com/>

**PROJECT EMAIL:**

[capitalprojects@idoa.in.gov](mailto:capitalprojects@idoa.in.gov)