

# E SERIES

# E9

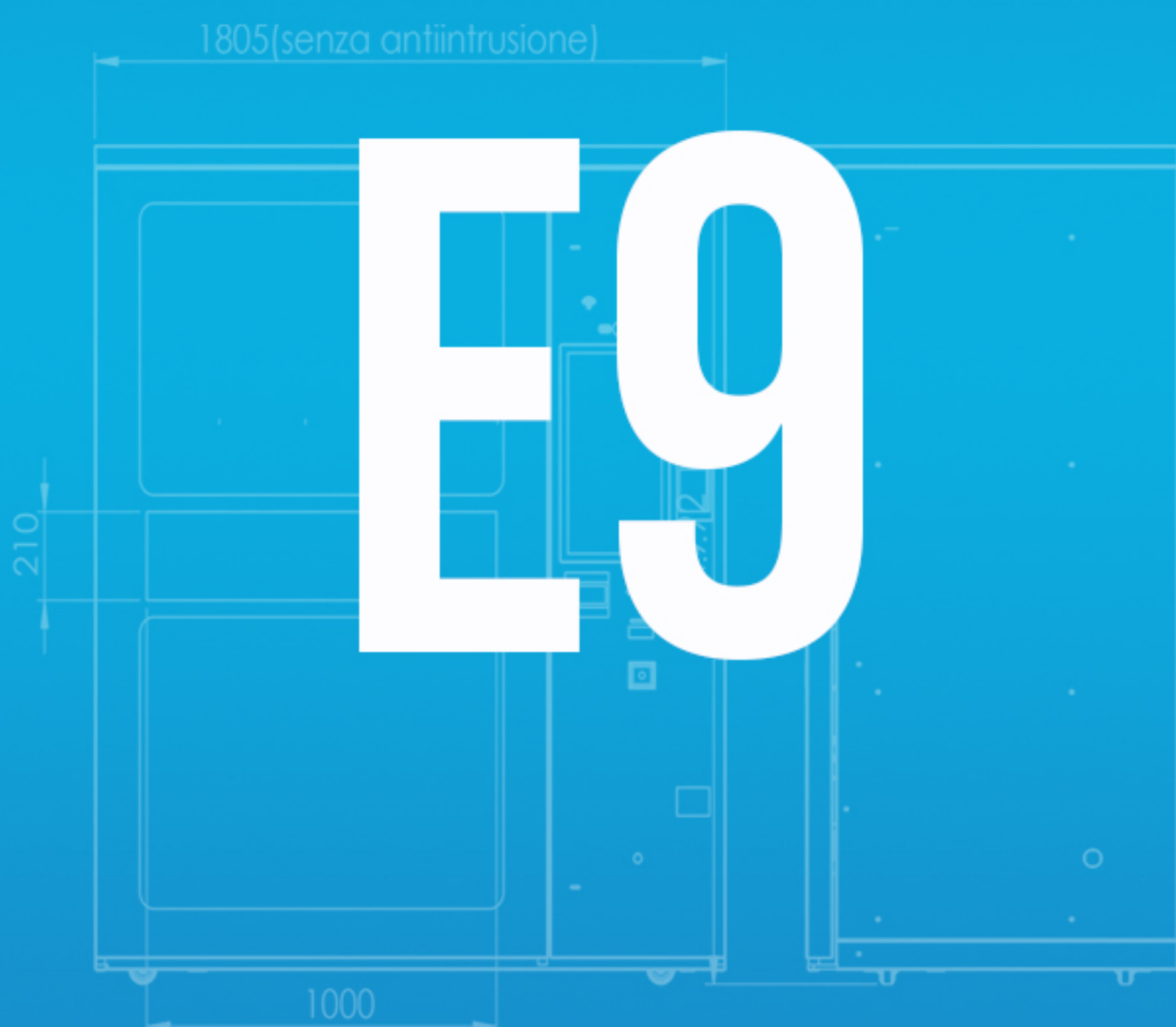

MAGEX<sup>®</sup> USA  
An Alps Innovations Group Company



The E9 is an automated kiosk with an innovative design perfect to sell a lot of different products; the dispensing product window is at 90cm from the ground to easily remove the products without bending down. The vending machine is equipped with a robotic product carrier that transports the product from the kiosk's floors to the middle dispensing door without over turning it. The product is dispensed thanks to the patented system with separators and without spirals, which allows to organize every floor according to the product's size. This system allows for the sale of fragile products. E9 has 9 lanes on every floor with up to 8 floors. The kiosk has a 22" HD touch display with 1920x1080p resolution: this screen provides a full products menu with product description, pictures and promotional video.

## NEW SLIDING PANEL SYSTEM

A simple and effective system: a sliding anti-vandal panel closes the floor behind it when the door on the lift opens to deliver the product. The sliding panel could remain open when the machine is not in the delivery phase to let the customer see all the products inside the machine; it can also be closed **to hide a specific floor with products to be sold only with proof of age.**

## MAGEX LOADING SYSTEM

The E9 has maximum adaptability to distribute all types of product, this unique system allows lanes to be paired to accommodate products of different sizes. The system also has interlocking partitions to separate products that are next to one another. This allows complete control of specific lanes so you may dispense products of different sizes and shapes. The E9 also has a self-diagnostic system that will check the operating status of any particular lane prior to any disbursement of the product.

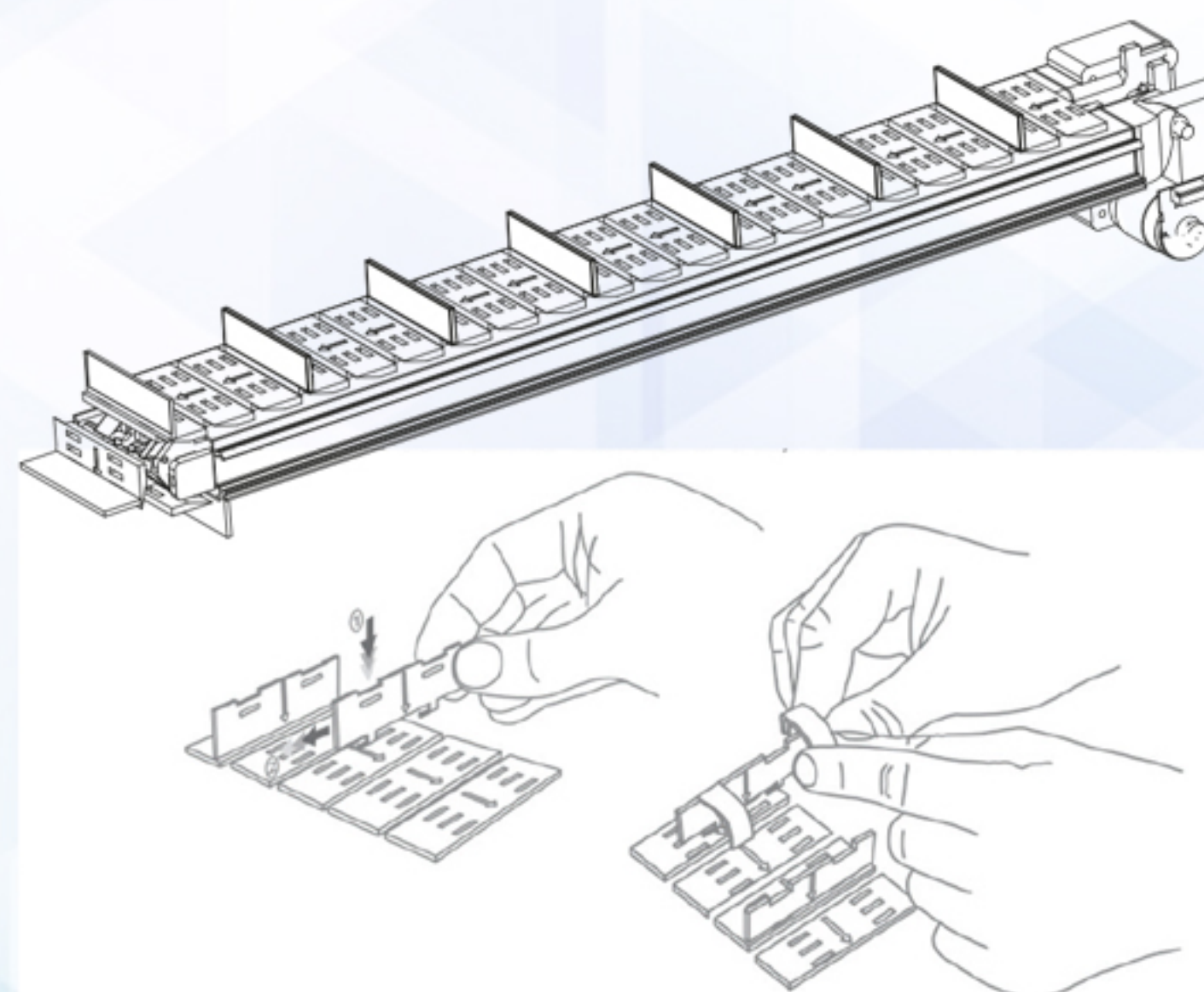



# E SERIES

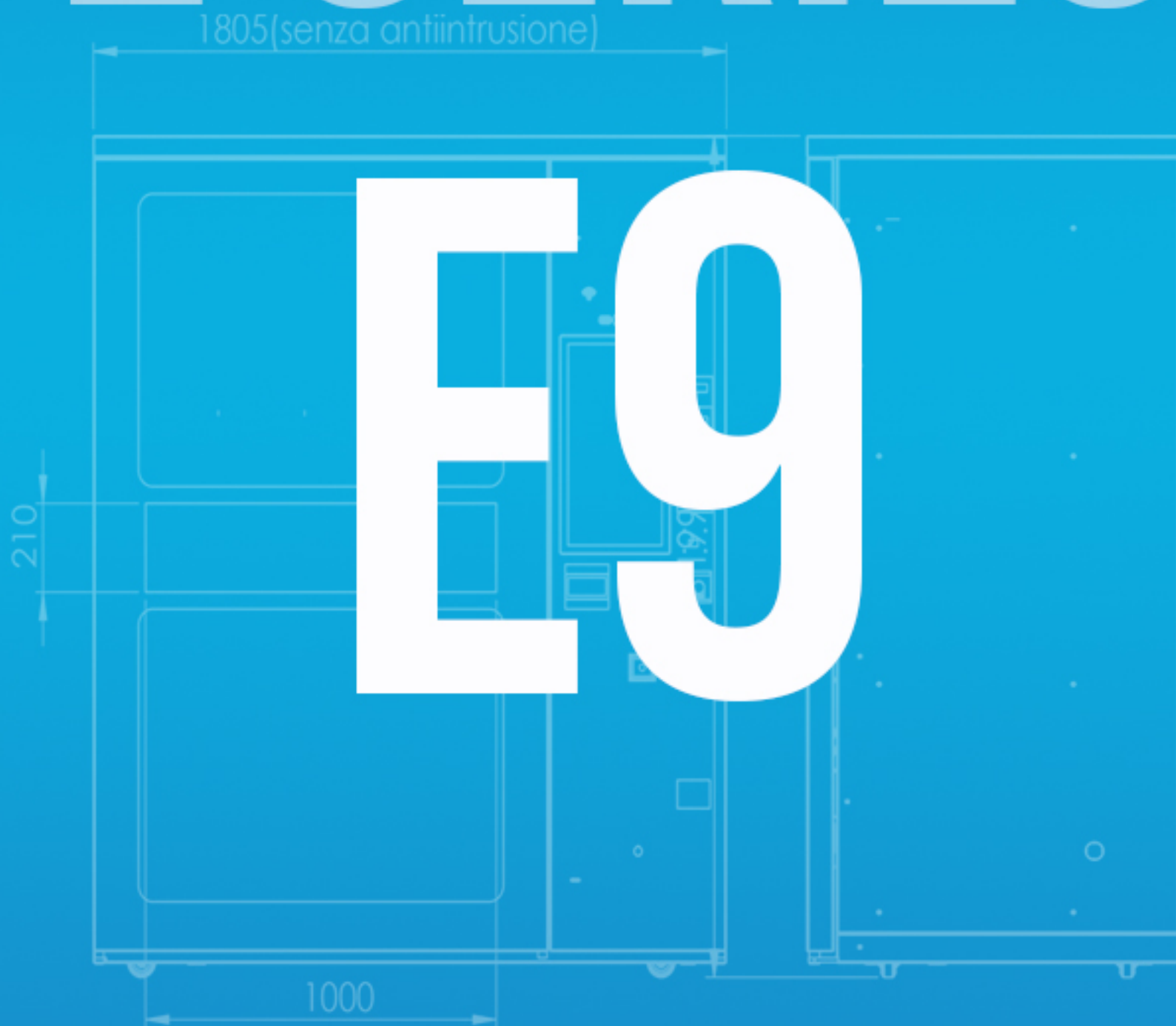

## E9 SPECS

**Width : 52"/1324 mm**

**Depth : 39"/981 mm**

**Height : 78.3"/1989 mm**

**Height w/refrigeration: 90"/2289 mm**

**Host Weight (with 6 floors) : 350 kg**

**Module Weight (slave module) : 350 kg**

**Maximum number of floors : 8**

**Maximum number of lanes : 9**

**Maximum facings per floor : 9**

**Lighting type : High luminosity LED (30W)**

**Power Supply : 240/50 Hz | 110V/60 Hz**

**Internal temperature : 2/4° C**

**Power consumption (with cooling) 5.5 KWH/24HR**

**Power consumption (without cooling) 2KWH/24HR**

## TECHNICAL SPECIFICATIONS

- Reinforced retrieval area
- Shatter proof resistant glass
- Console with independent opening (host)
- Industrial computer with quad core processor
- Operating system installed with 32 SSD
- LED lighting
- Modular shelf configuration
- Console locks isolated
- Self-diagnostic system
- Electronic multi-control
- Data and statistics management available in real time
- Temperature control
- 22" touch screen monitor with 1920x1080 pixel resolution (optional 10" monitor)

## OPTIONS

- Cashless/Credit/Debit Reader
- Cash: Note & Coin Reader and/or recycler
- Camera kit
- Graphic customization
- RFID loyalty card system
- Mobile App
- Cooling unit with digital temperature control
- Insulation for refrigeration
- More custom features available

## REAL TIME DATA SERVICE

Magex provides to all its customers a service for the management of the vending machines updated in real time, connected via web and accessible from laptops, mobile phones etc. This allows you to view in real-time data of each sale, the product stock status, the coins/banknotes inserted or returned, automatic reboots and other functions. It also monitors the temperature inside the machine with visual graphics.

**E9 IS EXPANDABLE UP TO 4 MODULES**