

MEKASHI®

BATTERY OPERATED RIDE ON CARS MADE IN INDIA



IS 15644:2006



CM/L-8800139014

Styles and colours may vary

PRODUCT MANUAL FOR
MKS-004 / MKS-004D
MKS-005 / MKS-005D
MKS-006 / MKS-006D

WWW.MEKASHI.TOYS

This ride-on car will provide your child with many miles of riding of enjoyment. To help assure you and your rider a safe ride we ask you to please read this manual carefully, and keep it for future reference.

Follow the recommendations in this manual, they are designed to improve the safety and operation of your ride-on car and it's rider.

Specification

Suitable age: 2+ Years

Battery: **1WD** 6V 4.5AH x1 or 6V7AH x1

2WD 6V 4.5AH x2

Charge time: 8~12 hours

Charge: Input: depend on local voltage

Output: **1WD** DC6V500mA or DC6V1000mA

2WD DC12V500mA or DC12V1000mA

Load capacity: Under 35kg

Size of car: 93 x 58 x 45 cm

Speed: 3~5 km/h



BATTERY INFORMATION

- Non-rechargeable batteries are not to be recharged.
- If removable rechargeable batteries are used, they are only to be charged under adult supervision.
- Remove rechargeable batteries from the product before charging.
- Do not mix old and new batteries. Do not mix different types of batteries: alkaline, standard (carbon-zinc) or rechargeable (nickel-cadmium).
- Insert batteries as indicated inside the battery compartment, anode to anode, cathode to cathode.
- Remove batteries during long periods of non-use. Always remove exhausted batteries from the product. Battery leakage and corrosion can damage this product. Dispose of batteries safely.
- Never short circuit the battery terminals.

NO.	PART NAME	Q'TY (PCS)		REMARK
		1WD	2WD	
1	Vehicle body	1		
2	Driving wheel	1	2	
3	Normal wheel	3	2	
4	Φ10 washer	7	6	
5	Lock nut / Cotter Pin	4		
6	Wheel cover	4		
7	View mirror	2		
8	Windshield	1		
9	Seat	1		
10	Seat lock	1		
11	Φ4x10 flat head screw	2		For windshiled
12	Steering wheel	1		
13	M5X40 machine screw	1		
14	Φ5 nut	1		
15	Φ3x10 screw	8		For wheel covers
A	Charger	1		
B	Remote controller	1		

• Assembly tools required:

Screwdriver
(not included)



NOTE: Some parts shown are assembled on both sides of vehicle

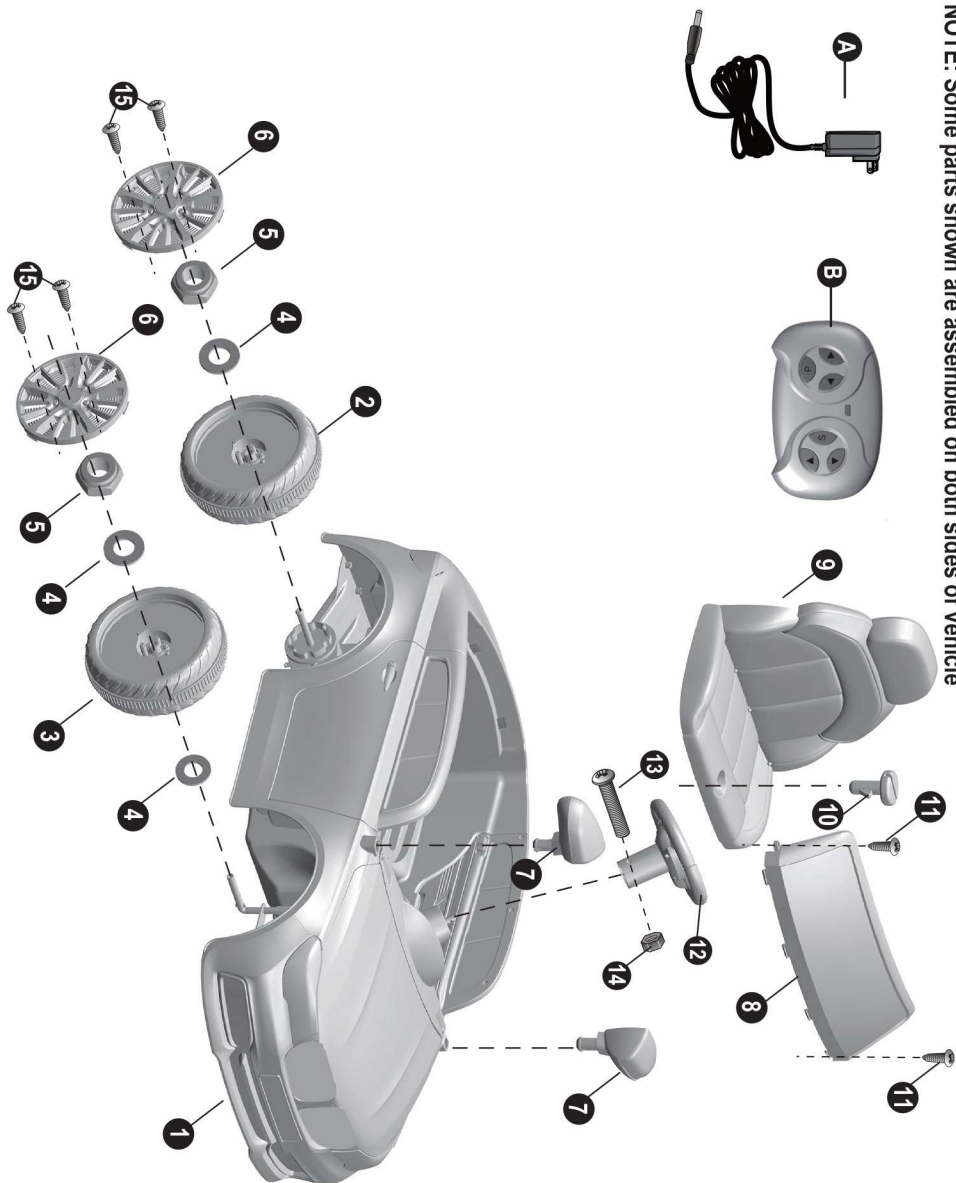

**PREVENT INJURIES AND DEATHS:**

- **NEVER LEAVE CHILD UNATTENDED. ADULT DIRECT SUPERVISION IS REQUIRED.** Always keep child in view when child is in vehicle.
- This toy should be used with caution since skill is required to avoid falls or collisions causing injury to the user or third parties.
- Protective equipment should be worn.
- Never use in roadways, near cars, on or near steep inclines or steps, swimming pools or other bodies of water.
- Always wear shoes, always sit on the seat.
- Not to be used in traffic.
- This toy is unsuitable for children under 24 months due to its maximum speed; Maximum user weight is 35 kgs.
- This toy has no brake.

**WARNING:**

- **CHOKING HAZARD!**
- **ADULT ASSEMBLY REQUIRED.**

Rules for Safe Riding

- Keep Children within Safe Riding Areas:
 - Never use in roadway, near motor vehicles, on lawn space, on or near steep inclines or steps, swimming pools or other bodies of water;
- Use the toy only on flat surfaces. Such as inside your house, garden or playground.
- Never use in the dark. A child could encounter unexpected obstacles and have an accident. Operate the vehicle only in the daytime or a well-lit area.
- It is prohibited to change the circuit or add other electric parts
- Inspect wires and connections of the vehicle periodically.
- Do not let any child touch the wheels or be near them when the car is moving .
- This vehicle has adjustable play seat belts. Please instruct children how to tie the safety belt before using, guarantee the security.

E **1WD** Attach the Rear Wheels

HINT: If your vehicle is *Two Wheels Driving Type*, see the next page please.

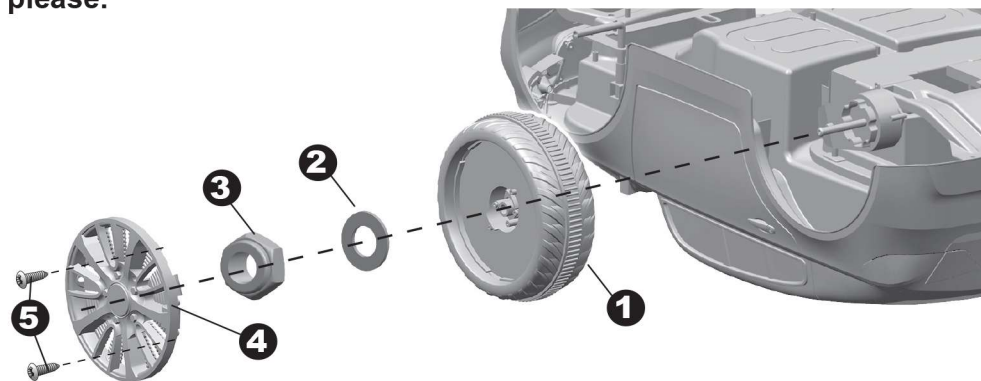

Turn over the vehicle body.

1. Slide the driving wheel onto the rear axle from Left Side. And keep the driving wheel match with the gear box.
2. Slide the $\varnothing 10$ washer onto the rear axle.
3. Tighten a lock nut onto the rear axle with a spanner.
- 4-5. Fit the wheel cover to the wheel and tighten two $\varnothing 3 \times 10$ screws.

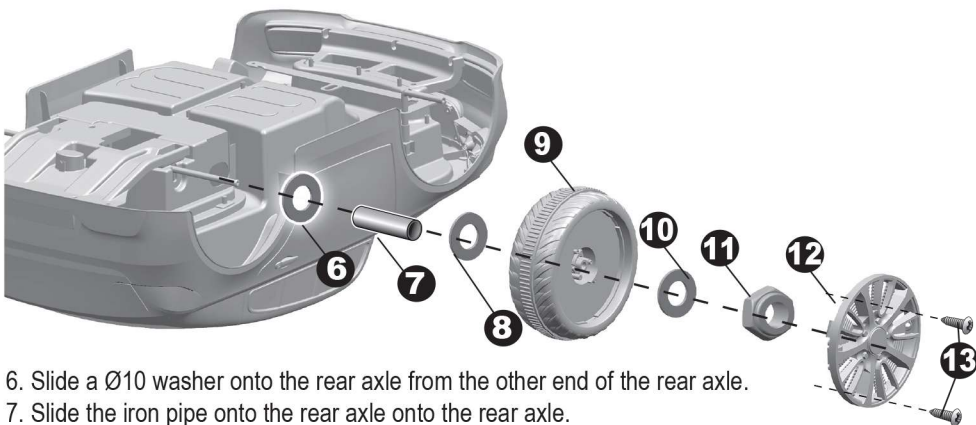

6. Slide a $\varnothing 10$ washer onto the rear axle from the other end of the rear axle.
7. Slide the iron pipe onto the rear axle onto the rear axle.
8. Slide the other $\varnothing 10$ washer onto the rear axle.
9. Slide a normal wheel onto the rear axle.
10. Slide the third $\varnothing 10$ washer onto the rear axle.
11. Tighten a lock nut onto the rear axle with a spanner.
- 12-13. Fit the wheel cover to the wheel and tighten two $\varnothing 3 \times 10$ screws.

Instead of the lock nut we use cotter pin.

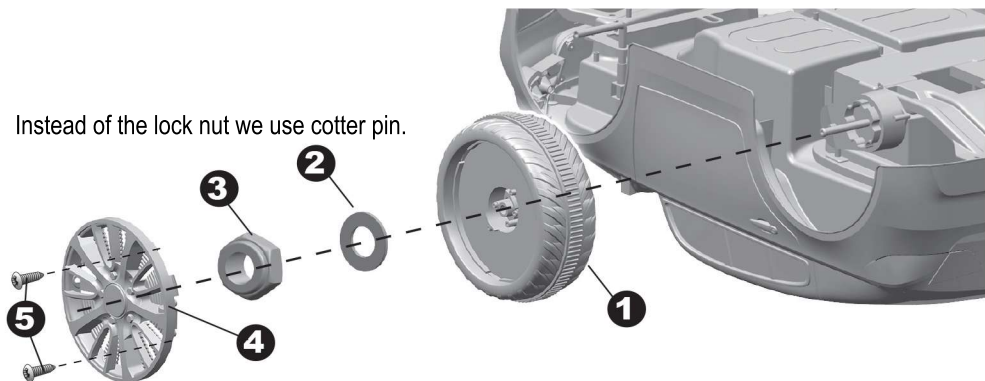

Turn over the vehicle body.

1. Slide the driving wheel onto the rear axle from Left Side. ("R" labeled gear box should be fit to the "R" side of vehicle body; "L" labeled gear box should be fit to "L" side of vehicle body)
And keep the driving wheel match with the gear box.
2. Slide the $\varnothing 10$ washer onto the rear axle.
3. Tighten a lock nut onto the rear axle with a spanner.
- 4-5, Fit the wheel cover to the wheel and tighten two $\varnothing 3 \times 10$ screws.



Repeat for the other driving wheel.

Instead of lock nut we use cotter pin.

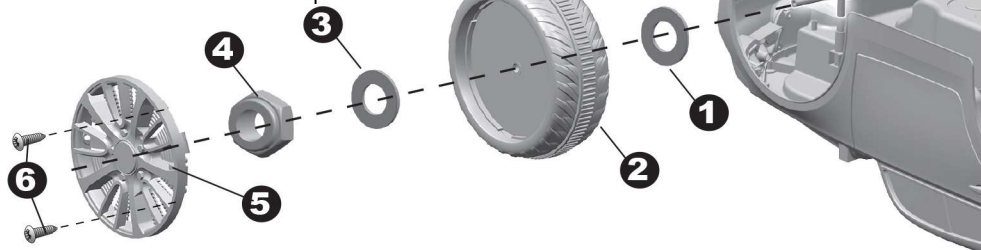

1. Slide a $\Phi 10$ washer onto the front axle.
 2. Slide a normal wheel onto the front axle.
 3. Slide the other $\Phi 10$ washer onto the front axle.
 4. Tighten a lock nut onto the rear axle with a spanner.
 - 5-6, Fit the wheel cover to the wheel and tighten two $\text{Ø}3 \times 10$ screws.
- Repeat for the other side.

7. Insert the tabs on the windshild into the slots on the front vehicle. And push until you hear it "snap" into place.

8. Tighten two $\text{Ø}4 \times 10$ flat head screws to secure it.

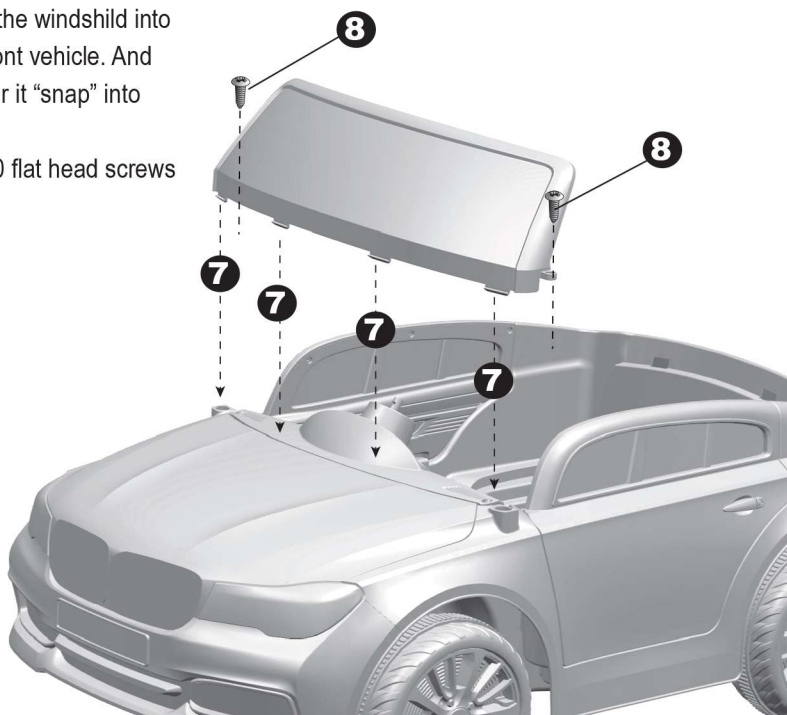

Attach the Steering wheel & View Mirrors **E**

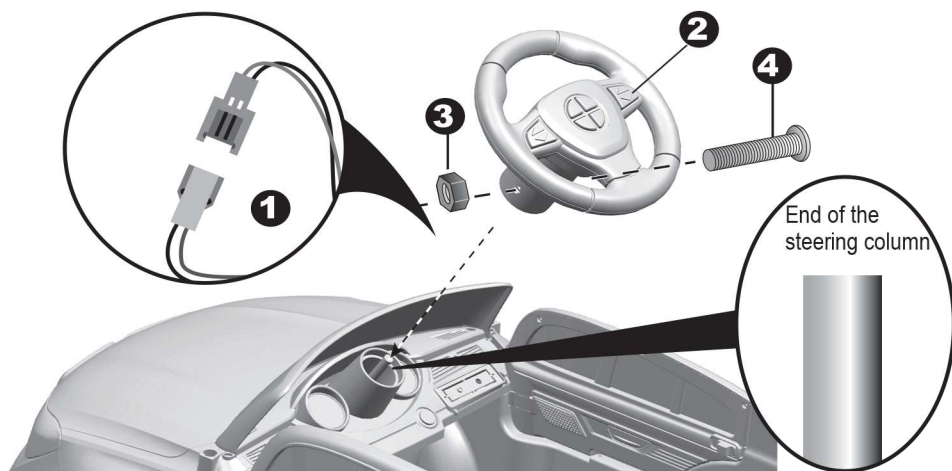

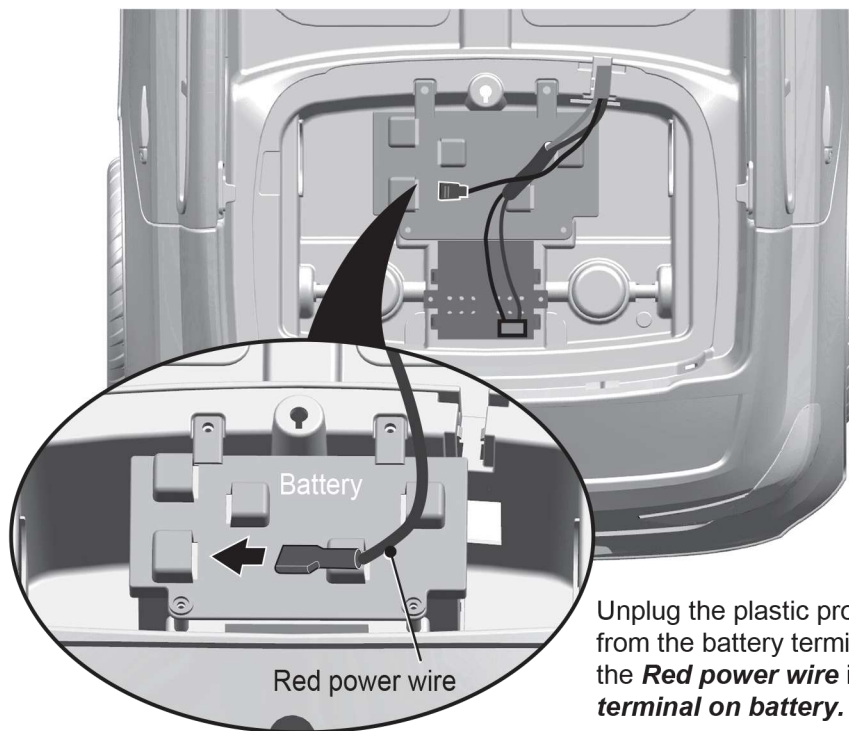

Unplug the plastic protector from the battery terminal, plug the **Red power wire** into the **terminal on battery**.

Using the door lock

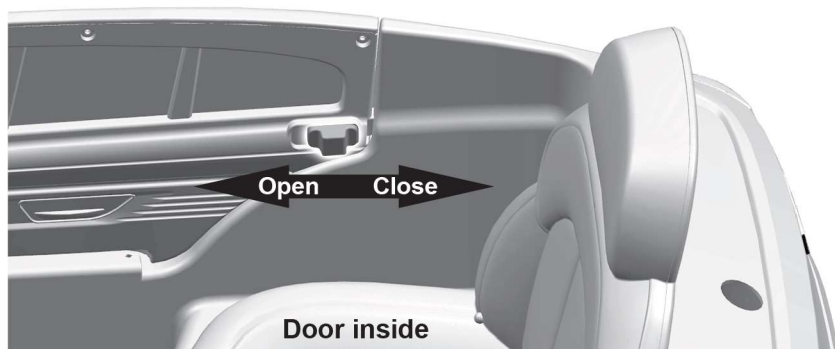

NOTE:

Please close the door and push it back to lock the door when riding for safety consideration.

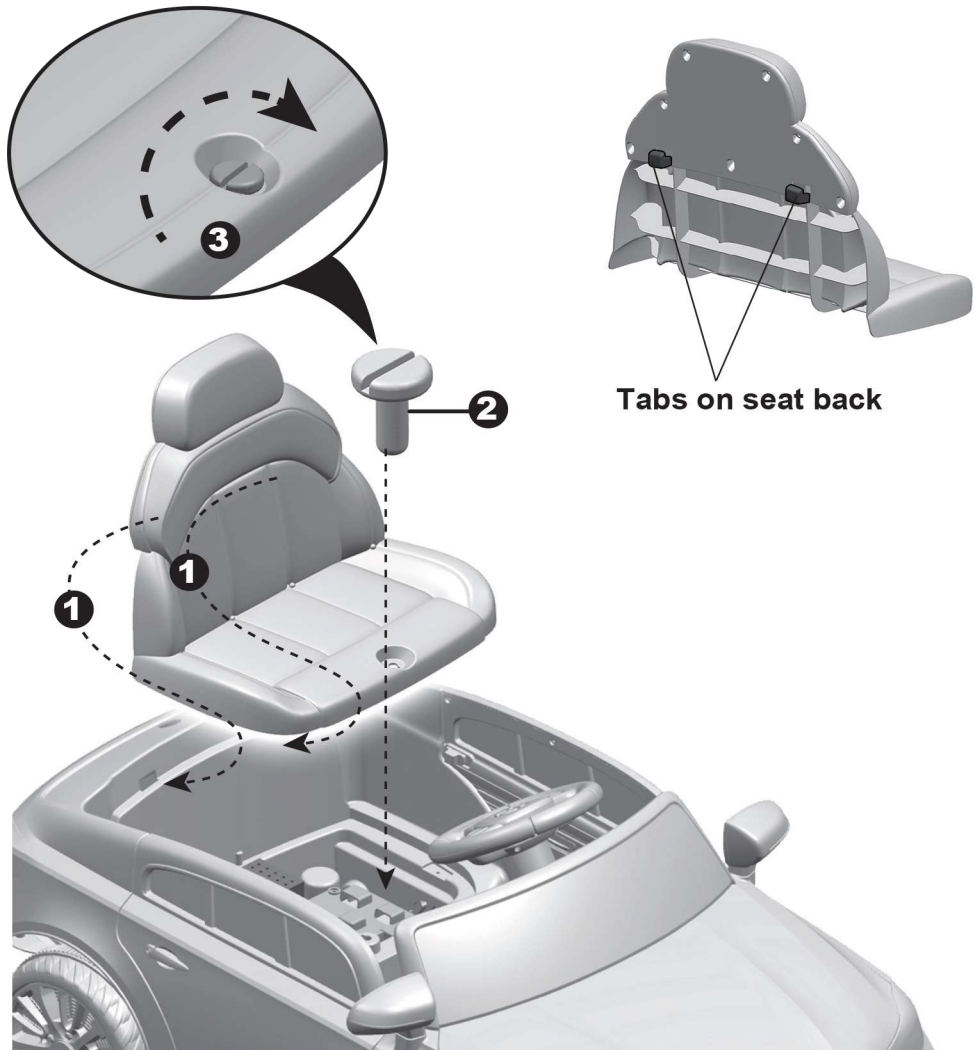

1. Fit the tabs on seat back into the slots on the vehicle body.
2. Fit the seat lock through the hole on the seat and into the hole on the vehicle.
3. Make the seat lock a quarter turn to lock it.

**IMPORTANT!**

Always stop vehicle when changing the speed or direction to avoid damage the gears and motor.

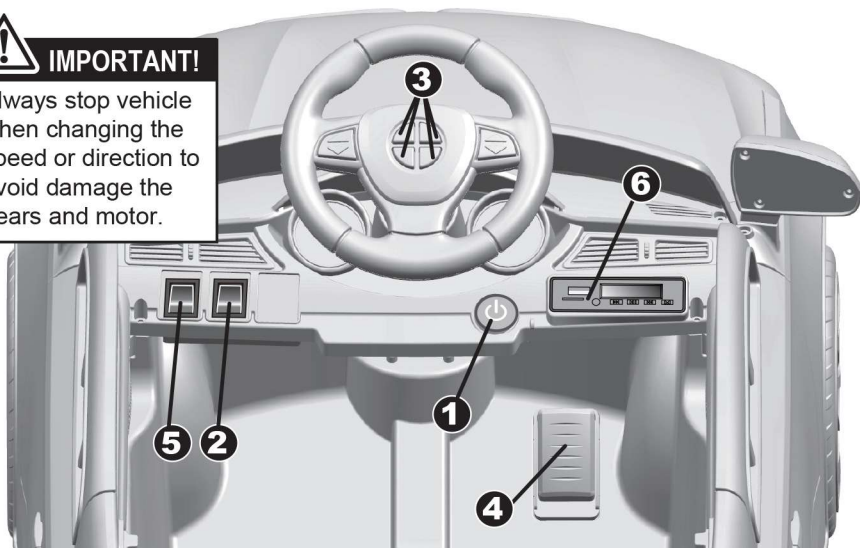

1. **Power Switch:** Turns the vehicle on and off.
2. **Forward/Reverse switch:** Changes the direction that vehicle moves from forward to reverse.
3. **Sounds buttons:** Press for sounds playing.
4. **Foot pedal:**
 - To move the car, press the pedal down.
 - To brake or slow down, release pressure from the pedal.
5. **Swing function(if equipped):** Operate the vehicle to kiddie car.
6. **Mp3 player:**

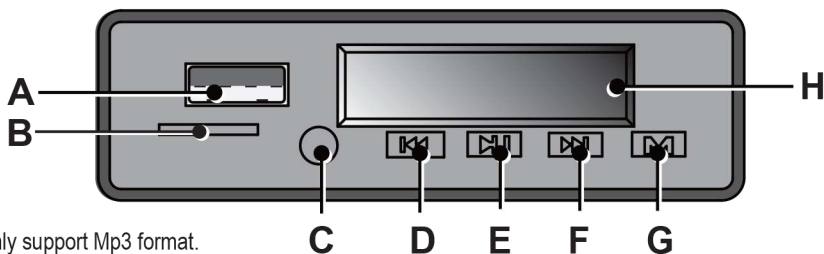

- A. **USB slot:** Only support Mp3 format.
- B. **TF card slot:** Only support Mp3 format.
- C. **Auxiliary input:** Allow the audio from your portable music player or phone to be played through the vehicle speakers.
- D. **Previous / Increase volume:** Long press for increasing the volume.
- E. **Play / Pause:** Playing and pausing the music.
- F. **Next / decrease volume:** Long press for decreasing the volume.
- G. **Change the audio input:** This button worked while you inserted two audio input devices.
- H. **Display screen:** It displays the power level of the battery when the vehicle is stop.

1WD : When the numerical value less than 5, recharge the battery please.

2WD : When the numerical value less than 10, recharge the battery please.

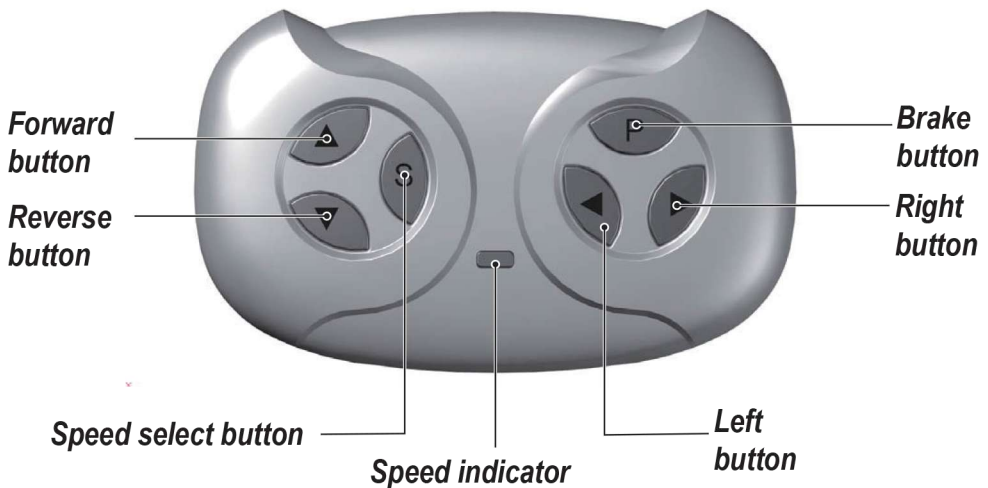

ASSEMBLY

Lift the battery compartment door on the back of the controller and insert two AAA(LR03) batteries.

NOTE: This product did not included the AA(LR6) batteries. Follow the battery information on page 1.

1. Connection button

Long press the forward and reverse buttons for 3 seconds, and the speed indicator flashes. Then power on the vehicle, the speed indicator goes to long bright, means the connection successful. If the speed indicator no response, means the connection failed. Replace the batteries and retry.

2. Brake button

Press the button to stop the vehicle, press it again to release the brake.

3. Speed select button

The switch operates the vehicle to move in low, normal or high speed.

HINT: The vehicle is designed to operate in low speed only in reverse.

NOTE:

- Leave the remote controller idling for about 10 seconds, it will shut down automatically.
- Repeat step 1 when you replace the batteries of the remote controller.



- The POWER SWITCH must be turned in **OFF** position when charging.
 - Before the first use, you should charge the battery for 4-6 hours. Do not recharge the battery for more than 10 hours to avoid overheating the charger.
 - When the vehicle begins to run slowly, recharge the battery.
1. Plug the charger port into the input socket.
 2. Plug the charger plug into a wall outlet. The battery will begin charging.

- It is parents' responsibility to check main parts of the toy before using. Must regularly examine for potential hazard, such as the battery, charge, cable or cord, plug, screws are fastening enclosure of other parts and that in the event of such damage, the toy must not be used until that damage had been properly removed.
- Make sure the plastic parts of the vehicle are not cracked or broken.
- Occasionally use a lightweight oil to lubricate moving parts such as wheels.
- Park the vehicle indoors or cover it with a tarp to protect it from wet weather.
- Keep the vehicle away from sources of heat, such as stoves and heaters. Plastic parts may melt.
- Recharge the battery after each use. Only an adult can handle the battery. Recharge the battery at least once a month when the vehicle Raider is not being used.
- Do not wash the vehicle with a hose. Do not wash the vehicle with soap and water. Do not drive the vehicle in rainy or snowy weather. Water will damage the motor, electric system and battery.
- Clean the vehicle with a soft, dry cloth. To restore shine to plastic parts, use a non-wax furniture polish. Do not use car wax. Do not use abrasive cleaners.
- Do not drive the vehicle in loose dirt, sand or fine gravel which could damage the moving parts, motors or the electric system.
- When not using, all the electrical source should be turn off. Turn off the power switch and disconnect the battery connection.

Problem	Possible Cause	Solution
Vehicle does not run	Battery low on power	Recharge battery.
	Thermal fuse has tripped	Reset fuse, see <Fuse>
	Battery connector or wires are loose	Check that the battery connectors are firmly plugged into each other. If wires are loose around the motor contact customer care.
	Battery is dead	Replace battery, contact customer care.
	Electrical system is damaged	Contact customer care.
	Motor is damaged	Contact customer care.
Vehicle does not run very long	Battery is under charged	Check that the battery connectors are firmly plugged into each other when recharging
	Battery is old	Replace battery, contact customer care.
Vehicle runs sluggishly	Battery low on power	Recharge battery, contact customer care.
	Battery is old	Replace battery, contact customer care.
	Vehicle is overload	Reduce weight on vehicle. Maximum user weight is 35 kgs.
	Vehicle is being used in harsh conditions	Avoid using vehicle in harsh conditions ,see <Safety>.
Vehicle needs a push to go forward	Poor contact of wires or Connectors	Check that the battery connectors are firmly plugged into each other. If wires are loose around the motor, contact customer care.
	"Dead Spot" on motor	A dead spot means the electric power is not being delivered to the terminal connection and the vehicle needs repair. Contact customer care.
Difficult shifting from forward to reverse or vice-versa	Attempting to shift while the vehicle is motion	Completely stop the vehicle and shift, see <Use Your New Vehicle>
Loud grinding or clicking noises coming from motor or gear box	Motor or gears are damaged	Contact customer care.
Battery will not recharge	Battery connector or adapter connector is loose	Check that the battery connectors are firmly plugged into each other.
	Charger not plugged in	Check that the battery charger is plugged into a working wall outlet.
	Charger is not working	Contact customer care.
Charger feels warm when recharging	This is normal and not a cause for concern	

Completely read through this manual and the troubleshooting guide table before calling. If you still need help resolving the problem **Contact customer care info@mekashi.toys**

Disposal Of Battery



- Your sealed lead-acid battery must be recycled or disposed of in an environmentally sound manner.
- Do not dispose of your lead-acid battery in a fire. The battery may explode or leak.
- Do not dispose of a lead-acid battery in your regular, household trash. The incineration, land filling or mixing of sealed lead-acid batteries with household trash is prohibited by law.

Customer Care Contact:

Masoom Playmates Pvt Ltd.

C-148 Hosiery Complex, Phase-2 Extn., NOIDA-201305, Uttar Pradesh, India

Email: info@mekashi.toys ; mail@masoomtoys.in

Phone: +91 9810344926

Website: www.mekashi.toys