

Roof Report



415 South Dixie Street, London, Kentucky, United States

3624 sqft

10 facets

Predominant Pitch 9/12



Nearmap Feb 28, 2022







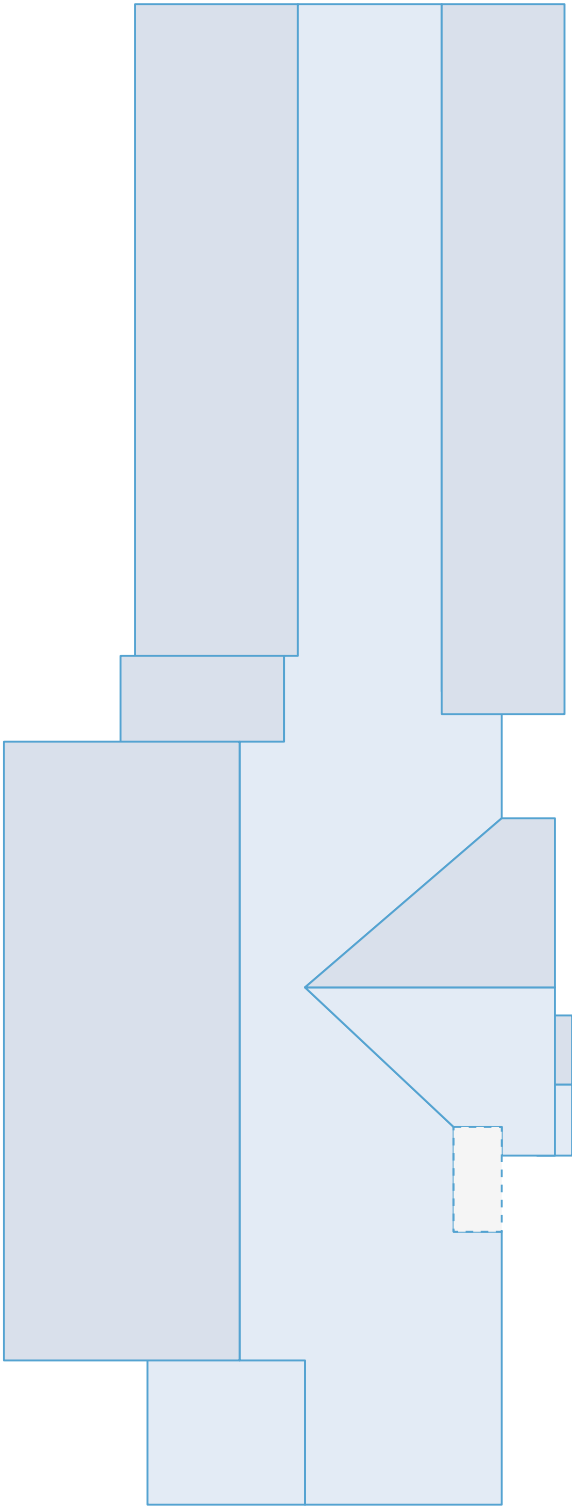





Diagram

415 South Dixie Street, London, Kentucky, United States



Length Measurement Report

415 South Dixie Street, London, Kentucky, United States

	Eaves 188ft 0in		Valleys 35ft 0in		Hips 0ft 0in
	Ridges 122ft 1in		Rakes 166ft 5in		Wall Flashing 10ft 1in
	Step Flashing 62ft 8in		Transitions 46ft 9in		Parapet Wall 0ft 0in
	Unspecified 108ft 5in				

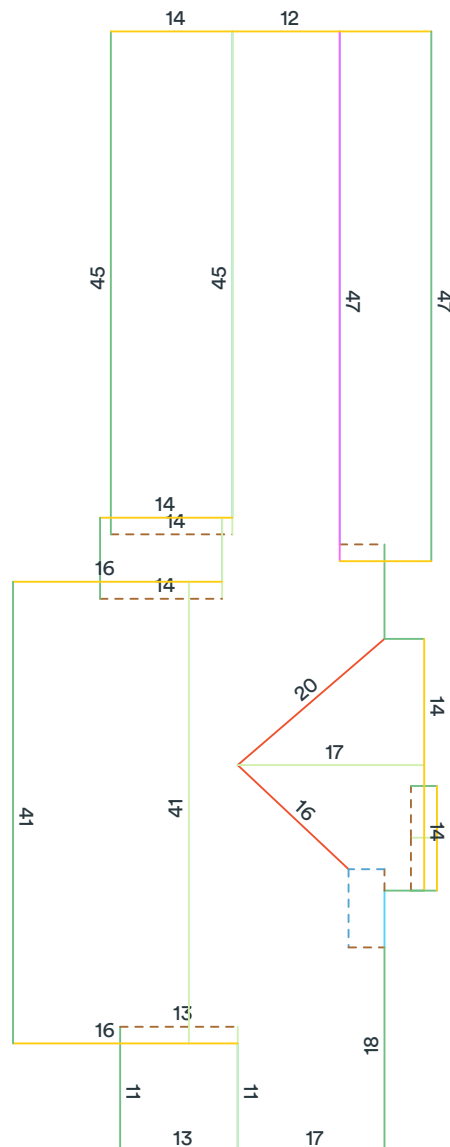

Note: The above diagram contains measurements that have been rounded up. 6 and 9 are written ●6 and ●9 to avoid confusion. Some edge length totals have been hidden from the diagram to avoid overcrowding. Flashings are depicted as dotted lines.



Area Measurement Report

415 South Dixie Street, London, Kentucky, United States

Total Roof Area: 3624 sqft	Predominant Pitch: 9/12
Pitched Roof Area: 2980 sqft	Predominant Pitch Area: 2570 sqft
Flat Roof Area: 643 sqft	Unspecified Pitch Area: 0 sqft
Two Story Area: 0 sqft	
Two Layer Area: 0 sqft	

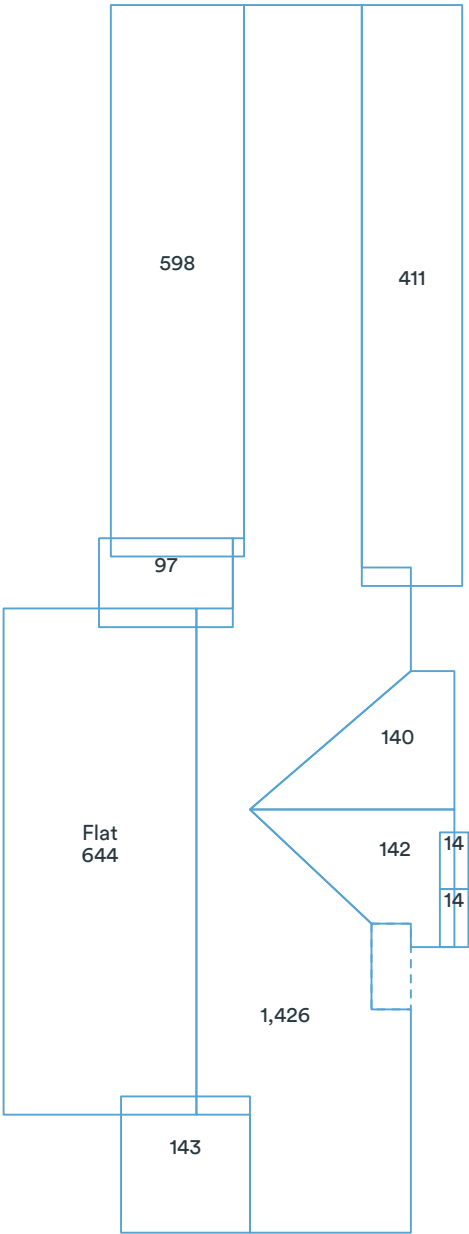

Note: The above diagram contains measurements rounded to the nearest whole number. The total at the top of the page is the sum of all the unrounded (exact) measurements, which is then rounded. Flashings are depicted as dotted lines. Deleted facets, which are not labeled with area, (Skylights, Chimneys, AC units) are omitted from area sums.

415 South Dixie Street, London, Kentucky, United States

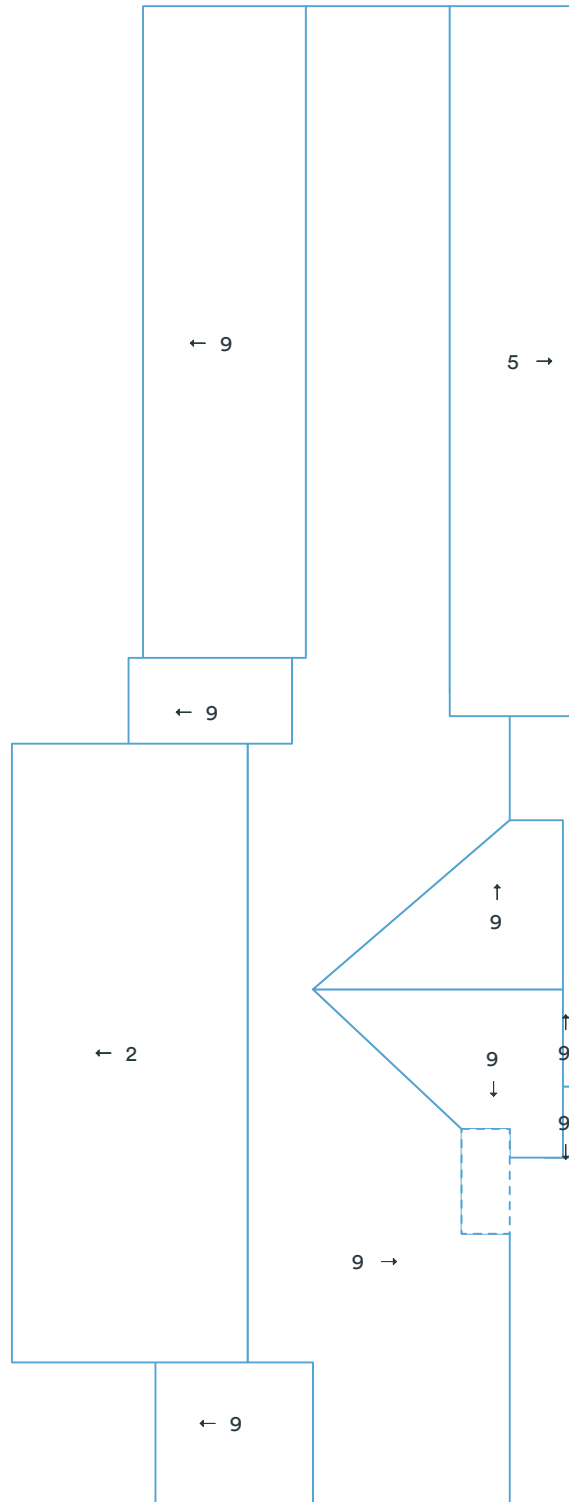

5

All Structures Summary

415 South Dixie Street, London, Kentucky, United States

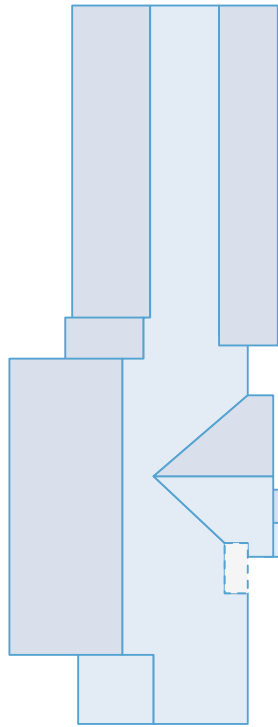

Measurements

Total Roof Area	3624 sqft
Total Pitched Area	2980 sqft
Total Flat Area	643 sqft
Total Roof Facets	10 facets
Predominant Pitch	9/12
Total Eaves	188ft 0in
Total Valleys	35ft 0in
Total Hips	0ft 0in
Total Ridges	122ft 1in
Total Rakes	166ft 5in
Total Wall Flashing	10ft 1in
Total Step Flashing	62ft 8in
Total Transition	46ft 9in
Total Parapet Walls	0ft 0in
Total Unspecified	108ft 5in
Hips + Ridges	122ft 1in
Eaves + Rakes	354ft 6in

Pitch	2/12	5/12	9/12
Area (sqft)	644	411	2,570
Squares	6.5	4.2	25.7

Waste %	0%	10%	12%	15%	17%	20%	22%
Area (sqft)	3,624	3,986	4,059	4,168	4,240	4,349	4,421
Squares	36.3	39.9	40.6	41.7	42.4	43.5	44.3

We've calculated the waste percentages you might expect for this job. A number of factors are involved in determining which waste percentage to use including: how complex the roof is, and your roof application style. These numbers only include the roof area. You will also need to calculate the quantity of materials you will need for hips, valleys, ridges, and starter lengths.

This report was prepared by Roofr. Copyright © 2023 Roofr.com | All rights reserved.

Material Estimate

415 South Dixie Street, London, Kentucky, United States

Product	Unit	Waste (0%)	Waste (10%)	Waste (15%)	Waste (20%)
Shingle (total sqft)		2,981 sqft	3,279 sqft	3,428 sqft	3,577 sqft
IKO - Cambridge	bundle	90	99	103	108
CertainTeed - Landmark	bundle	91	100	105	110
GAF - Timberline	bundle	91	100	105	110
Owens Corning - Duration	bundle	91	100	105	110
BP - Mystique	bundle	91	100	105	109
Starter (eaves + rakes)		355 ft	390 ft	408 ft	426 ft
IKO - Leading Edge Plus	bundle	4	4	4	4
CertainTeed - SwiftStart	bundle	4	4	4	4
GAF - Pro-Start	bundle	3	4	4	4
Owens Corning - Starter Strip	bundle	4	4	4	5
BP - Starter Strip	bundle	6	6	6	7
Ice and Water (eaves + valleys + flashings)		296 ft	326 ft	341 ft	355 ft
IKO - StormShield	roll	5	6	6	6
CertainTeed - WinterGuard	roll	5	6	6	6
GAF - WeatherWatch	roll	5	5	6	6
Owens Corning - WeatherLock	roll	4	5	5	5
BP - Weathertex	roll	5	6	6	6
Synthetic (total sqft; no laps)		2,981 sqft	3,279 sqft	3,428 sqft	3,577 sqft
IKO - Stormtite	roll	3	4	4	4
CertainTeed - RoofRunner	roll	3	4	4	4
GAF - Deck-Armor	roll	3	4	4	4
Owens Corning - RhinoRoof	roll	3	4	4	4
BP - PRODECK	roll	3	4	4	4
Capping (hips + ridges)		123 ft	135 ft	141 ft	147 ft
IKO - Hip and Ridge	bundle	4	4	4	4
CertainTeed - Shadow Ridge	bundle	3	3	4	4
GAF - Seal-A-Ridge	bundle	5	6	6	6
Owens Corning - DecoRidge	bundle	7	7	8	8
BP - Accu-Ridge	bundle	4	4	4	4
Other					
8' Valley (no laps)	sheet	5	5	6	6
10' Drip Edge (eaves + rakes; no laps)	sheet	36	39	41	43

These calculations are approximations and are not guaranteed. Always double check material orders quantities before using these calculations. The calculations are based off the the totals from the report of pitched facets only and the final numbers are rounded to the hundredths of the unit.