

EverAir™ Conditioned Air

EverAir has developed a cost effective air conditioning solution for vintage Beech Aircraft Using the O/IO-470 Engine.

- Engine driven compressor utilizing R134a refrigerant
- Affordably priced 16,000 BTU system
- Simple Cool—Off—Ventilate system with a 3-Speed fan selector

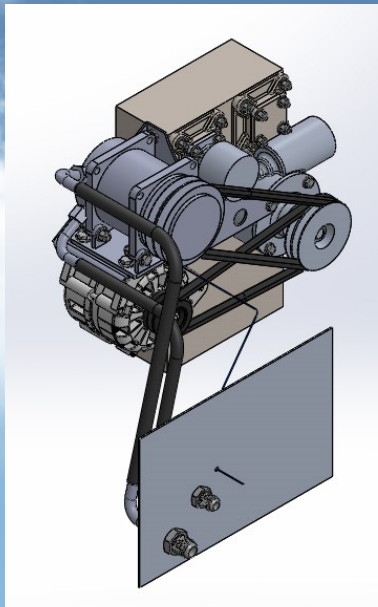

Engine driven compressor mounts on accessory case with a low mounted alternator location.

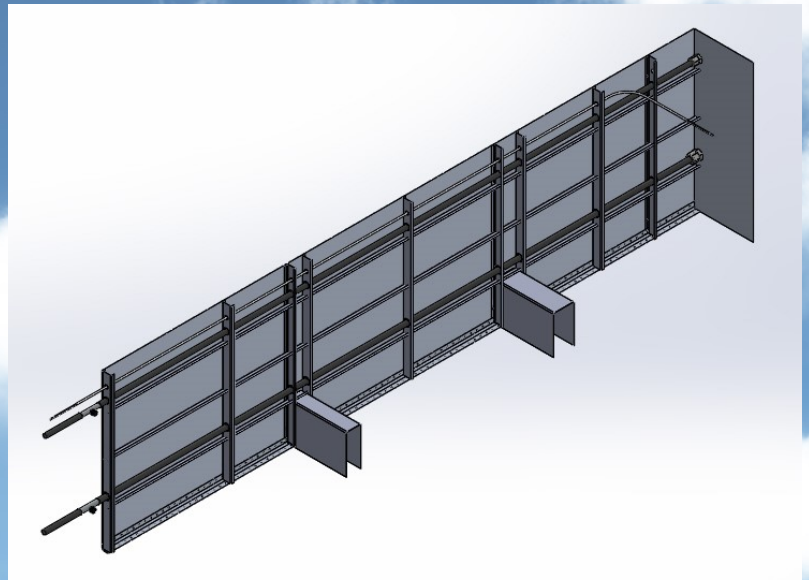

Refrigerant lines route through cockpit area bulkhead.

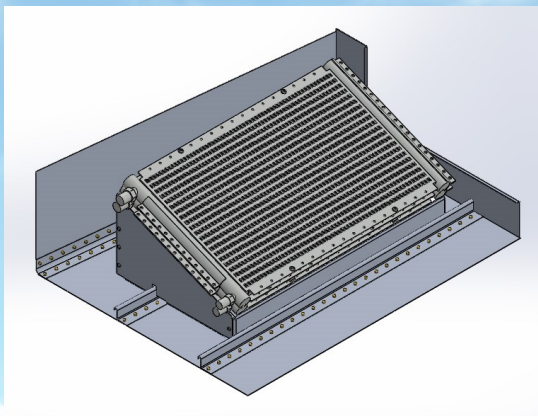

Tailcone mounted condenser coils use out of sight belly mounted louver pan-

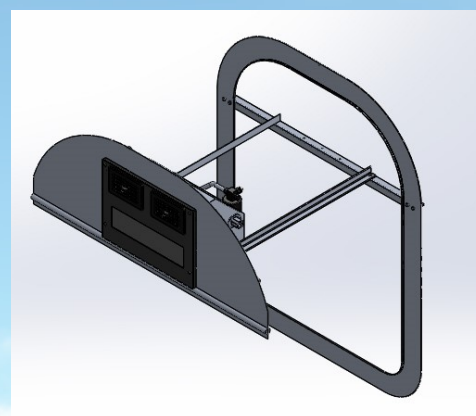

Evaporator unit mounts on baggage compartment bulkhead and includes directional louver vents.

EverAir LLC
615-973-3518
coldbeech@gmail.com
www.coldbeech.com