

CZK-3671

Contents

● SAFETY INSTRUCTIONS	2
● PRODUCT DESCRIPTION	2
● OPERATING INSTRUCTIONS	3
● SPECIFICATIONS	5
● FEATURES	6
● USING TIPS	6
● CUSTOMER SERVICE	6

SAFETY INSTRUCTIONS

1. Read and follow all instructions before use.
2. Keep the product out of reach of children.
3. Do not expose the air inflator to rain or water of any kind.
4. Do not use the product for applications outside of its intended use.
5. Do not disassemble and assemble this product without permission.
6. Do not store the air inflator in high temperature or humid environments.
7. Do not place the air inflator near hot sources, such as your vehicle's exhaust pipes.
8. Do not use the air inflator near flammable liquids or in gaseous or explosive atmospheres.
9. Check inflation tube for weak and worn conditions before each use, make sure all connections are secure. Don't use if the defect is found.
10. Do not use the air inflator if the power button doesn't power it on or off. An inflator can't be controlled by power button is dangerous.
11. Keep the air inflator dry, clean, and free from oil and grease. Please use dry cloth to clean it.

PRODUCT DESCRIPTION

Product details

- | | | |
|-------------------------------------|---------------------|------------------------|
| ① Button "-" | ⑥ Power bank button | ⑩ Hole for lanyard |
| ② Button "+" | ⑦ Charge indicator | ⑪ Nozzles storage area |
| ③ Display screen | ⑧ Type-C input | ⑫ Inflation tube port |
| ④ Power button | ⑨ USB output | ⑬ LED flashlight |
| ⑤ Unit switch/LED flashlight switch | | |

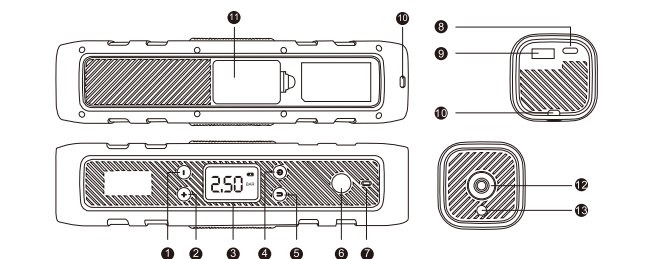

Accessories

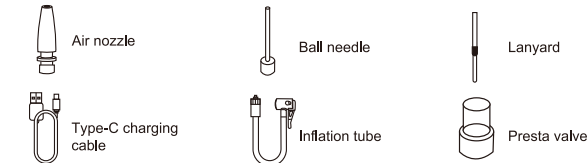

OPERATING INSTRUCTIONS

1. Battery status and charge



- When turn on the inflator:
1. If the battery indicator is always blue, it indicates that the battery is high.
 2. If the battery indicator flashes, it indicates that the battery is low.
- When charge the inflator:
1. If the battery indicator is red, the battery is charging.
 2. If the battery indicator is blue, the battery is fully charged.

2. Instructions for use

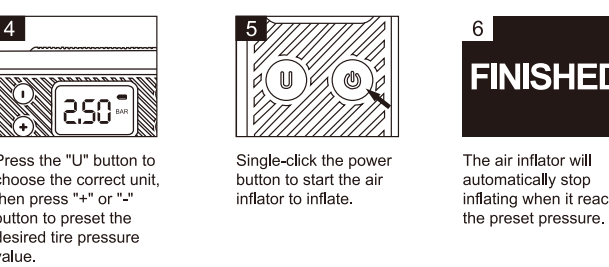
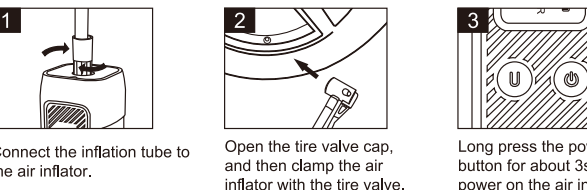

3. Lighting instructions

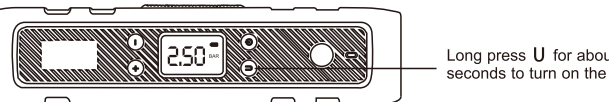

⚠ Attention: Need to press the button first to power on the air inflator

4. Preset tire pressure

Press the "U" button to choose the correct unit, then press "+" or "-" button to preset the tire pressure value. Wait for a few seconds until the number stops flashing. Then press the power button to start the tire inflator to inflate. The air inflator will automatically stop inflating when it reaches the preset pressure.

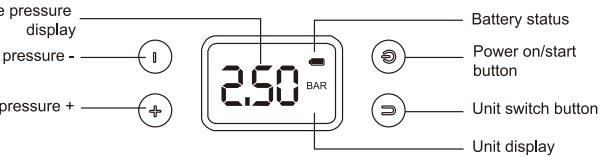

5. Nozzles storage area

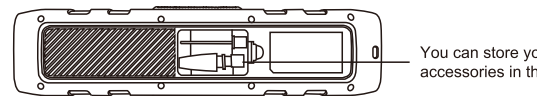

You can store your nozzles accessories in this area.

SPECIFICATIONS

Product name	Cordless Tire Inflator
Model No.	CZK-3671
Voltage	12.6V
Inflation tube length	10.81 IN
USB type	Type-C

FEATURES

1. Fast inflating, low noise.
2. Built-in extra-large capacity lithium battery.
3. Small, compact, portable and easy to store.
4. Preset tire pressure, automatically inflate and stop.
5. Cordless air compressor to pump items, safe and convenient
6. Super bright LED flashlight and 4 optional units, PSI, bar, kPa, kg/cm².
7. Our pump is suitable for bicycles, motorcycles, Lawn mower tires, small and medium cars including SUV but do not support big truck tires, Van, bus, RV.

USING TIPS

1. Please fully charge it before using it for the first time.
2. The product will auto shut off in 40s if you don't use it for a long time.
3. Avoid extended and continuous use. The max time for continuous use is 15 minutes.
4. After extended use, let the inflator to rest for 10 minutes to continue to use it.
5. The inflation tube may heat up during continuous use, please don't touch it while inflating or after use. Let it cool down for a few minutes.

CUSTOMER SERVICE

✉ service@nulksen.com



Made in China