

G2 Radio Pod Installation

Tools you'll need:

1. An 8mm socket or wrench
2. A Torx T30 bit/driver



RADIO NOT INCLUDED



Pry the back of the center dash cover up.



Pull up and out.



Unclip the metal clip from the bottom of the cover and remove cover.

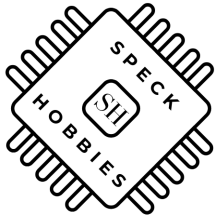

G2 Radio Pod Installation

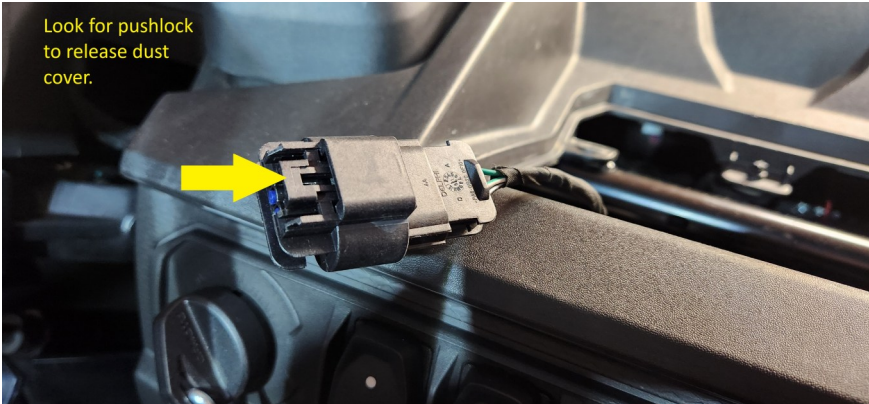

Look for pushlock to release dust cover.

Look for the push lock to release the dust cover.



Squeeze the pushlock and pull away the dust cover to expose the plug.

Squeeze the pushlock and pull away the dust cover to expose the plug.



G2 male Radio plug.

G2 male Radio Plug.



Contains a constant 12V, ACC (12V key on) and a Ground.

Contains a constant 12V, ACC (12V key on) and a Ground.

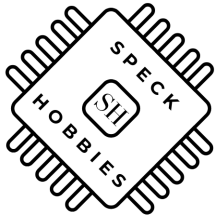

G2 Radio Pod Installation



You'll need a T30 Torx bit or driver to remove the two bolts holding the dash to the center brace.

You'll need a T30 Torx bit or driver to remove the two bolts holding the dash to the center brace.

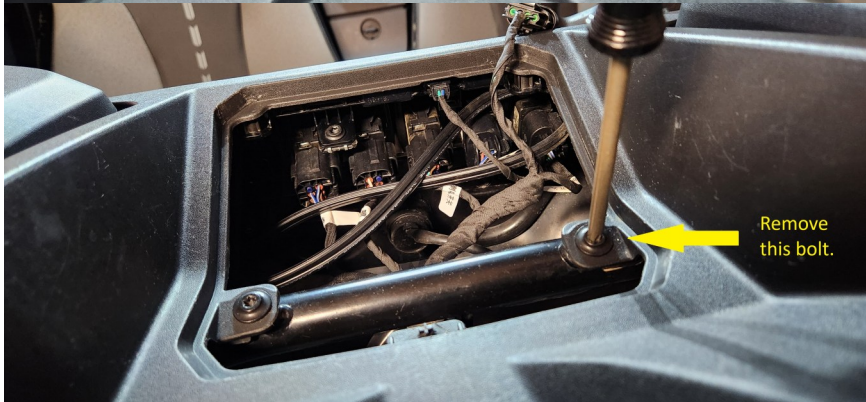

Remove this bolt.

Remove this bolt.

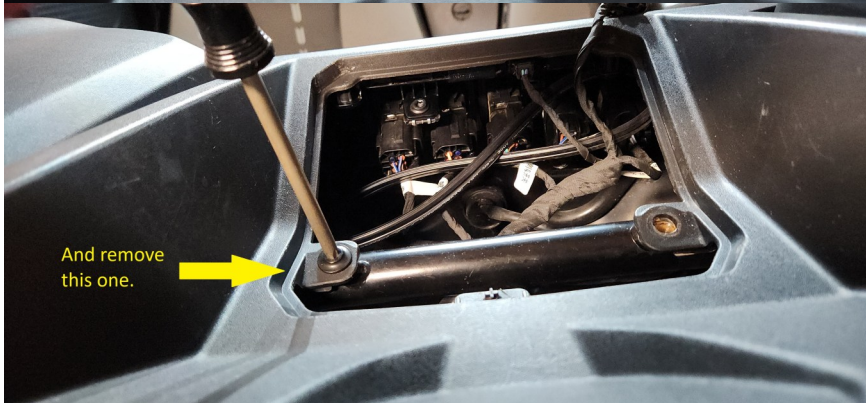

And remove this one.

And remove this one.

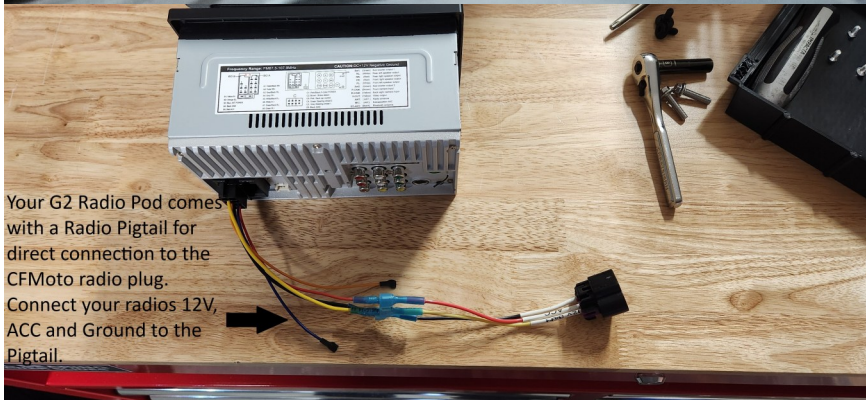

Your G2 Radio Pod comes with a Radio Pigtail for direct connection to the CFMoto radio plug. Connect your radio's 12V, ACC and Ground to the Pigtail.

Your G2 Radio Pod comes with a Radio Pigtail for direct connection to the CFMoto radio plug. Connect your radio's 12V, ACC and Ground to the Pigtail.

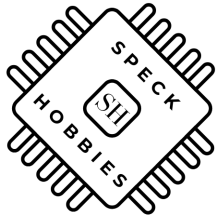

G2 Radio Pod Installation



Plug your Pigtail into the CFMoto Radio plug. Add a dab of dielectric grease to the seal inside the plug.

Plug your Pigtail into the CFMoto Radio plug. Add a dab of dielectric grease to the seal inside the plug.

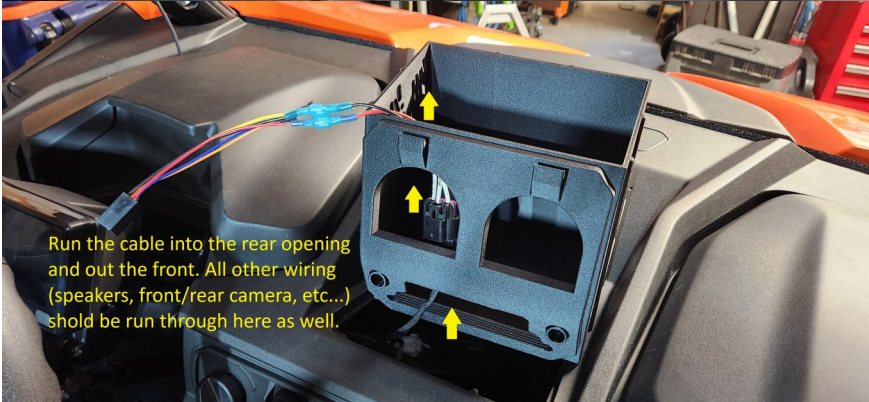

Run the cable into the rear opening and out the front. All other wiring (speakers, front/rear camera, etc...) should be run through here as well.

Run the cable into the rear opening and out the front. All other wiring (speakers, front/rear camera, etc...) should be run through here as well.



These front tabs hook under the front of the dash opening.

These front tabs hook under the front of the dash opening.

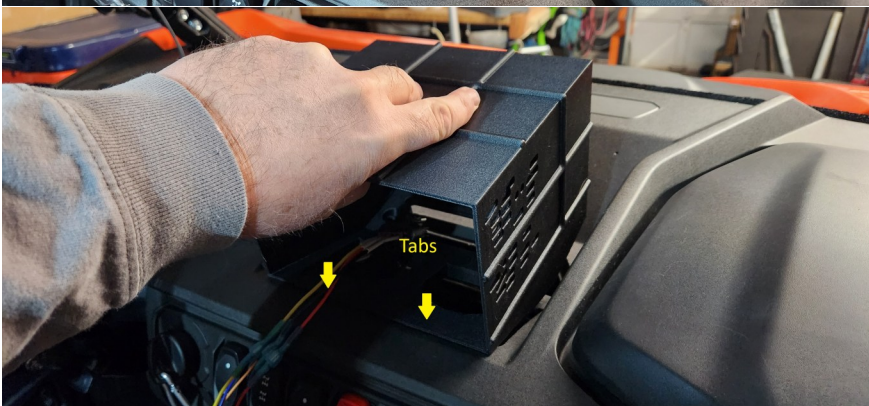

Tabs

Hook the tabs under the front of the dash opening and lay the back down.

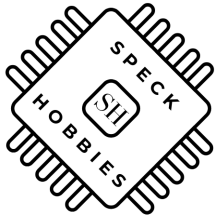

G2 Radio Pod Installation

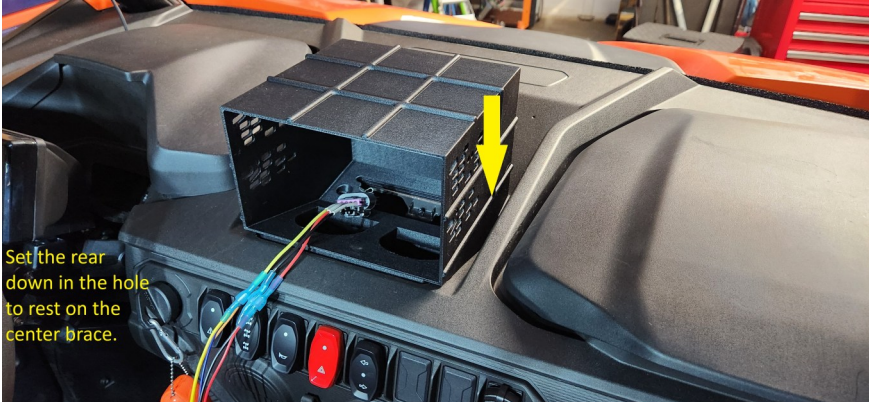

Set the rear down in the hole to rest on the center brace.

Set the rear down in the hole to rest on the center brace.

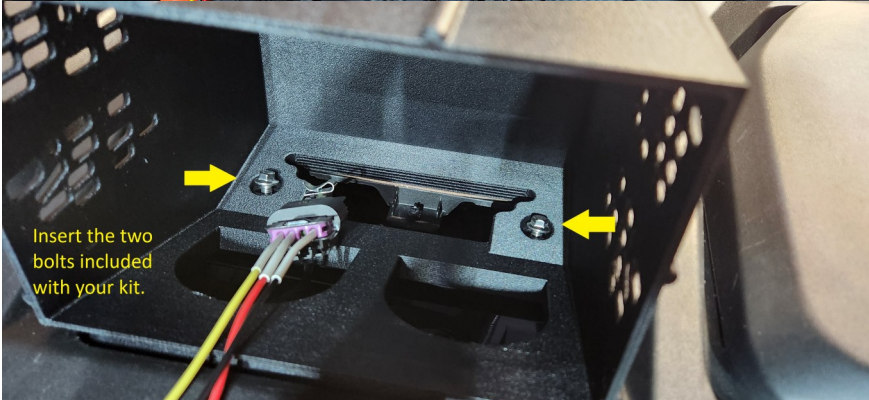

Insert the two bolts included with your kit.

Insert the two bolts included with your kit.



Grab your 8mm socket or wrench.

Grab your 8mm socket or wrench.

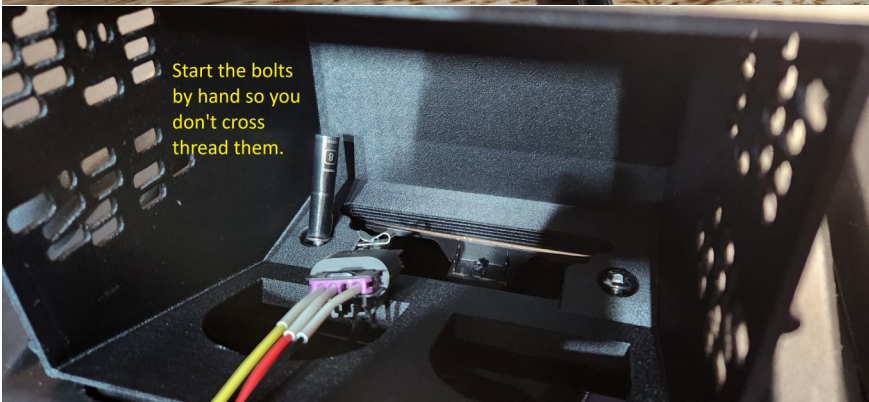

Start the bolts by hand so you don't cross thread them.

Start the bolts by hand so you don't cross thread them.

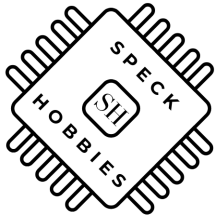

G2 Radio Pod Installation

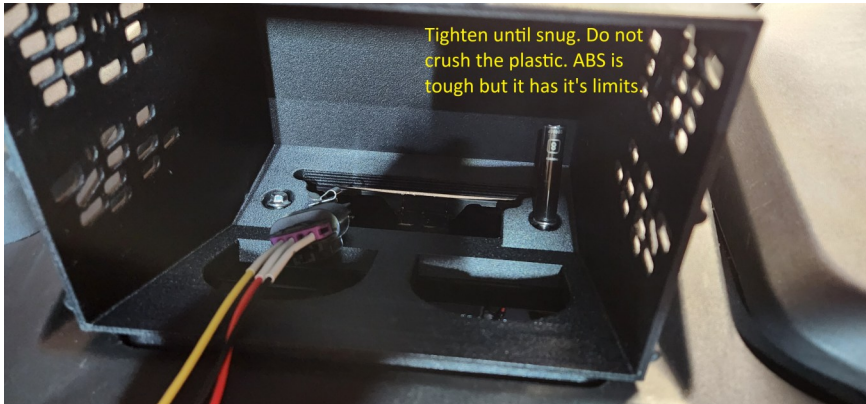

Tighten until snug. Do NOT crush the plastic. ABS is tough but it has it's limits.

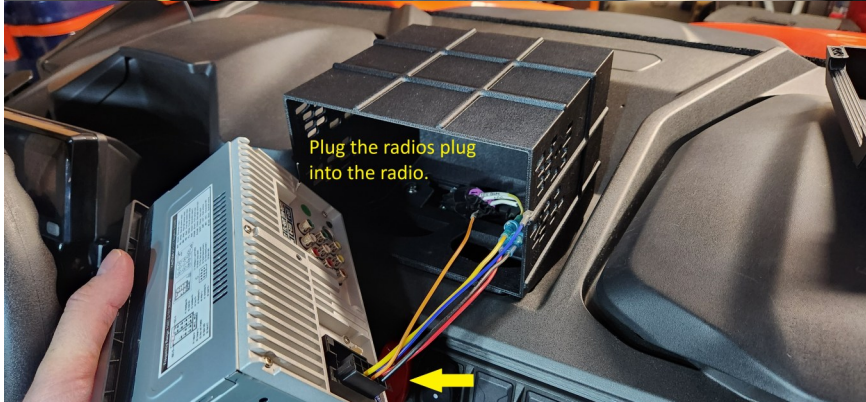

Plug the radio's plug into the radio.

And any other plugs or wires you may have.



Slide the radio into the G2 Radio Pod.



Nice.

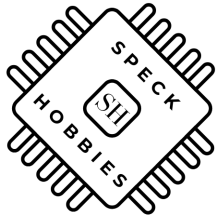

G2 Radio Pod Installation

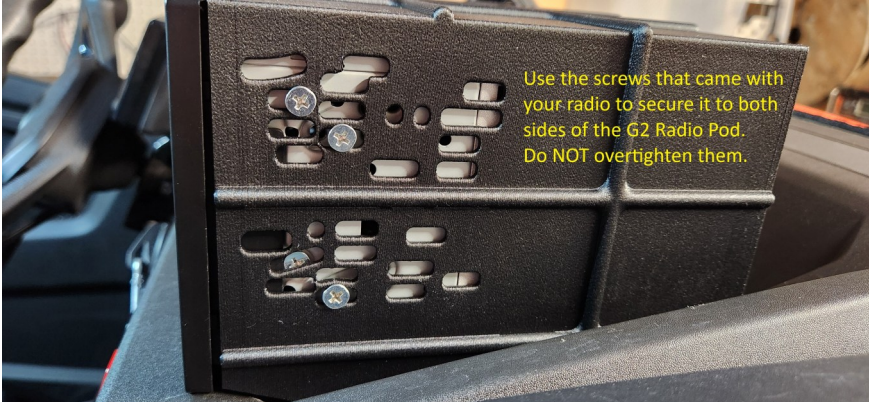

Use the screws that came with your radio to secure it to both sides of the G2 Radio Pod.

Do NOT overtighten them.



Turn the key on.

It's time to rock.

