

# Speckhobbies Key On Accessory Point Installation

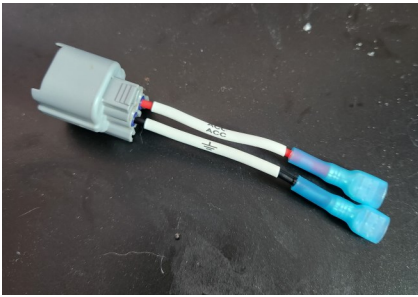

Tools you'll need for installation.

1. Cold beverage of choice.



1. The plug you need is located in the center under the dash. Notice that the grab handle has been removed to make access easier on a 6'-2" 300lb good 'ol boy like me.

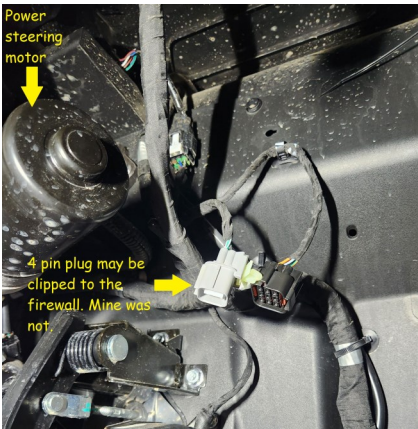

2. Both the 9 pin plug on the right and the 4 pin plug on the left should have protective covers on them to keep dust & water out.

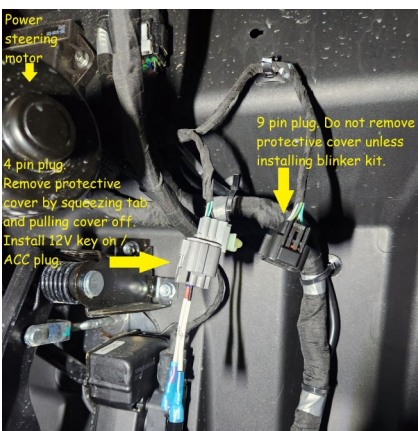

3. Remove the protective cover from the 4 pin plug. It may be clipped to the firewall in your machine. Mine was not. Install your Key On Accessory Point. Push it in till it clicks. Pro tip—apply a little dielectric grease.

That's it. You're done.

Please don't use this as a power source for lights, radio, etc....

Use it to turn on a relay or other powered device only.