

Proform
PF 300



INSTALATION

GENERAL NOTES

The details shown on the following pages are suggestions or guidelines on how to install PFR and PF 300 panels. The information shown is accurate and the installation details shown are proven methods of construction, but it is not intended to cover all instances, building requirements, designs or codes. The details may require changes or revisions due to individual project conditions. The installer should follow these recommended details using proper workmanship procedures.

It is the responsibility of the designer/installer to ensure the details meet particular building requirements and to assure adequate water-tightness. It must be noted that water-tightness is a function of the installer. Proform Metals LTD will be held harmless from any and all claims arising from a lack of water-tightness.

A proper uniform substructure should be used to avoid any panel distortion. All substructures should be designed to meet all necessary code requirements.

The installer should thoroughly familiarize himself/herself with all installation instructions. Before beginning installation of the panels, the installer should examine the substrate to ensure that all supporting members are straight, level and plumb.

The panels should be installed plumb, straight and accurately to the adjacent work. No penetrations shall be placed in the panel system by fasteners except as shown on the installation drawings.

Proform Metals LTD can provide all flashings and accessories shown in the installation drawings unless noted otherwise. Installation procedures shall be in accordance with the manufacture's printed instructions, detail or approved shop drawings. Flashing and trim shall be installed true and in proper alignment, with any exposed fasteners equally spaced for the best appearance.

Some field cutting and fitting of panels and flashings is to be expected by the installer and minor field corrections are a part of normal installation work. Workmanship shall be of the best industry standards and with installation performed by experienced metal craftsman.

Oil canning of metal panels is inherent in the product and is not a cause for rejection.

Contents of this manual are subject to change without notice. Because this manual is revised from time to time, users are advised to check the revision date to be sure they have the most current copy in print. To confirm this book is the most current copy, please visit Proform Metal LTD's website at <http://www.proformmetalsltd.com>.

GENERAL INFORMATION

FASTENER PATTERNS

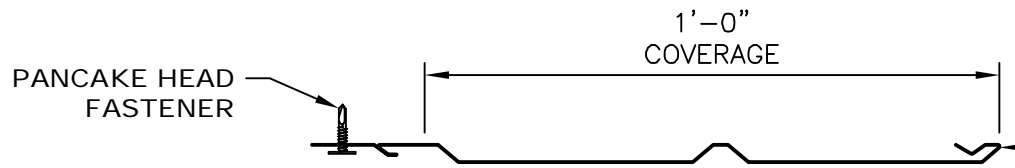

Proform PFR

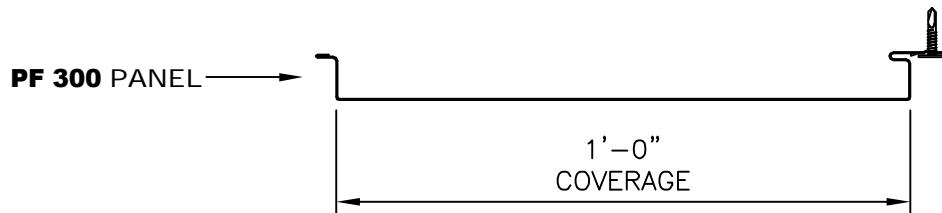

Proform PF 300

GENERAL INFORMATION

INSTALLATION TECHNIQUES

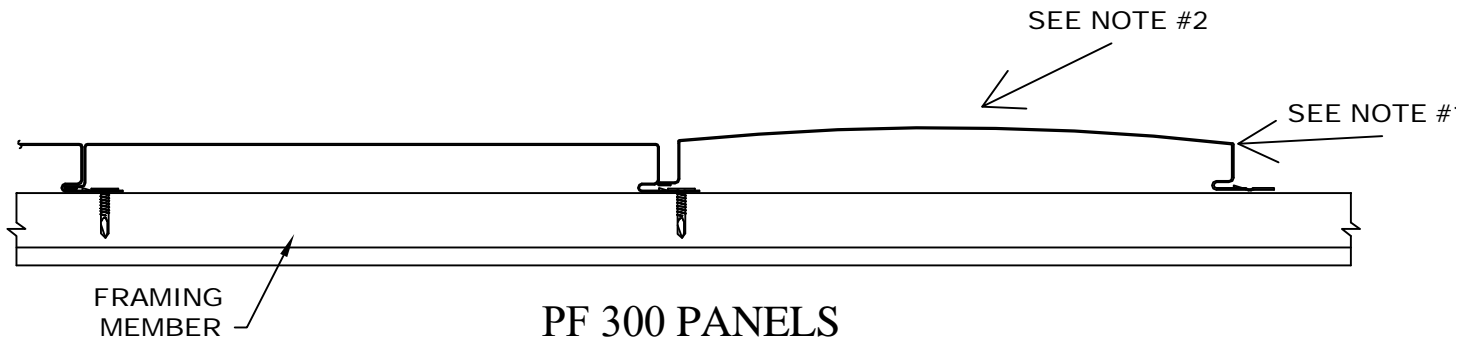

- NOTES: 1. Using hand, push panel until a bow is formed in the panel.
2. Using rubber palmed gloves and an angled forced blow, slap bow with palm of hand to snap male leg into female leg.
3. To verify panels without sealant are fully engaged, panels will slide lengthwise.
4. To separate panels without sealant, slide the panels lengthwise out of the female leg.

PF 300 PANELS

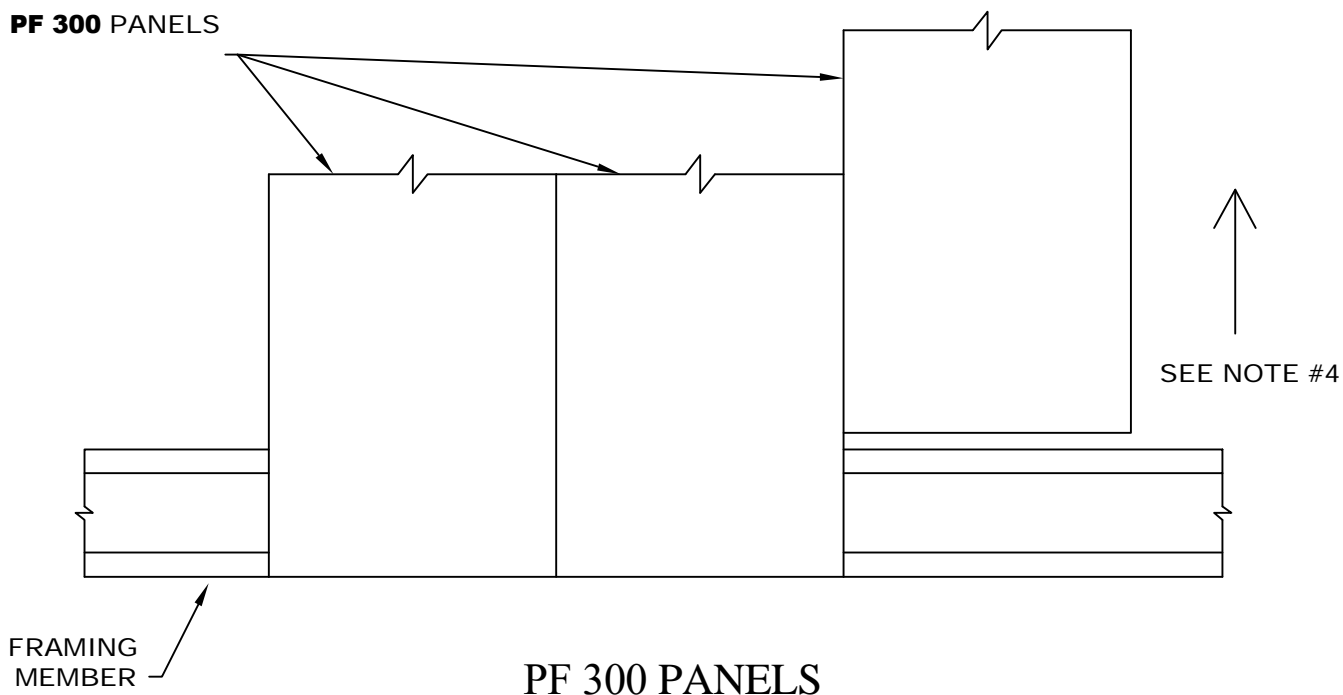

PF 300 PANELS

FASCIA/SOFFIT DETAIL

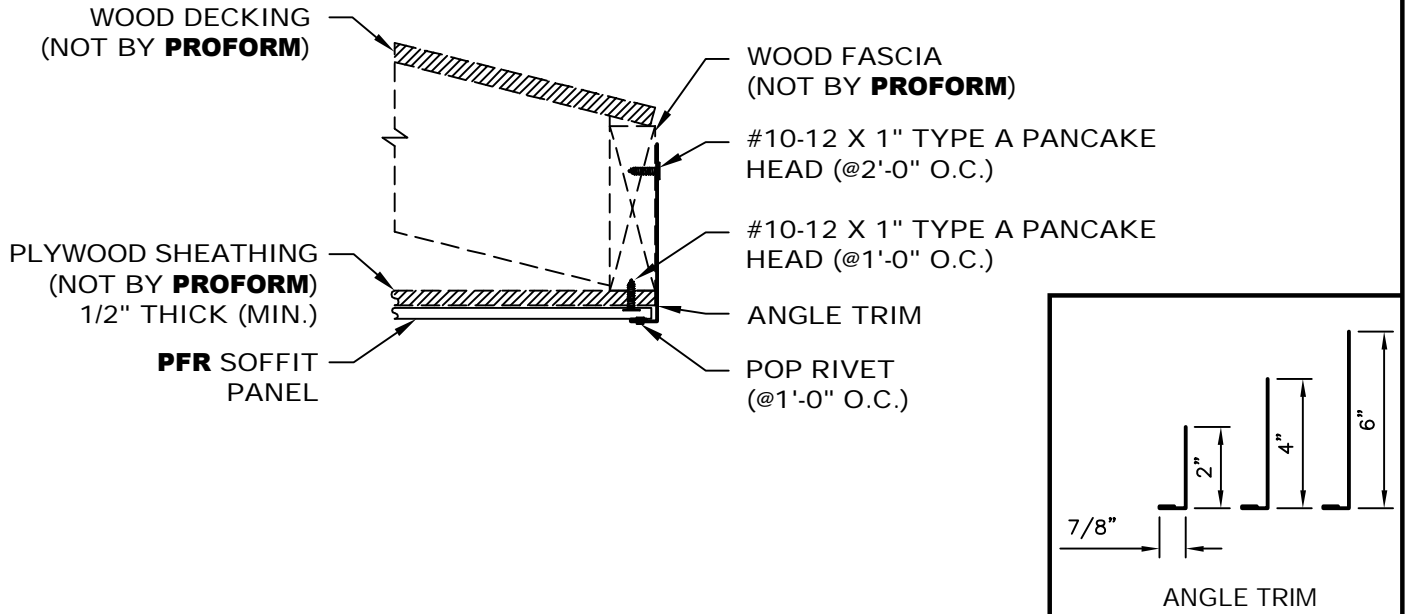

- NOTES: 1. Trim to start and end at building lines.
 2. Attach trim to blocking with #10-12 x 1" Type A Pancake Head at 2'-0" O.C.
 3. Attach panel to sheathing with #10-12 x 1" Type A Pancake Head.

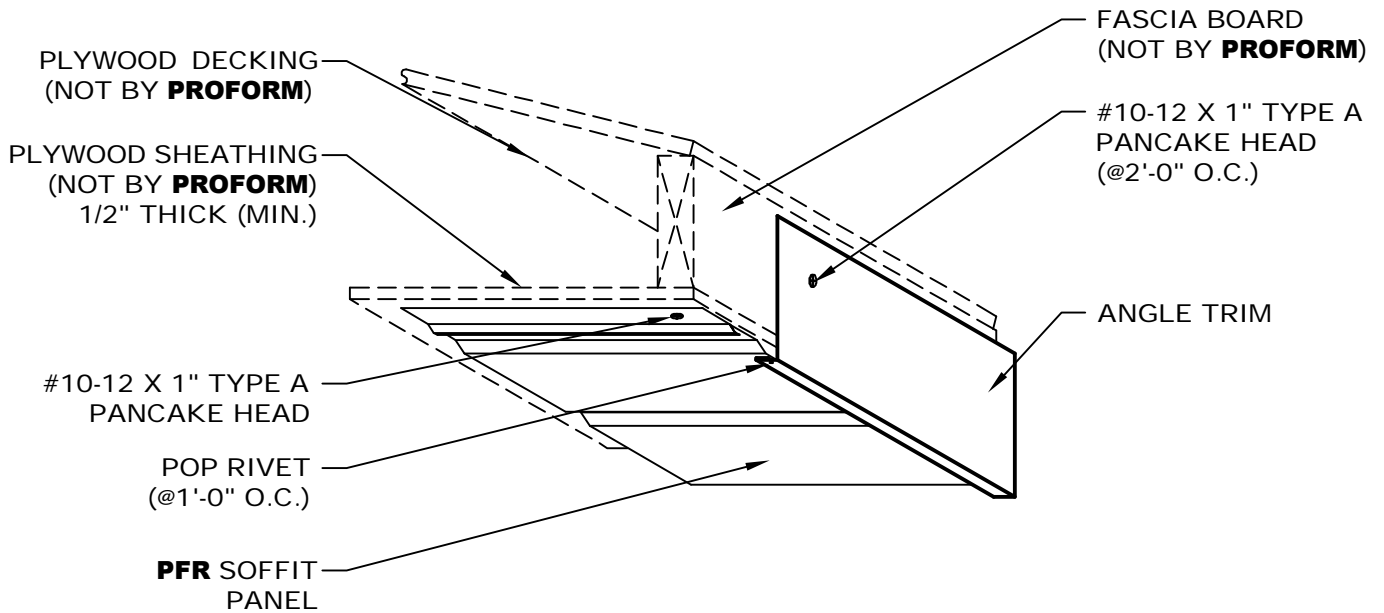

BUILDING/SOFFIT DETAIL

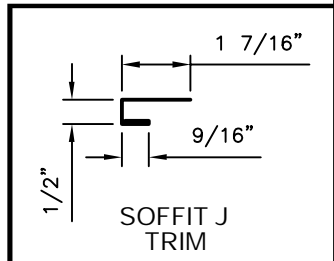
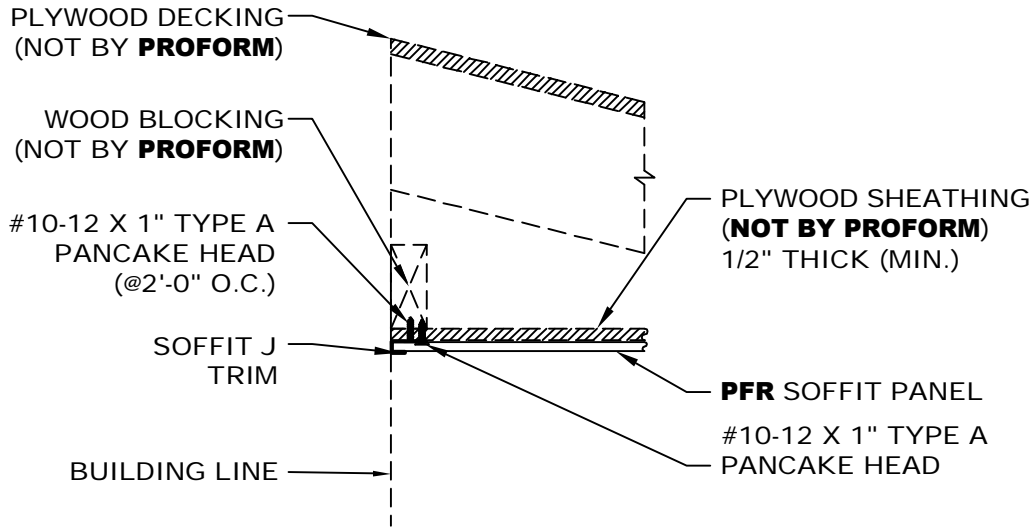

- NOTES: 1. Trim to start and end at building lines.
 2. Attach trim to blocking with #10-12 x 1" Type A Pancake Head at 2'-0" O.C.
 3. Attach panel to sheathing with #10-12 x 1" Type A Pancake Head.

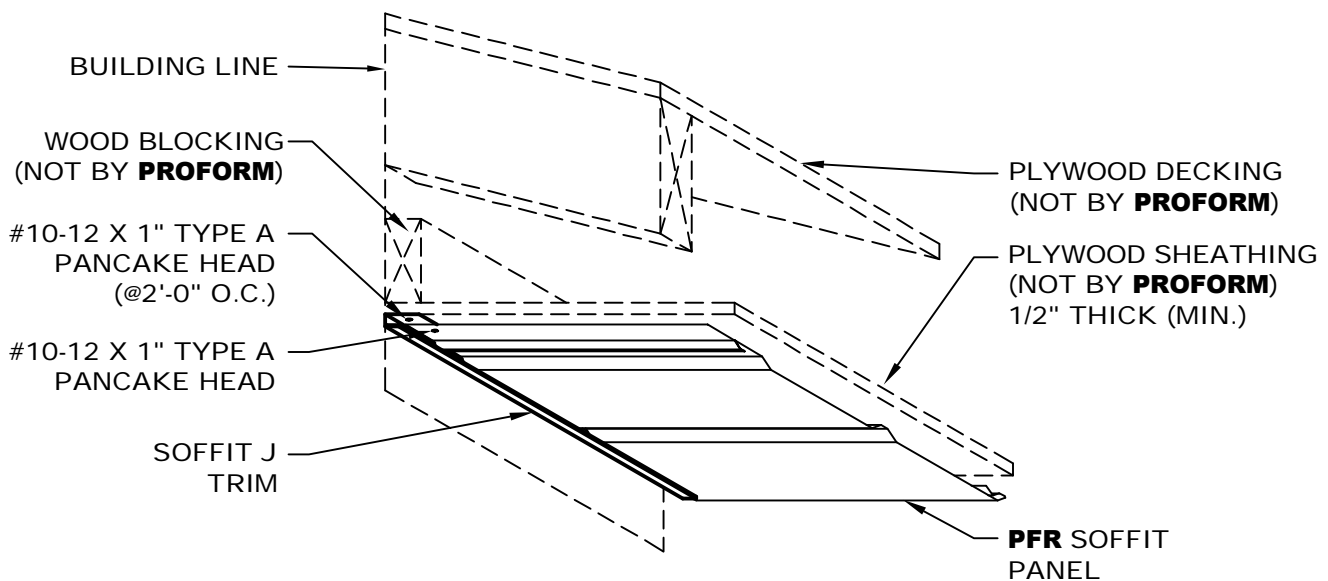

FASCIA/SOFFIT DETAIL

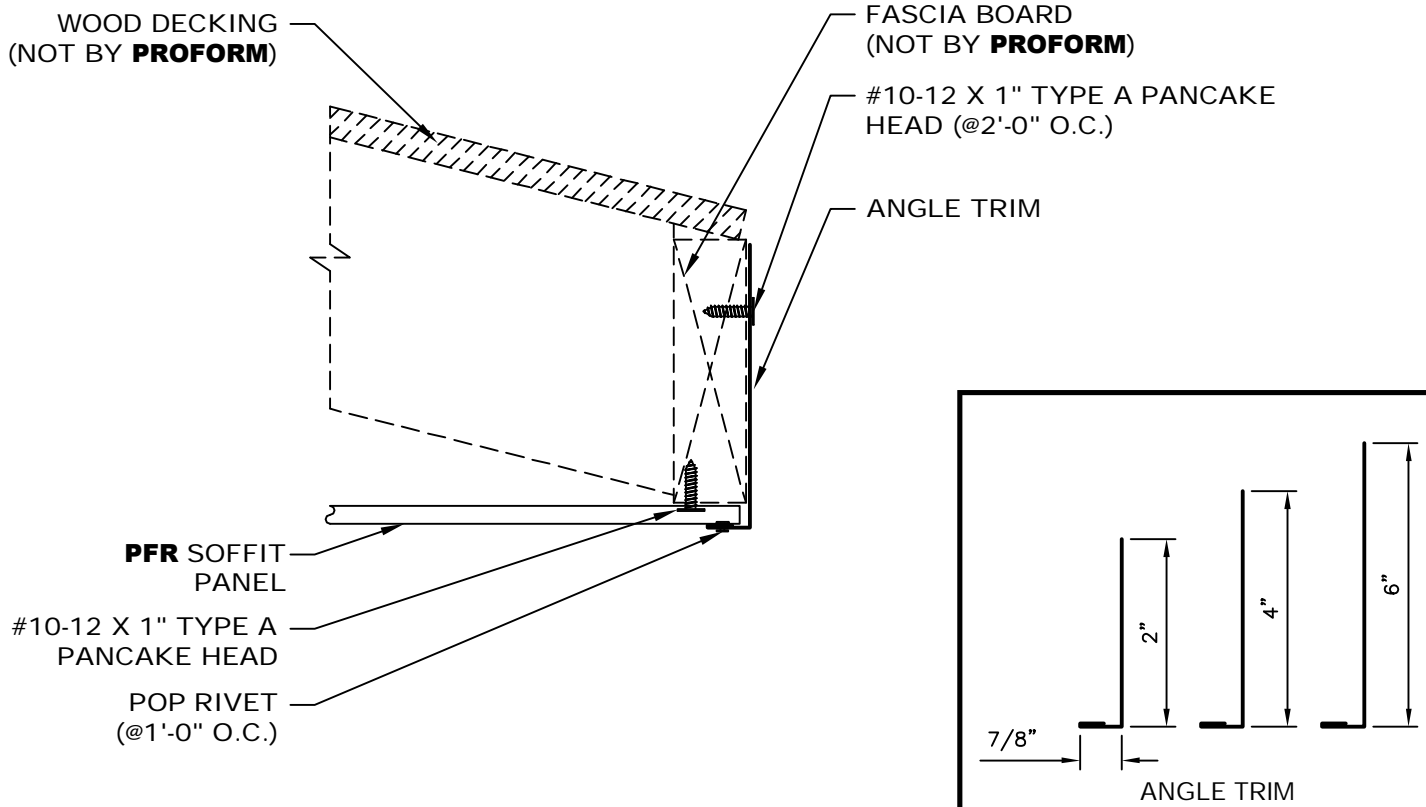

- NOTES: 1. Trim to start and end at building lines.
2. Attach trim to blocking with #10-12 x 1" Type A Pancake Head at 2'-0" O.C.
3. Attach panel to sheathing with #10-12 x 1" Type A Pancake Head.

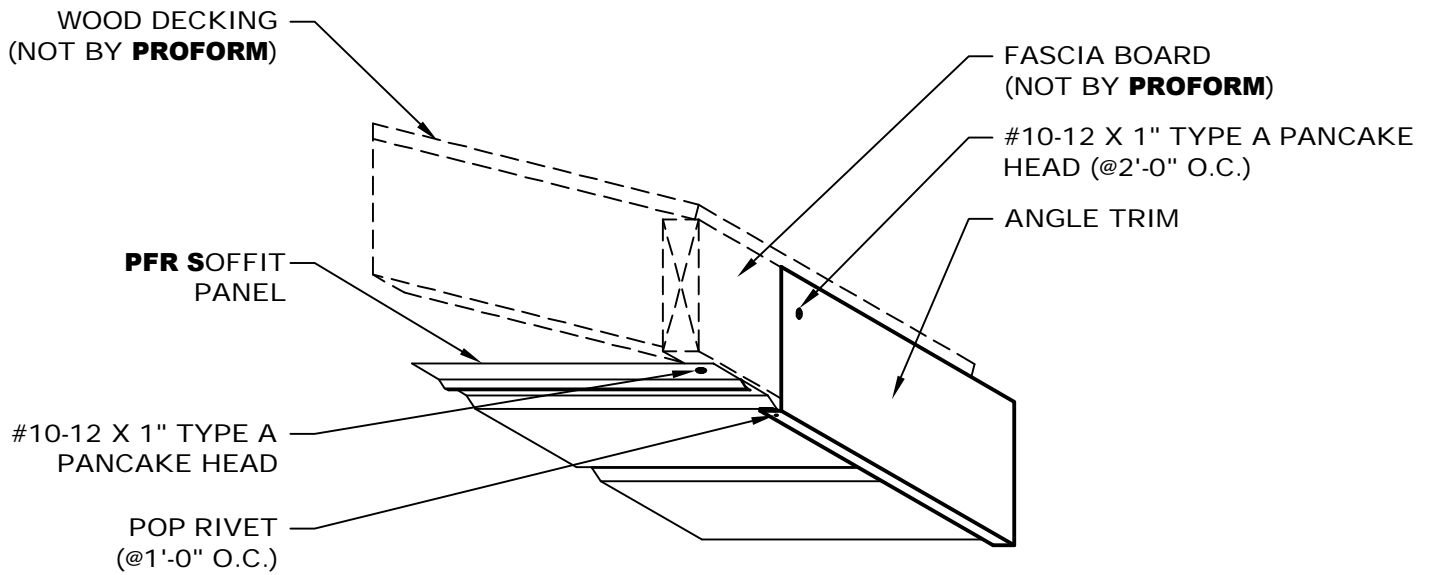

BUILDING/SOFFIT DETAIL

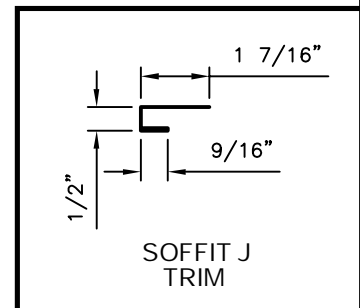
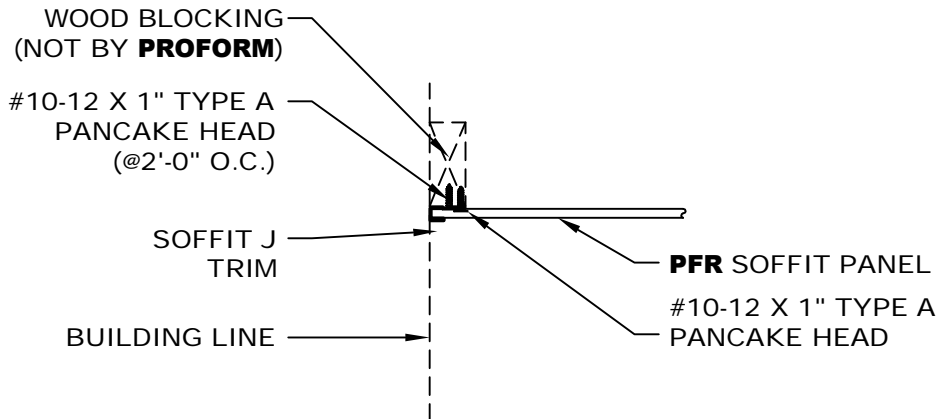

- NOTES: 1. Trim to start and end at building lines.
2. Attach trim to blocking with #10-12 x 1" Type A Pancake Head at 2'-0" O.C.
3. Attach panel to sheathing with #10-12 x 1" Type A Pancake Head.

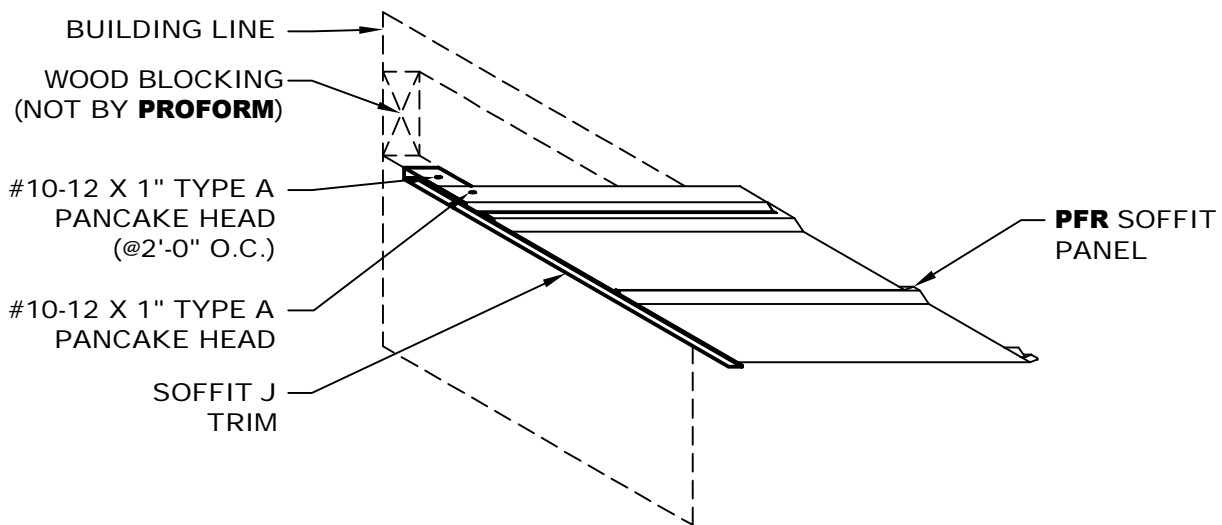

FASCIA/SOFFIT DETAIL

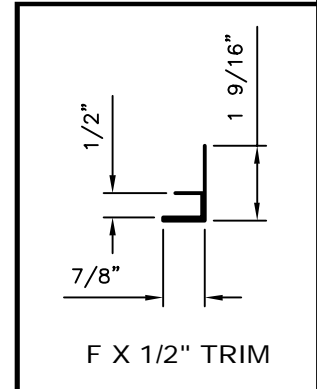
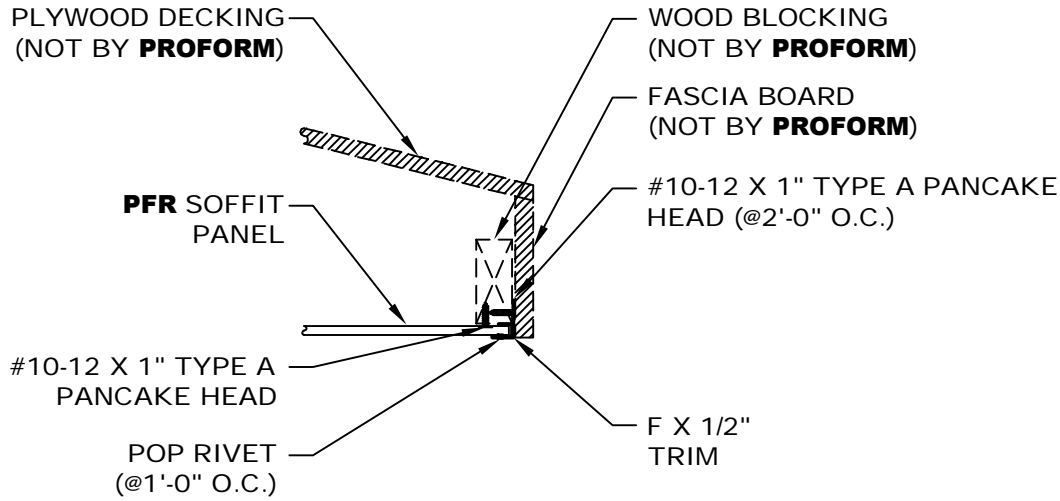

- NOTES:
1. Trim to start and end at building lines.
 2. Attach trim to blocking with #10-12 x 1" Type A Pancake Head at 2'-0" O.C.
 3. Attach panel to sheathing with #10-12 x 1" Type A Pancake Head.

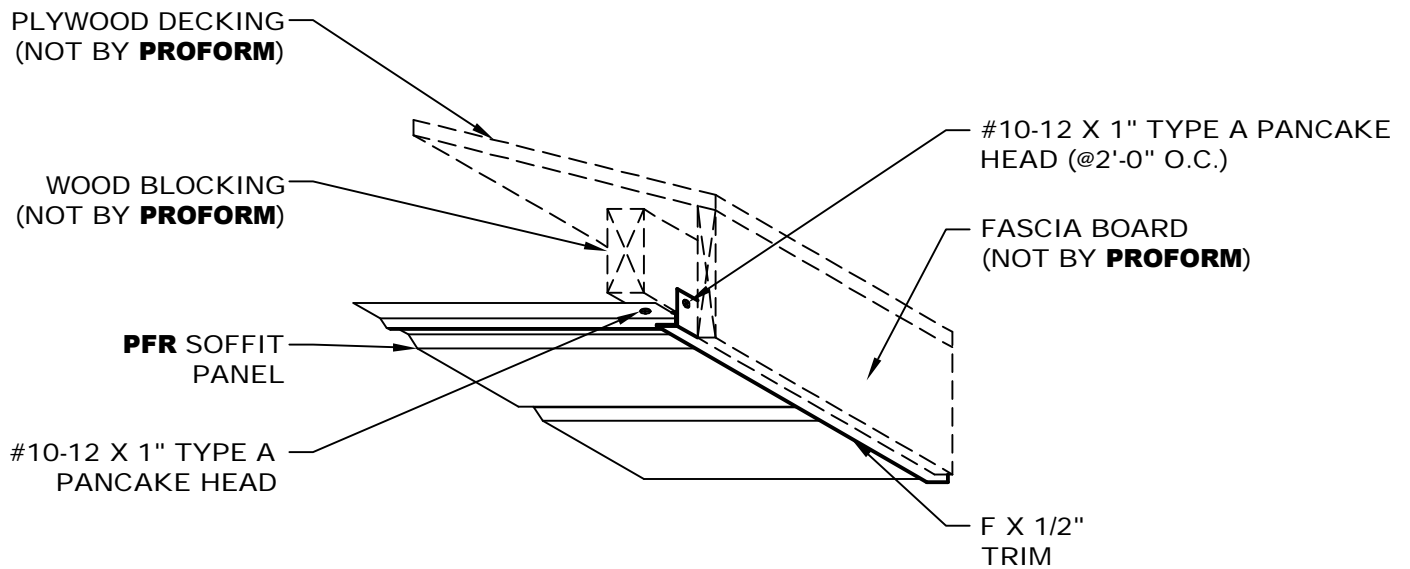

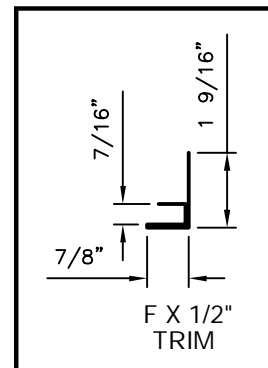
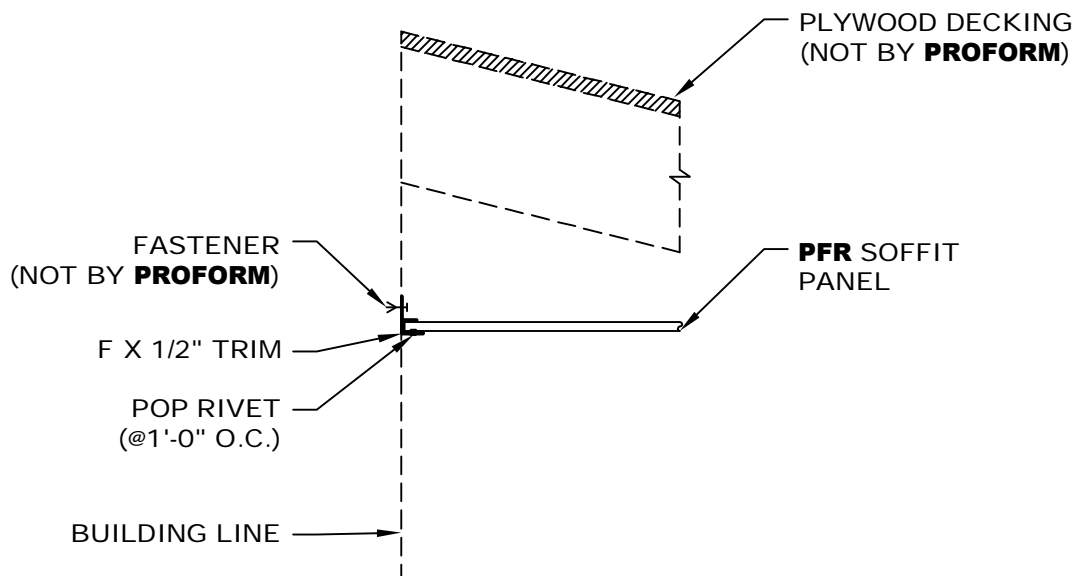

- NOTES: 1. Trim to start and end at building lines.
2. Attach trim to wall at 2'-0" O.C.
3. Attach panel to trim with a Pop Rivet @1'-0" O.C.
4. Maximum panel length for this condition is 1'-0".



BASE DETAIL

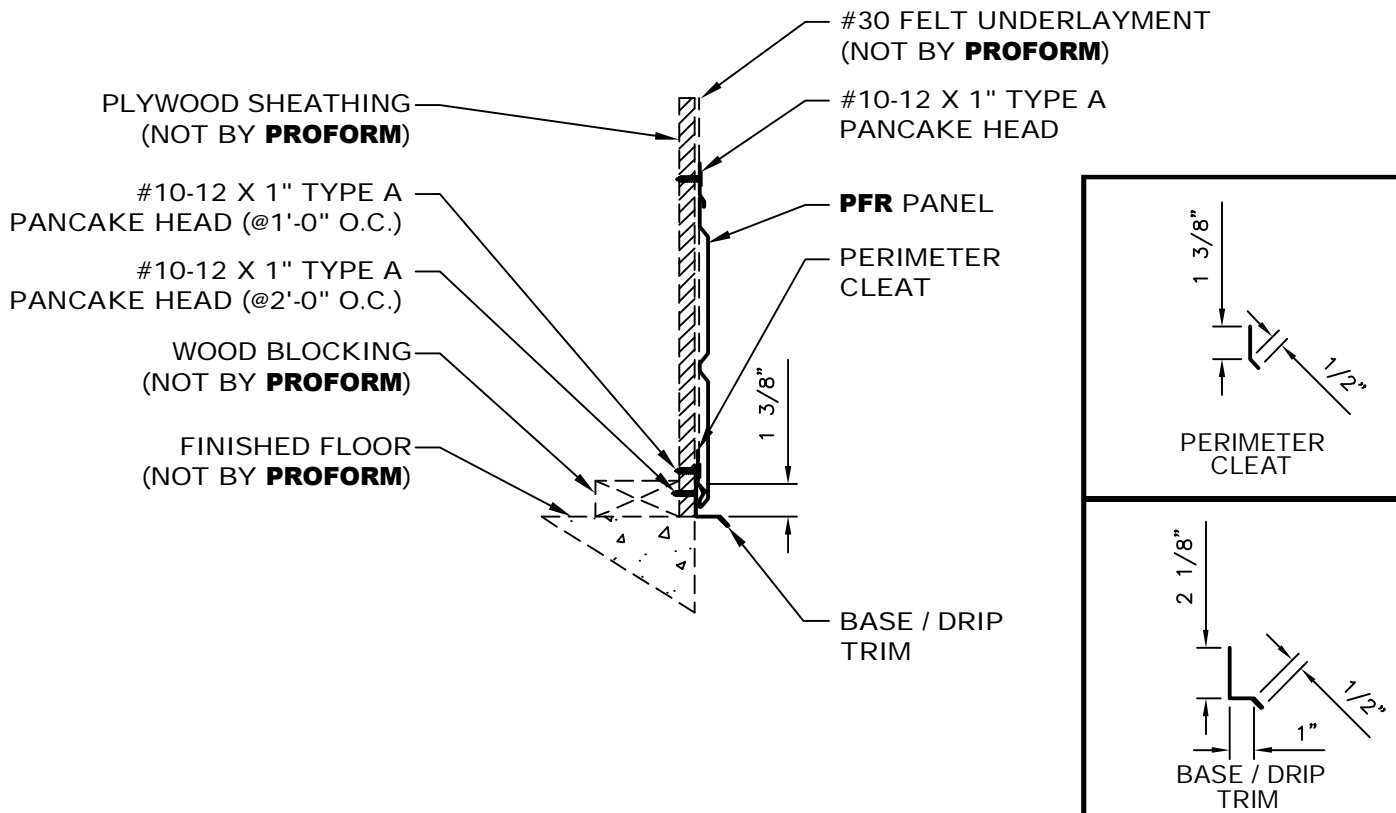

- NOTES: 1. Trim and Cleat to start and end at building lines.
 2. Attach trim to sheathing with #10-12 x 1" Type A Pancake Head at 2'-0" O.C.
 3. Attach cleat to sheathing with #10-12 x 1" Type A Pancake Head at 1'-0" O.C.
 4. Attach panel to sheathing with #10-12 x 1" Type A Pancake Head.

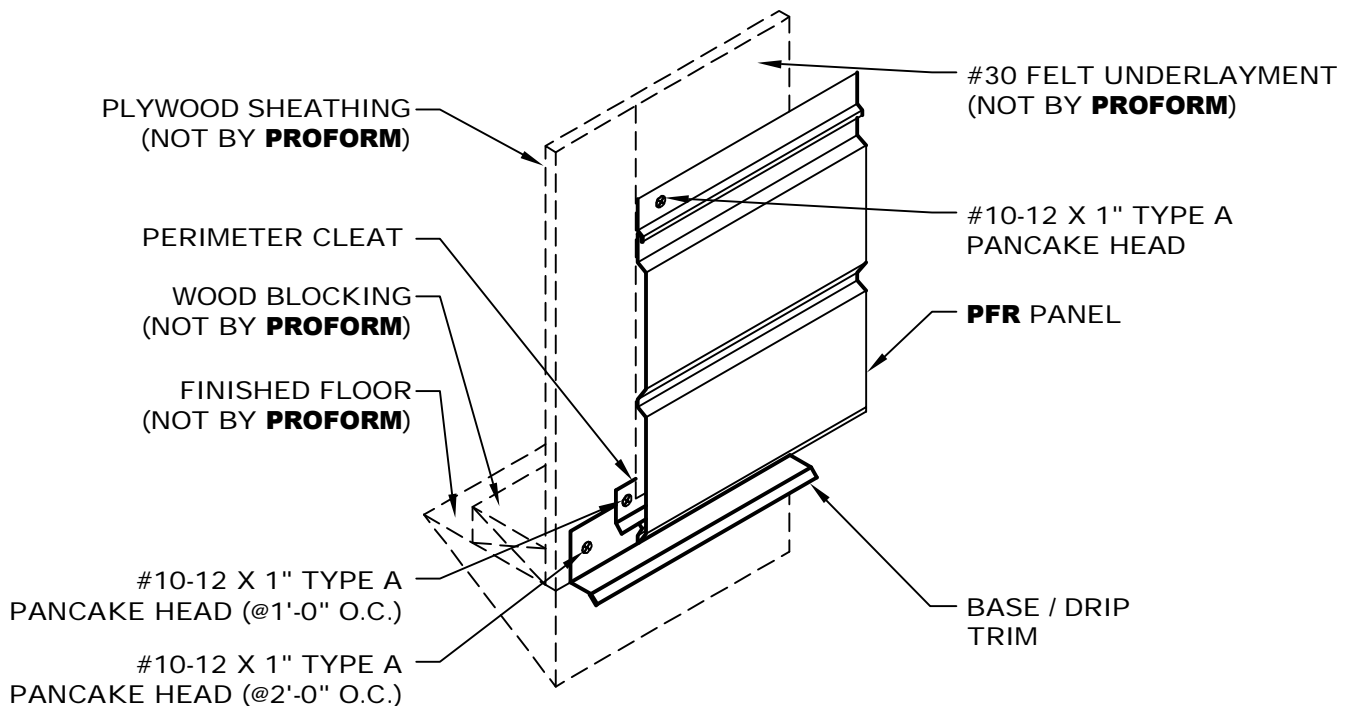

LAP NOTCHING DETAIL

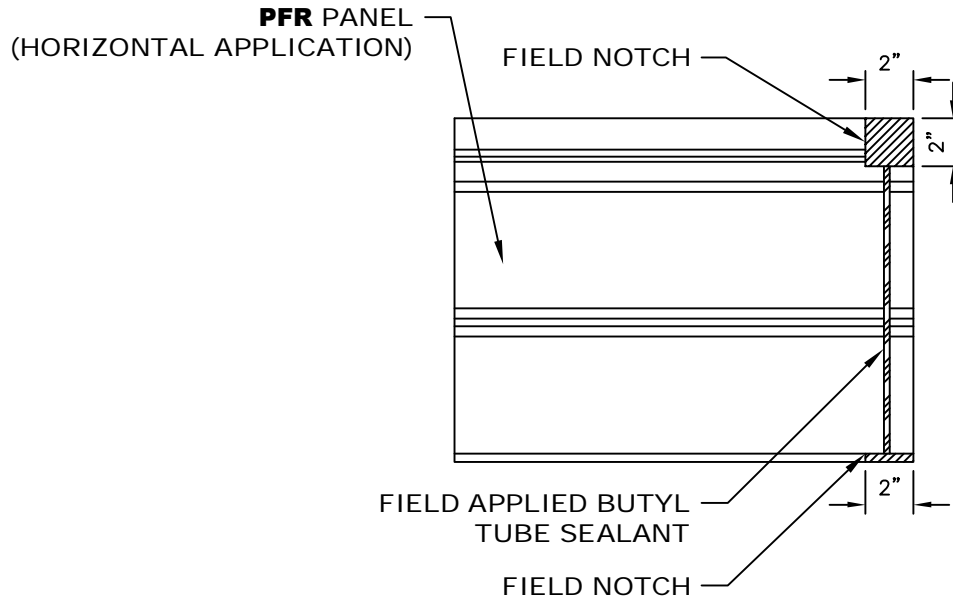

- NOTES: 1. Field notch male leg 0'-2" from end of panel and 0'-2" from edge of panel.
2. Field notch female leg 0'-2" from end of panel.
3. Field Apply a bead of Butyl Tube Sealant as shown in detail. Size and placement of bead will be determined by installer so that lap is sealed without sealant oozing from the joint.
4. Laps must be staggered a minimum of 2'-0".

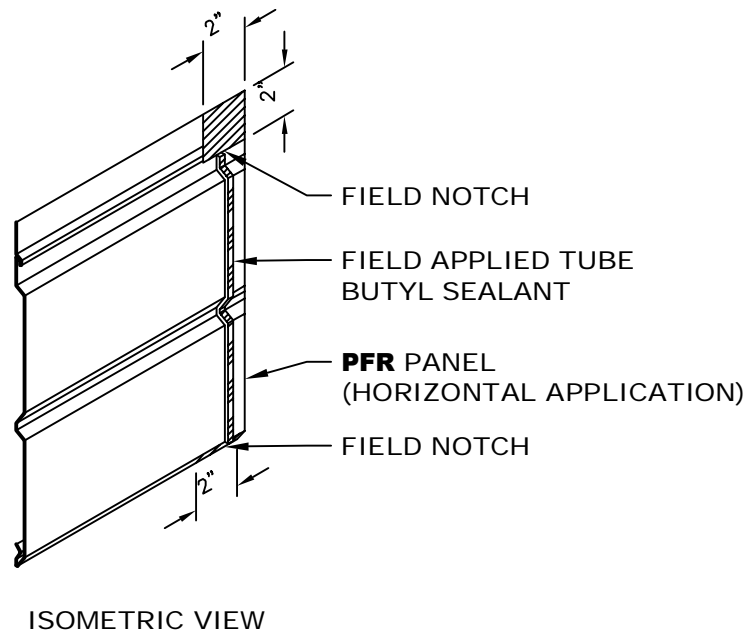

OUTSIDE CORNER DETAIL

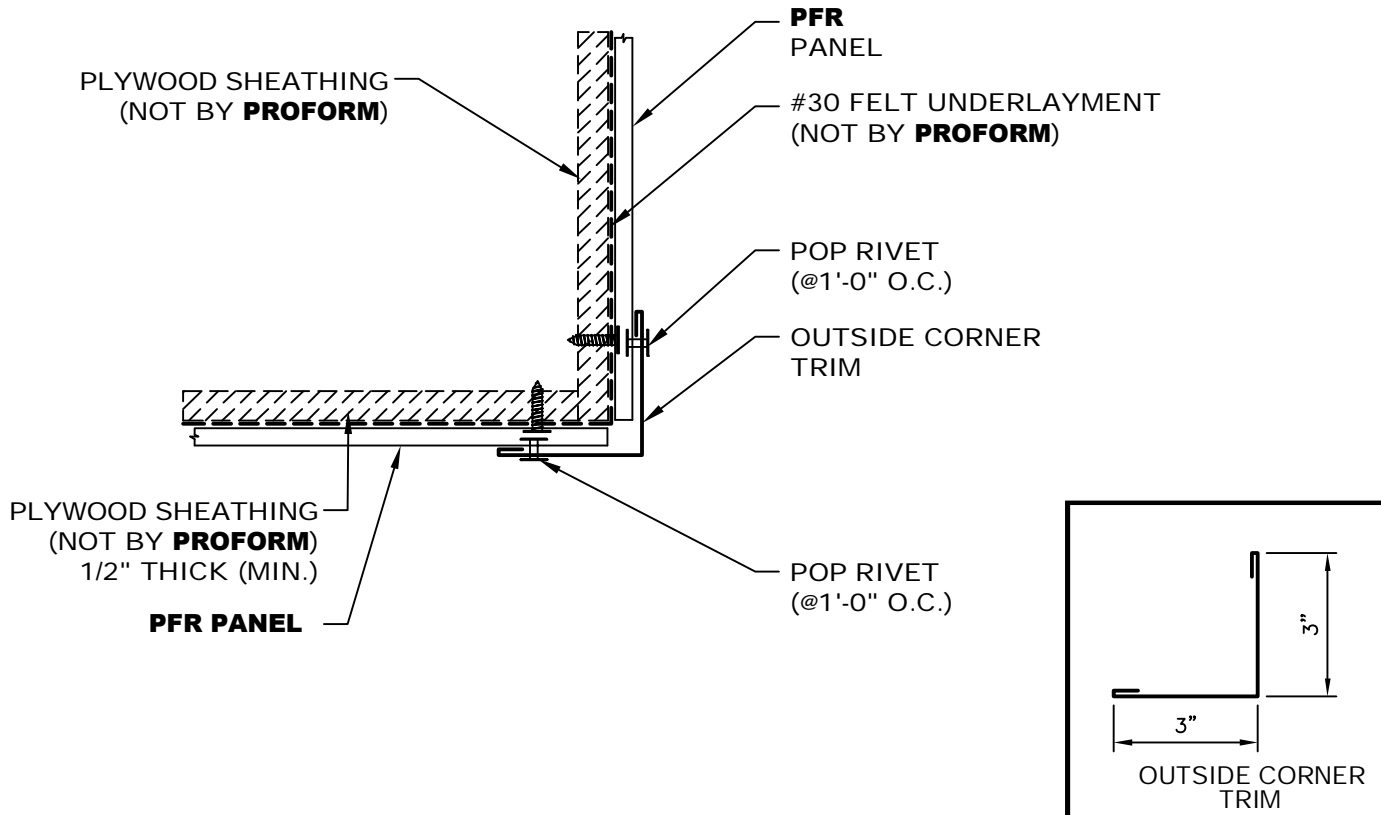

- NOTES: 1. Trim to start and end at building lines.
2. Attach panel to sheathing with #10-12 x 1" Type A Pancake Head.
3. Attach trim to panel with Pop Rivet @1'-0" O.C.

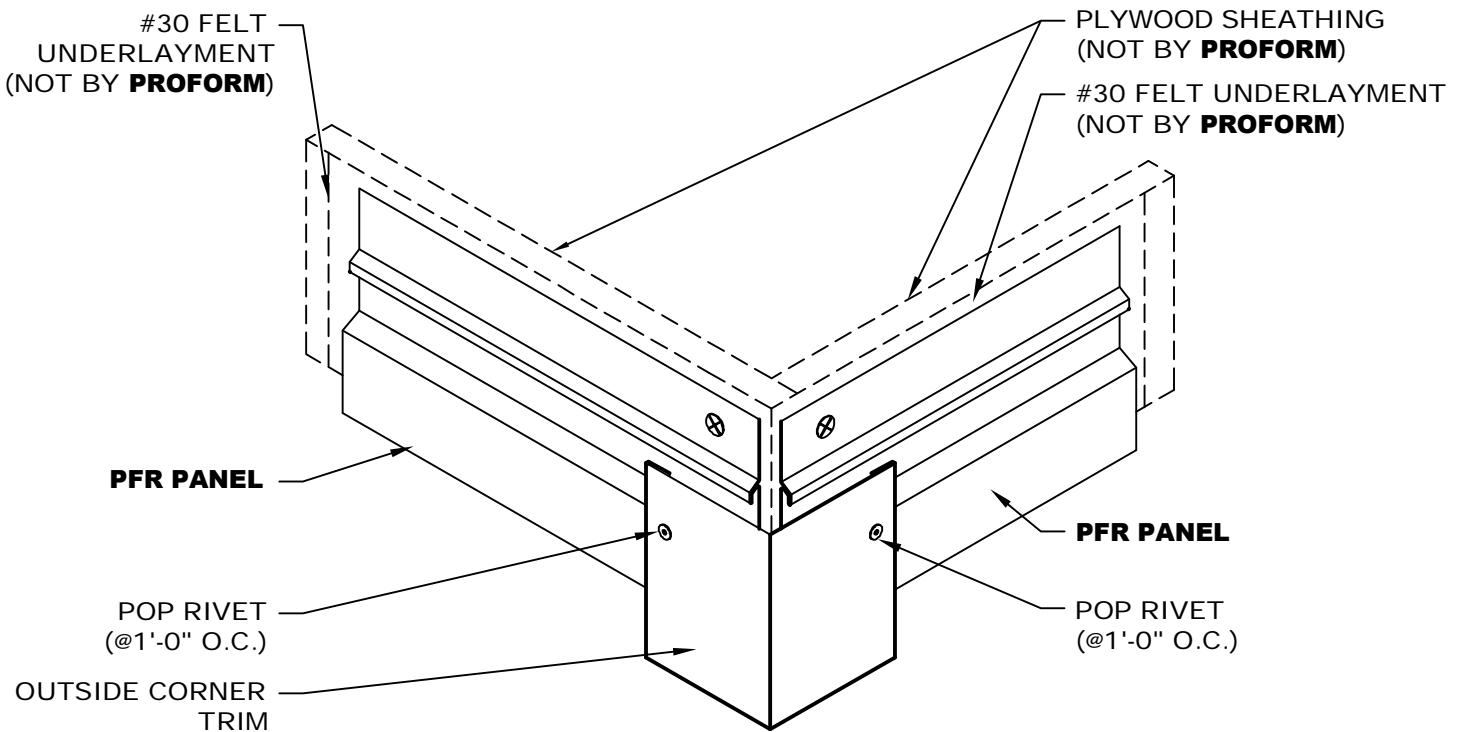

INSIDE CORNER DETAIL

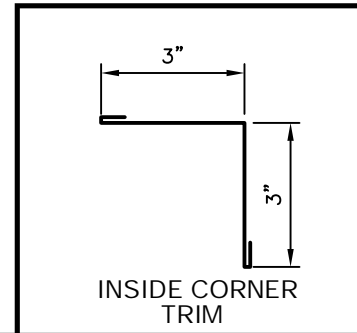
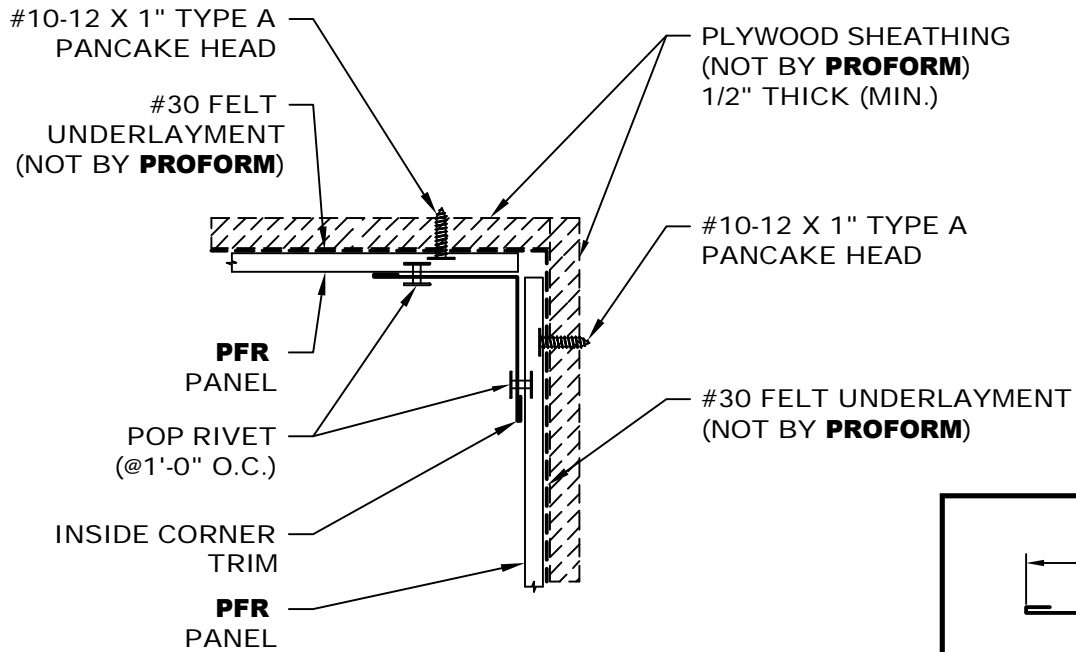

- NOTES: 1. Trim to start and end at building lines.
2. Attach panels to sheathing with #10-12 x 1" Type A Pancake Head.
3. Attach trim to panels with Pop Rivet @1'-0" O.C.

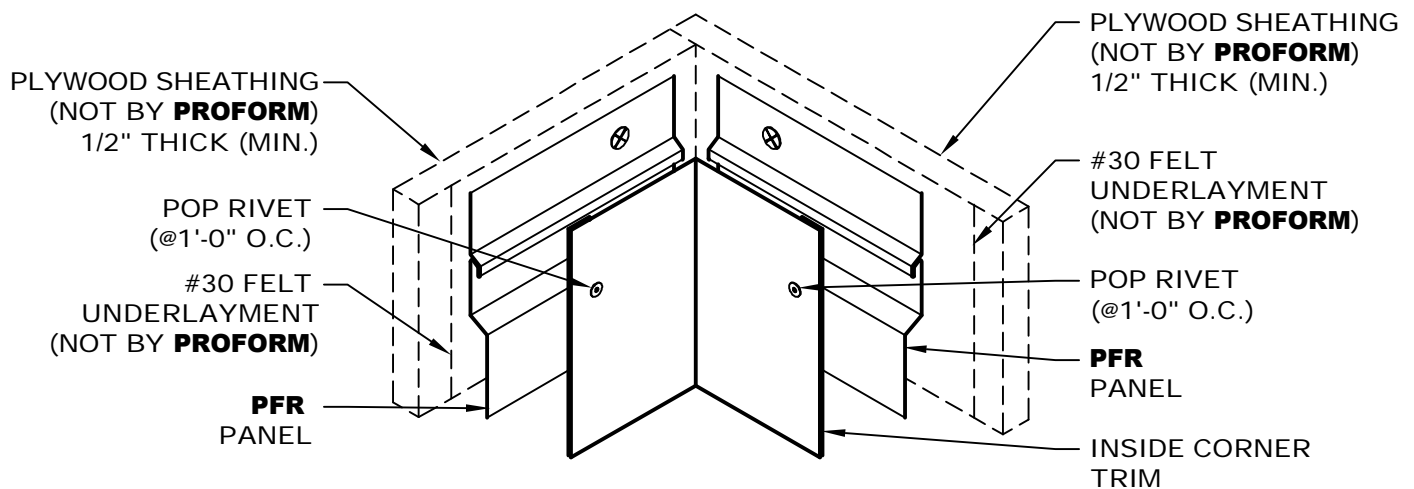

HEADER DETAIL

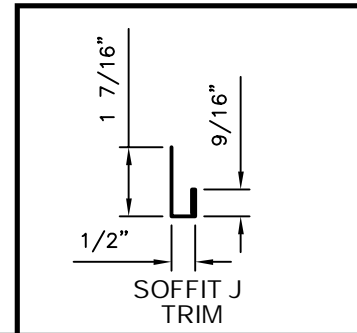
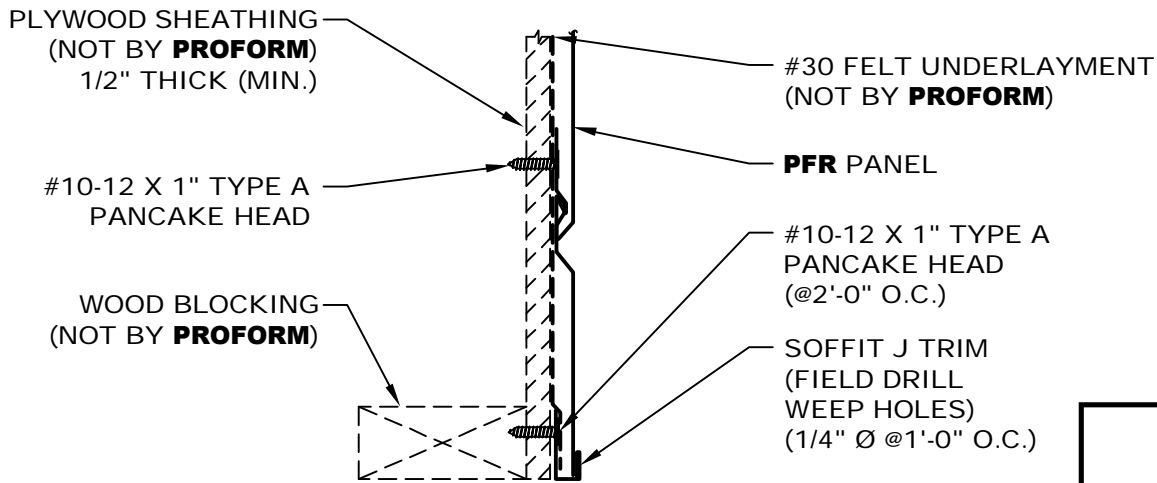

- NOTES: 1. Attach trim to sheathing with #10-12 x 1" Type A Pancake Head @2'-0" O.C.
 2. Attach panels to sheathing with #10-12 x 1" Type A Pancake Head.

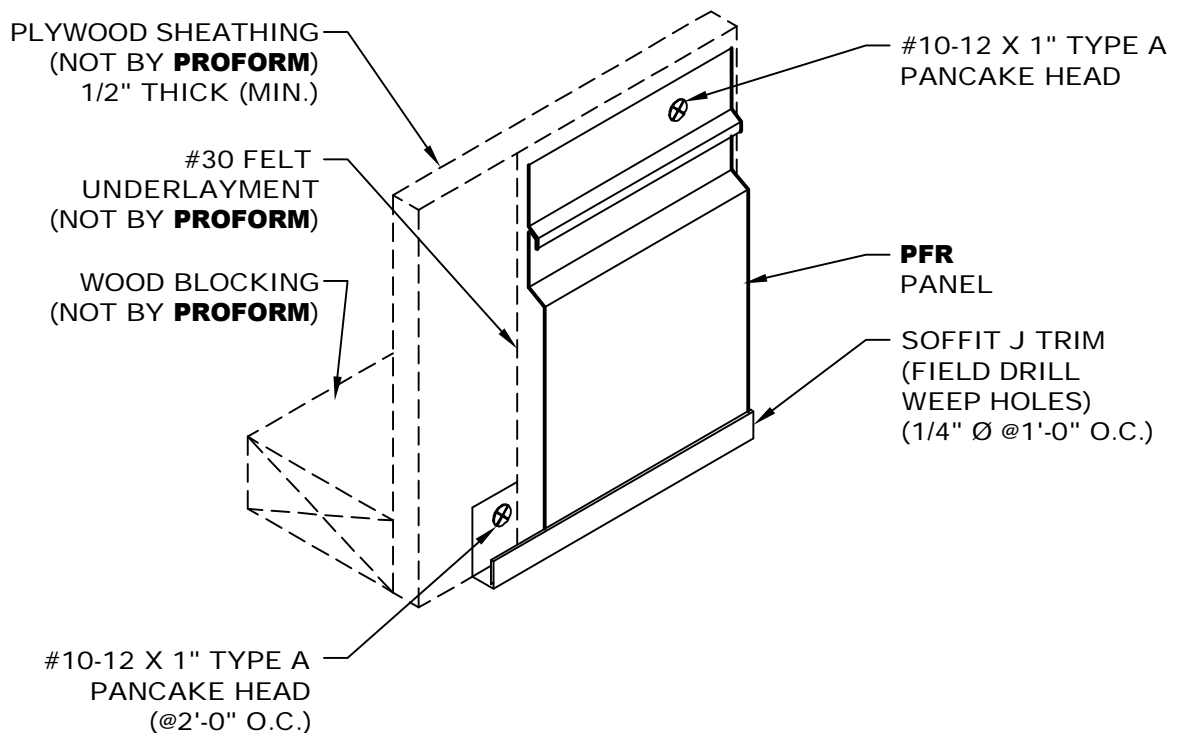

WINDOW SILL DETAIL

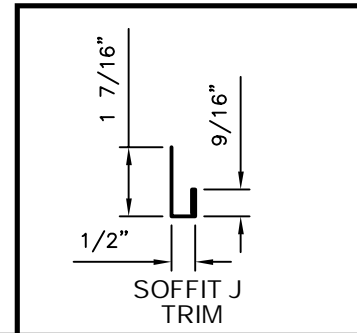
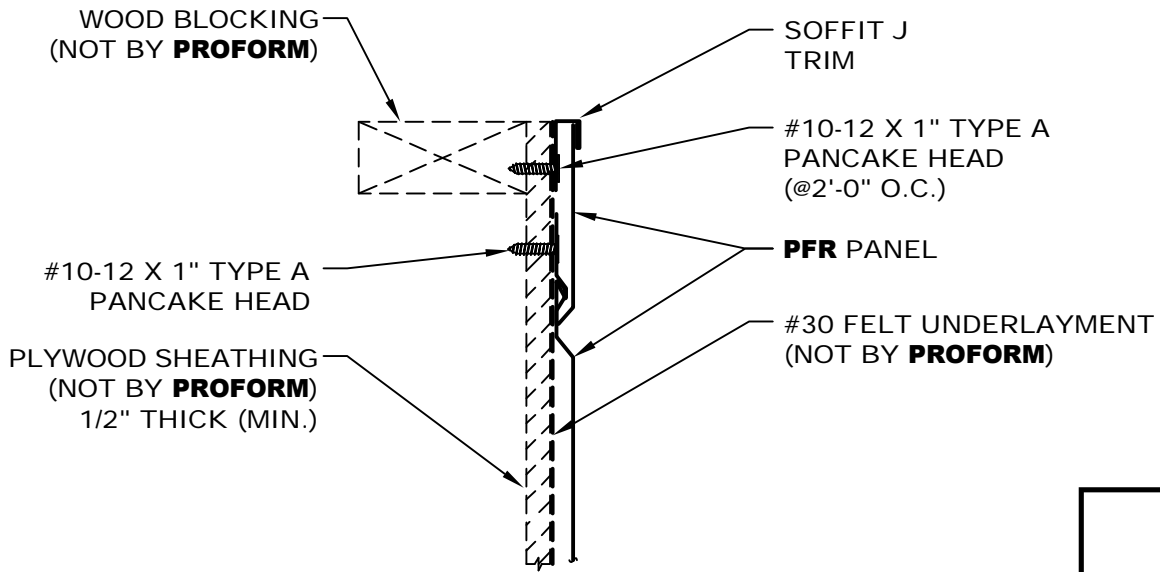

- NOTES: 1. Attach trim to sheathing with #10-12 x 1" Type A Pancake Head @2'-0" O.C.
2. Attach panels to sheathing with #10-12 x 1" Type A Pancake Head.

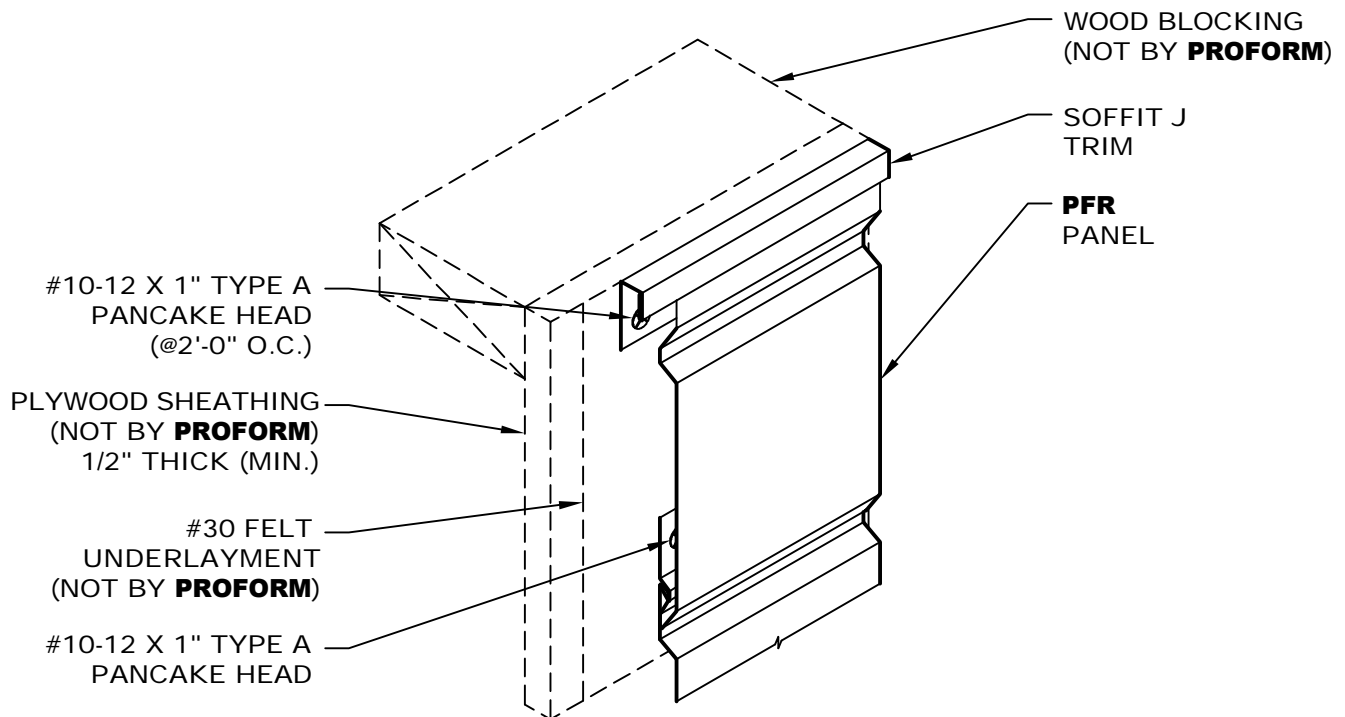

JAMB DETAIL

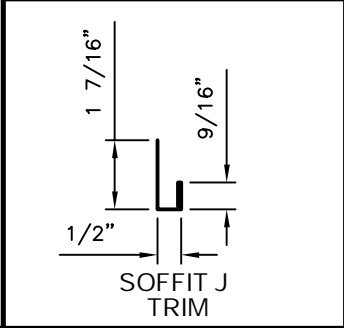
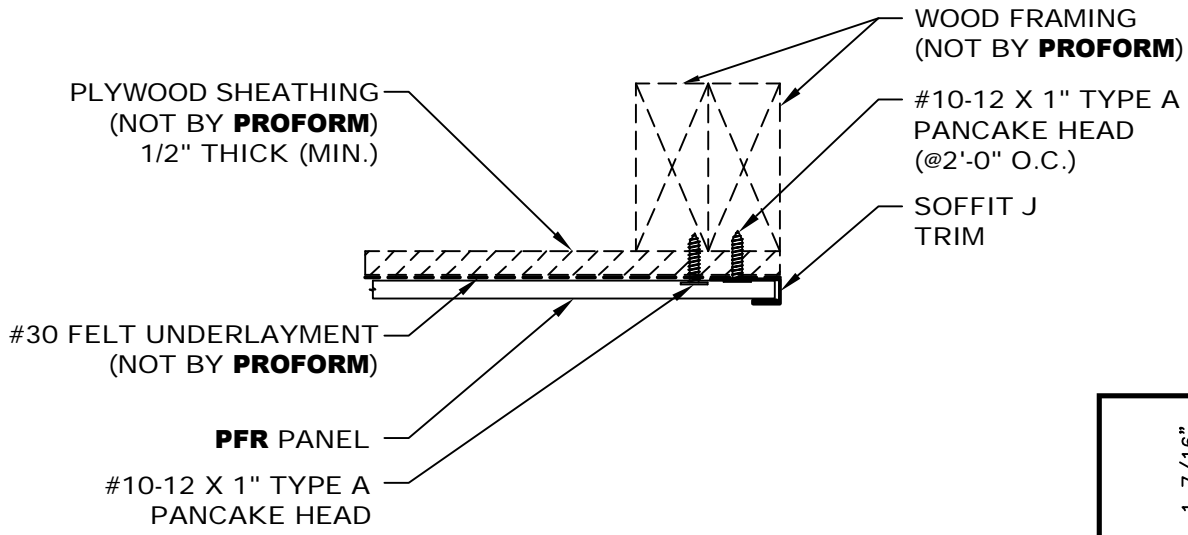

- NOTES: 1. Attach trim to sheathing with #10-12 x 1" Type A Pancake Head @2'-0" O.C.
2. Attach panels to sheathing with #10-12 x 1" Type A Pancake Head.

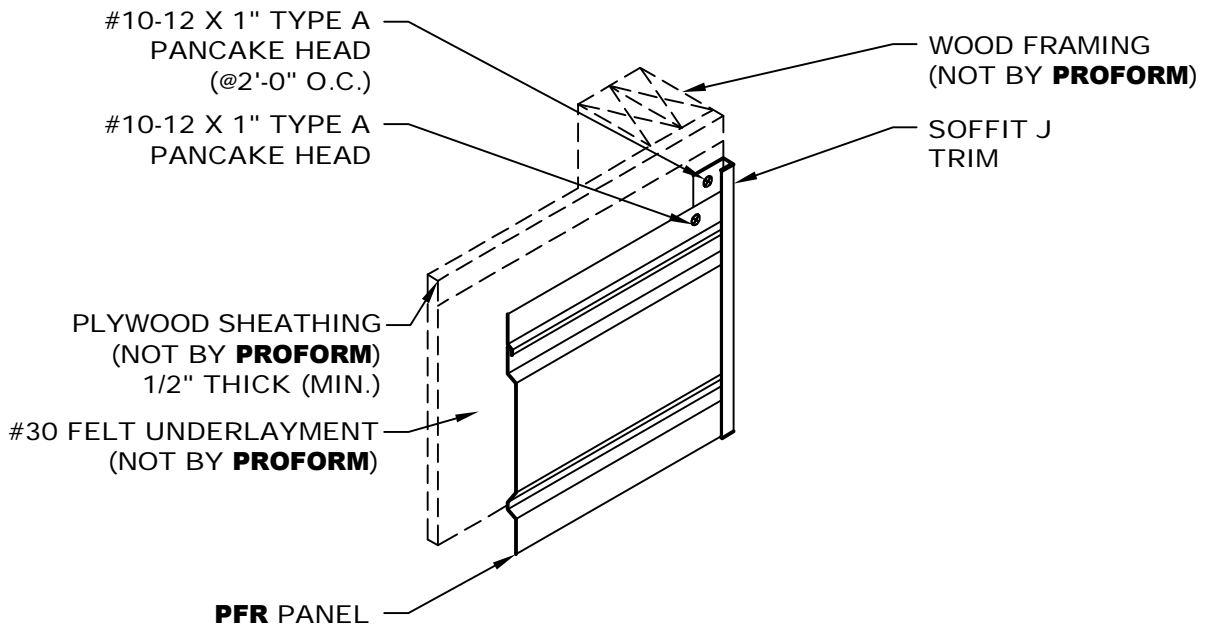

FASCIA/SOFFIT DETAIL

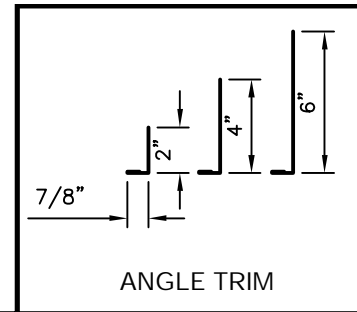
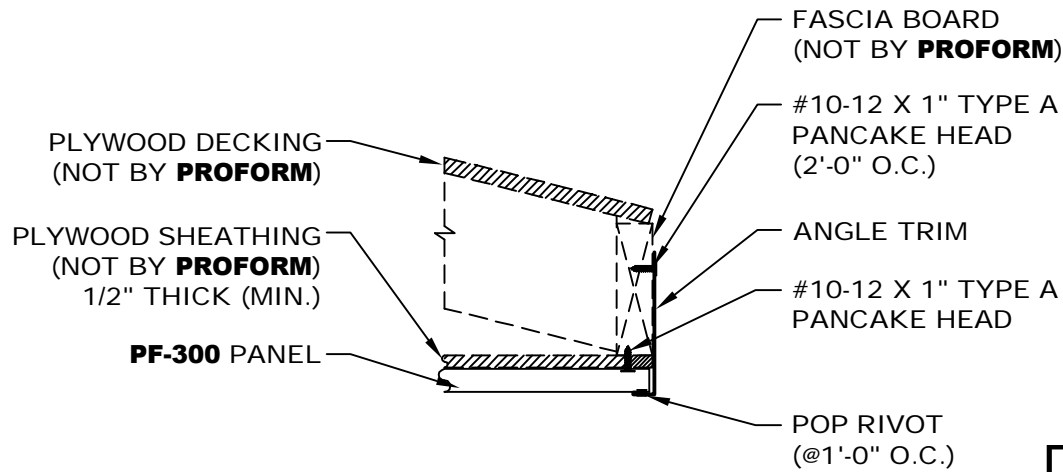

- NOTES: 1. Trim to start and end at building lines.
2. Attach trim to blocking with #10-12 x 1" Type A Pancake Head at 2'-0" O.C.
3. Attach panel to sheathing with #10-12 x 1" Type A Pancake Head.

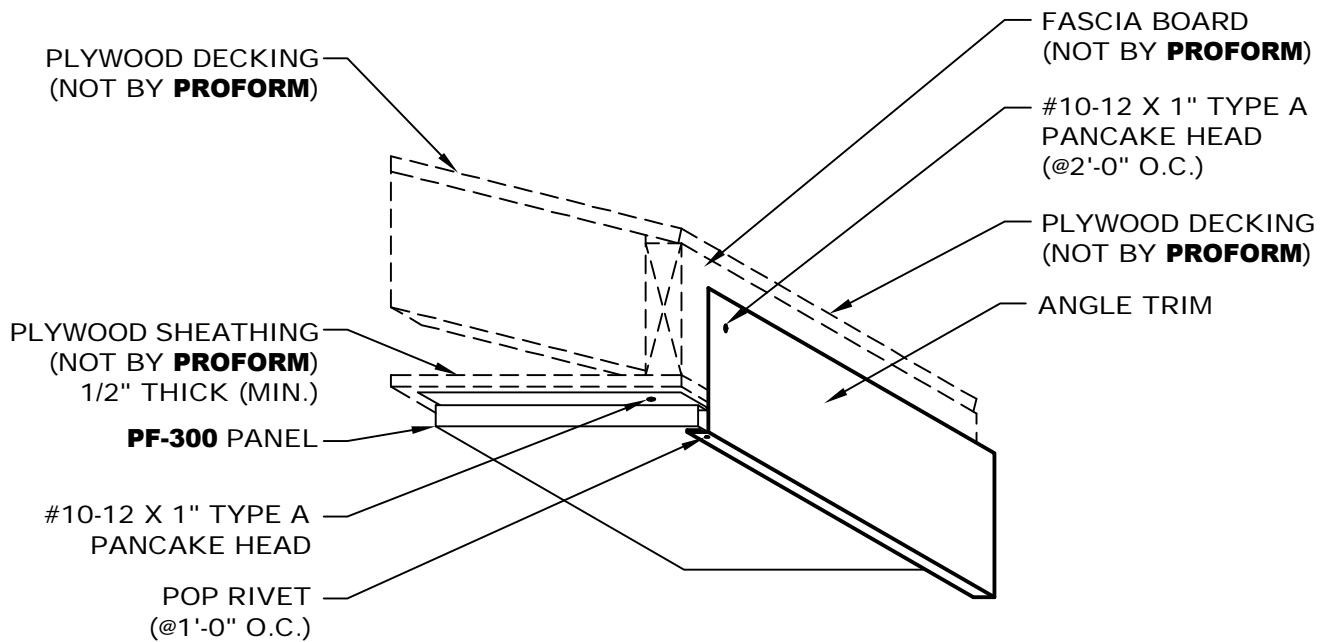

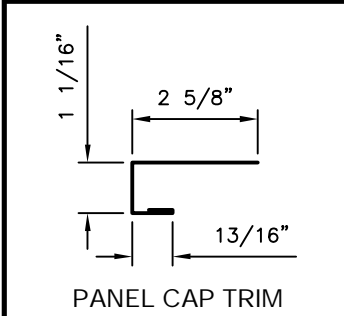
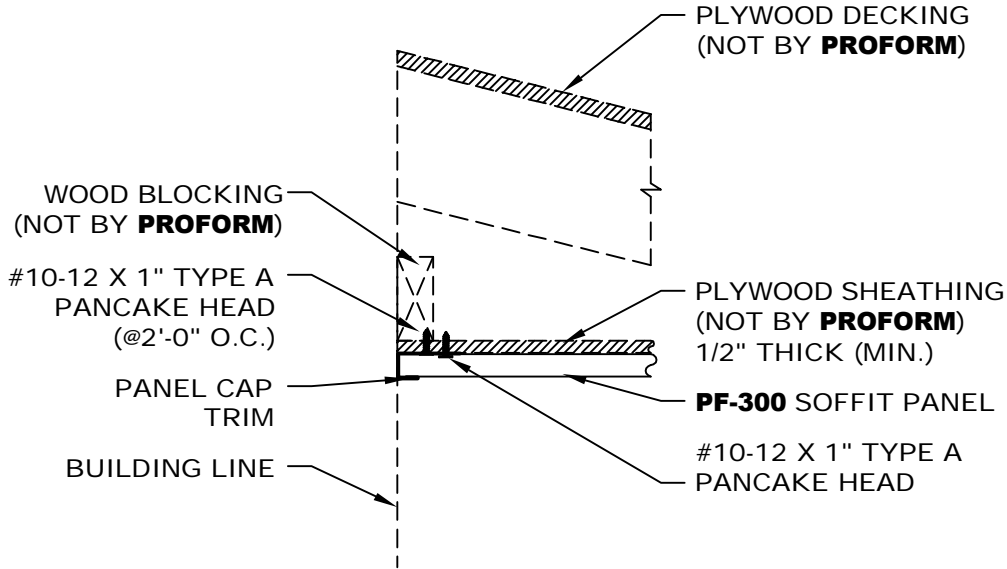

- NOTES: 1. Trim to start and end at building lines.
 2. Attach trim to blocking with #10-12 x 1" Type A Pancake Head at 2'-0" O.C.
 3. Attach panel to sheathing with #10-12 x 1" Type A Pancake Head.

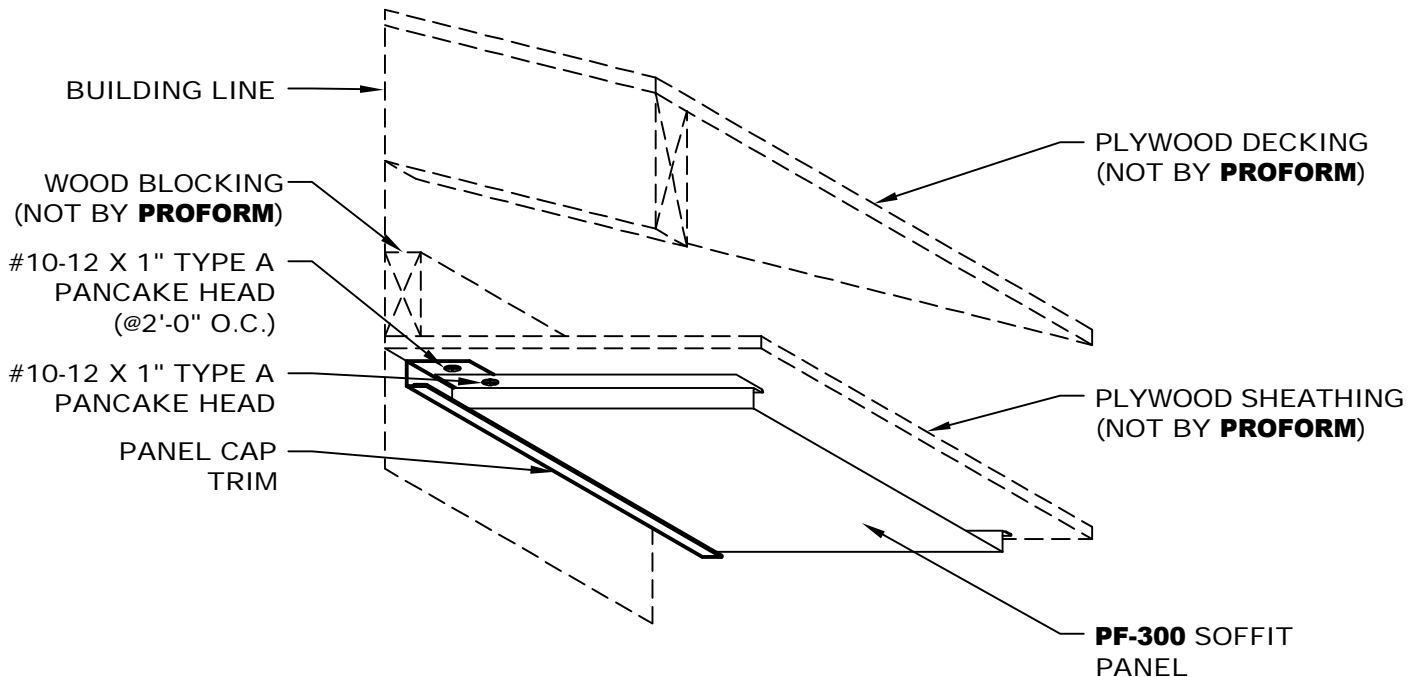

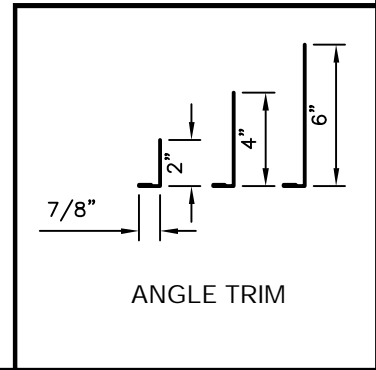
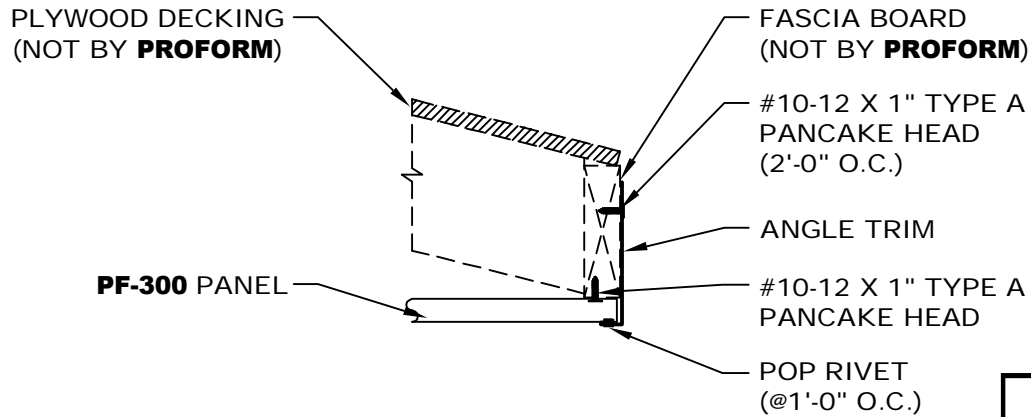

- NOTES: 1. Trim to start and end at building lines.
2. Attach trim to blocking with #10-12 x 1" Type A Pancake Head at 2'-0" O.C.
3. Attach panel to sheathing with #10-12 x 1" Type A Pancake Head.

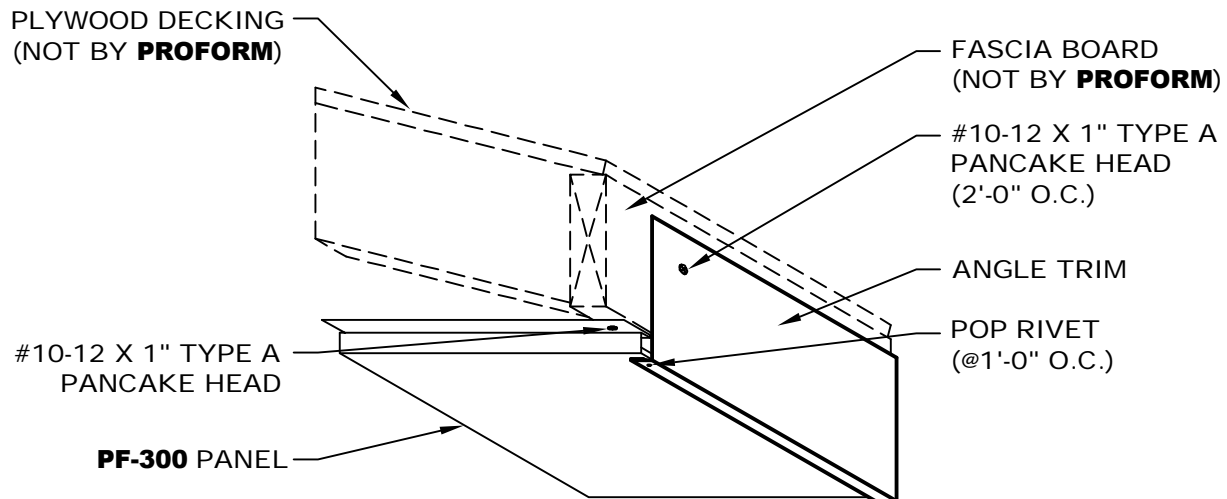

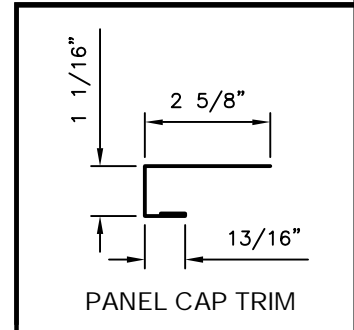
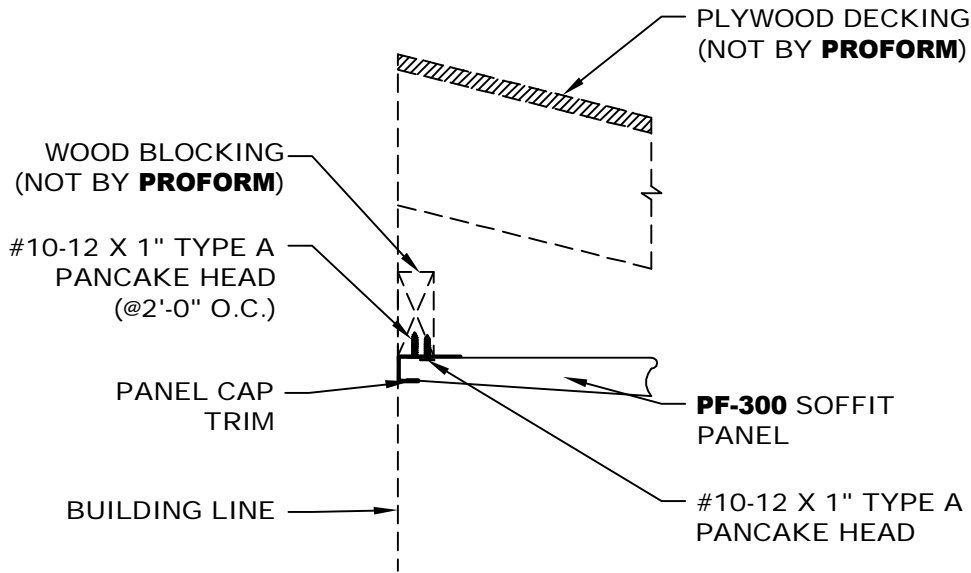

- NOTES: 1. Trim to start and end at building lines.
2. Attach trim to blocking with #10-12 x 1" Type A Pancake Head at 2'-0" O.C.
3. Attach panel to sheathing with #10-12 x 1" Type A Pancake Head.

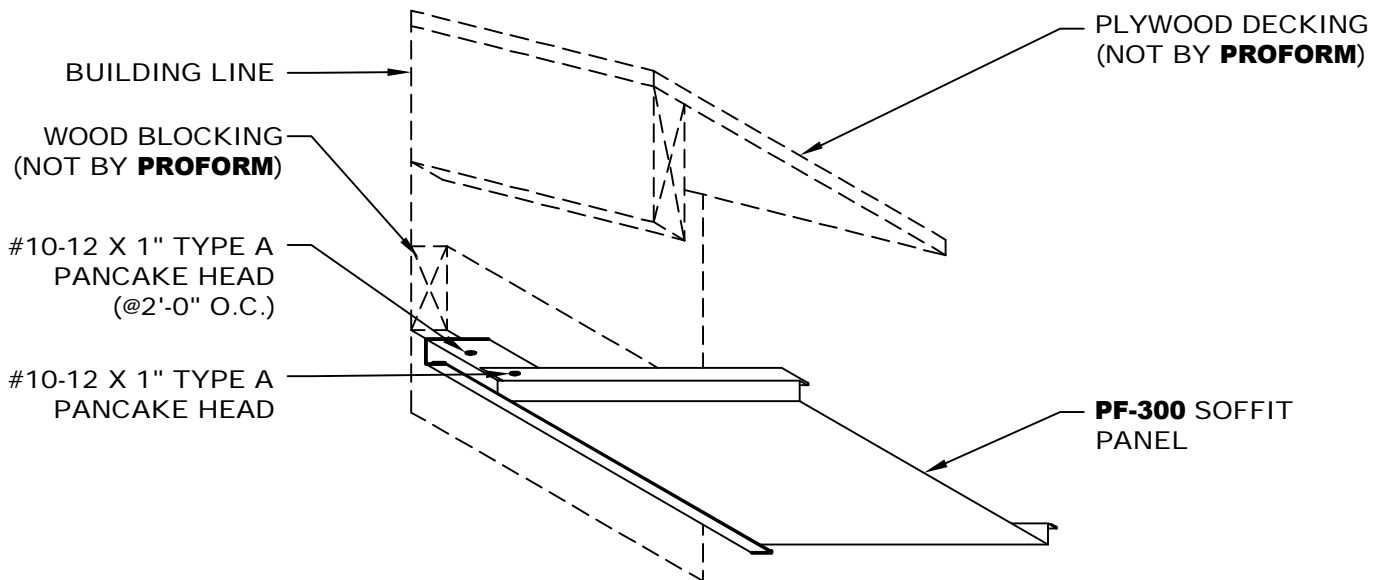

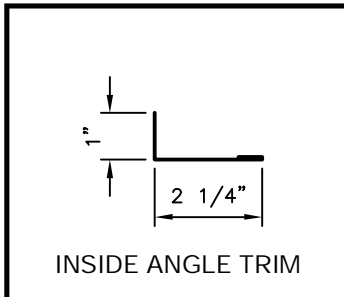
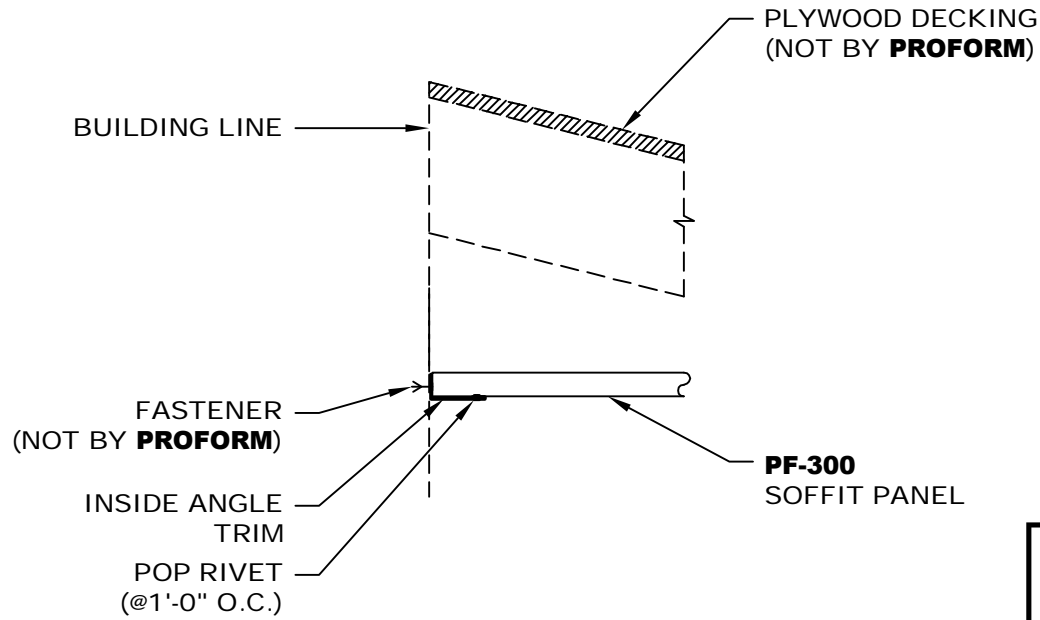

- NOTES: 1. Trim to start and end at building lines.
2. Attach trim to blocking with #10-12 x 1" Type A Pancake Head at 2'-0" O.C.
3. Attach panel to sheathing with #10-12 x 1" Type A Pancake Head.
4. Maximum panel length for this condition is 1'-0".

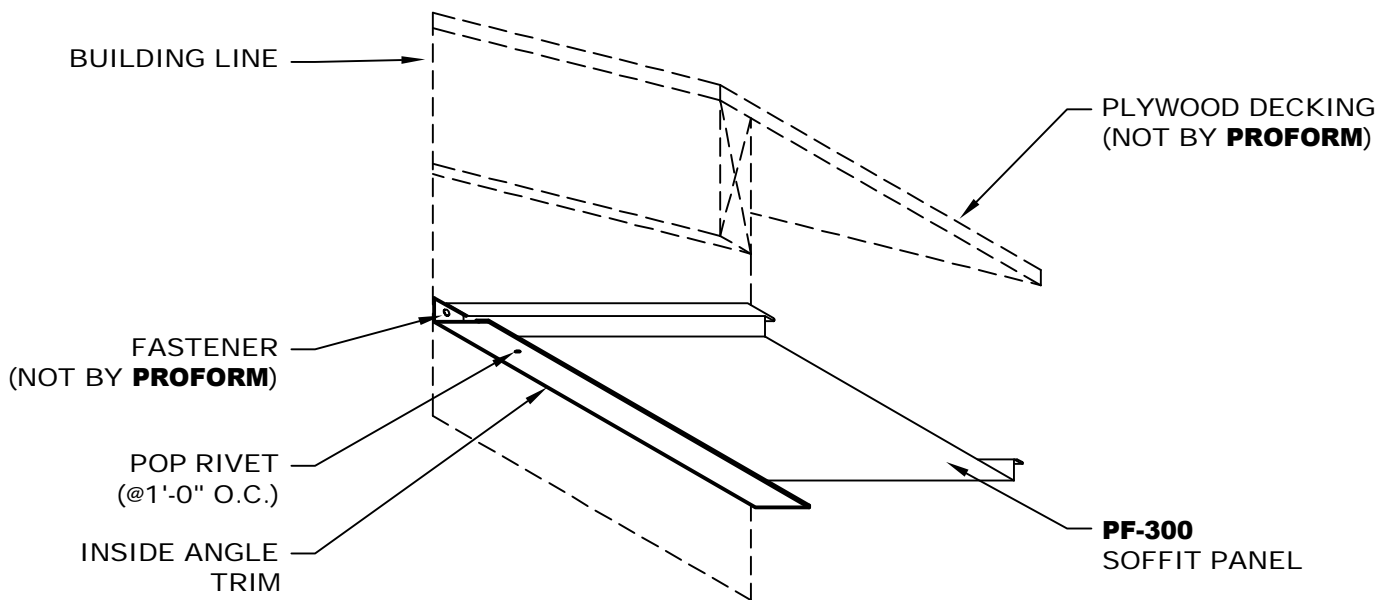

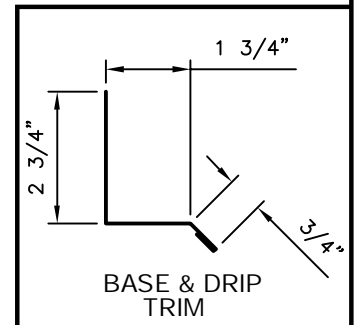
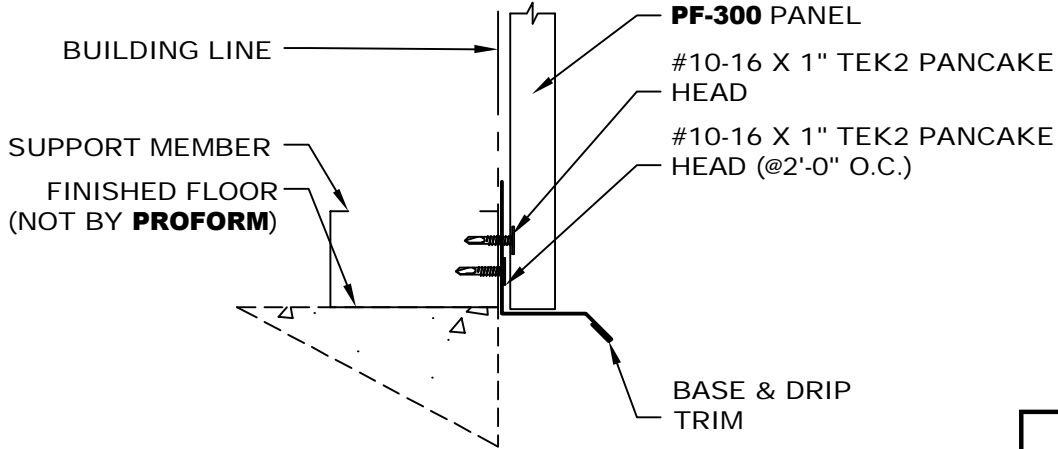

- NOTES: 1. Trim to start and end at building lines.
2. Attach trim to Support Member with #10-16 x 1" TEK2 Pancake Head at 2'-0" O.C.
3. Attach panel to framing with #10-16 x 1" TEK2 Pancake Head.

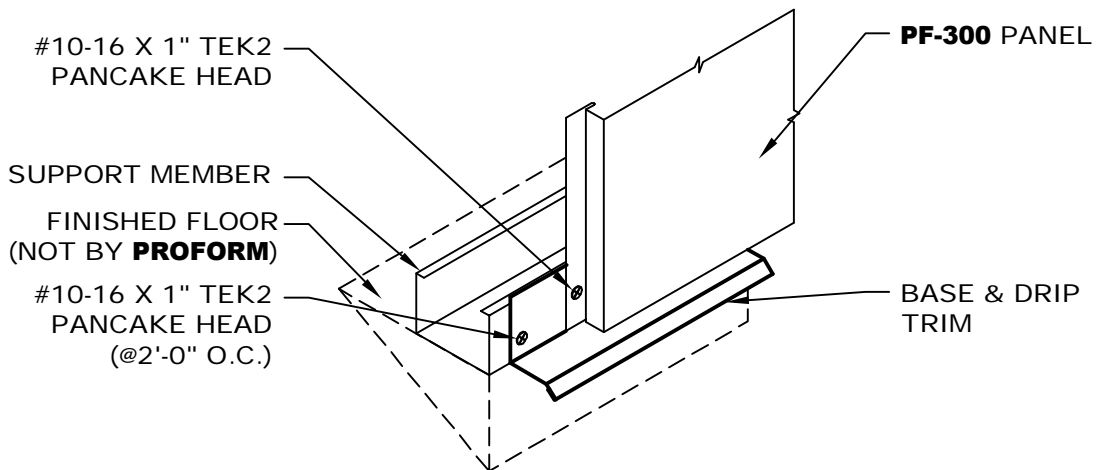

OUTSIDE CORNER DETAIL

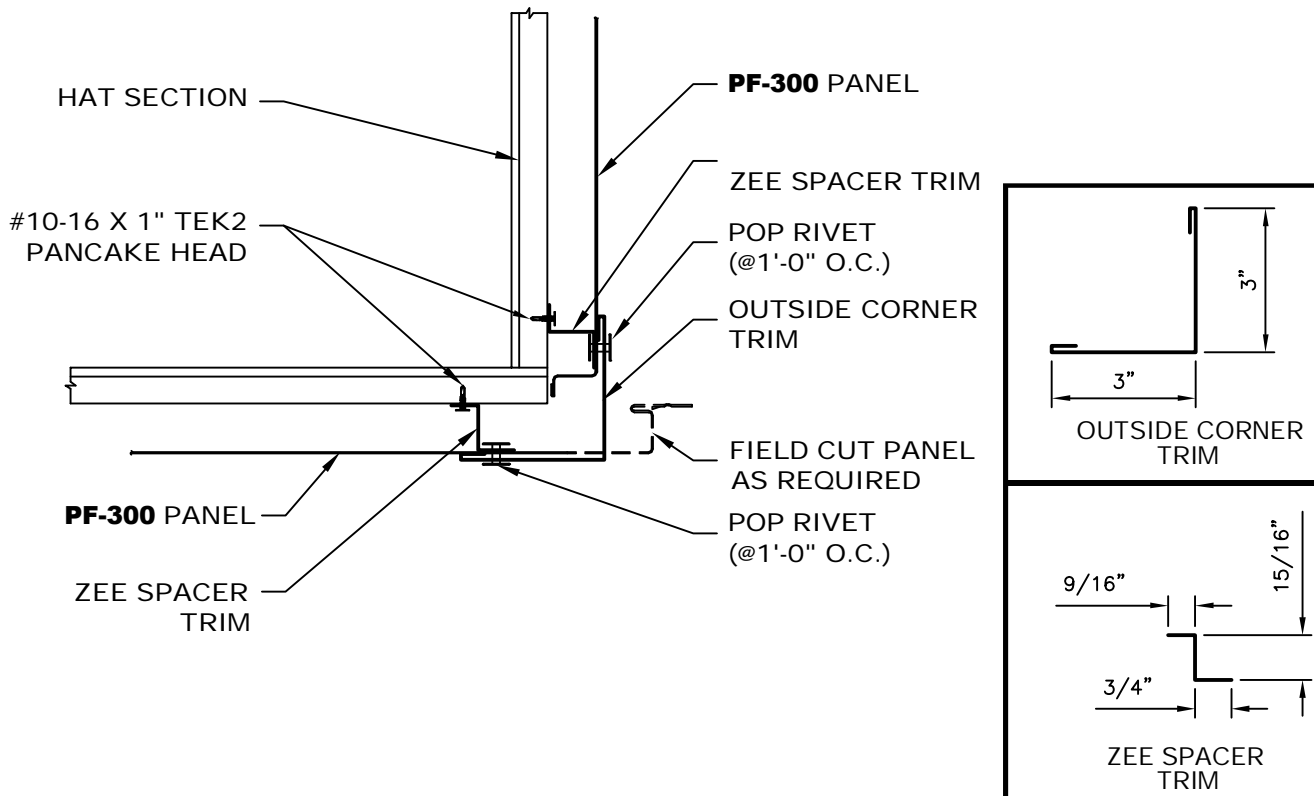

- NOTES: 1. Locate and attach Zee Spacer Trim with #10-16 x 1" TEK2 Pancake Head fasteners.
 2. Attach panels with #10-12 x 1" TEK2 Pancake Head fasteners.
 3. Attach Outside Corner trim with Pop Rivets @1'-0" O.C..

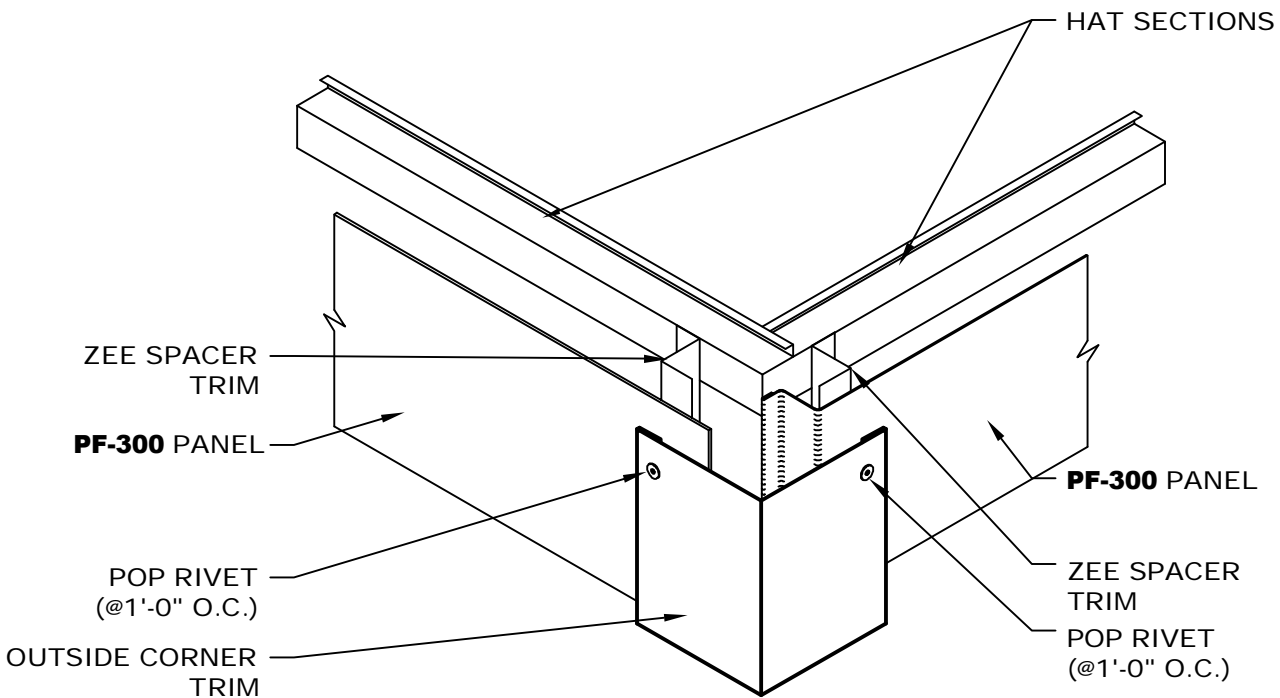

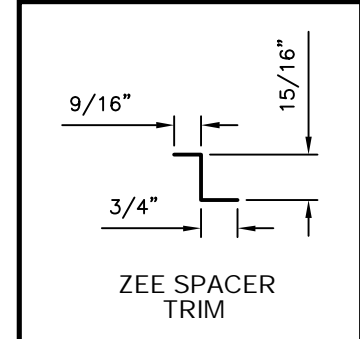
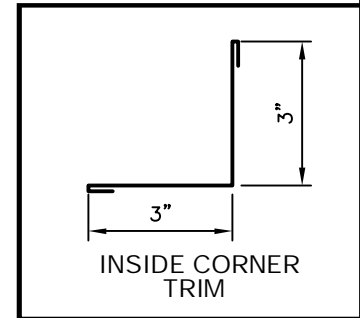
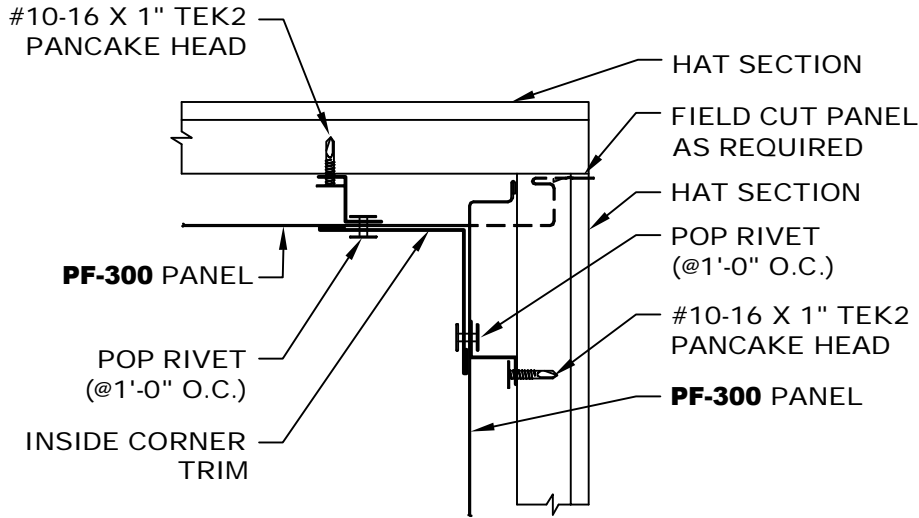

- NOTES: 1. Locate and attach Zee Spacer Trim with #10-16 x 1" TEK2 Pancake Head fastener.
 2. Attach panels to framing with #10-16 x 1" TEK2 Pancake Head fasteners.
 3. Attach Inside Corner with Pop-Rivets @ 1'-0" O.C.

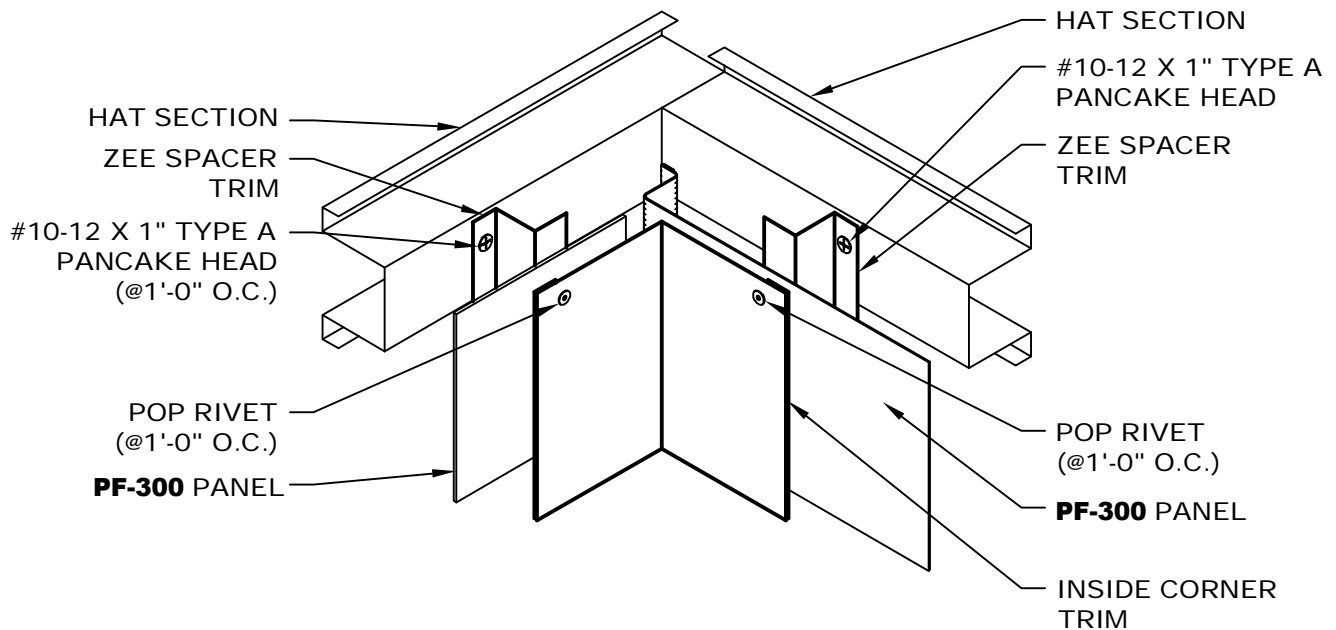

HEADER DETAIL

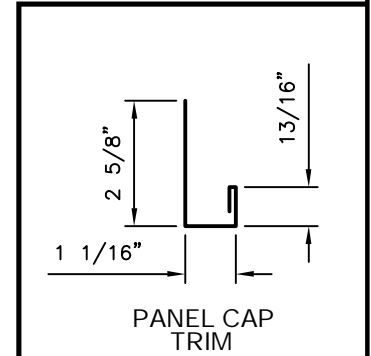
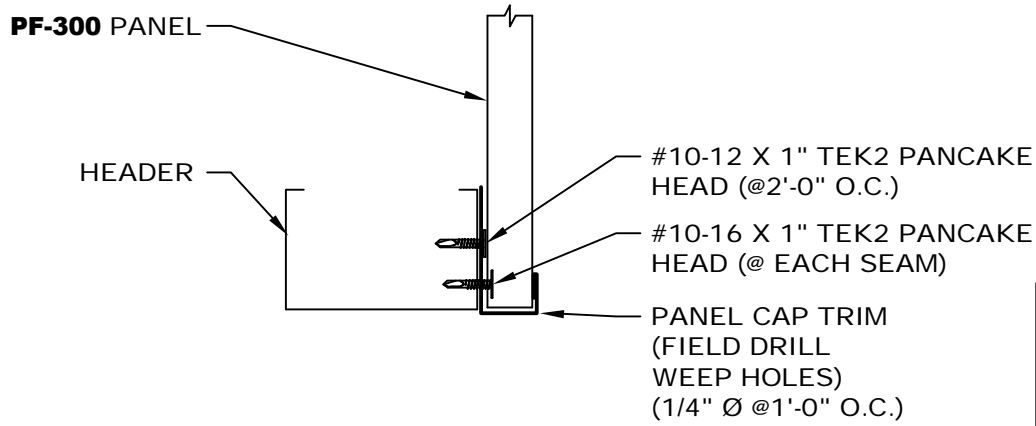

- NOTES: 1. Trim to start and end at door/window framing.
2. Attach trim to header with #10-16 x 1" TEK2 Pancake Head at 2'-0" O.C.
3. Attach panel to framing with #10-16 x 1" TEK2 Pancake Head.

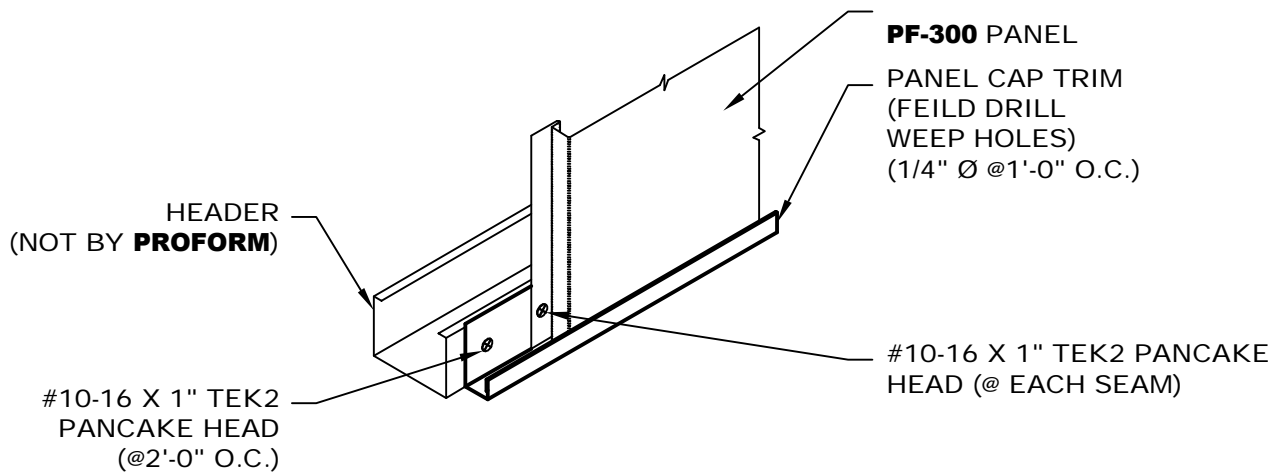

WINDOW SILL DETAIL

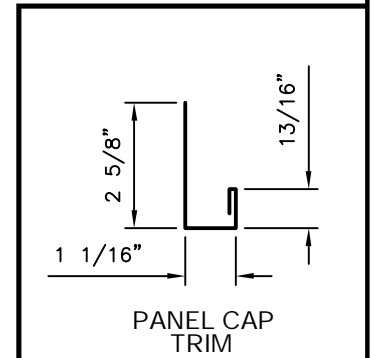
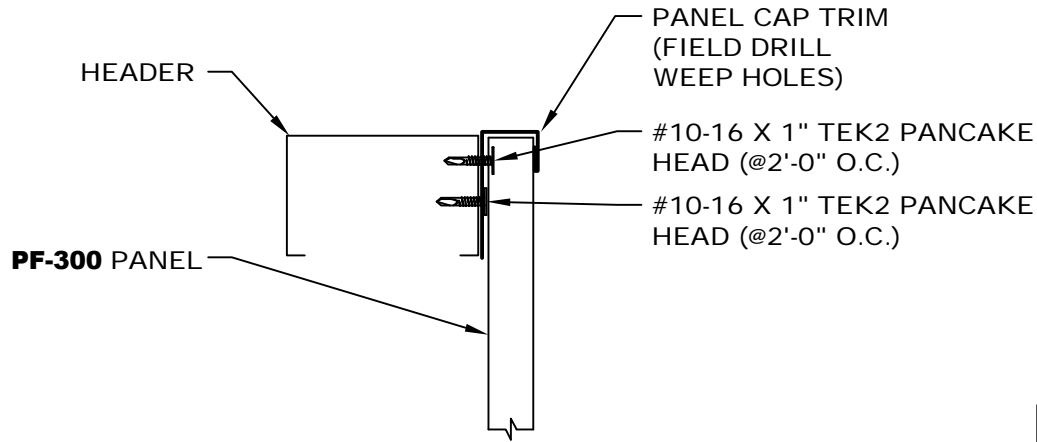

- NOTES: 1. Trim to start and end at window framing.
2. Attach trim to header with #10-16 x 1" TEK2 Pancake Head at 2'-0" O.C.
3. Attach panel to framing with #10-16 x 1" TEK2 Pancake Head.

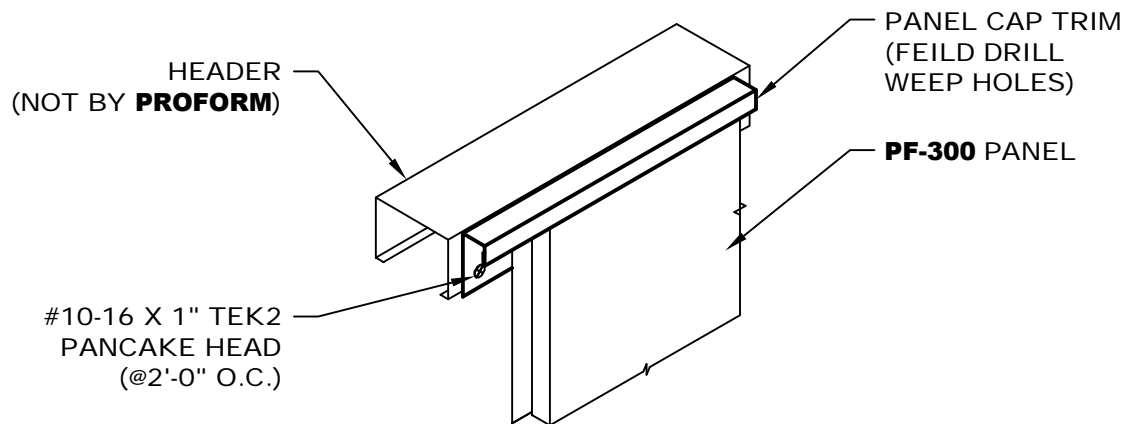

JAMB DETAIL

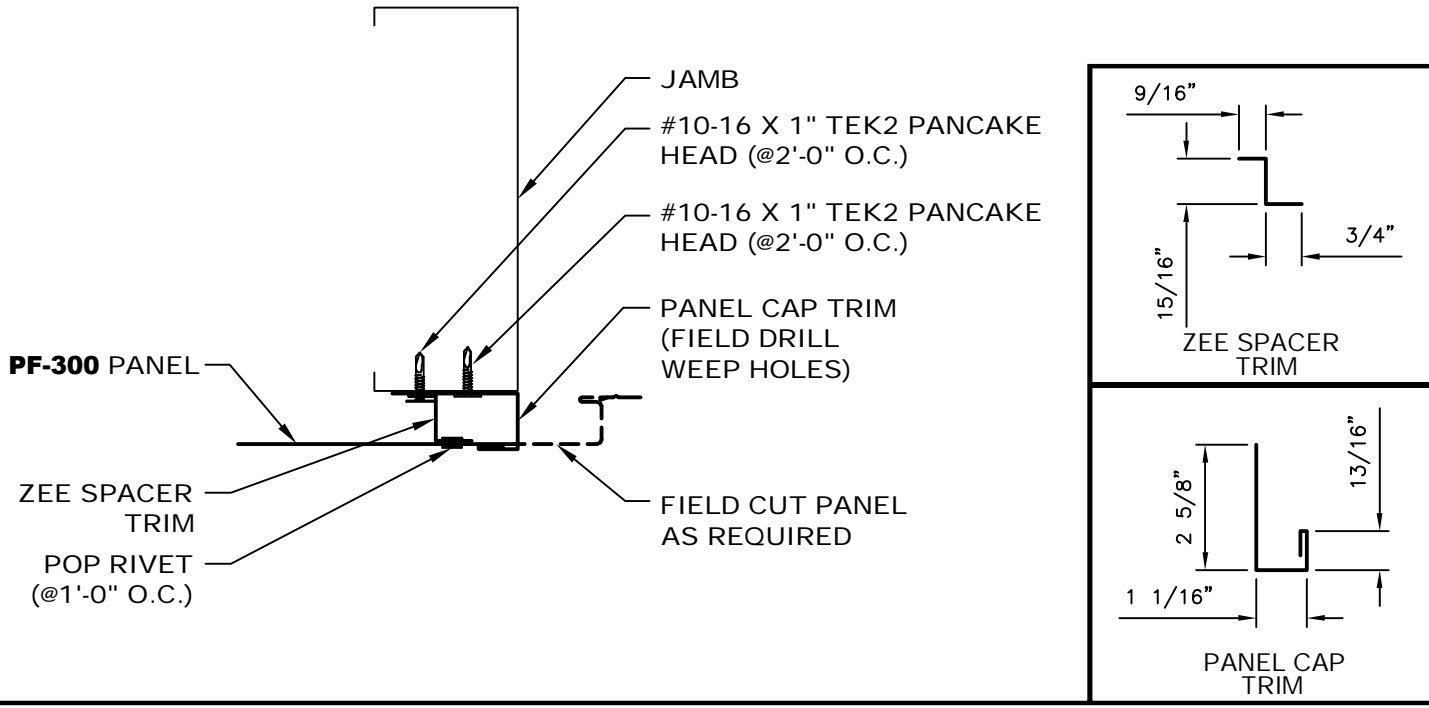

- NOTES: 1. Trim to start and end at window framing.
 2. Attach trim to header with #10-16 x 1" TEK2 Pancake Head at 2'-0" O.C.
 3. Attach panel to framing with #10-16 x 1" TEK2 Pancake Head.

