

ITEM NO.	DESCRIPTION	PartNo	QTY.
1	SKO TRIGGER SPRING	AR BP0248	1
1	PICATINNY RAIL	DP 0042	1
3	#8-32 FLAT HD CAP SCREW	DP 0106	3
4	#8-32 SOC HD CAP SCREW X .25	DP 0123	4
5	#10-24 BTN HEAD CAP SCREW X .500	DP 0131	2
6	2.5M SOC HD CAP SCREW X 10MM	SP 00116	2
7	#10-24 UNC SET SCREW X .3125	DP 0145	1
8	RBOU CATCH PLATE PLUNGER	RBOU 0008	1
9	RBOU TRIGGER RECOIL SPRING	RBOU 0039	1
10	SKO RECEIVER UPPER	SKO 00001	1
11	SKO RECEIVER LOWER	SKO 00002	1
12	SKO RECEIVER REAR HOUSING	SKO 00004	1
13	SKO BARREL EXTENSION	SKO 00005	1
14	SKO BARREL TUBE	SKO 00006	1
15	SKO BARREL LUG WITH GAS ASSIST	SKO 00007	1
16	SKO MAG TUBE BOLT SPRING GUIDE	SKO 00008	1
17	SKO HAMMER WITH BUSHING	SKO 00009	1
18	SKO BOLT BODY	SKO 00010	1
19	SKO TRIGGER	SKO 00011	1
20	SKO FOREND LEFT SIDE	SKO 00012	1
21	SKO FOREND TOP SHELL	SKO 00013	1
22	SKO REAR HAND GRIP	SKO 00014	1
23	SKO HAMMER SPRING	SKO 00015	1
24	SKO GAS ASSIST PISTON	SKO 00017	1

ITEM NO.	DESCRIPTION	PartNo	QTY.
25	SKO GAS ASSIST ORING SLEEVE	SKO 00018	1
26	SKO GAS SPRING SLEEVE	SKO 00019	1
27	SKO GAS ASSIST SPRING	SKO 00020	1
28	SKO GAS ASSIST SPRING LH NUT	SKO 00021	1
29	SKO SAFETY SEAR	SKO 00022	1
30	SKO BOLT RETURN SPRING	SKO 00023	1
31	SKO EXTRACTOR PLUNGER	SKO 00024	1
32	SKO HOLD OPEN PLUNGER	SKO 00025	1
33	SKO BOLT BUFFER SPRING	SKO 00027	1
34	SKO FOREND HEAT SHIELD	SKO 00029	2
35	SKO RECEIVER PICATINNY	SKO 00030	1
36	SKO SAFETY SEAR SPRING	SKO 00031	1
37	SKO LOCK RELEASE SPRING	SKO 00032	1
38	SKO CHARGER DETENT SPRING	SKO 00033	1
39	SKO RELEASE POST SPRING	SKO 00034	1
40	SKO HOLD OPEN SPRING	SKO 00035	1
41	SKO CHARGER DETENT BALL	SKO 00036	1
42	SKO PICTINNY RELEASE SPRING	SKO 00037	1
43	SKO FIRING PIN	SKO 00038	1
44	SKO FIRING PIN SPRING	SKO 00040	1
45	SKO EXTRACTOR SPRING	SKO 00041	1

ITEM NO.	DESCRIPTION	PartNo	QTY.
46	SKO EXTRACTOR	SKO 00042	1
47	SKO LAST ROUND BOLT HOLD OPEN	SKO 00045	1
48	SKO MAGAZINE RELEASE BUTTON	SKO 00046	1
49	SKO CLIP RELEASE POST	SKO 00047	1
50	SKO CLIP RELEASE HOLD BAR	SKO 00049	1
51	SKO SUPPORT TUBE NUT	SKO 00060	1
52	SKO SIGHT RAIL POST REAR	SKO 00062	1
53	SKO SIGHT RAIL POST FRONT	SKO 00063	1
54	SKO BOLT RETURN PLUNGER	SKO 00064	1
55	SKO BOLT CARRIER	SKO 00065	1
56	SKO CHARGER HANDLE	SKO 00066	1
57	SKO LOCK RELEASE PLUNGER	SKO 00067	1
58	SKO CARRIER SPRING ATTACHMENT	SKO 00068	1
59	SKO BOLT LOCK	SKO 00069	1
60	SKO HAMMER D SPRING	SKO 00070	1
61	SKO PICATINNY ATTACHMENT	SKO 00075	1
62	SKO MUZZLE SIGHT MOUNT	SKO 00077	1
63	SKO FRONT DETENT RECEIVER PIN	SKO 00078	1
64	SKO SAFETY PLUNGER	SKO 00079	1
65	SKO FOREND KNOB	SKO 00080	1
66	SKO REAR DETENT PIN	SKO 00082	1
67	SKO HAMMER BUSHING	SKO 00083	1
68	SKO PICATINNY RAIL PIN	SKO 00084	1
69	SKO TRIGGER PIN	SKO 00085	1
70	SKO HAMMER PIN	SKO 00086	1
71	SKO HOLD OPEN PIN	SKO 00087	1
72	SKO SAFETY BARREL	SKO 00090-1	1
73	SKO PICATINNY RELEASE PLUNGER	SKO 00098	1

ITEM NO.	DESCRIPTION	PartNo	QTY.
74	SKO FOREND KNOB DETENT(IN 00312 ASSY)	SKO 00099	1
75	SKO MAGAZINE RIGHT SHELL	SKO 00101	1
76	SKO MAGAZINE LEFT SHELL	SKO 00102	1
77	SKO MAGAZINE FOLLOWER	SKO 00103	1
78	SKO MAG LAST ROUND POST	SKO 00104	1
79	SKO MAGAZINE CLIP SPRING	SKO 00106-5	1
80	SKO MAGAZINE BOTTOM PLATE	SKO 00107	1
81	SKO MAGAZINE SPRING PLATE	SKO 00108	1
82	SKO FOREND ATTACHMENT	SKO 00109	1
83	SKO LAST ROUND POST PIN	SKO 00110	1
84	SKO REAR GRIP CAP	SKO 00119	1
85	SKO STOCK BODY WITHOUT COMOLD	SKO 00120	1
86	SKO STOCK RECOILPAD	SKO 00121	1
87	SKO STOCK LOP LEVER	SKO 00122	1
88	SKO LOP POST	SKO 00123	1
89	SKO STOCK LOP SPRING PIN	SKO 00124	1
90	SKO STOCK SUPPORT TUBE	SKO 00125	2
91	SKO STOCK LOP POST SPRING	SKO 00126	1
92	SLOTTED ROLL PIN .093 X .625	SKO 00127	1
93	SKO QR SWIVEL GROMMET	SKO 00128	1
94	SKO MAG LAST ROUND POST SPRING	SKO 00129	1
95	#5-40 SOCKET HD CAP SCREW X .375	SKO 00130	2
96	SKO GAS ASSIST STEEL SPLIT RING	SKO 00133	1
97	SKO GAS ASSIST ORING	SKO 00134	1
98	SKO RECEIVER STANDOFF	SKO 00135	1
99	SKO FIRING PIN STOP PIN	SKO 00136	1
100	SKO EXTRACTOR PIVOT PIN	SKO 00137	1
101	2.5MM SLOTTED ROLL PIN	SKO 00138	1
102	SKO BUFFER 2ND SPRING	SKO 00139	1
103	1/4-28 UNF SET SCREW X .3125	SKO 00140	1
104	#4-40 UNC SET SCREW X .19	SKO 00141	1
105	#8-32 UNC SET SCREW X .25	SKO 00142	2
106	SKO TENSION NUT DETENT SPRING	SKO 00143	1
107	2.5MM BALL DETENT	SKO 00144	1
108	SKO BUFFER SPRING STOP WASHER	SKO 00147	1
109	2MM SLOTTED ROLL PIN X 16MM	SKO 00148	1
110	2MM SLOTTED ROLL PIN X 10MM	SKO 00149	1
111	1/4-20 EXT TOOTH LOCKWASHER	SKO 00173	1
112	SKO FOREND DETENT DISC(IN 00312 ASSY)	SKO 00175	1
113	SKO FOREND RIGHT SIDE	SKO 00212	1
114	1/4-28 UNF SOC HD CAP SCREW X .625	SKO 00300	1
115	SKO SHORTY REAR HOUSING TUBE NUT	SKO 00380	1
116	SKO PUMP SAFETY END CAP	SKO 0090-2	2
117	#5-40 BUTTON HD CAP SCREW X .25	SKO 0172	4
118	SKO STOCK CHEEK REST	SKO 0220	1

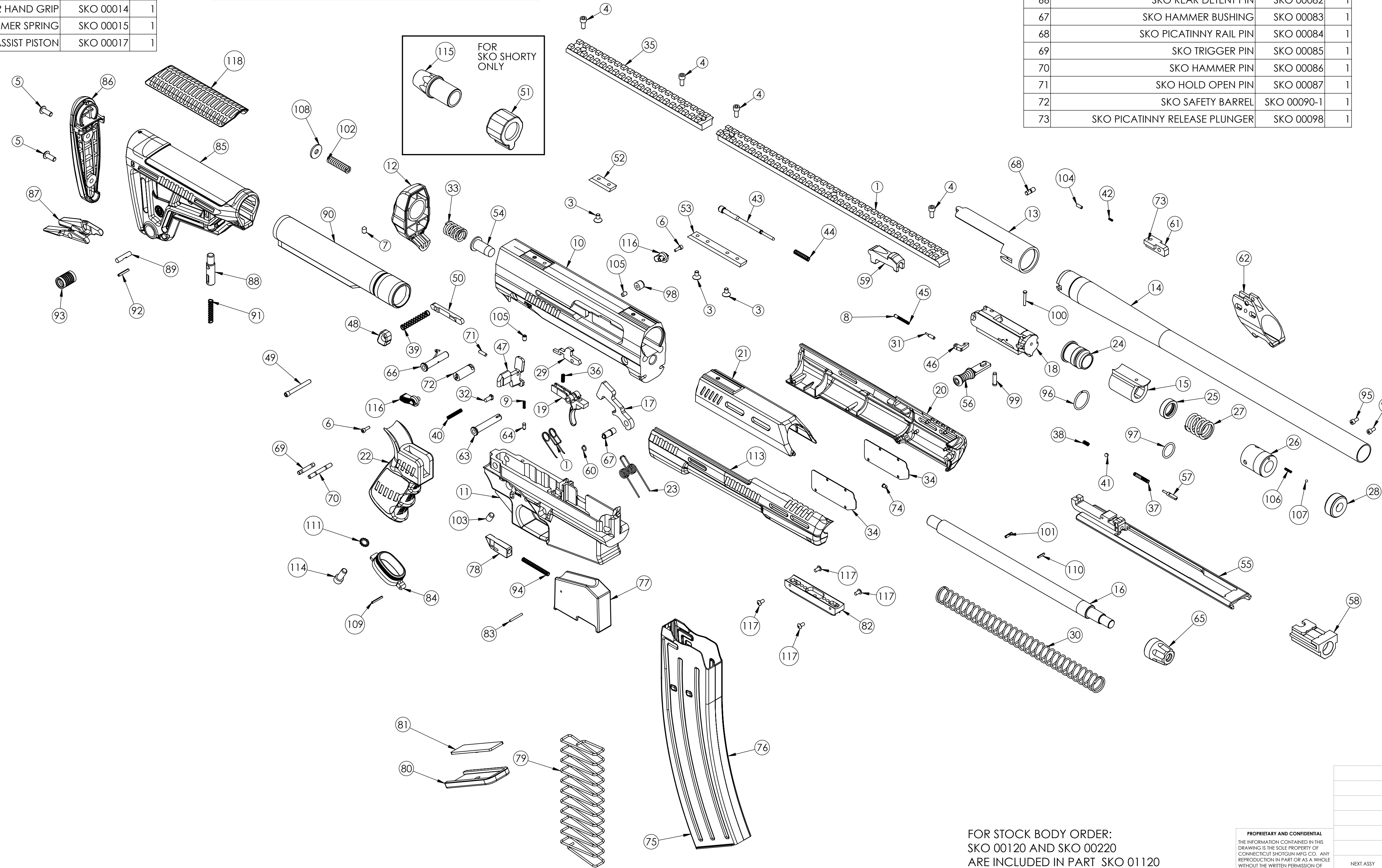

FOR STOCK BODY ORDER:  
SKO 00120 AND SKO 00220  
ARE INCLUDED IN PART SKO 01120

PROPRIETARY AND CONFIDENTIAL  
THE INFORMATION CONTAINED IN THIS DRAWING IS THE SOLE PROPERTY OF CONNECTICUT SHOTGUN MFG CO. ANY REPRODUCTION IN PART OR AS A WHOLE WITHOUT THE WRITTEN PERMISSION OF CONNECTICUT SHOTGUN MFG CO. IS PROHIBITED.

UNLESS OTHERWISE SPECIFIED: DIMENSIONS ARE IN INCHES TOLERANCES: FRACTIONAL ±.02 ANGULAR: MAX ±.12 BEND ± TWO PLACE DECIMAL ±.01 THREE PLACE DECIMAL ±.003		DRAWN PJC	NAME PJC	DATE 1/10/16	CONNECTICUT SHOTGUN MFG CO
INTERPRET GEOMETRIC TOLERANCING PER: MATERIAL		CHECKED ENG APPR.	ENG APPR.		TITLE: CLIP FED SHOTGUN EXPLODED VIEW
NEXT ASSY		G.A. COMMENTS:			SIZE DWG. NO. D SKO 11000 B
APPLICATION		FINISH			SCALE: 1:4 WEIGHT: SHEET 1 OF 2

D SK2 11000