

ITEM NO.	Description	MATERIAL	PartNo	QTY.	MFG PROCESS
1	#5-40 BTN HD CAP SCREW X .25		SKO 0172	4	
2	DBL PUMP SAFETY END CAP		SKO 0090-2	2	
3	DBL PUMP FRONT GRIP		DP 0125	1	
4	DBL PUMP GRIP CLASP		DP 0126	1	
5	DOUBLE PUMP 7 SLOT RAIL		DP 0129	1	
6	#8-32 BTN HD CAP SCREW		DP 0131	2	
7	#10-24 SMALL PATTERN HEX NUT		PURCHASED	2	
8	DP 0137		SP 00116	2	
9	SKO SAFETY PLUNGER SPRING		RBOU 0039	1	
10	SKO RECEIVER UPPER	ALUM 7075	SKO 00001	1	CSMC
11	SKO RECEIVER LOWER	ALUM 7075	SKO 00002	1	CSMC
12	SKO RECEIVER REAR HOUSING	PA66 30% GF	SKO 00004	1	
13	SKO BARREL EXTENSION		SKO 00005	1	
14	SKO BARREL TUBE	4140 STEEL	SKO 00006	1	TURNED
15	SKO BARREL LUG WITH GAS ASSIST	4140 STEEL	SKO 00007	1	MACHINED
16	SKO MAG TUBE BOLT SPRING GUIDE	STEEL ROD	SKO 00008	1	MACHINED
17	SKO HAMMER		SKO 00009	1	
18	SKO BOLT BODY	4140 STEEL	SKO 00010	1	FABRICATED
19	SKO TRIGGER		SKO 00011	1	
20	SKO FOREND LEFT SIDE		SKO 00012	1	
21	SKO FOREND TOP SHELL		SKO 00013	1	
22	SKO REAR HAND GRIP	PA66 NYLON GF	SKO 00014	1	
23	SKO HAMMER RETURN SPRING		SKO 00015	1	
24	SKO TRIGGER SPRING		SKO 00016	1	

ITEM NO.	Description	MATERIAL	PartNo	QTY.	MFG PROCESS
25	SKO GAS ASSIST PISTON		SKO 00017	1	
26	SKO GAS ORING SLEEVE		SKO 00018	1	
27	SKO GAS ASSIST SPRING LUGG		SKO 00019	1	
28	SKO GAS ASSIST SPRING		SKO 00020	1	
29	SKO GAS ASSIST LH NUT		SKO 00021	1	
30	SKO SAFETY SEAR		SKO 00022	1	
31	SKO BOLT RETURN SPRING		SKO 00023	1	
32	SKO EXTRACTOR PLUNGER		SKO 00024	1	
33	SKO HOLD OPEN PLUNGER		SKO 00025	1	
34	SKO BOLT BUFFER SPRING		SKO 00027	1	
35	SKO FOREND HEAT SHIELD		SKO 00029	2	
36	SKO SAFETY SEAR SPRING		SKO 00031	1	
37	SKO LOCK PLUNGER SPRING		SKO 00032	1	
38	SKO CHARGEER DETENT SPRING		SKO 00033	1	
39	SKO MAG RELEASE B4 SPRNG		SKO 00034	1	
40	SKO HOLD OPEN SPRING		SKO 00035	1	
41	SKO CHARGER DETENT BALL		SKO 00036	1	
42	SKO FIRING PIN		SKO 00038	1	
43	SKO FIRING PIN SPRING		SKO 00040	1	
44	SKO EXTRACTOR SPRING	MUSIC WIRE	SKO 00041	1	PURCHASED
45	SKO EXTRACTOR		SKO 00042	1	

ITEM NO.	Description	MATERIAL	PartNo	QTY.	MFG PROCESS
46	SKO LAST ROUND BOLT HOLD OPEN	4140 STEEL	SKO 00045	1	
47	SKO MAGAZINE RELEASE BUTTON		SKO 00046	1	
48	SKO CLIP RELEASE POST	STEEL	SKO 00047	1	MIM
49	SKO CLIP RELEASE BAR		SKO 00049	1	
50	SKO BOLT RETURN PLUNGER		SKO 00064	1	
51	SKO BOLT CARRIER		SKO 00065	1	
52	SKO CHARGER HANDLE		SKO 00066	1	
53	SKO LOCK RELEASE PLUNGER		SKO 00067	1	
54	SKO MUZZLE SIGHT MOUNT		SKO 00068	1	
55	SKO BOLT LOCK INSERT		SKO 00069	1	
56	SKO HAMMER D RING		SKO 00070	1	
57	SKO FRONT DETENT RECEIVER PIN		SKO 00078	1	
58	SKO SAFETY PLUNGER		SKO 00079	1	
59	SKO FOREND KNOB		SKO 00080	1	
60	SKO REAR DETENT PIN		SKO 00082	1	
61	SKO HAMMER BUSHING		SKO 00083	1	
62	SKO TRIGGER PIN		SKO 00085	1	
63	SKO HAMMER PIN		SKO 00086	1	
64	SKO HOLD OPEN BUTTON PIN		SKO 00087	1	
65	SKO SAFETY BARREL		SKO 00090-1	1	
66	SKO FOREND KNOB DETENT		SKO 00099	1	
67	SKO MAGAZINE RIGHT SHELL		SKO 00101	1	
68	SKO MAGAZINE LEFT SHELL		SKO 00102	1	
69	SKO MAGAZINE FOLLOWER		SKO 00103	1	
70	SKO MAG LAST ROUND HOLD OPEN		SKO 00104	1	
71	SKO MAGAZINE CLIP SRPING 5RND		SKO 00106-5	1	
72	SKO MAGAZINE BOTTOM PLATE		SKO 00107	1	
73	SKO MAGAZINE SPRING PLATE		SKO 00108	1	
74	SKO FOREND ATTACHMENT		SKO 00109	1	

ITEM NO.	Description	MATERIAL	PartNo	QTY.	MFG PROCESS
75	SKO LAST ROUND POST PIN		SKO 00110	1	
76	SKO REAR GRIP CAP	70 DUJR RUBBER	SKO 00119	1	
77	SKO LAST ROUND POST SPRING		SKO 00129	1	
78	#10-24 SOC HD CAP SCREW		SKO 00130	2	
79	SKO GAS STEEL ORING		SKO 00133	1	
80	SKO GAS ASSIST ORING		SKO 00134	1	
81	SKO RECEIVER STANDOFF		SKO 00135	1	
82	SKO FIRING PIN STOP		SKO 00136	1	
83	SKO EXTRACTOR PIN		SKO 00137	1	
84	SKO 2.5 MM ROLL PIN		SKO 00138	1	
85	SKO BUFFER SPRING #2		SKO 00139	1	
86	1/4-28 SET SCREW X .312		SKO 00140	1	
87	#8-32 UNC SET SCREW X .25		SKO 00142	2	
88	SKO GAS NUT DETENT SPRING		SKO 00143	1	
89	SKO GAS DETENT BALL PLUNGER		SKO 00144	1	
90	SKO BUFFER SPRING WASHER		SKO 00147	1	
91	2MM SLOTTED ROLL PIN X 18		DP 0134	2	
92	SKO FOREND DETENT DISC		SKO 00175	1	
93	SKO FOREND RIGHT SIDE		SKO 00212	1	
94	1/4-28 SOCKET HD CAP SCREW		SKO 00300	1	
95	SKO SHORTY STOCK SUPPORT		SKO 00361	1	
96	SKO SHORTY END CAP		SKO 00380	1	

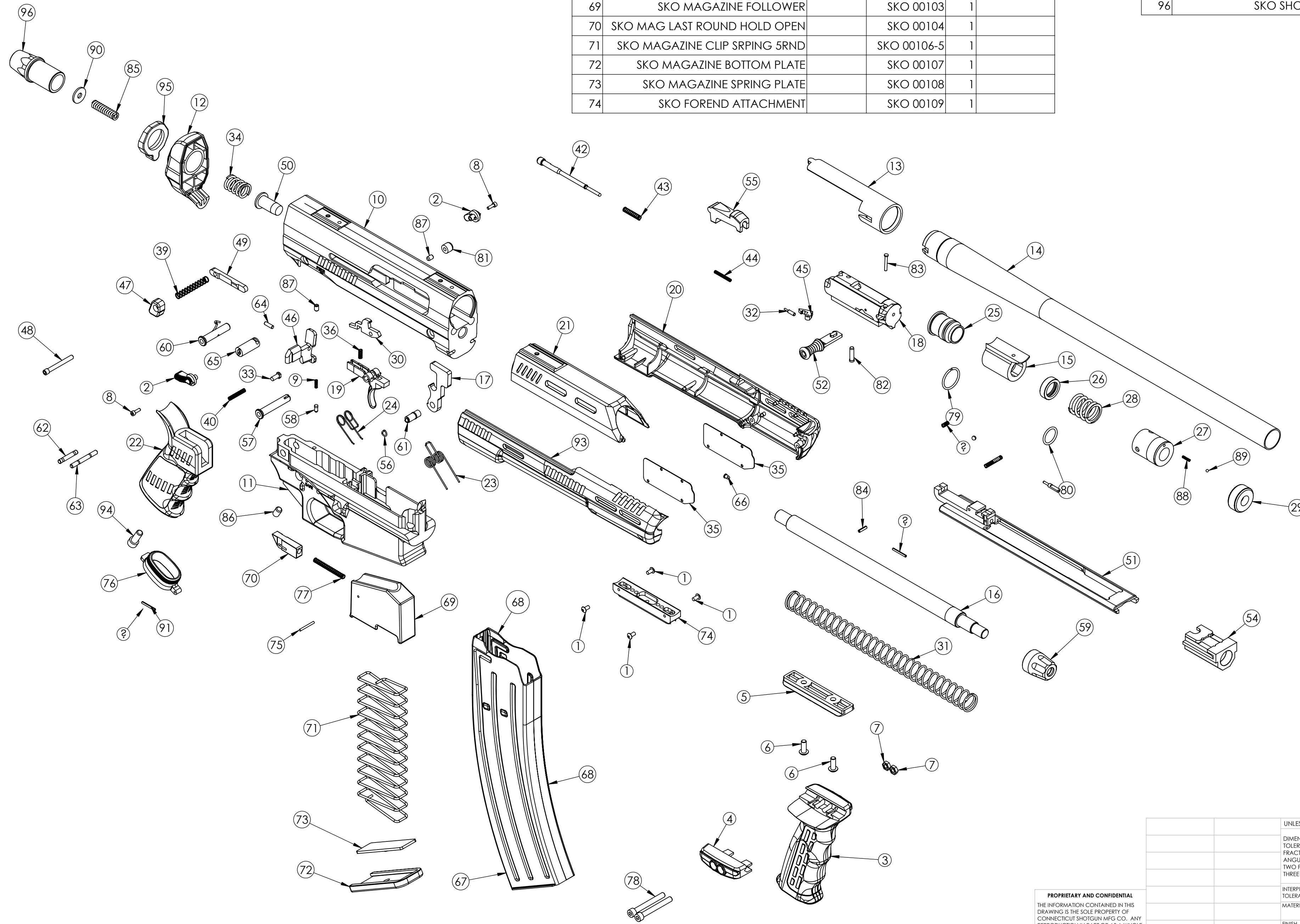

FOR STOCK BODY ORDER:  
SKO 00120 AND SKO 00220  
ARE INCLUDED IN PART SKO 01120

PROPRIETARY AND CONFIDENTIAL  
THE INFORMATION CONTAINED IN THIS  
DRAWING IS THE SOLE PROPERTY OF  
CONNECTICUT SHOTGUN MFG CO. ANY  
REPRODUCTION IN PART OR AS A WHOLE  
WITHOUT THE WRITTEN PERMISSION OF  
CONNECTICUT SHOTGUN MFG CO. IS  
PROHIBITED.

UNLESS OTHERWISE SPECIFIED:		NAME	DATE	CONNECTICUT SHOTGUN MFG CO
DRAWN	P/JC		1/10/16	
CHECKED				
ENG APPR.				
MFG APPR.				
G.A.				
COMMENTS:				
TITLE	CLIP FED SHORTY SHOTGUN EXPLODED VIEW			REV
SIZE	DWG. NO. SKO 21000			
SCALE	1:4 WEIGHT:			SHEET 1 OF 1
APPLICATION				

REV  
D SK2 21000