



SIX BASE

PRODUCT DESIGN PARTNERS

Access Doors
Access Panels

Rated Supplier for Construction Industry

UNIVERSAL ACCESS DOOR

SAD-EC-XXX

Universal All Purpose Access Door is ideal for cost and its aesthetics. This are applicable for various application, such as wires behind walls or ceiling, valves water connections, etc.

Design

- Door is 18 Gauge Satin Coat/Galvannealed Steel.
- It comes with one piece seamless Frame with 1.25" flange.

Hardware

- It comes with standard Stainless Steel Cam Latch which can be opened by Screw driver.
- This can be optionally ordered to come with Keyed Locks for added security.
- Designed to come with Piano Hinge same as the length of the Door.

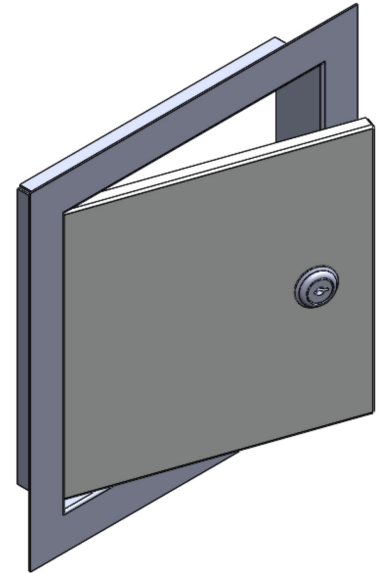

Standard Sizes for SAD-EC-xxx

Model #	Inches	Latches
SAD-EC-0606	06 x 06	1
SAD-EC-0808	08 x 08	1
SAD-EC-1010	10 x 10	1
SAD-EC-1212	12 x 12	1
SAD-EC-1414	14 x 14	1
SAD-EC-1616	16 x 16	1
SAD-EC-1818	18 x 18	1
SAD-EC-2020	20 x 20	1
SAD-EC-2424	24 x 24	2
SAD-EC-2230	22 x 30	2
SAD-EC-2236	22 x 36	2
SAD-EC-2436	24 x 36	2
SAD-EC-2448	24 x 48	2

