

# LOCKWOOD ANGUS

## FARM AND RANCH CUSTOM FARM TOYS FLAT BED TRUCK KIT

Congratulations on your purchase. This kit is designed to be built by beginners and experts as well. We believe it will provide you with many hours of enjoyment in your collection or display. All of our kits are designed to make a base model and may be customized and upgraded with your imagination. Be sure to follow our Facebook page for hints and tips as we grow for your hobby.

ADULT SUPERVISION RECOMMENDED UNDER 14 YEARS OF AGE. KITS MAY REQUIRE USE OF SHARP TOOLS AND CA GLUES.

Follow steps in order. Do not rush and do not force parts. Styrene plastic can and will break if forced. Each part is laser cut to exact size but may require sanding with an emery board or sand paper. Read our hints section before beginning construction and enjoy your build.

### 1. Bed Construction

*You may remove by breaking the bridging tabs or cutting.*

**A:** Lay Bed flat on surface, check that tabs are clear and the Headache Rack will fit easily onto front of Bed.

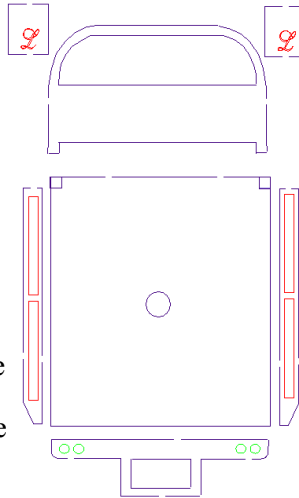

**B:** If you wish to put the Side Boards on your bed prepare both boards ensuring you have desired fit.

**C:** Apply glue to bottom of Headache Rack and insert tabs into front. Apply Glue to bottom and front end of Side Rails and set in desired location. Make sure you have a good fit against the Headache Rack and Side Board for better appearance and strength.

**D:** Determine what truck you are mounting the bed on and set the bed on the frame to determine where you want to apply the Tail Drop. Most beds only have a few inches of overhang so take this into consideration. Apply glue to top of Tail Drop and hold against bottom of Bed until set.

**E:** If you wish to apply Mud Flaps place bed in position and apply glue to top of Mud Flaps and hold in place against bottom of Bed behind rear wheels of truck.

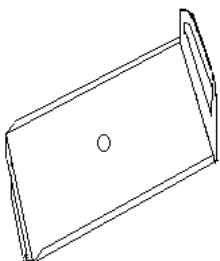

#### CUSTOMIZE YOUR BED

Consider putting a piece of mesh in the Headache Rack by using screen, toole, or hobby mesh. Add tool boxes underneath or on top, cake feeders, or some tools on the bed. We also offer a diamond plate paper that may be applied. Paint to match your truck, and even try your hand at striping if you don't want to apply DOT striping. Paint tail lights.

#### HELPFUL HINTS

*When sanding straight edges flat lay your sand paper or emery board flat and hold the pieces in your hand pressing against flat surface. I only hold sand paper when I am sanding a round radius or sanding a large flat sheet. Cheap fingernail emery boards and 400 to 800 grit sand paper are my choice.*

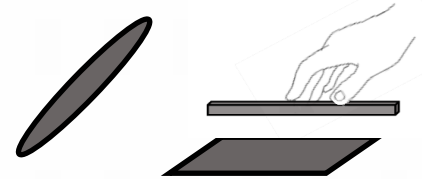

*When gluing, seldom use the bottle to apply your glue. If you are working where too much glue can ruin your piece apply it with an applicator, tooth pick, or scrap piece of styrene. Nothing like ruining a piece because the glue ran.*



*THESE ARE SUGGESTIONS ONLY FROM MY BENCH TO YOURS.*

We take pride in sending you this kit, all pieces are pre-inspected. As with all laser cuts there is a best side for display, study your pieces and use them where they fit best. If any thing is missing or breaks call us immediately.