

LOCKWOOD ANGUS

FARM AND RANCH

CUSTOM FARM TOYS

OPEN TOP STOCK TRAILER KIT

Congratulations on your purchase. This kit is designed to be built by beginners and experts as well. We believe it will provide you with many hours of enjoyment in your collection or display. All of our kits are designed to make a base model and may be customized and upgraded with your imagination. Be sure to follow our Facebook page for hints and tips as we grow for your hobby.

ADULT SUPERVISION RECOMMENDED UNDER 14 YEARS OF AGE. KITS MAY REQUIRE USE OF SHARP TOOLS AND CA GLUES.

Follow all steps in order. Do not rush and do not force parts. Styrene plastic can and will break if forced. Each part is laser cut to exact size but may require sanding with an emery board or sand paper.

Read our hints section before beginning construction and enjoy your build.

1. Bottom and Side Construction

A: Make sure the edges of the Bottom are sanded or trimmed smooth from the bridging tabs. The edges of the Bottom glue onto the Sides (illustration 1) The back of the trailer should be even. One Side panel has a hole for the trailer jack. Install this on the left or driver side of the assembly. Glue the front plate in while assembling the Side plates to help ensure a good square box.

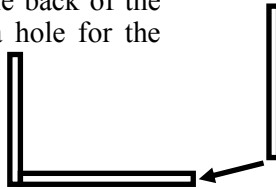

NOTE: The front plate has notches on the top.

2 Fenders and Bows

A: Glue Fender Skirts on top of bottom pan. Insert Bows into holes while doing so to ensure that holes are in proper position. The Bows should rest against the Side Panel if Fender Skirts are properly aligned. Bows are precut to length but may vary slightly. It is recommended to glue front and rear Bow in position and place a straight edge to ensure top is straight.

Bows are pre shaped but may require flexing to get into the fender skirts. These parts can break if too much pressure is applied.

Glue Tail Light Plates in place during assembly to ensure clearance.

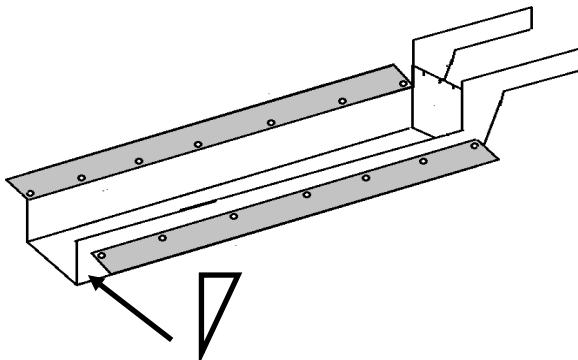
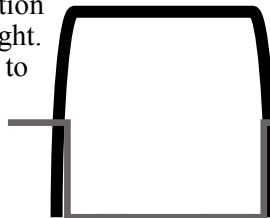

HELPFUL HINTS

When gluing Bows we recommend applying small amount of glue to Bow and setting on a flat surface, ensure Bow is straight and allow glue to set. Glue applied to Side Panel will often show through the paint.

Styrene plastic will melt easily when heat is applied. If you need to bend a piece you can apply enough friction between your fingers while rubbing back and forth to make it bend easier.

When gluing seldom use the bottle to apply your glue. If you are working where too much glue can ruin your piece apply it with an applicator, tooth pick, or scrap piece of styrene. Nothing like ruining a piece because the glue ran.

We take pride in sending you this kit, all pieces are pre-inspected. As with all laser cuts there is a best side for display, study your pieces and use them where they fit best. If any thing is missing or breaks call us immediately.

OPEN TOP STOCK TRAILER KIT

3.

Wall Panels

Each trailer kit comes with slats to install on the wall of the trailer. These are cut for a high side trailer with 4 slats. You may remove one slat by snapping the top off. We are build 3 slat trailers unless requested for a high side.

A: After deciding on wall height apply glue to inside of front and back Bow where Wall Panel makes contact. Insert panel sliding to front until it makes contact with the Front Panel. Spacing between the Wall Panel and Fender Skirt is up to the builder. Repeat process for other side. Go back and apply glue to inside bows and allow to set.

NOTE: The Wall Panels are cut a little long on purpose. You may trim these to the length you have finished now with a pair of scissors or cutters.

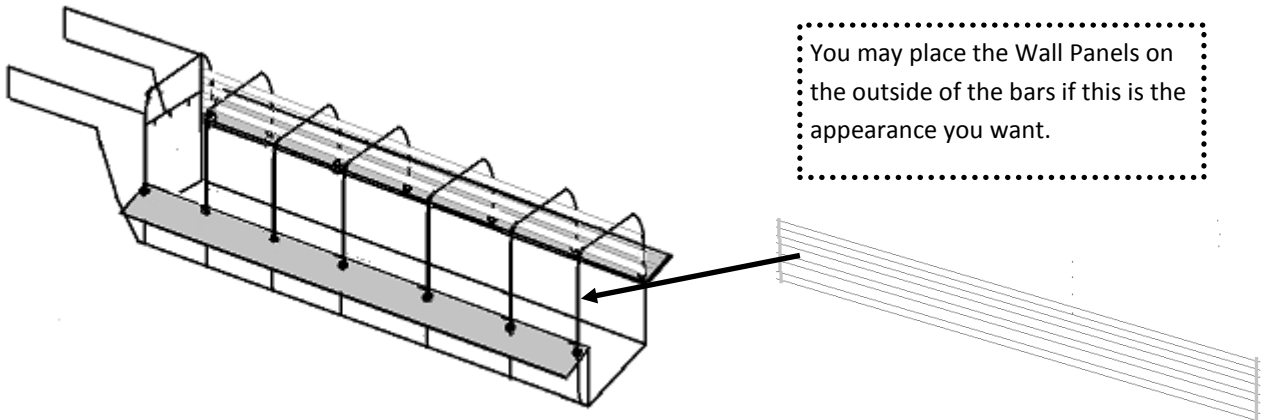

4.

Gates

Each trailer kit comes with enough gates and hardware for you to select several option. Three full width gates and a set of doubles gives you many choices. Standard configuration for a 24 ft trailer is one center gate at 12 foot. This is your choice.

A: Glue Round 1 mm styrene rod to Gate on side allowing to extended past top and bottom of Gate, this will be trimmed to required length later..

B: Place wood floor in bottom of trailer. Glue one Hinge tab above floor line against Side Panel where you wish gate to be positioned. Remove Wood Floor. You may insert Gate and place second Hinge on top for marking. Due to tight clearances it is not recommended that you glue in place with Gate inserted. The gate can be reinserted easily by bowing once the glue on both hinges has set. You may sand or trim the Hinges to ensure you have proper clearance for the gate to meet your specifications.. The double gates are joined together, we recommend you do not cut them apart until both gates are mounted to ensure they stay even.

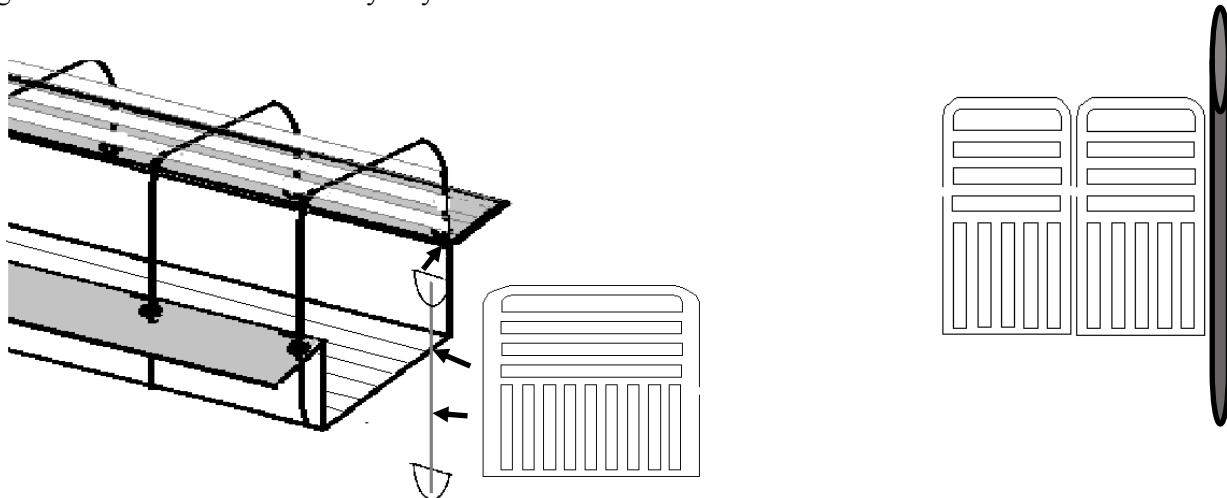

OPEN TOP STOCK TRAILER KIT

5.

Bar Placement

Your kit includes enough rod to complete this design. You may customize and place rods where you wish. None of the rods are cut to length. Trim to length after glue sets.

A: Lay the five Top Bars out on top of the Bows. The notches in the front plate are spaced to allow even spacing. Side bars should meet your specification's on placement but will fit on edge.

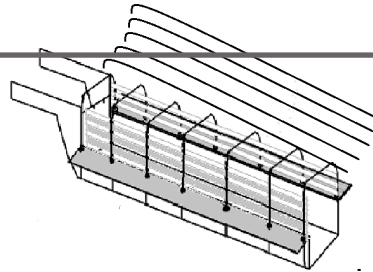

NOTE: The downturn on the Top Bar is longer than needed. Lay

B: The Inside Round Bar is molded to slide inside your trailer. This bar slides inside the bows and glues above the Wall Panels you have previously set. If you went with the high side version you may not have space for the Inside Round Bar.

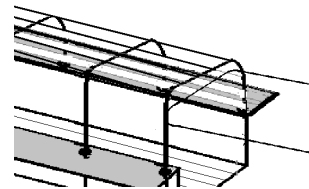

C: Once all bars are in place on top you may take the two remaining round bars and place an X across the top of Trailer from one corner to the other. If you wish to you may bend the bars downwards onto tongue for bracing.

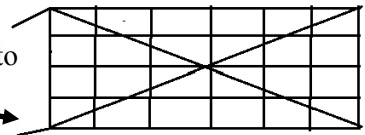

5.

Tongue assembly

A: During this process you will gently bend the front extension of the Side Panels until they meet in middle.

NOTE: If you start to see any breakage where you have bent the extensions apply glue to the inside of the arms

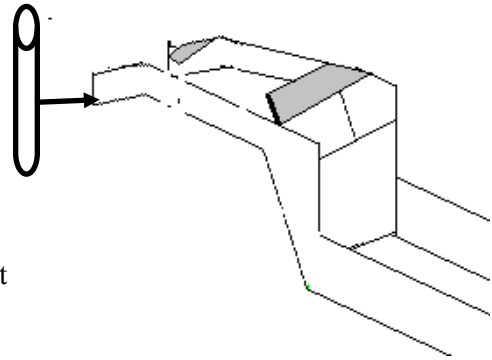

B: Glue the Neck into place on the front of the trailer, Make sure it is in the center when placing this piece. You may place the neck even on the top edge or leave it sticking up to meet your needs. Length may be cut to fit height of the truck your are using once tongue assembly is complete.

C: Glue cross braces in place once your Neck has set properly. The cross braces must be trimmed to fit your build correctly.

NOTE: Try holding Cross Braces in place and mark from the bottom side with a pencil to get good lines to trim too.

To bend styrene and make a straight line try holding it in a set of pliers with a straight jaw apply light pressure and set your angle creating a straight bend.

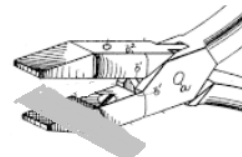

OPEN TOP STOCK TRAILER KIT

7.

Axle and Wheel Installation

Your kit comes with precut axles and brass rods. Apply a light amount of glue onto tip of brass rod and install wheel, make sure they are straight by setting flat as glue dries.

A: Glue Axle Assemblies to bottom of trailer assembly in desired location. Make certain they are spaced apart to allow enough space for both tires. These may be placed any place you desire on the side. Install brass rods and wheels after painting.

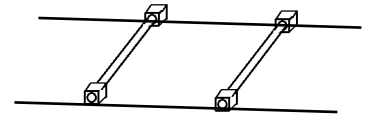

8.

Trailer Jack Assembly

A: Glue the Square Jack on the front plate. Make certain the hole for the handle is in the appropriate location.

.....
B: Take the lower jack assembly and screw it into the upper Square Jack you just mounted. Turn it until it is all the way in for the next step.

C: Place Jack Handle into hole on side you have positioned and place small amount of glue in hole where handle goes through Side Panel from the inside. Placing glue on the Jack itself may glue the Bottom in a fixed position. If you leave this out you may insert handle into center blocking screw from going upwards.

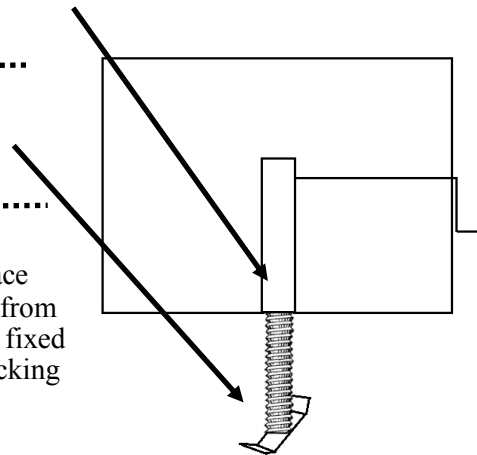

9.

Final Assembly

A: Prepare your model and paint desired color. We use 400 to 800 grit sand paper to ensure the surfaces are ready.. Read B in this section and insert Pin if desired before painting.

.....
B: Glue Spare Tire in desired location . It may be glued on side above fender or on Cross Brace on front. A typical placement is on the front Cross Brace. We often insert a small pin to help hold Spare Tire.

.....
C: DOT striping has been provided and may be added to sides, gates, or tongue for a finished detaill

.....
D: slide wood flror in place, apply glue across front and back to set in place before installing.



CONGRATULATIONS ON YOUR ASSEMBLY! We believe this is a high quality piece that will bring hours of enjoyment to your collection or display. If you have any question get in contact with us.