

Fisherbrand Lab Furnishings

Comprehensive Design Services.

Fisherbrand™ Lab Furnishings offers free comprehensive design services to help clients create highly functional and efficient laboratory spaces.

Our experienced project managers are proficient in AutoCAD, enabling them to develop detailed lab layouts with multiple perspectives, including top views and elevation views.

Whether you're renovating an existing lab or constructing a new one, our team will guide you through every stage of the process, ensuring that your space is optimized for workflow, safety, and future expansion.

By working closely with clients, we help define key design considerations and provide valuable insights that lead to a well-planned and effective laboratory environment.

The design process begins with understanding the available space, carefully surveying the area to determine spatial requirements, utility services, and essential equipment considerations such as fume hood placement.

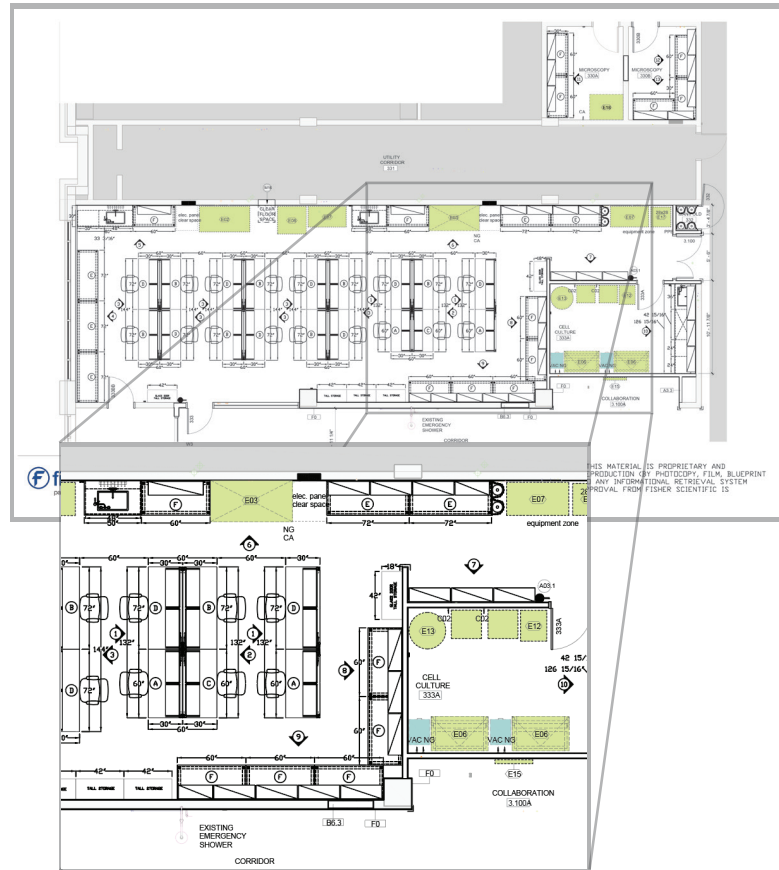
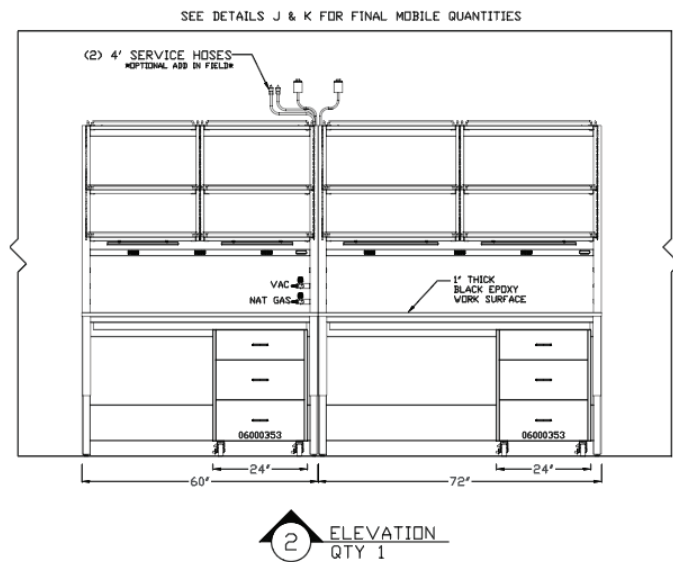

Once the space is assessed, our team assists in selecting a casework layout that maximizes efficiency while adhering to industry standards. From cabinets and countertops to specialized configurations and controlled environment requirements, our experts help clients curate a complete list of necessary components to outfit their labs. Throughout the process, we offer sample layouts and planning tools to ensure that every element is thoughtfully integrated into the overall design.

Enhancing Lab Design with Revit 3D Modeling

Revit allows clients to:

- Visualize their lab before construction begins
- Ensure better planning
- Gain spatial optimization
- Have better informed decision-making.

To provide an even more immersive planning experience, Fisherbrand Lab Furnishings also offers full Revit renderings of lab spaces.

Autodesk Revit is a powerful Building Information Modeling (BIM) tool used to create detailed 3D models that showcase the design, layout, and infrastructure of a laboratory before construction begins.

This advanced visualization capability allows clients to explore different configurations, assess spatial relationships, and make informed decisions before finalizing their plans.

By leveraging both AutoCAD and Revit, our team delivers precision-driven, high-quality lab designs that support functionality, safety, and long-term adaptability.

See full catalog of Fisherbrand lab furniture at fisherlabfurniture.com/

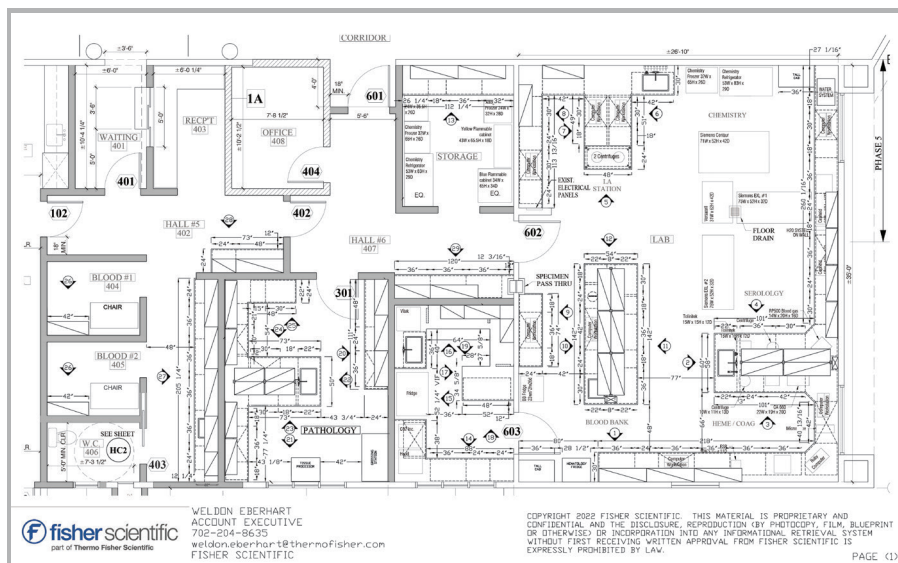

Distributed by Fisher Scientific. Contact us today:

In the United States

Order online: fishersci.com

Call customer service: 1-800-766-7000

In Canada

Order online: fishersci.ca

Call customer service: 1-800-234-7437