



User Guide for i-Home app

1. Wi-Fi Function

Wi-Fi function enables the monitor to be connected with Wi-Fi network and Mobile App. The end user could answer the call from outdoor panel through Mobile App.

1.1 Wi-Fi Connection

Touch  to enter the system setting, choose  Wi-Fi Setting, come to **Choose a network** and select your Wi-Fi network and input password to connect the Wi-Fi

1.2 Device ID and Download App

 **Device ID** Enter to get the QR code of Wi-Fi Device ID. Scan the QR to add the device to App.

 **Download App** Scan the QR Code to download the i-Home App.

2. i-Home App operation Guide

2.1 Mobile Phone OS requests:

IOS 8.0 and above Android 4.3 and above

2.2 i-Home App Download

Method 1: Enter system setting to scan the QR code to download the App.

Method 2: Search i-Home in Google or Apple Store to download the App.

The App Icon is as below 

2.3 i-Home App account registration

Please follow below steps for the account registration.

Open the App => Sign Up => Select the region => Input mobile phone or email ID => Get the verification code => Input verification code => Set log-in password => Log in

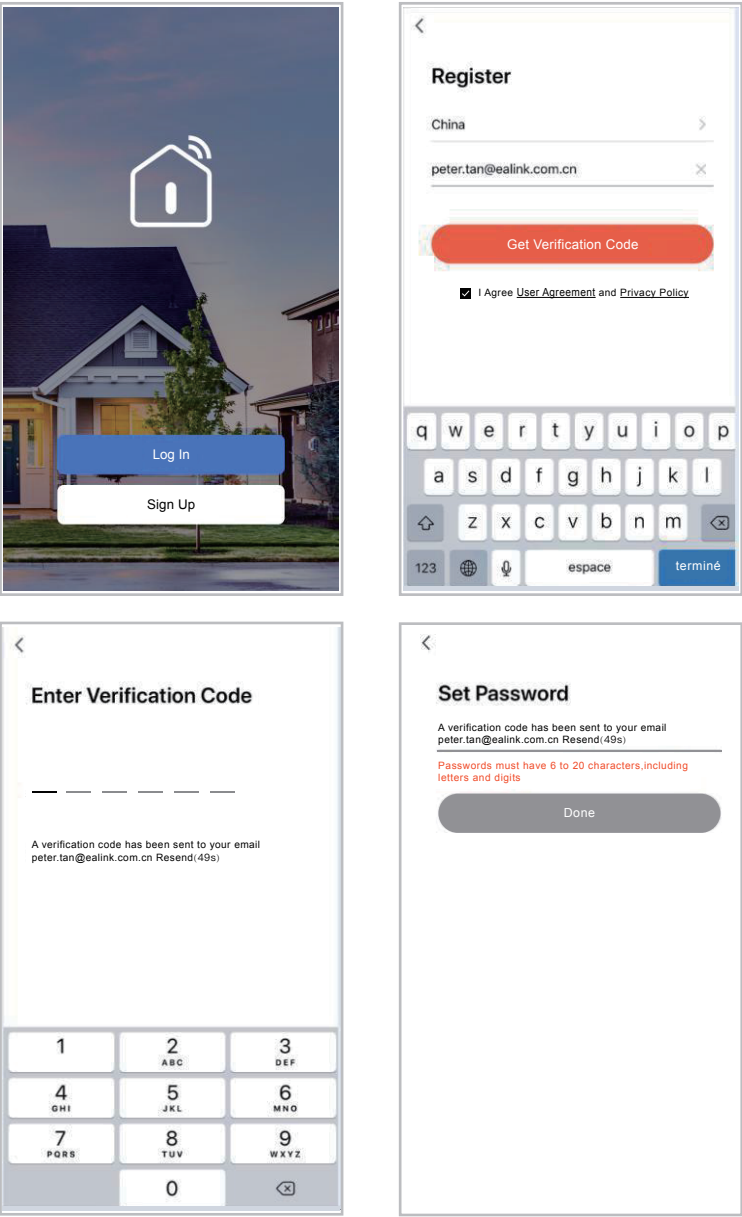

2.4 Add Device

Please follow below Route to add device:

Open the App => Log in => Home => Touch Add Icon  on the upper right corner => Touch scan icon

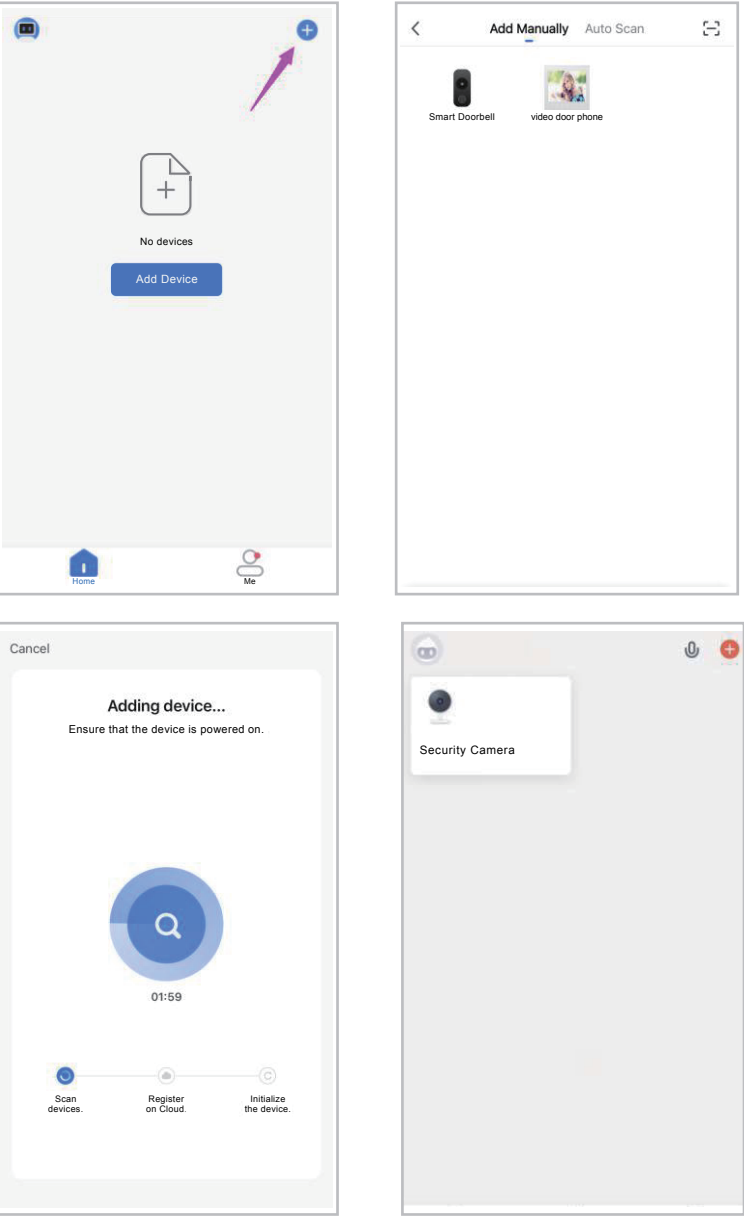









 => Scan the QR Code of DEVICE ID in monitor's setting page => Device added.

Remark:

- (1) The first account which has added the device is the master account. The master account could share the links to other Tuya/i-Home account to add the device.
- (2) Maximum 10 accounts could be added to the device.
- (3) When making a call from outdoor panel, all the mobiles which have added the device will receive the call. The first one which answers the call could make a video intercom with the outdoor panel.
- (4) Only one mobile phone could monitor the outdoor panel at the same time.

2.5 i-Home App operation Guide

Touch the Icon of security camera/added device to enter the monitoring interface.

- 
Gate
- Gate: Touch it to open the gate lock.
- 
Two-way talk
- Two-way Talk: Touch it to active the talking with outdoor panel
- 
Door
- Door: Touch it to open the door lock.
- 
Video
- Video: Touch it to start recording a video.
- 
Screenshot
- Screenshot: Touch it to take a picture.
- 
Cameras list
- Cameras List: Touch it to see the outdoor stations which have been added by the monitor.
- 
Album
- Album: Touch it to view the recorded video and photo
- 
- Touch it to enter setting interface

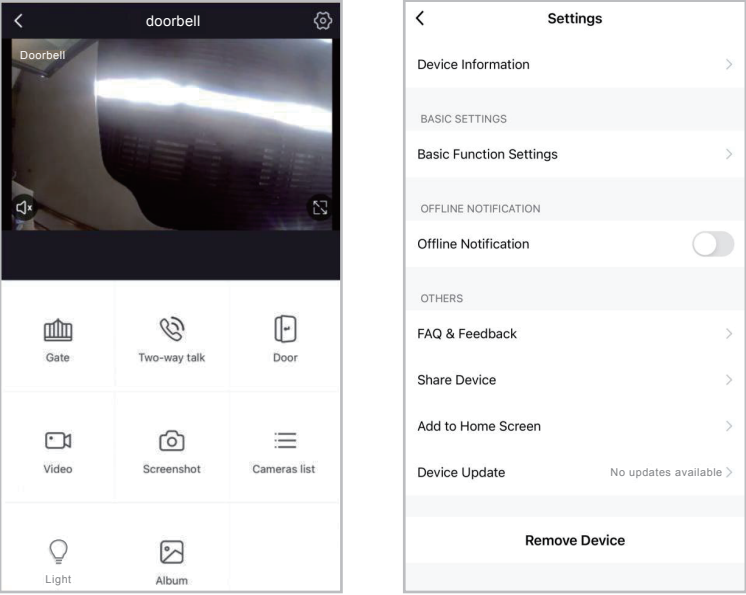

Device Name: Change the name of added device.

Share Device: The master account could share the device to other account to add it.

Device information: For checking the device information.

FAQ&Feedback

Basic Function Settings: Talk mode setting.

Firmware information: Show the firmware version.

Remove Device: Removing the device from this account

2.6 App Setting

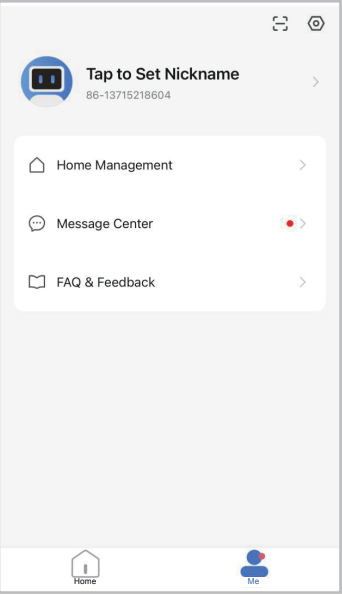

Home management: For creating a home or join a home.

Message Center: Records for the activities of added devices.

FAQ&feedback