

#### NEGATIVE WELL AND BOAT LAUNCH NOTES

- RECONFIGURED DOCK CONSTRUCTION WILL BE WOOD PILE AND CRIB.
- RECONFIGURED DOCKING ELEVATION SHALL BE SET AT 505.82.
- INSTALL COFFER DAM AND NEGATIVE WELL FIRST, RESTRICTING CONSTRUCTION IMPACTS TO WITHIN 15' OF THE NEGATIVE WELL STRUCTURE.
- DREDGED MATERIAL SHALL BE DISPOSED OF OUTSIDE OF WETLAND AND SHORELAND JURISDICTIONAL AREAS. IF SUCH MATERIAL IS FOUND TO HAVE VISUAL OR OLFACTORY EVIDENCE OF CONTAMINATION SUCH MATERIAL SHALL BE MANAGED AND DISPOSED OF IN ACCORDANCE APPLICABLE STATE STATUTES.
- REMOVE TURBIDITY CURTAIN AND COFFER DAM ONCE WATER CLARITY HAS RETURNED TO BACKGROUND CLARITY
- CONSTRUCTION OF THE BOAT LAUNCH AND NEGATIVE WELL REQUIRES A NET 22.0 CY CUT (110.3 CY CUT; 88.3 CY FILL) BELOW TOP OF BANK. THIS EQUATES TO 2,421 SF CUT AND 3,122 SF FILL IN PLAN VIEW.

FOR US A.C.O.E. AREA CALCULATIONS BELOW ORDINARY HIGH WATER MARK (REFERENCE LINE), THE PROJECT REQUIRES NET 34.7 CY CUT (95.3 CY CUT; 60.6 CY FILL). THIS EQUATES TO 1,698 SF CUT AND 2,015 SF FILL IN PLAN VIEW.

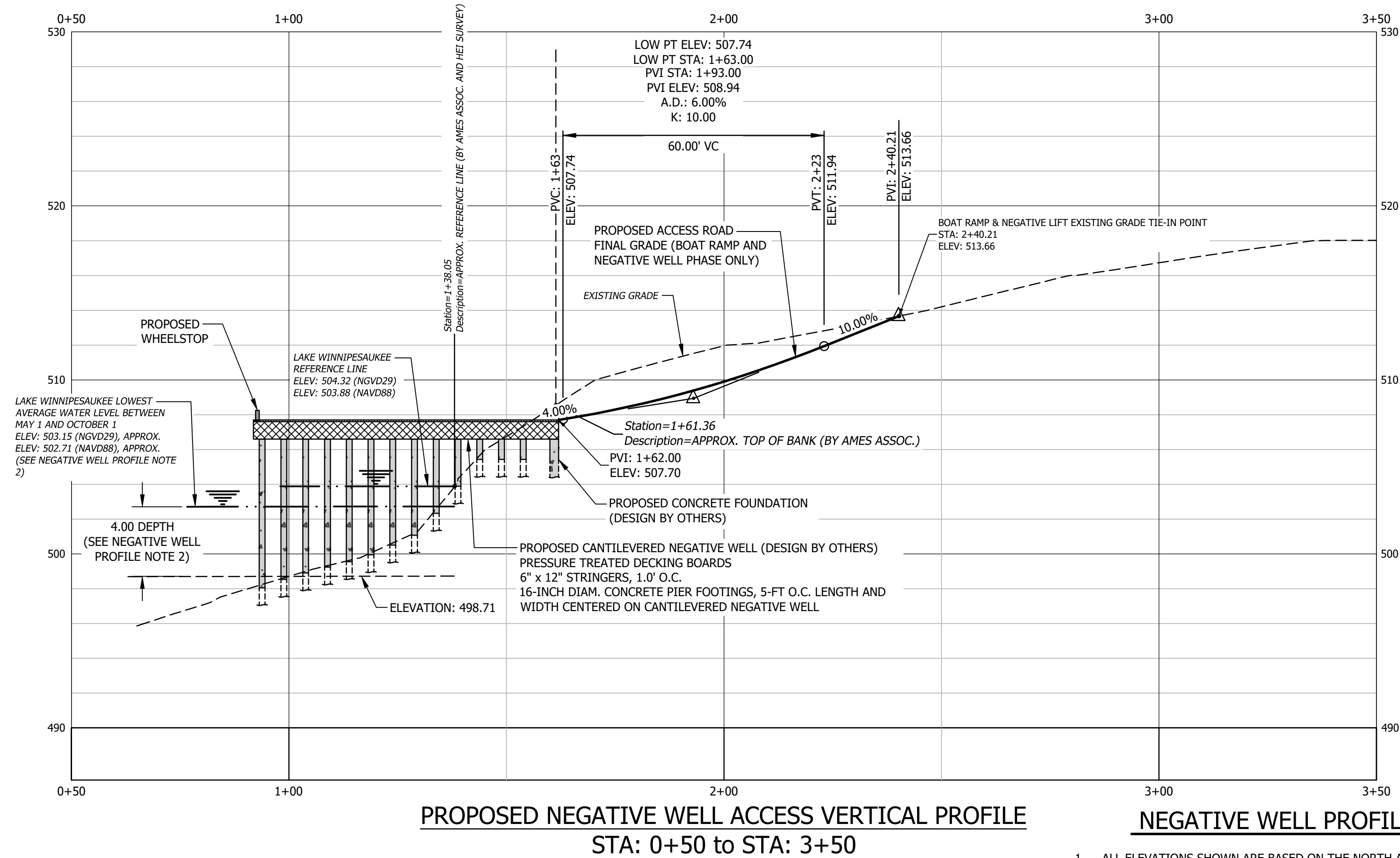

PROPOSED BOAT RAMP VERTICAL PROFILE  
STA: 0+00 to STA: 2+40

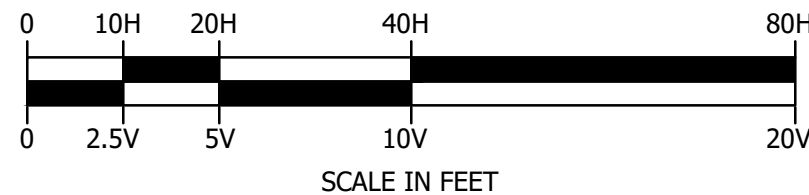

DATE OF PRINT  
NOVEMBER 06 2024  
HORIZONS ENGINEERING

© 2024  
horizons  
Engineering  
All rights reserved

**horizons**  
Engineering  
Civil and Structural Engineering  
Land Surveying and Environmental Consulting  
MAINE • NEW HAMPSHIRE • VERMONT  
www.horizonsengineering.com

GOODHUE MEREDITH, LLC

31 LOVEJOY SANDS ROAD  
COMMERCIAL BOAT LAUNCH AND  
NEGATIVE WELL IMPROVEMENTS

MEREDITH, NEW HAMPSHIRE

TAX MAP U35 LOTS 8A & 11 - SHORELINE "S" DISTRICT

PROPOSED COMMERCIAL BOAT RAMP  
& NEGATIVE WELL PLAN & PROFILE

NO.	DATE	REVISION DESCRIPTION	ENG	DWG

DATE: NOV 2023	PROJECT #: 20818
ENGINE'D BY: -	DRAWN BY: WAM
CHECK'D BY: WTD	ARCHIVE #: -
SHEET C2.1	