

A Series

Smart panel apply to lighting switch, curtain control with long push/short push/reverse function

- Function feature: front laser LED indicator
- Material: aluminum alloy wire-drawing / matt panel
- Color: Volcanic Gray, Silver, Black, Champagne Gold (support customization)
- Certificate: CE, KNX

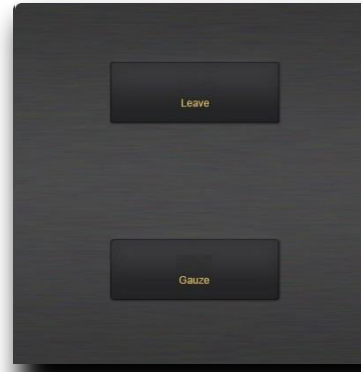

PC-22MK.8.2/A



PC-22MK.8.2/A

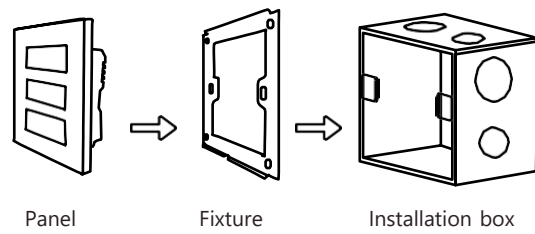

Bus Voltage :	21-30V DC
Bus current :	≤12mA
Bus power :	≤360mW
Size :	86*86mm or 86*93mm