

# Color Knob Temperature Control

KNX LCD Knob panel with exquisite aluminum alloy frame could freely control fresh air, floor heating, AC three in one function. It also displays temperature setting, wind speed setting, molded setting and air quality.

- Function feature: knob control, sensor touch, color UI display
- Material: aluminum alloy wire-drawing / matt panel
- Color: Volcanic Gray, Black, Champagne Gold (support customization)
- Certificate: CE, KNX

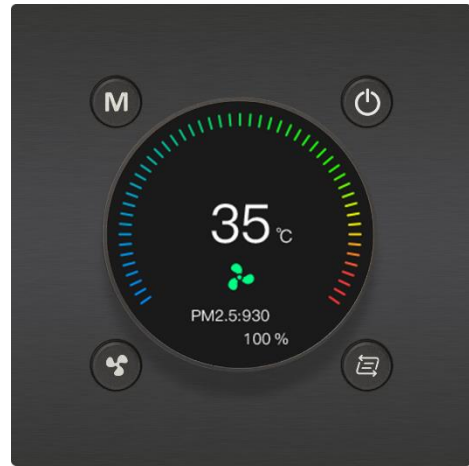

PC-TC86.01

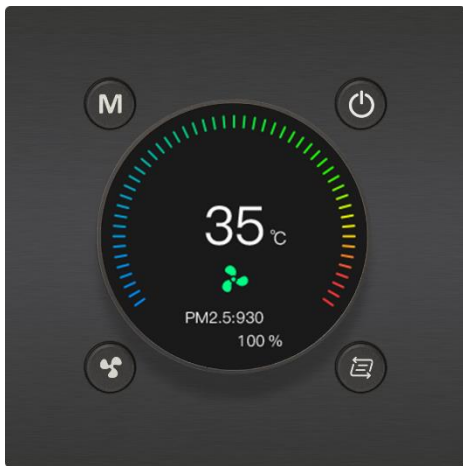

PC-TC86.01

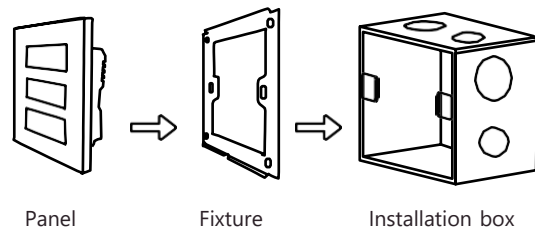

Auxiliary supply voltage :	24VDC
KNX supply voltage :	30VDC
Bus current :	≤12mA
Bus power :	≤360mW
Size :	86*86mm or 86*93mm