



Manufacturer of the
World's finest fire
safety products.



**Hand Held
Fire Extinguishers**



**Wheeled
Fire Extinguishers**



**Foam Concentrates
and Hardware**



**Restaurant Fire
Suppression Systems**

**PRODUCT
CATALOG**

heritage



Hand Held, Wheeled &
Specialty Fire
Extinguishers.
Foam Concentrates
& Hardware.
Restaurant Fire
Suppression Systems





AMERICAN MADE SINCE 1968

For over four decades Buckeye Fire Equipment has been an international leader in the development and manufacture of reliable fire protection products.

A privately owned and operated company with its headquarters near Charlotte, NC, Buckeye Fire Equipment has earned an excellent reputation for quality, reliability and value within the commercial and industrial fire protection industry.

We offer a complete line of hand-held and wheeled fire extinguishers, extinguishing agents, fire suppressing foam concentrates & hardware and pre-engineered kitchen suppression systems.

To ensure our distributors and customers get the highest quality

fire protection equipment, all of our products undergo rigorous testing, both in-house and by third party testing organizations such as Underwriters Laboratories, Factory Mutual, ASME and the U.S. Government.

We are committed to helpful and responsive customer service and knowledgeable and dependable technical support. This commitment has earned Buckeye Fire Equipment the coveted ISO 9001-2000 Quality Certification.

Contact us for more information about the wide selection of Buckeye Fire Equipment Company products and services. We have trained personnel who are ready to assist you with your fire protection needs.

Hand Held Fire Extinguishers | Page 5-13
Automatic Fire Extinguishers | Page 14-15
Wheeled Fire Extinguishers | Page 16-20
Restaurant Fire Suppression Systems | Page 21-22
Foam Concentrates & Hardware | Page 23 - 24
Mounting Hardware | Page 25 - 26

guide

To provide the best protection of life and property from fire, it is critical that the proper extinguisher selection be made. The classification and rating of an extinguisher are vital pieces of information for making this selection.



PORTABLE FIRE EXTINGUISHER SELECTION GUIDE

The National Fire Protection Association (NFPA) has established the requirements for the **number, size, placement, performance** and **maintenance** of portable fire extinguishers. These requirements are contained in NFPA 10, "Standard for Portable Fire Extinguishers".

Within this standard it is stated that the selection of fire extinguishers for a given situation is determined by the following:

- the character and size of the fires anticipated to be encountered.
- the construction and occupancy of the property to be protected.
- the ambient temperature of the area where the extinguisher will be located.
- other factors that may dictate the selection of a particular type of extinguisher.

FIRE CLASSIFICATIONS

Generally fire extinguishers are selected based on the hazard(s) they are intended to protect. Classifications have been established to categorize these hazards as follows:



Class A: Fires involving ordinary combustible materials such as wood, cloth, paper, rubber and many plastics.



Class B: Fires involving flammable liquids, combustible liquids, petroleum grease, tars, oils, oil based paints, solvents, lacquers, alcohols, and flammable liquids.



Class C: Fires that involve energized electrical equipment.



Class D: Fires involving combustible metals such as magnesium, sodium, potassium and sodium potassium alloys.



Class K: Fires involving combustible cooking media such as vegetable oils, animal oils and fats.

needs



This ABC extinguisher is rated 3-A:40-B:C. The 3 and the 40 indicate the extinguishing potential for Class A and Class B fires respectively. The C indicates that the agent will not conduct electricity. This unit exceeds the minimum rating for LOW and MODERATE occupancy requirements.

FIRE RATINGS

Along with the classification, the numerical rating of an extinguisher is an important factor in the proper selection of an extinguisher. The rating is a measure of the extinguishing potential of the fire extinguisher and is developed on the basis of comparative fire tests.

Only **Class A** and **Class B** classifications carry numerical ratings. Basically the higher the number associated with the classification letter, the larger the fire the extinguisher has the potential to extinguish.

Class A fire tests involve two types of fire, a wood crib fire test and a wood panel fire test. For example to achieve a 3-A rating an extinguisher must successfully extinguish a burning wood crib measuring 29" x 29" x 27" and a wood panel measuring 12' x 12'.

Class B fire tests involve square trays containing flammable liquid. For example to achieve a 40-B rating an extinguisher must successfully extinguish a burning pan measuring 100 sq. ft.

There are no numerical ratings associated with Class C, D or K.

For Class C, the electrical nonconducting characteristics of the agent are verified, not its extinguishing potential.

For Class D, only the amount of agent and application method needed to control a metal fire of a certain size and type is tested.

For Class K, the extinguisher must extinguish 80 lbs. of burning cooking oil in a commercial deep fat fryer and cause no splashing of flaming oil outside the fryer.

PLACEMENT/ACCESSIBILITY OF EXTINGUISHER

FIRE CLASSIFICATION	CLASS A	CLASS B	CLASS C	CLASS D	CLASS K
MAXIMUM TRAVEL DISTANCE TO FIRE EXTINGUISHER	75 FEET Maximum area that one extinguisher can protect and meet the 75 ft. rule = 11,250 sq. ft..	50 FEET Maximum area that one extinguisher can protect and meet the 50 ft. rule = 5,000 sq. ft..	In accordance with the Class A or B hazard it is protecting	75 FEET	30 FEET Maximum area that one extinguisher can protect and meet the 30 ft. rule = 1,800 sq. ft..

OCCUPANCY HAZARDS

The NFPA classifies occupancies as either LOW, MODERATE OR HIGH HAZARD.

Low hazard occupancies are locations where the total amount of Class A combustible materials and Class B flammables, including furnishings, decorations, and contents, is of minor quantity. This can include some buildings or rooms occupied as **offices, classrooms, churches, assembly halls, guest room areas of hotels/motels.**

Moderate hazard occupancies are locations where the total amount of Class A combustibles and Class B flammables are present in greater amounts than expected under low hazard occupancies. These occupancies could consist of **dining areas, mercantile shops and allied storage, light manufacturing, research operations, auto showrooms, parking garages and workshops.**

High hazard occupancies are locations where the total amount of Class A combustibles and Class B flammables present, in storage, production, use, finished product,

or combination thereof, is over and above those expected in occupancies classed as moderate hazard. These occupancies could consist of **woodworking; vehicle repair; aircraft and boat servicing; cooking areas; individual product display showrooms; product convention center displays; and storage and manufacturing processes such as painting, dipping, and coating, including flammable liquid handling.**

Occupancies	Min. Rating	Unit of A
Low	2-A:5/10-B	3000
Moderate	2-A:10/20-B	1500
High	4-A:40/80-B	1000

Note: If the lower B rating is installed then the maximum travel distance to the extinguisher is reduced from 50 to 30 feet.

To determine the overall A rating necessary for protection of an occupancy, divide the total sq. ft. by the Unit of A in the above table.

For example if a low occupancy building has a total sq. ft. of 30,000. Divide 30,000 x 3000 (Unit of A) = 10.

Therefore in this example the building would require a minimum of 5 x 2-A rated extinguishers.

quality

ABC DRY CHEMICAL
STANDARD DRY CHEMICAL
PURPLE K DRY CHEMICAL
HALOTRON
CARBON DIOXIDE
WATER & WATER MIST
WET CHEMICAL
DRY POWDER (CLASS D)

HAND HELD FIRE EXTINGUISHERS

Our goal is to provide our customers with quality fire extinguishers at a great value. In pursuit of this, we manufacture all our products in the U.S.A. We mill and blend our own dry chemical agents, machine the component parts, assemble and then test our units to the highest quality standards.

KEY FEATURES

- Manufactured to meet UL/ULC rigorous standards for commercial hazard protection and backed by our manufacturer's warranty.
- Rechargeable.
- Anodized metal & brass valve assemblies for superior strength and corrosion resistance.
- Industrial grade steel & aluminum cylinders with polyester powder coating designed to withstand harsh environments & rough usage.
- Metal pull pins, vehicle brackets and wall hooks for extended unit service life.
- The extinguisher nameplate incorporates trilingual operating and maintenance instructions in English, Spanish and French.
- Color-coded gauges show operating status at-a-glance.
- Extinguishers have model and serial number bar coding for easy and accurate maintenance history.



*Third Party
Approvals For
Peace Of Mind*



USCG
Approved

DOT
Compliant

coverage

ABC DRY CHEMICAL



ABC Dry Chemical is a multipurpose extinguishing agent that is suitable for use on Class A, Class B and Class C fires.

TYPICAL USES: For public areas such as offices, classrooms, churches, parking garages, and hotel/motel assembly halls and guest areas. For businesses such as retail stores, light manufacturing facilities, research facilities, auto dealerships, vehicle/aircraft/marine service centers, and manufacturing processes such as painting, dipping, and coating.

Not suitable for use on fires involving cooking oil and grease. Not recommended for use on sensitive electronic equipment or aircraft structure.



LISTED

USCG
ApprovedDOT
Compliant

Where available Canadian Part Numbers are shown in parenthesis. V/B = Vehicle Bracket Included

Model	2.5 ABC V/B	5 ABC	5 ABC V/B	10 TALL ABC	10S ABC	20S ABC	30S ABC
Pt. # ALUM. VALVE	13315 (10095)	10914 (10990)	25614 (25690)	11340 (11390)	11310	12120 (12195)	N/A
Pt. # BRASS VALVE	N/A	10915	25615	11341 (11349)	N/A	12121 (12196)	12905
AGENT CAPACITY	2.5 lb. (1.13 kg)	5 lb. (2.27 kg)	5 lb. (2.27 kg)	10 lb. (4.54 kg)	10 lb. (4.54 kg)	20 lb. (9.07 kg)	30 lb. (13.6 kg)
UL RATING	1-A:10-B:C	3-A:40-B:C	3-A:40-B:C	4-A:80-B:C	4-A:60-B:C	20-A:120-B:C	20-A:160-B:C
DISCHARGE TIME	9 sec	14 sec	14 sec	22 sec	18 sec	27 sec	32 sec
RANGE (FT/M)	9-15 / 2.7-4.6	12-18 / 3.7-5.5	12-18 / 3.7-5.5	15-21 / 4.6-6.4	15-21 / 4.6-6.4	15-21 / 4.6-6.4	25-30 / 7.6-9.1
OPERATING PRESSURE	100 psi (689 kPa)	195 psi (1344 kPa)	195 psi (1344 kPa)	195 psi (1344 kPa)	195 psi (1344 kPa)	195 psi (1344 kPa)	195 psi (1344 kPa)
BRACKET	Vehicle	Wall	Vehicle	Wall	Wall	Wall	Wall
USCG APPROVAL	Type B:C Size I	Type A Size II Type B:C Size I	Type A Size II Type B:C Size I	Type A Size II Type B:C Size II	Type A Size II Type B:C Size II	Type A Size II Type B:C Size III	Type A Size II Type B:C Size IV
SHIP WEIGHT	5.5 lb. (2.5 kg)	10 lb. (4.5 kg)	10.25 lb. (4.7 kg)	18.25 lb. (8.3 kg)	18.75 lb. (8.6 kg)	33.5 lb. (15.2 kg)	52.25 lb. (23.7 kg)
UNIT HEIGHT	14.75 in (37.5 cm)	16.375 in (41.6 cm)	16.375 in (41.6 cm)	21 in (53.3 cm)	16.75 in (42.5 cm)	21.25 in (53.8 cm)	27.375 in (69.4 cm)
UNIT WIDTH	4.875 in (12.4 cm)	7.25 in (18.4 cm)	7.25 in (18.4 cm)	7.75 in (19.7 cm)	8.25 in (21 cm)	8.75 in (22.2 cm)	8.75 in (22.2 cm)
UNIT DIAMETER	3.375 in (8.6 cm)	4.25 in (10.8 cm)	4.25 in (10.8 cm)	5.125 in (13 cm)	6 in (15.2 cm)	7.5 in (19.1 cm)	7.5 in (19.1 cm)

choice

STANDARD DRY CHEMICAL



Standard (BC) Dry Chemical is a sodium bicarbonate based extinguishing agent that is suitable for use on Class B and Class C fires.

TYPICAL USES: For flammable liquid hazards in public areas such as offices, classrooms, churches, parking garages, and hotel/motel assembly halls and guest areas. For flammable liquid hazards in businesses such as retail stores, light manufacturing facilities, research facilities, auto dealerships, vehicle/aircraft/marine service centers, and manufacturing processes such as painting, dipping, and coating.

Not suitable for use on fires involving cooking oil and grease. Not recommended for use on sensitive electronic equipment.



LISTED

USCG
ApprovedDOT
Compliant

Canadian Part Numbers are shown in parenthesis. V/B = Vehicle Bracket Included

Model	2.5 STD V/B	5.5 STD	5.5 STD V/B	10 STD	20S STD
Pt. # ALUM. VALVE	13415 (13490)	11014 (11090)	13514 (13581)	11840 (11890)	12220 (12290)
AGENT CAPACITY	2.5 lb. (1.13 kg)	5.5 lb. (2.5 kg)	5.5 lb. (2.5 kg)	10 lb. (4.54 kg)	20 lb. (9.07 kg)
UL RATING	10-B:C	40-B:C	40-B:C	40-B:C	120-B:C
DISCHARGE TIME	9 sec	14 sec	14 sec	14 sec	28 sec
RANGE (FT/M)	9-15 / 2.7-4.6	12-18 / 3.7-5.5	12-18 / 3.7-5.5	15-21 / 4.6-6.4	15-21 / 4.6-6.4
OPERATING PRESSURE	100 psi (689 kPa)	195 psi (1344 kPa)	195 psi (1344 kPa)	195 psi (1344 kPa)	195 psi (1344 kPa)
BRACKET	Vehicle	Wall	Vehicle	Wall	Wall
USCG APPROVAL	Type B:C Size I	Type B:C Size I	Type B:C Size I	Type B:C Size II	Type B:C Size III
SHIP WEIGHT	5.5 lb. (2.5 kg)	10.5 lb. (4.8 kg)	10.75 lb. (4.9 kg)	18.25 lb. (8.3 kg)	33.5 lb. (15.2 kg)
UNIT HEIGHT	14.75 in (37.5 cm)	16.375 in (41.6 cm)	16.375 in (41.6 cm)	21 in (53.3 cm)	21.25 in (53.8 cm)
UNIT WIDTH	4.875 in (12.4 cm)	7.25 in (18.4 cm)	7.25 in (18.4 cm)	7.75 in (19.7 cm)	8.75 in (22.2 cm)
UNIT DIAMETER	3.375 in (8.6 cm)	4.25 in (10.8 cm)	4.25 in (10.8 cm)	5.125 in (13 cm)	7.5 in (19.1 cm)

performance

PURPLE K DRY CHEMICAL



Purple K Dry Chemical is a high performance extinguishing agent most effective for dealing with flammable liquid fires. Purple K is suitable for use on Class B and Class C fires.

TYPICAL USES: For flammable liquid hazards in public areas such as offices, classrooms, churches, parking garages, and hotel/motel assembly halls and guest areas. For flammable liquid hazards in businesses such as retail stores, light manufacturing facilities, research facilities, auto dealerships, vehicle/aircraft/marine service centers, and manufacturing processes such as painting, dipping, and coating.

Not suitable for use on fires involving cooking oil and grease. Not recommended for use on sensitive electronic equipment.



LISTED

USCG
ApprovedDOT
Compliant

Where available Canadian Part Numbers are shown in parenthesis. V/B = Vehicle Bracket Included

Model	2.5 PK V/B	5 PK	5 PK V/B	10 PK	20S PK	30S PK
Pt. # ALUM. VALVE	13515 (13590)	11214 (11290)	25914	11740 (11790)	12620 (12690)	N/A
Pt. # BRASS VALVE	N/A	N/A	N/A	N/A	12621	12805
AGENT CAPACITY	2.5 lb. (1.13 kg)	5 lb. (2.27 kg)	5 lb. (2.27 kg)	10 lb. (4.54 kg)	20 lb. (9.07 kg)	30 lb. (13.6 kg)
UL RATING	10-B:C	20-B:C	20-B:C	80-B:C	120-B:C	160-B:C
DISCHARGE TIME	9 sec	9 sec	9 sec	22 sec	27 sec	32 sec
RANGE (FT/M)	9-15 / 2.7-4.6	12-18 / 3.7-5.5	12-18 / 3.7-5.5	15-21 / 4.6-6.4	15-21 / 4.6-6.4	25-30 / 7.6-9.1
OPERATING PRESSURE	100 psi (689 kPa)	195 psi (1344 kPa)	195 psi (1344 kPa)	195 psi (1344 kPa)	195 psi (1344 kPa)	195 psi (1344 kPa)
BRACKET	Vehicle	Wall	Vehicle	Wall	Wall	Wall
USCG APPROVAL	Type B:C Size I	Type B:C Size I	Type B:C Size I	Type B:C Size II	Type B:C Size III	Type B:C Size IV
SHIP WEIGHT	5.5 lb. (2.5 kg)	10 lb. (4.5 kg)	10.25 lb. (4.7 kg)	18.25 lb. (8.3 kg)	33.5 lb. (15.2 kg)	52.25 lb. (23.7 kg)
UNIT HEIGHT	14.75 in (37.5 cm)	16.375 in (41.6 cm)	16.375 in (41.6 cm)	21 in (53.3 cm)	21.25 in (53.8 cm)	27.375 in (69.4 cm)
UNIT WIDTH	4.875 in (12.4 cm)	7.25 in (18.4 cm)	7.25 in (18.4 cm)	7.75 in (19.7 cm)	8.75 in (21 cm)	8.75 in (22.2 cm)
UNIT DIAMETER	3.375 in (8.6 cm)	4.25 in (10.8 cm)	4.25 in (10.8 cm)	5.125 in (13 cm)	7.5 in (19.1 cm)	7.5 in (19.1 cm)

safe

HALOTRON



Halotron is a clean, non conductive gaseous agent that is an excellent replacement for Halon 1211 extinguishers. Halotron is suitable for use on Class A, Class B and Class C fires.

TYPICAL USES: For protecting sensitive electronic equipment in offices, classrooms, churches, parking garages, and hotel/motel assembly halls and guest areas. For protecting sensitive electronic equipment in businesses such as retail stores, light manufacturing facilities, research facilities, auto dealerships, vehicle/aircraft/marine service centers, and manufacturing processes such as painting, dipping, and coating.

Not suitable for use on fires involving cooking oil and grease. Recommended for use on sensitive electronic equipment.



LISTED

USCG
ApprovedDOT
Compliant

Where available Canadian Part Numbers are shown in parenthesis. V/B = Vehicle Bracket Included. F = Fixed Nozzle. H = Hose.

Model	2.5F	2.5F V/B	2.5H	2.5H V/B	5F	5F V/B	5H	5H V/B	11	15
Pt. # ALUM. VALVE	70258 (70280)	70251 (70295)	70259	70256	70510 (70580)	70550 (70590)	75550	75555	71100 (71180)	71550 (71580)
Pt. # BRASS VALVE	N/A	N/A	N/A	N/A	70511	70551	75551	75556	71101	71551
AGENT CAPACITY	2.5 lb. (1.13 kg)	2.5 lb. (1.13 kg)	2.5 lb. (1.13 kg)	2.5 lb. (1.13 kg)	5 lb. (2.27 kg)	5 lb. (2.27 kg)	5.5 lb. (2.49 kg)	5.5 lb. (2.49 kg)	11 lb. (5 kg)	15.5 lb. (7.03 kg)
UL RATING	2-B:C	2-B:C	2-B:C	2-B:C	5-B:C	5-B:C	5-B:C	5-B:C	1-A:10-B:C	2-A:10-B:C
DISCHARGE TIME	9 sec	9 sec	9 sec	9 sec	9 sec	9 sec	9 sec	9 sec	9 sec	13 sec
RANGE (FT/M)	6-10 / 1.8-3	6-10 / 1.8-3	6-10 / 1.8-3	6-10 / 1.8-3	9-15 / 2.7-4.5	9-15 / 2.7-4.5	9-15 / 2.7-4.5	9-15 / 2.7-4.5	9-15 / 2.7-4.5	12-18 / 3.7-5.5
OPERATING PRESSURE	100 psi (689 kPa)	100 psi (689 kPa)	100 psi (689 kPa)	100 psi (689 kPa)	100 psi (689 kPa)	100 psi (689 kPa)	100 psi (689 kPa)	100 psi (689 kPa)	100 psi (689 kPa)	125 psi (862 kPa)
BRACKET	Wall	Vehicle	Wall	Vehicle	Wall	Vehicle	Wall	Vehicle	Wall	Wall
USCG APPROVAL	N/A	N/A	N/A	N/A	N/A	Type B:C Size I	N/A	Type B:C Size I	Type B:C Size I	Type B:C Size II
SHIP WEIGHT	5.25 lb. (2.4 kg)	5.5 lb. (2.49 kg)	5.5 lb. (2.49 kg)	5.75 lb. (2.6 kg)	9.25 lb. (4.2 kg)	9.5 lb. (4.3 kg)	10.0 lb. (4.5 kg)	10.25 lb. (4.7 kg)	21.25 lb. (9.6 kg)	25.75 lb. (11.75 kg)
UNIT HEIGHT	13.375 in (34 cm)	13.375 in (34 cm)	13.375 in (34 cm)	13.375 in (34 cm)	16.375 in (41.6 cm)	16.375 in (41.6 cm)	16.375 in (41.6 cm)	16.375 in (41.6 cm)	17.5 in (44.5 cm)	17.5 in (44.5 cm)
UNIT WIDTH	5.625 in (14.3 cm)	5.625 in (14.3 cm)	6.75 in (17.1 cm)	6.75 in (17.1 cm)	6.5 in (16.5 cm)	7.25 in (18.5 cm)	6.5 in (16.5 cm)	7.25 in (18.5 cm)	8.625 in (21.9 cm)	8.625 in (21.9 cm)
UNIT DIAMETER	3.375 in (8.6 cm)	3.375 in (8.6 cm)	3.375 in (8.6 cm)	4.25 in (10.8 cm)	4.25 in (10.8 cm)	4.25 in (10.8 cm)	4.25 in (10.8 cm)	4.25 in (10.8 cm)	7 in (17.8 cm)	7 in (17.8 cm)

CARBON DIOXIDE



Carbon Dioxide is the trusted non-conductive clean agent and is most effective for dealing with electronic equipment fires. CO₂ is suitable for use on Class B and Class C fires.

TYPICAL USES: For protecting sensitive electronic equipment in offices, classrooms, churches, parking garages, and hotel/motel assembly halls and guest areas. For protecting sensitive electronic equipment in businesses such as retail stores, light manufacturing facilities, research facilities, auto dealerships, vehicle/aircraft/marine service centers, and manufacturing processes such as painting, dipping, and coating.

Not suitable for use on fires involving cooking oil and grease. Recommended for use on sensitive electronic equipment.



Canadian Part Numbers are shown in parenthesis.

Model	5CD	10CD	15CD	20CD
Pt. #	45100 (45191)	45600 (45691)	46100 (46191)	46600 (46691)
AGENT CAPACITY	5 lb. (2.27 kg)	10 lb. (4.54 kg)	15 lb. (6.8 kg)	20 lb. (9.07 kg)
UL RATING	5-B:C	10-B:C	10-B:C	10-B:C
DISCHARGE TIME	9 sec	9 sec	15 sec	20 sec
RANGE (FT/M)	4-8 / 1.2-2.4	4-8 / 1.2-2.4	4-8 / 1.2-2.4	4-8 / 1.2-2.4
BRACKET	Wall	Wall	Wall	Wall
USCG APPROVAL	Type B:C Size I	Type B:C Size I	Type B:C Size II	Type B:C Size II
SHIP WEIGHT	13.75 lb. (6.3 kg)	27.75 lb. (12.6 kg)	37.75 lb. (17.1 kg)	49 lb. (22.2 kg)
UNIT HEIGHT	17.375 in (44.1 cm)	19.75 in (50.2 cm)	26.375 in (67 cm)	26.875 in (68.2 cm)
UNIT WIDTH	8.25 in (21 cm)	12 in (30.5 cm)	12 in (30.5 cm)	13 in (33 cm)
UNIT DIAMETER	5.25 in (13.3 cm)	6.89 in (17.5 cm)	6.89 in (17.5 cm)	8 in (20.3 cm)



LISTED

USCG
ApprovedDOT
Compliant

cooling

WATER AND WATER MIST



Our Water and Water Mist units provide effective and economical protection for common combustible fires.

The Water Mist unit uses deionized water and incorporates a unique spray nozzle. These features make it safe for use on energized electrical equipment. Water Mist is considered to be the #1 extinguisher choice for libraries and hospitals.

Water & Water Mist are suitable for use on Class A fires. Water Mist is suitable for use on Class C fires.

TYPICAL USES: For common combustible fires in offices, classrooms, churches, parking garages, and hotel/motel assembly halls and guest areas. For common combustible fires in businesses such as retail stores, light manufacturing facilities, research facilities, auto dealerships, vehicle/aircraft/marine service centers, and manufacturing processes such as painting, dipping, and coating.



Model	500	WM250
PART #	50000	51000
CYLINDER/VALVE MATERIAL	Stainless Steel/Plated Brass	Stainless Steel/Plated Brass
AGENT CAPACITY	2.5 gallons (9.6 liters)	2.5 gallons (9.6 liters)
UL RATING	2-A	2-A:C
DISCHARGE TIME	50 sec	73 sec
OPERATING PRESSURE	100 psi (689 kPa)	100 psi (689 kPa)
BRACKET	Wall	Wall
USCG APPROVAL	N/A	N/A
SHIP WEIGHT	Empty: 7.75 lb. (3.5 kg)	Full: 29.5 lb. (13.4 kg)
UNIT HEIGHT	24.5 in (62.2 cm)	28 in (78.1 cm)
UNIT WIDTH (INCL HOSE)	9 in (22.9 cm)	14 in (35.6 cm)
UNIT DIAMETER	7 in (17.8 cm)	7 in (17.8 cm)



sealing

WET CHEMICAL - CLASS K



Our Wet Chemical units contain a blend of Potassium Acetate and Potassium Citrate that is extremely effective in suppressing high temperature fires involving cooking oils and grease.

The units incorporate a spray nozzle that ensures the agent is applied gently to the burning oil thus preventing splashing. It's unique cooling properties delivers exceptional heat absorption ensuring the fire remains out.

Wet Chemical is suitable for use on Class A and K fires.

TYPICAL USES: For protecting cooking oil and grease fires in commercial kitchens. This extinguisher is designed to complement existing pre-engineered hood systems.



Used in conjunction with Kitchen Fire Suppression System. Page 21 & 22.



Canadian Part Numbers are shown in parenthesis.

Model	WC-6 LITER	WC-2.5 GALLON
PART #	50006 (50006ULC)	
CYLINDER/VALVE MATERIAL	Stainless Steel/Plated Brass	Stainless Steel/Plated Brass
AGENT CAPACITY	6 Liters (1.59 gallons)	
UL RATING	1-A:K	1-A:K
DISCHARGE TIME	54 sec	
BRACKET	Wall	Wall
USCG APPROVAL	N/A	N/A
SHIP WEIGHT	22 lb. (10 kg)	
UNIT HEIGHT	19.25 in (48.9 cm)	
UNIT WIDTH	9 in (22.9 cm)	9 in (22.9 cm)
UNIT DIAMETER	7 in (17.8 cm)	7 in (17.8 cm)



specialty

COMBUSTIBLE METALS - CLASS D



Specially designed for use on combustible metal fires, this extinguisher features a discharge assembly that keeps the operator at a safe distance while providing accurate application of the agent on the fire.

From the heat of the fire, the sodium chloride based agent forms a crust to exclude air from the burning material. Suitable for use Class D fires such as those involving magnesium, sodium, potassium and sodium-potassium alloys.

TYPICAL USES: There is data showing that zirconium, uranium, titanium, and powdered aluminum fires can be controlled and extinguished with this unique extinguisher.



Model	30D
PART #	52000
AGENT CAPACITY	30 lb. (13.6 kg)
FM RATING	D
DISCHARGE TIME	28 sec
OPERATING PRESSURE	195 psi (1344 kPa)
BRACKET	Wall
USCG APPROVAL	N/A
SHIP WEIGHT	55 lb. (24.95 kg)
UNIT HEIGHT	33 in (83.8 cm)
UNIT WIDTH (INCL HOSE)	16 in (40.6 cm)
UNIT DIAMETER	8 in (20.3 cm)



automatic

MINI-GUARD VERTICAL MOUNT AUTOMATIC SPOT PROTECTION



Designed to supply supplementary fire protection for some local and total flood applications. MINI-GUARD is designed, tested and constructed to our portable extinguisher standards.

MINI GUARD units are available in horizontal and vertical mounts and can be charged with Multipurpose Dry Chemical or Halotron. Suitable for use on Class A, Class B and Class C fires.

TYPICAL USES: The protection of specialized equipment used in business or manufacturing processes or for specific fire risk areas such as flammable liquid storage rooms (dry chemical) and small data protection rooms (Halotron).

Model	MULTIPURPOSE (ABC) DRY CHEMICAL				HALOTRON	
AGENT TYPE	ABC Dry Chemical	ABC Dry Chemical	ABC Dry Chemical	ABC Dry Chemical	Halotron	Halotron
PART #	80250	80501	81001	82001	87100	87200
AGENT CAPACITY	2.5 lb. (1.13 kg)	5 lb. (2.3 kg)	10 lb. (4.5 kg)	20 lb. (9.1 kg)	18 lb. (8.2 kg)	25 lb. (11.3 kg)
SHIP WEIGHT	4 lb. (1.8 kg)	11 lb. (5 kg)	19 lb. (8.6 kg)	36 lb. (16.3 kg)	29 lb. (13.2 kg)	42 lb. (19 kg)
OPERATING PRESSURE	100 psi (689 kPa)	100 psi (689 kPa)	195 psi (1344 kPa)	195 psi (1344 kPa)	100 psi (689 kPa)	100 psi (689 kPa)
UNIT LENGTH	15.25 in (38.7 cm)	17.25 in (43.8 cm)	17.625 in (44.8 cm)	21.875 in (55.6 cm)	17.875 in (45.4 cm)	21.875 in (55.6 cm)
UNIT DIAMETER	3.375 in (8.6 cm)	4.25 in (10.8 cm)	6 in (15.2 cm)	7.5 in (19.1 cm)	7 in (17.8 cm)	7.5 in (19.1 cm)
MAX TOTAL FLOOD VOLUME	120 cu. ft.	180 cu. ft.	1300 cu. ft.	2184 cu. ft.	500 cu. ft.	700 cu. ft.
MAX TOTAL FLOOD HEIGHT ABOVE HAZARD	7.5 ft.	7.5 ft.	13 ft.	14 ft.	8 ft.	10 ft.
LOCAL APPLICATION COVERAGE AREAS	4 ft. x 4 ft.	4 ft. x 6 ft.	10 ft. x 10 ft.	12 ft. x 13 ft.	4 ft. x 4 ft.	6 ft. x 6 ft.

MAXIMUM LOCAL APPLICATION - HEIGHT ABOVE HAZARD = 4 FEET FOR ALL MODELS

automatic

MINI-GUARD HORIZONTAL MOUNT

AUTOMATIC SPOT PROTECTION



Designed to supply supplementary fire protection for some local and total flood applications. MINI-GUARD is designed, tested and constructed to our portable extinguisher standards.

MINI GUARD units are available in horizontal and vertical mounts and can be charged with Multipurpose Dry Chemical or Halotron. Suitable for use on Class A, Class B and Class C fires.

TYPICAL USES: The protection of specialized equipment used in business or manufacturing processes or for specific fire risk areas such as flammable liquid storage rooms (dry chemical) and small data protection rooms (Halotron).

Model	MULTIPURPOSE (ABC) DRY CHEMICAL				HALOTRON	
AGENT TYPE	ABC Dry Chemical	ABC Dry Chemical	ABC Dry Chemical	ABC Dry Chemical	Halotron	Halotron
PART #	80251	80521	81021	82021	87105	87205
AGENT CAPACITY	2.5 lb. (1.13 kg)	5 lb. (2.3 kg)	10 lb. (4.5 kg)	20 lb. (9.1 kg)	18 lb. (8.2 kg)	25 lb. (11.3 kg)
SHIP WEIGHT	4 lb. (1.8 kg)	11 lb. (5 kg)	19 lb. (8.6 kg)	36 lb. (16.3 kg)	29 lb. (13.2 kg)	42 lb. (19 kg)
OPERATING PRESSURE	100 psi (689 kPa)	100 psi (689 kPa)	195 psi (1344 kPa)	195 psi (1344 kPa)	100 psi (689 kPa)	100 psi (689 kPa)
UNIT LENGTH	14.25 in (36.2 cm)	17.25 in (43.8 cm)	20.875 in (53 cm)	21.875 in (55.6 cm)	17.875 in (45.4 cm)	21.875 in (55.6 cm)
UNIT DIAMETER	3.375 in (8.6 cm)	4.25 in (10.8 cm)	5.125 in (13 cm)	7.5 in (19.1 cm)	7 in (17.8 cm)	7.5 in (19.1 cm)
MAX TOTAL FLOOD VOLUME	120 cu. ft.	180 cu. ft.	1300 cu. ft.	2184 cu. ft.	500 cu. ft.	700 cu. ft.
MAX TOTAL FLOOD HEIGHT ABOVE HAZARD	7.5 ft.	7.5 ft.	13 ft.	14 ft.	8 ft.	10 ft.
LOCAL APPLICATION COVERAGE AREAS	4 ft. x 4 ft.	4 ft. x 6 ft.	10 ft. x 10 ft.	12 ft. x 13 ft.	4 ft. x 4 ft.	6 ft. x 6 ft.
MOUNTING BRACKET	700287	700270	700226	700229	700228	700229

MAXIMUM LOCAL APPLICATION - HEIGHT ABOVE HAZARD = 4 FEET FOR ALL MODELS

WHEELED DRY CHEMICAL



Our comprehensive line of wheeled dry chemical extinguishers is available in three types and designed to meet the majority of large extinguishing needs.

Designed for one man operation these units are easily transportable through doorways and over rough terrain.

All models are rechargeable and meet relevant UL/ULC & DOT/TC requirements. Selected models have US Coast Guard Approvals.

Stationary models are also available.

TYPICAL USES: Offshore rigs, ship docks, refineries, chemical plants, aircraft ramps, remote construction sites, large laboratories, processing plants, storage and loading areas. Not for use on sensitive electronic equipment.

Dry chemical wheeled units are available for Class A, Class B and Class C fires.



WHEELED DRY CHEMICAL - PRODUCT SPECIFICATION

SP = STORED PRESSURE
 RG = REGULATED PRESSURE
 PT = PRESSURE TRANSFER

MODEL	TYPE	PART NUMBER	AGENT CAPACITY	UL RATING	DISCHARGE TIME	DISCHARGE RANGE	UNIT WEIGHT
A-50-SP	ABC Dry Chemical	30010	50 lb. (22.7 kg)	30-A:160-B:C	35 sec	25-35 ft. (7.6-10.7 m)	154 lb. (70 kg)
A-150-SP	ABC Dry Chemical	30110	125 lb. (56.7 kg)	40-A:240-B:C	47 sec	30-40 ft. (9.1-12.2 m)	300 lb. (136 kg)
A-150-RG	ABC Dry Chemical	31120	125 lb. (56.7 kg)	40-A:240-B:C	44 sec	30-40 ft. (9.1-12.2 m)	387 lb. (176 kg)
A-150-RG	ABC Dry Chemical	31140	125 lb. (56.7 kg)	40-A:240-B:C	44 sec	30-40 ft. (9.1-12.2 m)	422 lb. (191 kg)
A-150-RG	ABC Dry Chemical	31150	125 lb. (56.7 kg)	40-A:240-B:C	44 sec	30-40 ft. (9.1-12.2 m)	434 lb. (197 kg)
A-150-PT	ABC Dry Chemical	31110	125 lb. (56.7 kg)	40-A:240-B:C	43 sec	30-40 ft. (9.1-12.2 m)	325 lb. (147 kg)
A-350-RG	ABC Dry Chemical	32120	300 lb. (136 kg)	40-A:320-B:C	52 sec	30-40 ft. (9.1-12.2 m)	780 lb. (354 kg)
A-350-RG	ABC Dry Chemical	32140	300 lb. (136 kg)	40-A:320-B:C	52 sec	30-40 ft. (9.1-12.2 m)	806 lb. (366 kg)
A-350-PT	ABC Dry Chemical	32110	300 lb. (136 kg)	40-A:320-B:C	53 sec	30-40 ft. (9.1-12.2 m)	657 lb. (298 kg)
A-350-PT	ABC Dry Chemical	32130	300 lb. (136 kg)	40-A:320-B:C	53 sec	30-40 ft. (9.1-12.2 m)	683 lb. (310 kg)
S-150-RG	Standard Dry Chemical	31220	150 lb. (68 kg)	240-B:C	48 sec	30-40 ft. (9.1-12.2 m)	412 lb. (187 kg)
S-150-RG	Standard Dry Chemical	31240	150 lb. (68 kg)	240-B:C	48 sec	30-40 ft. (9.1-12.2 m)	447 lb. (203 kg)
S-150-RG	Standard Dry Chemical	31250	150 lb. (68 kg)	240-B:C	48 sec	30-40 ft. (9.1-12.2 m)	459 lb. (208 kg)
S-150-PT	Standard Dry Chemical	31210	150 lb. (68 kg)	240-B:C	43 sec	30-40 ft. (9.1-12.2 m)	350 lb. (159 kg)
S-350-RG	Standard Dry Chemical	32220	350 lb. (159 kg)	320-B:C	59 sec	30-40 ft. (9.1-12.2 m)	830 lb. (376 kg)
S-350-RG	Standard Dry Chemical	32240	350 lb. (159 kg)	320-B:C	59 sec	30-40 ft. (9.1-12.2 m)	856 lb. (388 kg)
S-350-PT	Standard Dry Chemical	32210	350 lb. (159 kg)	320-B:C	50 sec	30-40 ft. (9.1-12.2 m)	707 lb. (321 kg)
S-350-PT	Standard Dry Chemical	32230	350 lb. (159 kg)	320-B:C	50 sec	30-40 ft. (9.1-12.2 m)	733 lb. (333 kg)
K-50-SP	Purple K Dry Chemical	30030	50 lb. (22.7 kg)	160-B:C	34 sec	25-35 ft. (7.6-10.7 m)	154 lb. (70 kg)
K-150-SP	Purple K Dry Chemical	30310	125 lb. (56.7 kg)	320-B:C	54 sec	30-40 ft. (9.1-12.2 m)	300 lb. (136 kg)
K-150-RG	Purple K Dry Chemical	31320	125 lb. (56.7 kg)	320-B:C	55 sec	30-40 ft. (9.1-12.2 m)	387 lb. (176 kg)
K-150-RG	Purple K Dry Chemical	31340	125 lb. (56.7 kg)	320-B:C	55 sec	30-40 ft. (9.1-12.2 m)	422 lb. (191 kg)
K-150-RG	Purple K Dry Chemical	31350	125 lb. (56.7 kg)	320-B:C	55 sec	30-40 ft. (9.1-12.2 m)	434 lb. (197 kg)
K-150-PT	Purple K Dry Chemical	31310	125 lb. (56.7 kg)	320-B:C	54 sec	30-40 ft. (9.1-12.2 m)	325 lb. (147 kg)
K-350-RG	Purple K Dry Chemical	32320	300 lb. (136 kg)	320-B:C	57 sec	30-40 ft. (9.1-12.2 m)	780 lb. (354 kg)
K-350-RG	Purple K Dry Chemical	32340	300 lb. (136 kg)	320-B:C	57 sec	30-40 ft. (9.1-12.2 m)	806 lb. (366 kg)
K-350-PT	Purple K Dry Chemical	32310	300 lb. (136 kg)	320-B:C	62 sec	30-40 ft. (9.1-12.2 m)	657 lb. (298 kg)
K-350-PT	Purple K Dry Chemical	32330	300 lb. (136 kg)	320-B:C	62 sec	30-40 ft. (9.1-12.2 m)	683 lb. (310 kg)

US Coast Guard Approved Models - Part numbers 30010, 30110, 30030, 30310 & 31210

coverage



UNIT HEIGHT	UNIT WIDTH	UNIT DEPTH	HOSE LENGTH & DIAMETER	WHEEL TYPE	WHEEL DIAMETER
47 inches (119 cm)	24 inches (61 cm)	26.5 inches (67 cm)	25 ft. x .50 in. (7.6 m x 1.3 cm)	Rubber	12.3 in. x 3.5 in. (31.3 cm x 8.9 cm)
51 inches (128 cm)	26 inches (66 cm)	38 inches (96.5 cm)	50 ft. x .75 in. (15.2 m x 1.9 cm)	Rubber	16 in. x 4 in. (40.6 cm x 10.2 cm)
50 inches (127 cm)	24 inches (61 cm)	42 inches (105 cm)	50 ft. x .75 in. (15.2 m x 1.9 cm)	Rubber	16 in. x 4 in. (40.6 cm x 10.2 cm)
55 inches (139 cm)	32 inches (81.3 cm)	46 inches (117 cm)	50 ft. x .75 in. (15.2 m x 1.9 cm)	Steel	36 in. x 2.5 in. (91.4 cm x 6.4 cm)
55 inches (139 cm)	32 inches (81.3 cm)	46 inches (117 cm)	50 ft. x .75 in. (15.2 m x 1.9 cm)	Steel with rubber tread	36 in. x 2.5 in. (91.4 cm x 6.4 cm)
50 inches (127 cm)	24 inches (61 cm)	42 inches (105 cm)	50 ft. x .75 in. (15.2 m x 1.9 cm)	Rubber	16 in. x 4 in. (40.6 cm x 10.2 cm)
58 inches (147 cm)	36 inches (91.4 cm)	48 inches (122 cm)	50 ft. x 1 in. (15.2 m x 2.5 cm)	Steel	36 in. x 6 in. (91.4 cm x 15.2 cm)
58 inches (147 cm)	36 inches (91.4 cm)	48 inches (122 cm)	50 ft. x 1 in. (15.2 m x 2.5 cm)	Steel with rubber tread	36 in. x 6 in. (91.4 cm x 15.2 cm)
57 inches (147 cm)	36 inches (91.4 cm)	48 inches (122 cm)	50 ft. x 1 in. (15.2 m x 2.5 cm)	Steel	36 in. x 6 in. (91.4 cm x 15.2 cm)
57 inches (147 cm)	36 inches (91.4 cm)	48 inches (122 cm)	50 ft. x 1 in. (15.2 m x 2.5 cm)	Steel with rubber tread	36 in. x 6 in. (91.4 cm x 15.2 cm)
50 inches (127 cm)	24 inches (61 cm)	42 inches (105 cm)	50 ft. x .75 in. (15.2 m x 1.9 cm)	Rubber	16.4 in. x 4 in. (40.6 cm x 10.2 cm)
55 inches (139 cm)	32 inches (81.3 cm)	46 inches (117 cm)	50 ft. x .75 in. (15.2 m x 1.9 cm)	Steel	36 in. x 2.5 in. (91.4 cm x 6.4 cm)
55 inches (139 cm)	32 inches (81.3 cm)	46 inches (117 cm)	50 ft. x .75 in. (15.2 m x 1.9 cm)	Steel with rubber tread	36 in. x 2.5 in. (91.4 cm x 6.4 cm)
50 inches (127 cm)	24 inches (61 cm)	42 inches (105 cm)	50 ft. x .75 in. (15.2 m x 1.9 cm)	Rubber	16 in. x 4 in. (40.6 cm x 10.2 cm)
58 inches (147 cm)	36 inches (91.4 cm)	48 inches (122 cm)	50 ft. x 1 in. (15.2 m x 2.5 cm)	Steel	36 in. x 6 in. (91.4 cm x 15.2 cm)
58 inches (147 cm)	36 inches (91.4 cm)	48 inches (122 cm)	50 ft. x 1 in. (15.2 m x 2.5 cm)	Steel with rubber tread	36 in. x 6 in. (91.4 cm x 15.2 cm)
58 inches (147 cm)	36 inches (91.4 cm)	48 inches (122 cm)	50 ft. x 1 in. (15.2 m x 2.5 cm)	Steel	36 in. x 6 in. (91.4 cm x 15.2 cm)
58 inches (147 cm)	36 inches (91.4 cm)	48 inches (122 cm)	50 ft. x 1 in. (15.2 m x 2.5 cm)	Steel with rubber tread	36 in. x 6 in. (91.4 cm x 15.2 cm)
47 inches (119 cm)	24 inches (61 cm)	26.5 inches (67 cm)	25 ft. x .50 in. (7.6 m x 1.3 cm)	Rubber	12.3 in. x 3.5 in. (31.3 cm x 8.9 cm)
51 inches (128 cm)	26 inches (66 cm)	38 inches (96.5 cm)	50 ft. x .75 in. (15.2 m x 1.9 cm)	Rubber	16 in. x 4 in. (40.6 cm x 10.2 cm)
50 inches (127 cm)	24 inches (61 cm)	42 inches (105 cm)	50 ft. x .75 in. (15.2 m x 1.9 cm)	Rubber	16 in. x 4 in. (40.6 cm x 10.2 cm)
55 inches (139 cm)	32 inches (81.3 cm)	46 inches (117 cm)	50 ft. x .75 in. (15.2 m x 1.9 cm)	Steel	36 in. x 2.5 in. (91.4 cm x 6.4 cm)
55 inches (139 cm)	32 inches (81.3 cm)	46 inches (117 cm)	50 ft. x .75 in. (15.2 m x 1.9 cm)	Steel with rubber tread	36 in. x 2.5 in. (91.4 cm x 6.4 cm)
50 inches (127 cm)	24 inches (61 cm)	42 inches (105 cm)	50 ft. x .75 in. (15.2 m x 1.9 cm)	Rubber	16 in. x 4 in. (40.6 cm x 10.2 cm)
58 inches (147 cm)	36 inches (91.4 cm)	48 inches (122 cm)	50 ft. x 1 in. (15.2 m x 2.5 cm)	Steel	36 in. x 6 in. (91.4 cm x 15.2 cm)
58 inches (147 cm)	36 inches (91.4 cm)	48 inches (122 cm)	50 ft. x 1 in. (15.2 m x 2.5 cm)	Steel with rubber tread	36 in. x 6 in. (91.4 cm x 15.2 cm)
58 inches (147 cm)	36 inches (91.4 cm)	48 inches (122 cm)	50 ft. x 1 in. (15.2 m x 2.5 cm)	Steel	36 in. x 6 in. (91.4 cm x 15.2 cm)
58 inches (147 cm)	36 inches (91.4 cm)	48 inches (122 cm)	50 ft. x 1 in. (15.2 m x 2.5 cm)	Steel with rubber tread	36 in. x 6 in. (91.4 cm x 15.2 cm)

safe

WHEELED HALOTRON



Our residue-free wheeled Halotron units are designed to deliver exceptional performance whatever the environment. DOT approved cylinders, rugged frames and semi-pneumatic tires are key features of these UL approved units.

Halotron is suitable for use on Class A, Class B and Class C fires.

TYPICAL USES: For protecting sensitive electronic equipment in research facilities, vehicle/aircraft/marine service centers, and flight lines.



LISTED

DOT
Compliant

Model	W-65	W-150
PART #	76500	71500
AGENT CAPACITY	65 lb. (29.5 kg)	150 lb. (68 kg)
UL RATING	4-A:40-B:C	10-A:80-B:C
DISCHARGE TIME	17 sec	23 sec
RANGE	15-25 ft. (4.6-7.6 m)	23-36 ft. (7-10.7 m)
UNIT WEIGHT	252 lb. (114 kg)	396 lb. (180 kg)
UNIT HEIGHT x WIDTH x DEPTH	50" x 24" x 41.5" (127 x 61 x 105 cm)	62" x 24" x 41.5" (157.5 x 61 x 105 cm)
HOSE DIAMETER & LENGTH	.75 in x 25 ft. (1.9 cm x 7.6 cm)	1 in x 40 ft. (2.5 cm x 12.2 cm)



WHEELED CARBON DIOXIDE



Model C-100-SE



Model C-50-SE

Our residue-free wheeled Carbon Dioxide units are designed for one-man operation and are constructed with spun steel cylinders and plated brass valve assemblies. DOT approved cylinders, rugged frames and solid rubber tires are key features of these UL approved units.

Suitable for use on Class B and Class C fires.

TYPICAL USES: For protecting sensitive electronic equipment in refineries, shipboard, laboratories, construction sites, chemical plants and manufacturing facilities.



LISTED



USCG Approved



DOT Compliant

Model	C-50-SE	C-100-SE
PART #	35050	35100
AGENT CAPACITY	50 lb. (22.68 kg)	100 lb. (45.36 kg)
UL RATING	20-B:C	20-B:C
USCG APPROVAL	Type B:C Size IV	Type B:C Size V
DISCHARGE TIME	40 sec	80 sec
RANGE	15 ft. (4.6 m)	15 ft. (4.6 m)
UNIT WEIGHT	286 lb. (130 kg)	416 lb. (189 kg)
UNIT HEIGHT x WIDTH x DEPTH	60" x 31" x 21" (152.4 x 76.2 x 53.3 cm)	65" x 30" x 21" (165.1 x 76.2 x 53.3 cm)
HOSE DIAMETER & LENGTH	.75 in x 25 ft. (1.9 cm x 7.6 cm)	1 in x 40 ft. (2.5 cm x 12.2 cm)



simple

Tested & Listed to UL-300

KITCHEN MISTER - RESTAURANT FIRE SUPPRESSION SYSTEM

Open flames, red-hot cooking surfaces, and a heavily grease-laden environment combine to make the modern commercial kitchen a potentially dangerous fire hazard. Kitchen fires spread quickly and have proven to be very difficult to extinguish, making them the leading cause of structural fire damage in the United States.

Protecting the modern commercial kitchen from the ever-present danger of cooking oil and grease fires is the reason we developed The Buckeye *Kitchen Mister*™ System. Utilizing state of the art misting technology, the *Kitchen Mister* System has proven to be **the most effective fixed kitchen fire extinguishing system ever developed**, extinguishing potentially deadly kitchen fires fast, before they can spread.

That's why the *Kitchen Mister* System is **quickly becoming the preferred choice of fire protection professionals throughout the world.**

So before fire strikes...

**DON'T TAKE CHANCES -
DEMAND THE BEST!**

LISTINGS AND APPROVALS

- Listed to Underwriters Laboratories, Inc. Standard UL-300
- Listed to Underwriters Laboratories of Canada, Inc.
- Approved by the New York City Fire Department COA #5550
- Complies with NFPA-96 and NFPA-17A Standards



SYSTEM CYLINDERS

The models BFR-5, BFR-10, BFR-15 and BFR-20 cylinders are designated by flow point capacity (so the BFR-5 supports five (5) flow points) instead of the amount of agent they hold. Recharge is available in 5 and 10 flow point containers so there's never a chance of error.



BUCKEYE SHIELDED CABLE

The *Kitchen Mister* Shielded Cable Interface is used to connect Buckeye Shielded Cable to any standard ½ inch conduit connection device. The use of Buckeye Shielded Cable instead of conduit and corner pulleys for connecting the gas valve, remote pull station, and fusible link line to the Systems Releasing Module reduces installation time by up to 50%.

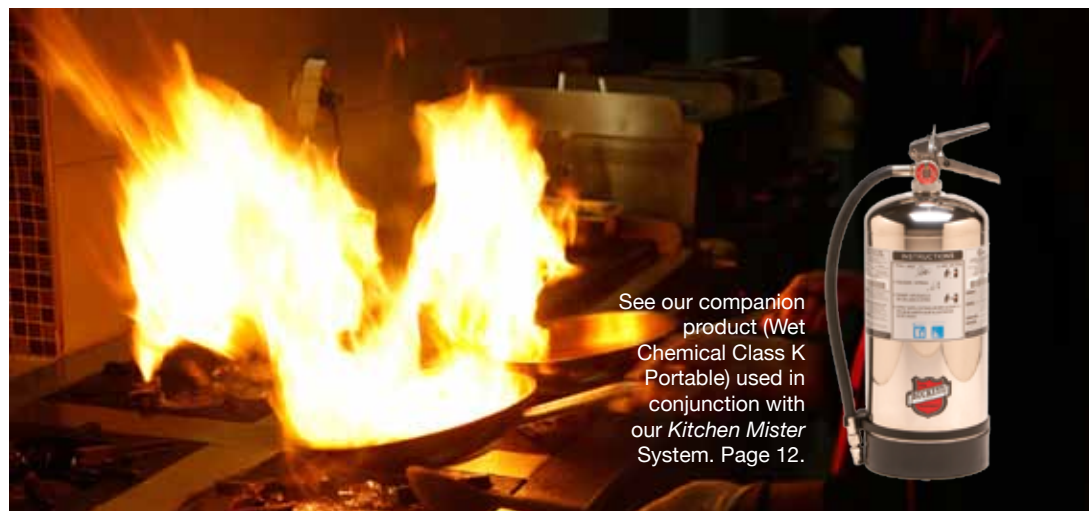

See our companion product (Wet Chemical Class K Portable) used in conjunction with our *Kitchen Mister* System. Page 12.

installation



Protect with the best & install for less.



DISCHARGE NOZZLES

All five (5) *Kitchen Mister* nozzles come equipped with a color identification band, red, blue, green, white and yellow. This allows for easy identification of the nozzle even when it's installed in difficult locations such as a duct or plenum area. The nozzle is also stamped with its model number.

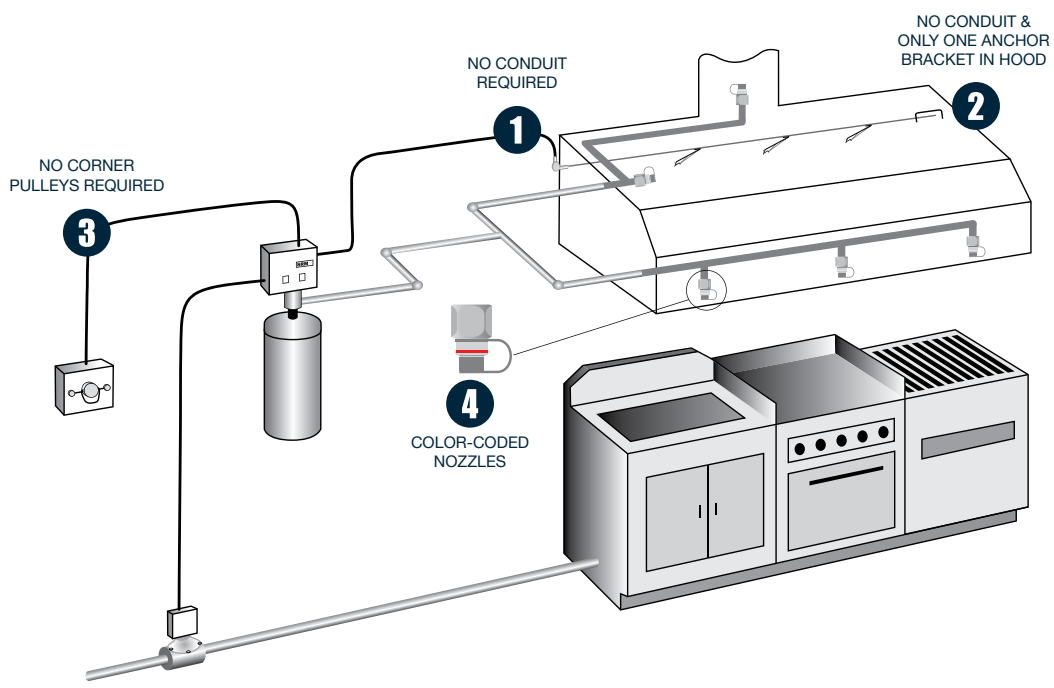

- 1 NO CONDUIT REQUIRED**
By using Buckeye Shielded Cable no conduit is required for system inputs/outputs. Buckeye Shielded Cable is Listed for the gas valve, detection line, and pull station.
- 2 NO CONDUIT & ONLY ONE ANCHOR BRACKET IN HOOD**
The *Kitchen Mister* System eliminates the need for conduit in the plenum and requires only one anchor bracket in the exhaust hood.
- 3 NO CORNER PULLEYS REQUIRED**
Buckeye Shielded Cable eliminates the need for corner pulleys, making installation easy and fast.
- 4 COLOR-CODED NOZZLES**
All *Kitchen Mister* nozzles have a unique color band for easy identification.

SIMPLICITY OF DESIGN

The constant changes and complicated requirements of most restaurant systems have made design and installation errors a concern of fire protection professionals globally.

The uncomplicated design of the *Kitchen Mister*™ System all but eliminates design and installation errors by combining common sense features and eliminating confusing design requirements.

FASTER INSTALLATIONS

By eliminating the labor-intensive task of installing conduit, corner pulleys, and detector brackets, the *Kitchen Mister* System dramatically reduces installation time.

The *Kitchen Mister* System is approved for use with Buckeye Shielded Cable instead of traditional conduit and corner pulleys for all system inputs and outputs. This, combined with the elimination of conduit and fusible link brackets in the plenum area, makes installing the *Kitchen Mister* System quick and easy.

DEALER FRIENDLY FEATURES

- Uncomplicated system design eliminates design and installation errors.
- Installation time significantly reduced.
- Innovative design eliminates conduit and corner pulleys.
- Advanced detection system installs quickly and easily.
- Color-coded nozzles for easy identification.
- Flexible piping requirements allow for unlimited system configurations.
- Best coverage in industry.
- Online & face to face training.

professional

FOAM CONCENTRATES AND EQUIPMENT



Maximum Protection for Every Application

Buckeye Fire Equipment manufactures a complete line of foam agents and hardware that when used in conjunction with one another make an unbeatable fire-fighting combination.

The selection includes bladder tanks, balanced pressure pump skid paks, eductors, monitors, foam chambers, foam makers, high expansion foam generators, foam carts and handline nozzles.

Many of the components can be customized to provide optimal protection for your unique situation. All foam system components are precision made from rugged materials to provide years of dependable service.

Buckeye's Foam Team Delivers

- The widest selection of Earth-Friendly fire fighting foam concentrates in the industry.
- Foam concentrates that independent tests have proven to be superior in quality and performance*.
- A wide selection of foam proportioning hardware and agents designed to maximize performance.
- Knowledgeable, professional in-house foam system design expertise to assist with your fire suppression equipment choice.

* Independent tests conducted by Chevron Petroleum and Dow Chemical. Report available on request.

suppression

Foam Concentrates



Foam Monitors



Hi-Ex Generators



Foam Bladder Tanks



Foam Concentrate Proportioners

Protecting the Environment

In addition to delivering superior reliability, Buckeye foam concentrates are all manufactured without EPA reportable components, thus reducing environmental impact.

By using only Earth-Friendly components, we relieve you of the major problems and burdensome paperwork that can result from the discharge of other foam concentrates. This environmental commitment in no way dilutes the fire-fighting effectiveness of Buckeye products.

Every foam concentrate we manufacture is subjected to rigorous quality control standards and tough testing to ensure complete reliability and maximum fire fighting performance.

Part Number	Foam Concentrate	Listing/Approvals
BFC-1.1	Platinum 1% AFFF	Underwriters Laboratories/FM Approved
BFC-3.1	Platinum 3% AFFF	Underwriters Laboratories/FM Approved
BFC-6.1	6% AFFF	Underwriters Laboratories
BFC-33.1	Platinum 3% x 3% AR-AFFF	Underwriters Laboratories/FM Approved
BFC-36.1	Platinum 3% x 6% AR-AFFF	Underwriters Laboratories
BFC-3LT	3% Low Temp AFFF	Underwriters Laboratories
BFC-36LT	3%- 6% Low Temp AR-AFFF	Buckeye Quality Assurance
BFC-CA.1	Platinum Class A	USDA Forest Service QPL
BFC-HX	2.2% High Expansion	Underwriters Laboratories
BFC-3MS	3% Mil Spec AFFF	U.S. Navy QPL(Mil-F-24385)/Underwriters Laboratories
BFC-VF	Virtual Foam	Buckeye Quality Assurance

mounting

Marine/Vehicle Brackets



Pt. # 700287



Pt. # 700270



Pt. # 700260



Pt. # 700430

Buckeye Fire Equipment manufactures strong and durable mounting hardware for all our portable fire extinguishers.

Whether you are looking for vehicle or marine vessel mounting, or simply to mount on a wall, you can be sure that all our brackets and wall hooks are designed to keep your Buckeye fire extinguisher secure and readily accessible.



Pt. # 700224
Pt. # 700226
Pt. # 700228
Pt. # 700229
Pt. # 700230

Marine/Vehicle Brackets

Part Number	Model	Suitable for Typical Extinguisher Sizes	Reference Diameter
700287	A-2	2.5 lb. Dry Chemical, Halotron & MiniGuard (horizontal)	3.375 inches
700270	A-6	5 lb. & 5.5 lb. Dry Chemical, Halotron & MiniGuard (horizontal)	4.25 inches
700260	B-6	5 lb. & 5.5 lb. Dry Chemical and Halotron	4.25 inches
700430	B-12	10 lb. Tall Dry Chemical	5.125 inches
700224	5DC	5 lb. & 5.5 lb. Dry Chemical, Halotron & MiniGuard (horizontal)	4.25 inches
700226	809	10 lb. Tall Dry Chemical, MiniGuard (horizontal) and 5 lb. CO ₂	5.0 - 5.25 inches
700228	810	10 lb. & 15 lb. CO ₂ . 11 lb. & 15 lb. Halotron. 2.5 gal Water & Water Mist	6.5 - 7.25 inches
700229	811	20 lb. & 30 lb. Dry Chemical, 30 lb. Class D. 18 lb, 20 lb & 25 lb MiniGuard (horizontal).	7.0 - 8.0 inches
700230	812	10 lb. Short Dry Chemical	6.0 - 6.25 inches

Wall Hooks



Pt. # 700202



Pt. # 700203



Pt. # 700204



Pt. # 700247



Pt. # 700249

Pt. # 900935
Pt. # 900937

Wall Hooks

Part Number	Suitable for Typical Extinguisher Sizes	Reference Diameter
700202	2.5 lb., 5 lb. & 5.5 lb. Dry Chemical and Halotron	3.25 - 4.25 inches
700203	10 lb. Tall Dry Chemical and 5 lb. CO2	4.75 - 5.5 inches
700204	10 lb. Short Dry Chemical	5.0 - 6.5 inches
700247	20 lb. & 30 lb. Dry Chemical, 10 lb. & 15 lb. CO2, 11 lb. & 15 lb. Halotron	6.75 - 7.5 inches
700249	20 lb. CO2	7.5 - 8.0 inches
900935	Wet Chemical & Water	7.0 inches
900937*	Water Mist	7.0 inches

*Stainless Steel



Buckeye Fire Equipment
PO Box 428
110 Kings Road
Kings Mountain
North Carolina 28086

Tel. 704 739 7415
Fax. 704 739 7418
www.buckeyef.com



**Buckeye Fire Equipment manufactures:
Restaurant Fire Suppression Systems.
Hand Held, Wheeled & Specialty Fire Extinguishers.
Foam Concentrates & Hardware.**

Proudly Manufactured in the United States Since 1968

For more information please contact: