

FOR SALE - MULTI FAMILY GROUND

CS Real Estate Services is offering approximately 9.5 +/- acres of medium-density town house ground. Currently available for purchase, Spring Crest is within a half mile of Waukee Elementary. Located on the west side of Waukee, Spring Crest is south of Hickman. From Hickman, turn south on 10th Street which will take you directly to Spring Crest. This multi-family parcel is on the southwest corner of 10th and Maple.

Information contained here deemed reliable but not guaranteed by CS Real Estate Services

CASEY SHELTON

t: 515 499 6194

e: casey@csrealestateservice.com

a: 9235 Swanson Blvd . Clive . Iowa . 50325

TOWNHOME GROUND

- 9.5 Acres / 414,675 SF
- \$100,000 per acre
- 12 units per acre

ROW HOUSE LOTS

- \$45,000 per lot

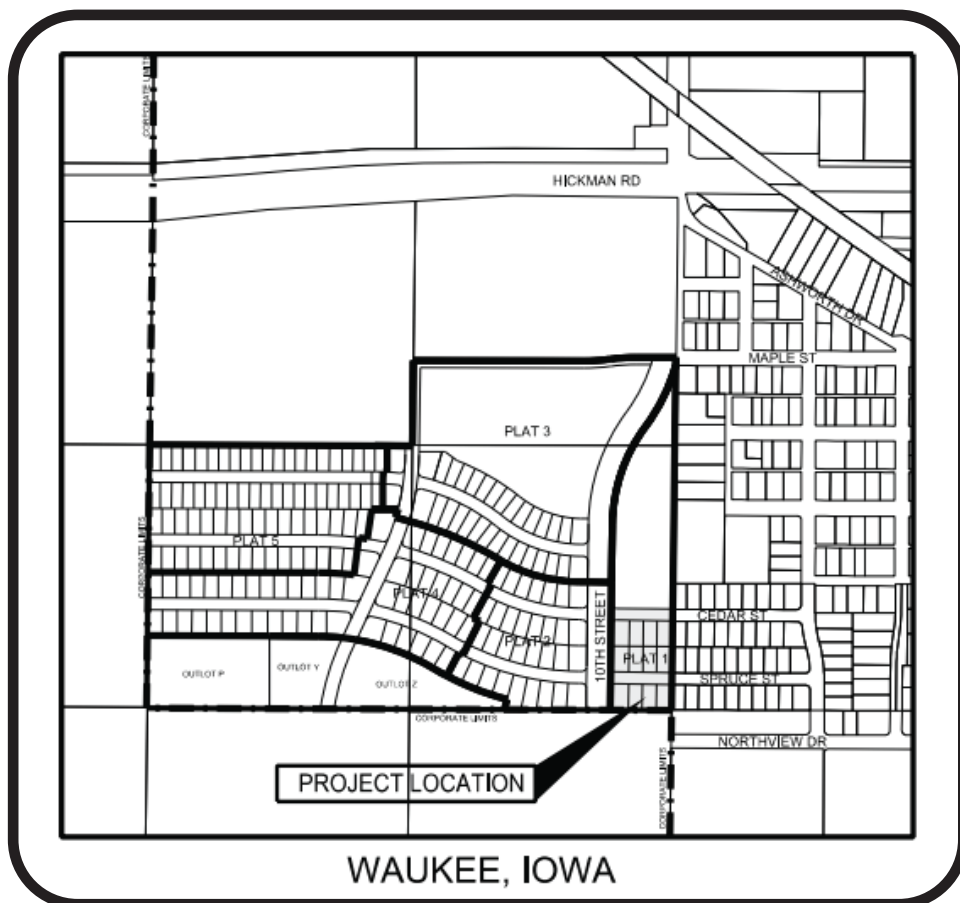

HICKMAN ROAD / SOUTH 10TH STREET



Information contained here deemed reliable but not guaranteed by CS Real Estate Services

CASEY SHELTON

t : 515 499 6194

e : casey@csrealestateservice.com

a : 9235 Swanson Blvd . Clive . Iowa . 50325

SPRING CREST

HICKMAN ROAD / SOUTH 10TH STREET



53,785
2017 Population



65,037
2020 Est. Population



34
Median Age



20,961
Total Employees



\$95,527
Median Household Income



1,198
Total Businesses



21,180
Total Homes
(owned + rented)

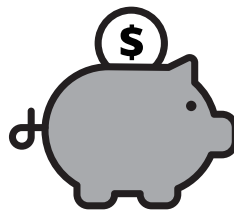

\$281,626
Median Net Worth

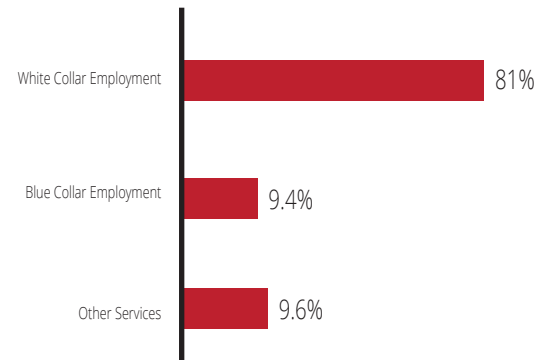
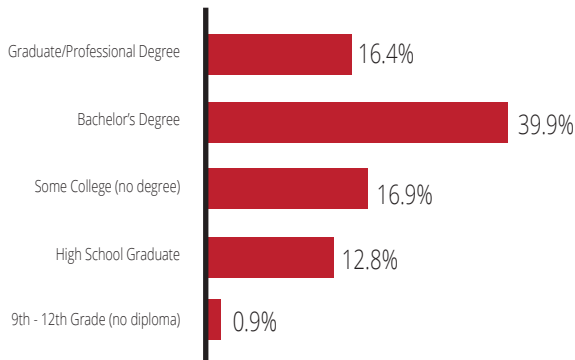

Information contained here deemed reliable but not guaranteed by CS Real Estate Services

CASEY SHELTON

t : 515 499 6194

e : casey@csrealestateservice.com

a : 9235 Swanson Blvd . Clive . Iowa . 50325