

Dear St. Joseph family,

As you may know our St. Joseph south school building has damaged roof trusses causing the roof to be unstable. Within the next couple of years, we must properly address this issue to ensure a safe St. Joseph campus. Please review and give input on the following ideas and options on how to proceed with this lingering issue.

-Please let me know how much you would give to **EACH OPTION BELOW** if we chose that option. A blank in the \$/dollar response line would indicate that you would never give any money to that option. Please mail this document back to St. Joseph Parish, or access the website and submit electronically, or drop in the collection basket by June 30th, 2025. *Please note: This is a preliminary poll and your \$ response is not official or legally binding.*

Sincerely,

Fr. Jeff

~~~~~

**Option #1**

I am in favor of demolishing the south school (not including the garage) which will cost the parish around \$100,000.

*This option includes demolishing the south school and rebuilding the north Convocation Center wall and the south garage wall. (This option retains the current garage)*

**Recommended donation equates to**

**\$1,200 - \$1,700 over 5 years = (\$20 a month)**

**If** we took this route, I would consider giving over a five-year period totaling:

\$ \_\_\_\_\_

\_\_\_\_\_

Print Name

\_\_\_\_\_

Date

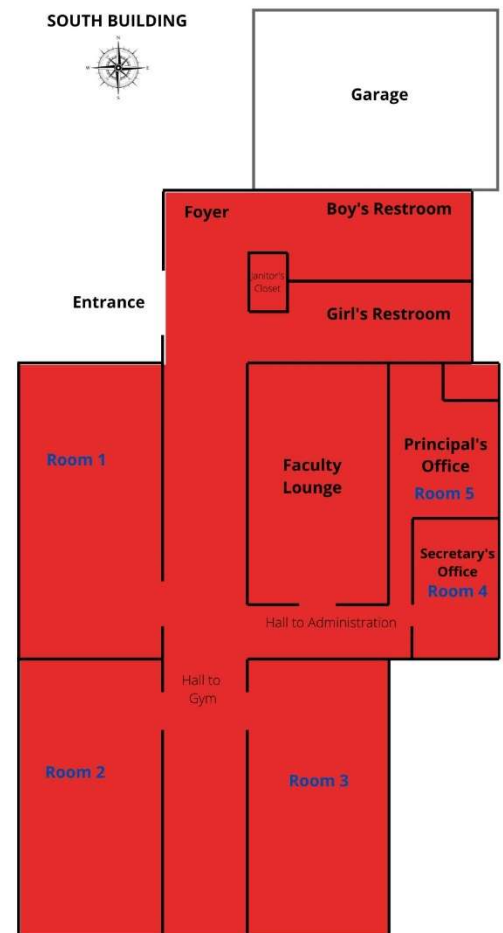

## Option #2

I am in favor of demolishing the south school building partially while keeping 2 rooms attached to the Convocation Center for garage/storage and an office. This option would cost the parish around \$180,000 \*Current garage would be demolished\*

*This option includes demolition to the south school building while keeping only the two rooms attached to the Convocation Center for garage/storage and parish office.*

**Recommended donation: \$3,000 - \$4,000 over 5 years = (\$66 a month)**

If we took this route, I would consider giving over a five-year period totaling:

\$ \_\_\_\_\_

\_\_\_\_\_  
Printed Name

\_\_\_\_\_  
Date

SOUTH BUILDING



***Everything in red would be demolished.***

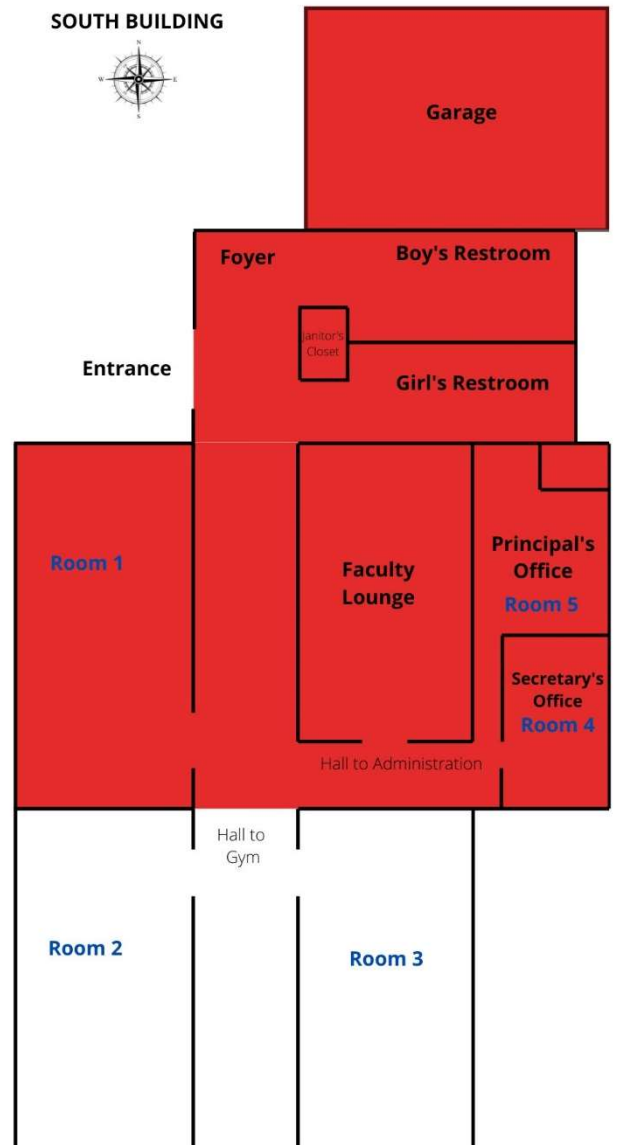

### Option #3

I am in favor of a partial fix which will cost the parish around \$360,000

*This option would remove the two west classrooms and slightly reduce the roof pitch. While the rest of the structure would be repaired.*

**Recommended donation: \$6,000 - \$8,000 over 5 years = (\$133 a month)**

If we took this route, I would consider giving over a five-year period totaling:

\$ \_\_\_\_\_

Print Name \_\_\_\_\_

Date \_\_\_\_\_

SOUTH BUILDING



***Everything in red would be demolished.***

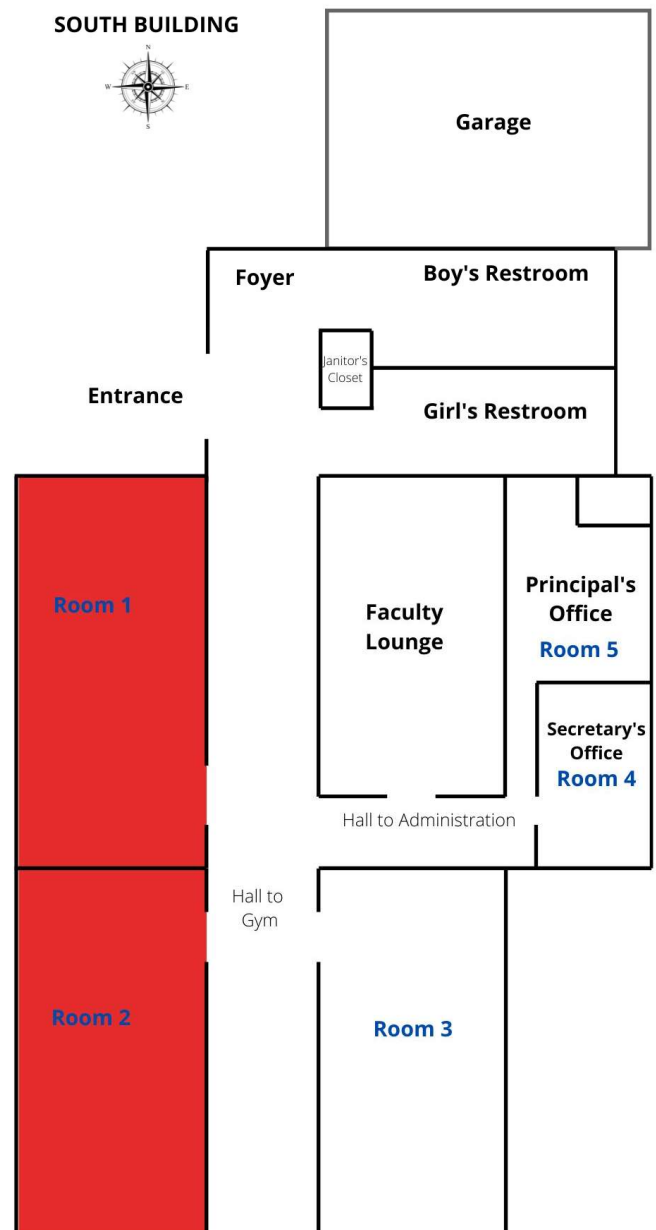

## Option #4

I am in favor of a total fix which will cost the parish around \$470,000.

*This option would repair the roof in total.*

**Recommended donation: \$8,000 - \$9,000 over 5 years = (\$150 a month)**

**If** we took this route, I would consider giving over a five-year period totaling:

\$ \_\_\_\_\_

Print Name \_\_\_\_\_

Date \_\_\_\_\_

**Save your completed form to your computer. Please email with form attached to:**

[jpalm@stjosephcrestline.org](mailto:jpalm@stjosephcrestline.org)

**I sincerely thank you!**

**Fr. Jeff**

