

Installation Instructions

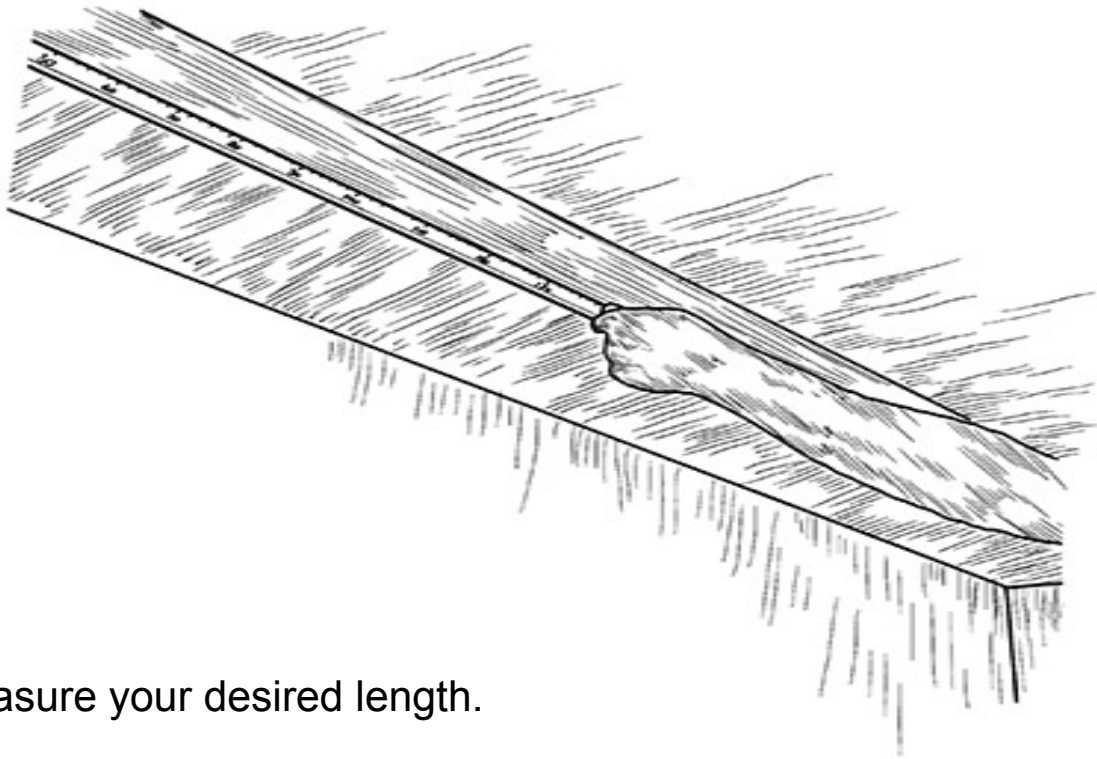

1. Measure your desired length.

2. Cut crown moulding to desired length or angle.

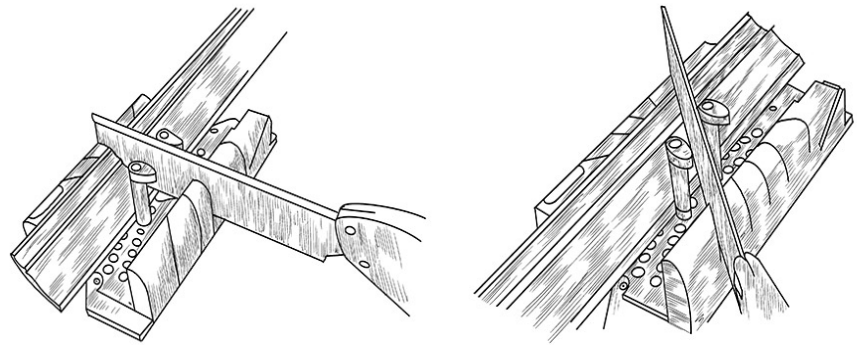

3. Apply adhesive to back of crown moulding.

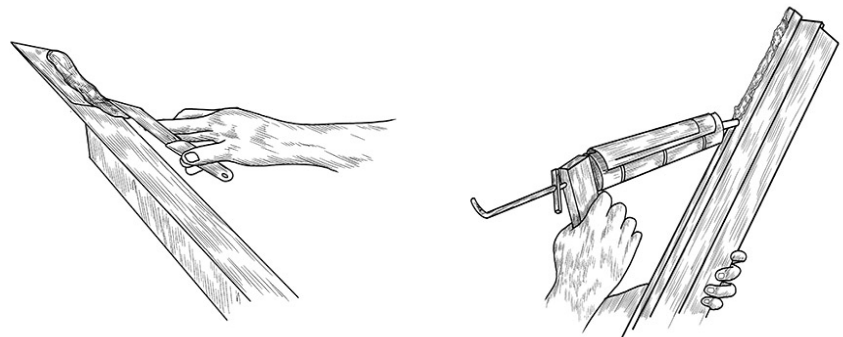

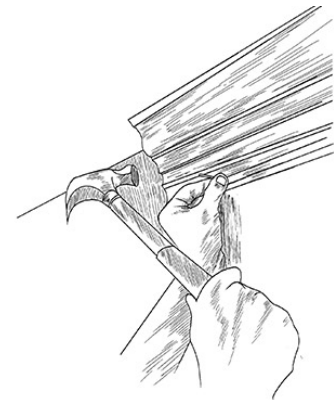
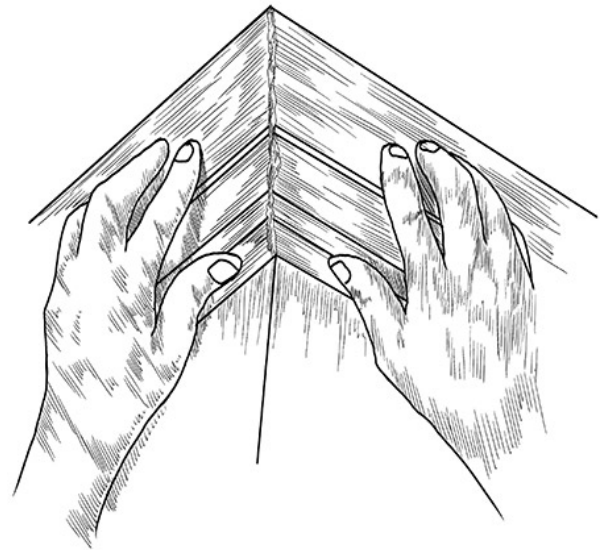
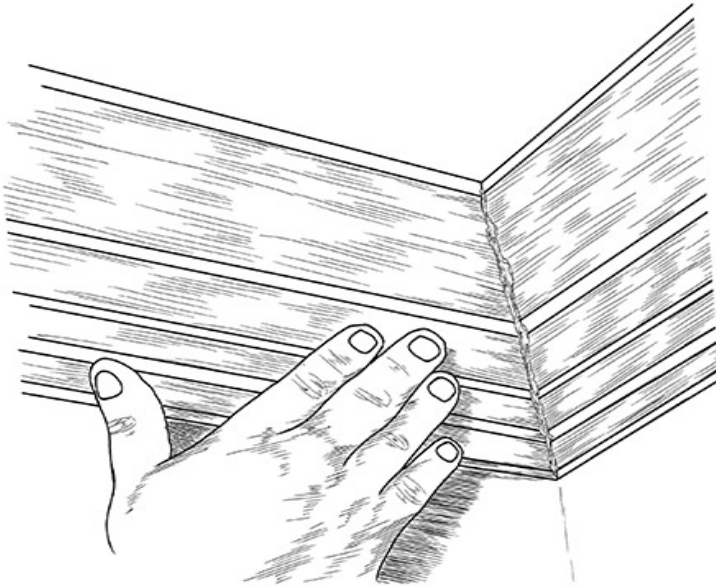
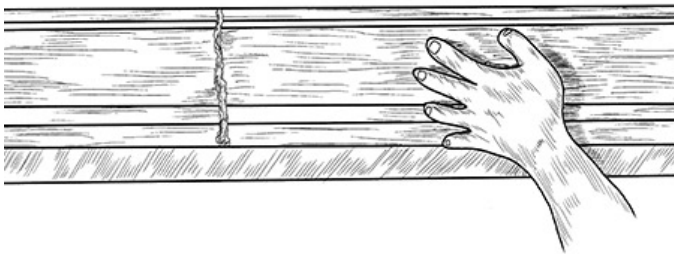
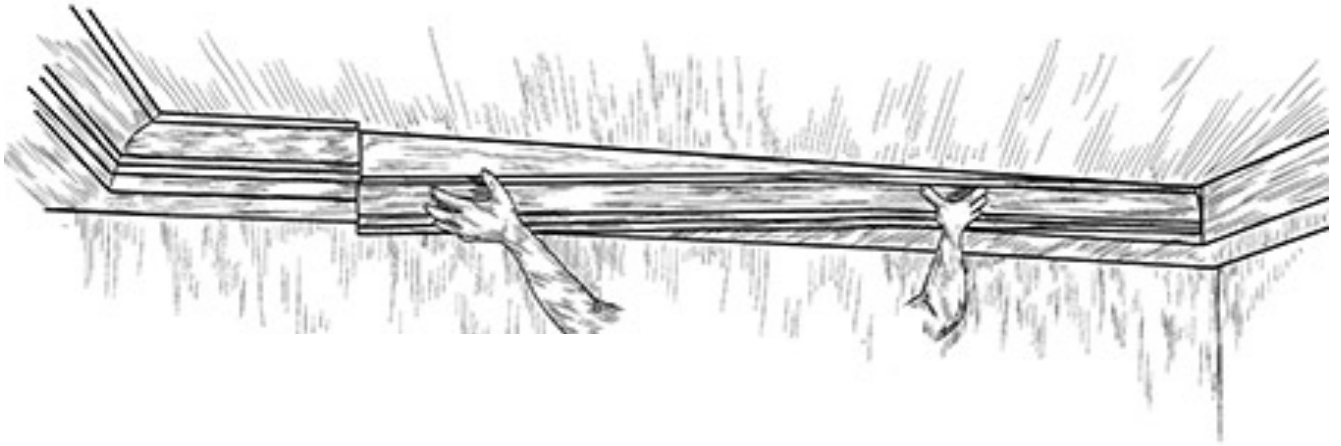

4. Install by placing crown moulding into desired place and temporary securing it.

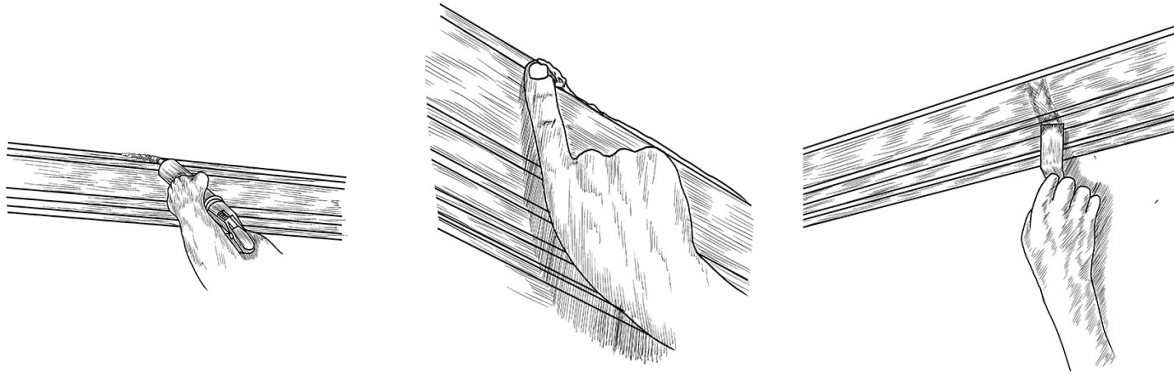

5. Seal joints and gaps with caulking or drywall mud.

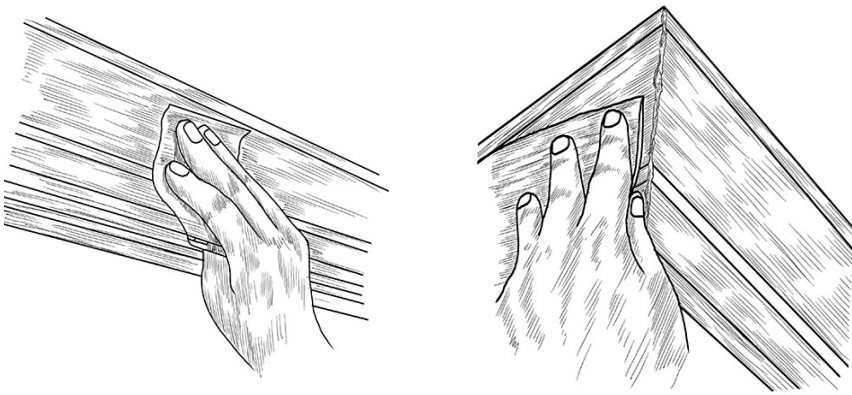

6. Lightly sand the joints and gaps that have been sealed.

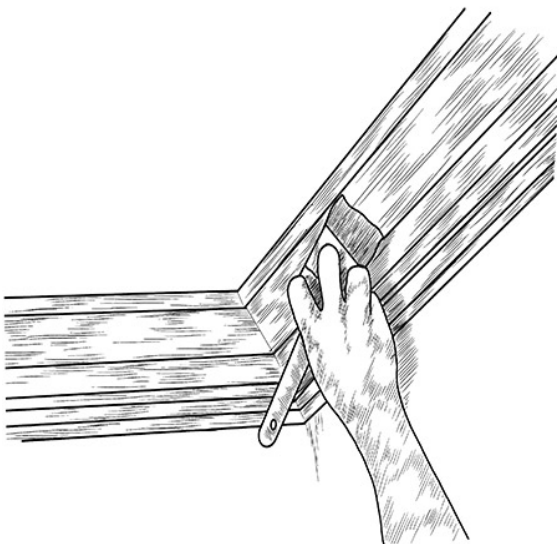

7. Paint (no primer necessary; premium quality latex flat paint is recommended).