

ITEM NO.	PART NUMBER	DESCRIPTION	QTY.
1	PS-6SA21416H1X	AUBURN POWER WHEEL ORDER CODE 6SA21416H1X	1
2	PS-184-0219-002	CHARLYNN HYDRAULIC MOTOR - 184-0219-002	1
3	AGR-00-0033	8" PIN	1
4	AGR-00-0034	LONG PIN FOR AUGER	1
5	AGR-01-002	AUGER BASE WELDMENT	1
6	AGR-01-003	CONNECTOR FOR PLANETARY TO BASE	1
7	AGR-01-006	18" AUGER WELDMENT	1
8	AGR-01-012	TUBE WELDMENT FOR CHARLYNN MOTOR / PARKER MOTOR	1
9	FA0166990	1/2"-13 GRADE F ZINC FLANGE TOP LOCK NUT	9
10	FA0166993	3/4"-10 GRADE F ZINC FINISH STEEL FLANGE TOP LOCK NUT	2
11	FA110120307	1/4"-20 X 1-3/4" GRADE 5 ZINC HEX CAP SCREW	1
12	FA15212	1/2"-13 x 2-1/4" GRADE 8 YELLOW ZINC HEX CAP SCREW	9
13	FA15369	3/4"-10 x 4" GRADE 8 YELLOW ZINC HEX CAP SCREW	2
14	HOSE CLAMP	HOSE CLAMP	2
15	HOSE CLAMP METAL	METAL PART FOR HOSE CLAMP	1
16	LOCKING PIN WITH RING	5/16" LOCKING PIN WITH RING	4

REVISIONS			
REV.	DESCRIPTION	DATE	APPROVED
A	ADDED NUTS & BOLTS	4/9/2018	BEVAN
B	UPDATED THE BOLTS	6/19/2018	BEVAN
C	UPDATED THE P/N FOR THE NUTS & BOLTS	10/1/2019	BEVAN
D	UPDATED P/N FOR MOTOR AND PLANETARY	1/7/2021	BEVAN

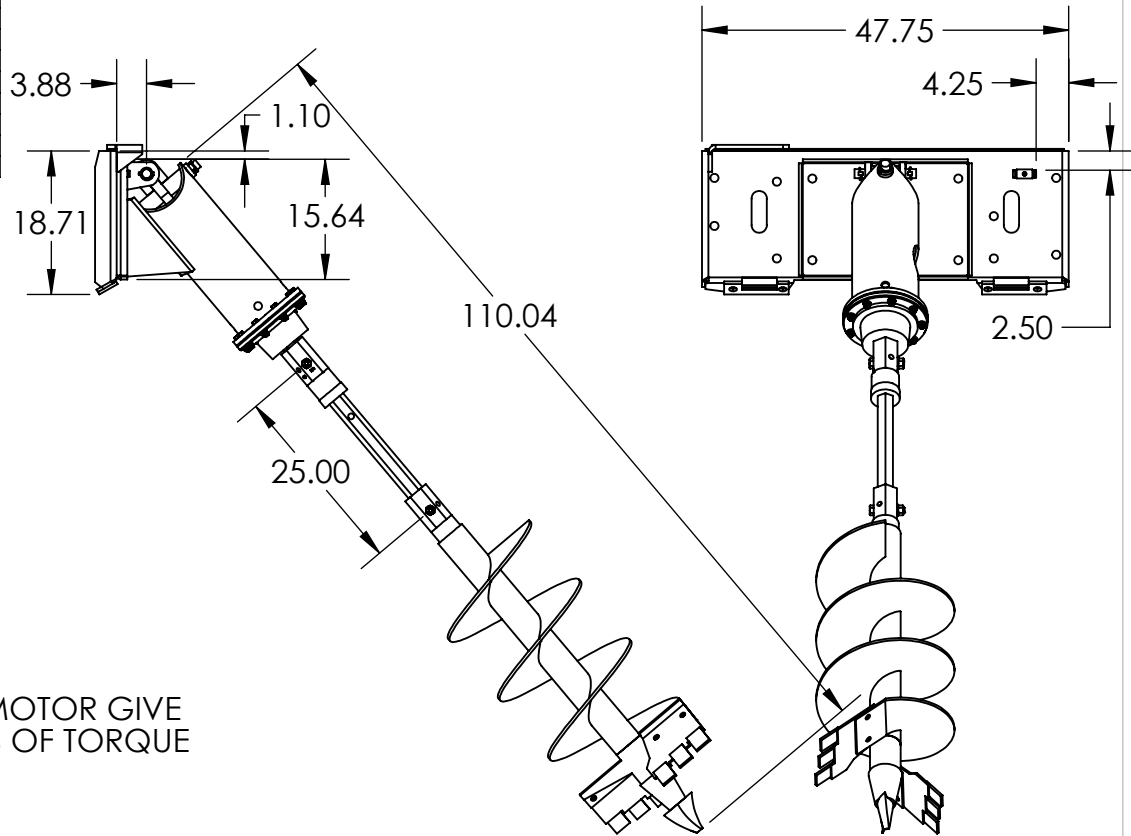
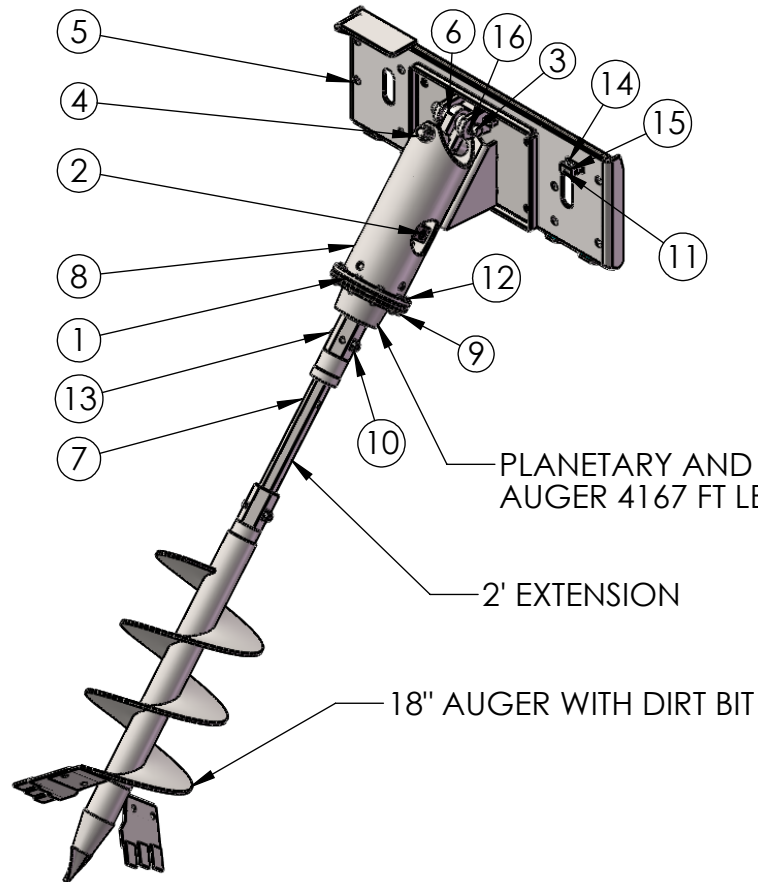

UNLESS OTHERWISE SPECIFIED:		NAME	DATE
DIMENSIONS ARE IN INCHES		DRAWN	BEVAN 9/28/2017
TOLERANCES:		CHECKED	
FRACTIONAL ±		ENG APPR.	
ANGULAR: MACH ± BEND ±		MFG APPR.	
TWO PLACE DECIMAL ±		Q.A.	
THREE PLACE DECIMAL ±		COMMENTS:	
INTERPRET GEOMETRIC TOLERANCING PER:			
MATERIAL			
FINISH			
NEXT ASSY	USED ON		
APPLICATION			
DO NOT SCALE DRAWING			

EZ-SPOT-UR		
TITLE:		
AUGER ASSEMBLY		
SIZE	DWG. NO.	REV
A	AGR-01-018 - 18" AUGER ASSEMBLY	D
SCALE: 1:25	WEIGHT: 624.82 LBS	SHEET 1 OF 1

PROPRIETARY AND CONFIDENTIAL

THE INFORMATION CONTAINED IN THIS DRAWING IS THE SOLE PROPERTY OF EZ-SPOT-UR. ANY REPRODUCTION IN PART OR AS A WHOLE WITHOUT THE WRITTEN PERMISSION OF EZ-SPOT-UR IS PROHIBITED.