

“Pilgrims Promise Resort” by KasoyTuba Travel & Tours

Our Business Case & Profit Opportunity for YOU

Our Core Purpose

TO HELP MERCY ABOUND IN YOU...

- **By inviting YOU to** be our guest, so that YOU can learn how to become an ever-more merciful person simply by enjoying the **FAMILY-ORIENTED FOOD & FUN** we offer to YOU from deep within our hearts... each & every day...
- **By helping YOU to** grow an ever-better set of LEGS, so that YOU can learn how to **LOVE, EARN, GIVE & SAVE all YOU can** as YOU live the life YOU choose upon this Earth... wherever YOU may go...
- **By investing an incrementally increasing percentage of our ever-growing profits with YOU** as we work together to provide food, water, clothing, open migration, welcoming homes, healthcare, personal development, dignified burial & kind remembrance to those among us who are most in need of such... so that we all can live together well... right now... and ultimately... **SO THAT WE ALL CAN LIVE @ PEACE... FOREVER!**

Our Local Investments in Mercy

- **Feeding, clothing, housing, and caring for an aging indigenous farming population** who are too often left with no land & no means of income due to mismanagement, unfortunate happenstance, and the unmerciful acts of others in their immediate midst
- **Helping move local beggar families from the streets to their own welcoming homes** by building a manufacturing base that will offer them meaningful, dignifying work, so that they can make their own way in the world without begging for handouts on the street
- **Educating a vibrant & rapidly growing youth population in both the ways of sound business management, and socially responsible earning**, so that even the youngest among us can “Grow LEGS” by learning how best to run a good race in this life by LOVING, EARNING, GIVING & SAVING (with frugality) all they can as they sojourn to wherever Grace may carry them

Our Core Business Functions

- **Operating a residential performance arts training school** at our resort in Kimamon, Sto. Tomas, Davao Del Norte, The Philippines, utilizing a “Chief Artist in Residence” training format
- **Producing live performances, daily, at our resort** using an “8 Days a Week” format
- **Offering locally favorite food & drink** to both our resort travel guests & our local, day-pass holding guests from the general public
- **Running a team-oriented athletic training program** for our Swim Team pass holding guests
- **Providing tour packages for our Inbound Guests at our resort** utilizing our daily performance & food service capabilities
- **Personalizing global travel & tour package accommodations for our Outbound Guests** to take them from wherever they may be, to wherever they may wish to go on the face of This Earth, whenever the humor of travel & exploration strikes them

Our Core Business Functions... Continued

- **Maximizing our quality control & minimizing our operational costs** by growing our own lechon, chicken, vegetables & mushrooms to support our daily food service needs
- **Producing “Celebratory Wall Plaques”** utilizing ShroomStone harvested from our mushroom growing operations to celebrate those who Help Mercy Abound in this world while defraying the cost of building our “Wall of Mercy & Remembrance” around the boundary of our resort property
- **Expanding our basic product & service value streams into ancillary offerings** for local, regional, national & global markets as opportunities arise
- **Extending production capabilities into adjacent properties** as opportunities arise
- **Researching & developing new products & services for new guest populations** as opportunities arise

Our Competitive Advantages

- Located in Rapidly Growing Metropolitan Area
- ZERO Foreseeable Competition for AT LEAST the Next Five Years
- EXTREMELY HIGH First Mover Market Monopoly Potential
- UNTAPPED Ancillary Expansion Potential for Core Business Functions
- Preliminary Support Expressed by Government Development Partners
- Offering Unique Amenities given the Context of Our Local Market

[illegible]

DE LA CERNIA

17

Our Immediate Expansion Plan — Phase 1A

(Lot E - Arts Pavilion, Dorms, Food Service & Swimming)



Our Immediate Expansion Plan — Phase 1B

(Lot A - Farming & ShroomStone Manufacturing)

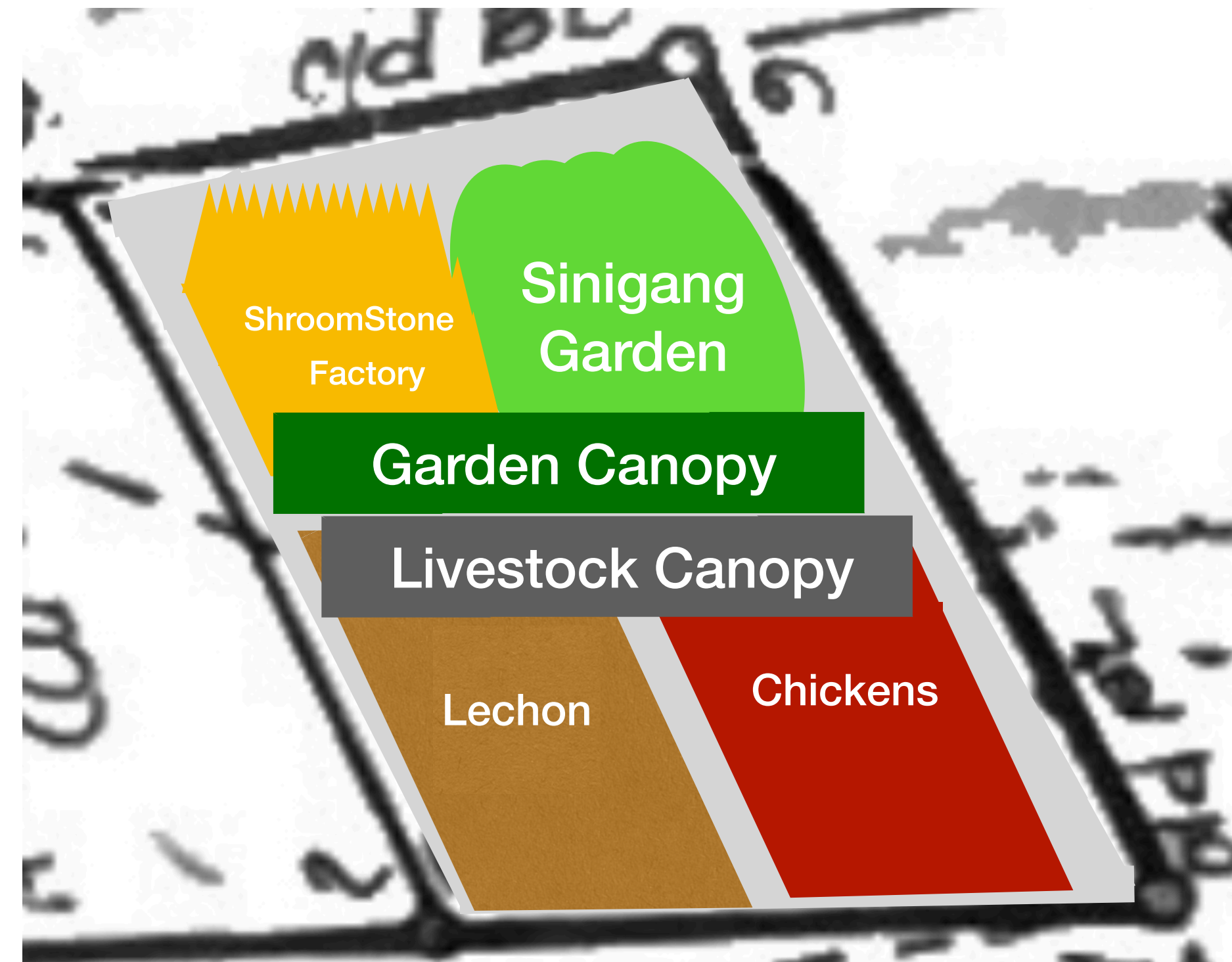

Our Current Numbers in a Nutshell

A \$6 Million USD investment returns \$18 Million USD to YOU in 6 years

Pilgrims Promise Resort: Investment Needs			
Improvement	PHP	INR	USD
Pool	11,250,000	15,517,000	194,000
Pool Canopy	3,750,000	5,172,000	65,000
Dorms x 15	4,500,000	6,207,000	78,000
Hot Tub	1,080,000	1,490,000	19,000
Sauna	1,000,000	1,379,000	17,000
Food Canopy	1,740,000	2,400,000	30,000
Performing Arts Pavilion	7,200,000	9,931,000	124,000
Concrete for Foundations & Walkways	4,050,000	5,586,000	70,000
Live Stock Canopy	2,000,000	2,759,000	34,000
Chicken Pens	1,181,250	1,629,000	20,000
Lechon Pens	2,700,000	3,724,000	47,000
Garden Pavilion	2,000,000	2,759,000	34,000
ShroomStone Mfg. Pavillion	3,420,000	4,717,000	59,000
Farm Wells	200,000	276,000	3,000
Room Wells	750,000	1,034,000	13,000
Electrics	560,000	772,000	10,000
Septic Service	300,000	414,000	5,000
Toilet Units (5 Toilets Each)	1,500,000	2,069,000	26,000
Pond & Fountain	3,600,000	4,966,000	62,000
Operational Bootstrap	300,000,000	413,793,000	5,172,000
Total Investment Needed	352,782,000	486,594,000	6,082,000
Infrastructure Only Investment Needed	52,782,000	72,801,000	910,000

Pilgrims Promise Resort: Annual Profit Projections (Basic Income Only*)						
Income Source	Daily Capita	Daily Per Capita (PHP)	Days	PHP	INR	USD
Student Fees	12	8,000	330	31,680,000	43,697,000	547,000
Tour Packages	24	261,000	330	2,067,120,000	2,851,200,000	35,640,000
Dinner Show Tix	100	100	2,912	29,120,000	40,166,000	503,000
Non-Show Food Services	1,000	1,200	330	396,000,000	546,207,000	6,828,000
“Swim Team” Pool Fees	180	100	330	5,940,000	8,194,000	103,000
ShroomStone Plaque Fees	100	1,000	330	33,000,000	45,518,000	569,000
Annual Gross Income				2,562,860,000	3,534,980,000	44,188,000
Annual Expenses				1,691,488,000	2,333,087,000	29,164,000
Annual Payback Reserve				17,640,000	24,332,000	305,000
Annual NIBIT				853,732,000	1,177,562,000	14,720,000
Total Investment Payback	Principal + 200% ROI			1,058,400,000	1,459,863,000	18,249,000
*Notes	Basic Income does not include natural parlay of core business into ancillary income streams, so our overall profit picture may be higher as our ancillary market opportunities allow.					

“Full-Scale Construction” starts when we raise our first \$1 Million USD

Profit Sharing Opportunities for YOU

1. **200% ROI** paid to YOU, along with your initial investment — regularly, annually & incrementally — beginning at the close of our second business year (Available at \$6 Million USD investment level only)
2. **A Negotiable Percentage of Our Annual Net Profits** paid to YOU as our positive cash flow allows — beginning at the close of our first business year — this investment option increases BOTH the profit YOU make & the risk YOU take (Available at \$1 Million USD investment level and above)
3. **A Business Facility Formally & Publicly Named in Your Honor, based on the total value of the GIFT YOU invest in us** — in this case: the goodwill YOU generate through our co-marketing efforts is your profit (Available at any substantially supportive investment level of your choosing)