

82-A

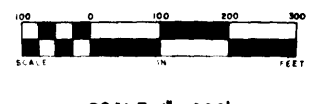

BLUE RIDGE MANOR ashe lake section



SCALE 1" = 200'

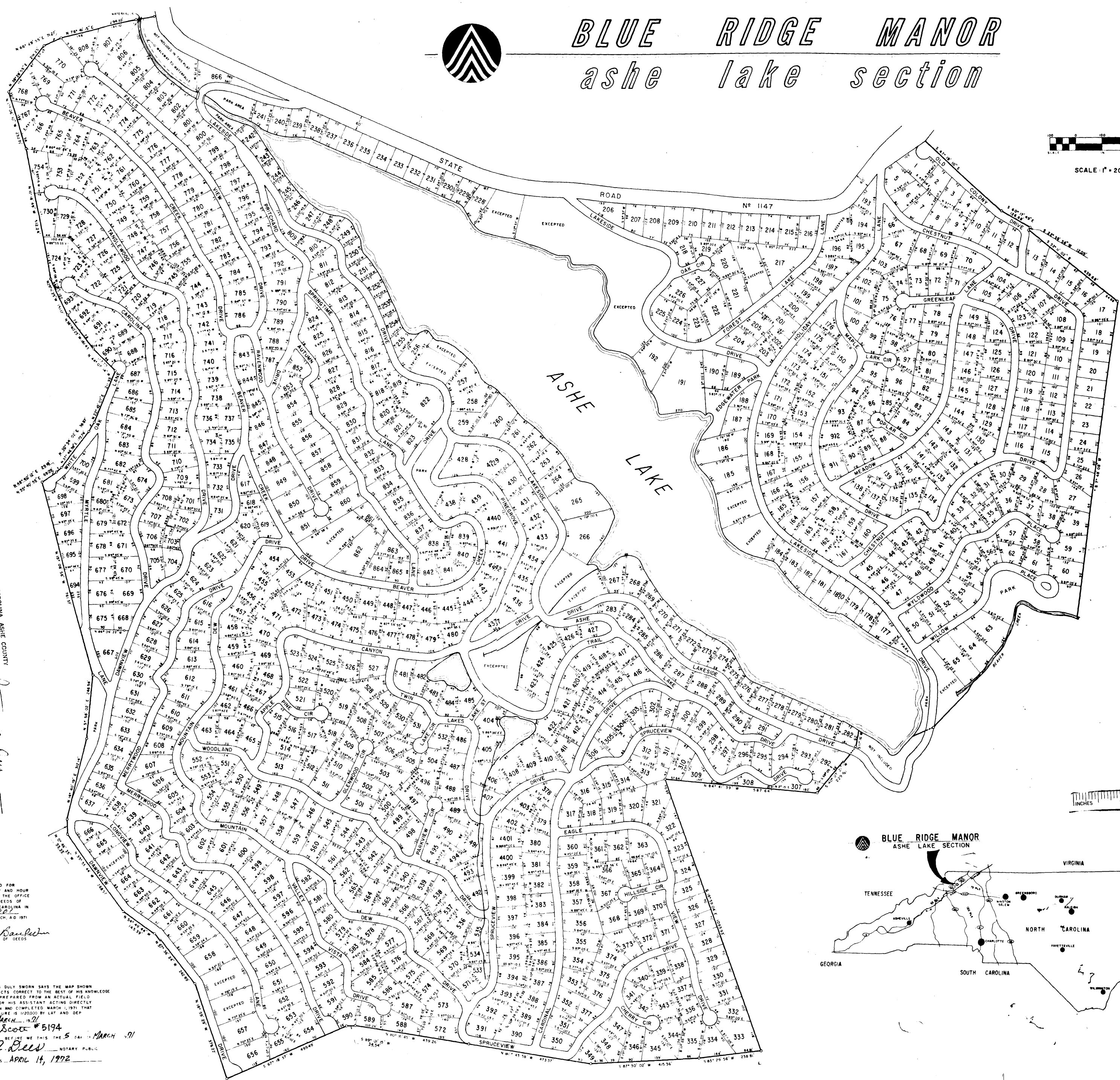

NORTH CAROLINA, ASHE COUNTY
 The foregoing copy of *Plat of Blue Ridge Manor*
 is (has) been filed in the office of the Register of Deeds of
 Ashe County, North Carolina in Book *202*
 for registration this day and hour and day of *MARCH* A.D. 1972 at
 County North Carolina in G.M. &
 This *5* day of *MARCH* A.D. 1972
John Campbell
 Register of Deeds

THIS MAP WAS PRESENTED FOR
 REGISTRATION THIS DAY AND HOUR
 AND DULY RECORDED IN THE OFFICE
 OF THE REGISTER OF DEEDS OF
 ASHE COUNTY, NORTH CAROLINA IN
 BOOK *202* PAGE *202*
 THIS DAY OF *MARCH* A.D. 1972
 AT *11:25* O'CLOCK A.M.
John Campbell
 REGISTER OF DEEDS

NORTH CAROLINA
 ASHE COUNTY
 GEORGE C. SCOTT BEING DULY SWORN SAYS THE MAP SHOWN
 HEREON IS IN ALL RESPECTS CORRECT TO THE BEST OF HIS KNOWLEDGE
 AND BELIEF AND WAS PREPARED FROM AN ACTUAL FIELD
 SURVEY MADE BY HIM OR HIS ASSISTANT ACTING DIRECTLY
 UNDER HIS SUPERVISION AND COMPLETED MARCH 1972 THAT
 THE PRECISION OF CLOSURE IS 1:20000 BY LAT AND DEP.
 THIS THE *5* DAY OF *MARCH* A.D. 1972
George C. Scott #5194
 SUBSCRIBED AND SWORN before me this *5* day of *MARCH* 1972
Patricia A. Bees NOTARY PUBLIC
 MY COMMISSION EXPIRES APRIL 14, 1972

