

## Step 1- Assemble the Handle

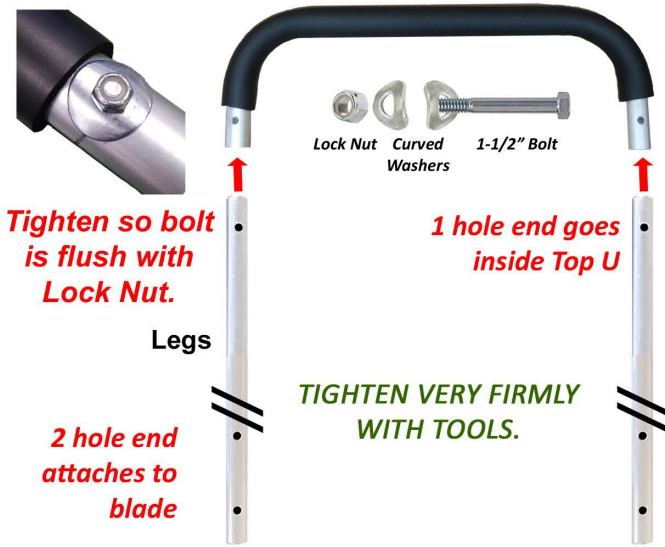

## How to Store Your MANPLOW When Not in Use

To keep your blade in good condition, store your MANPLOW vertically on an even surface in a cool location.

### What Not To Do:

- Don't store laying down flat.
- Don't store where other things may be put on top of it.
- Don't store in Garage rafters where it gets hot in summer.
- Don't store in backyard sheds that get hot in summer.



# MANPLOW

## U-HANDLE

STRENGTH & VERSATILITY

## ASSEMBLY

[www.manplow.com/assembly-instructions](http://www.manplow.com/assembly-instructions)

## REVOLUTION X

## Step 2- Attaching the Blade

### First

Slide black handle connector over each end of the legs. Align holes. It should be snug (if to snug, run under hot water).

Back of blade will go against flat side of handle connector.



### Second

Insert the bolts with larger washer through the front of the blade and through the handle connector. Smaller washers and Lock Nut in back. **HAND TIGHTEN ONLY!**



Durability & Performance

# MANPLOW

## PRO



It is recommended that you assemble the handle first.



## Problems with your order?

Damage? Missing parts? Trouble assembling? For the quickest solution, contact MANPLOW directly at [theman@manplow.com](mailto:theman@manplow.com). Our customer service team is committed to resolving any issue you may have.