



PRODUCTO:

## MAQUINA FLEJADORA TP-6000

### DESCRIPCIÓN

Flejadora automática económica para flejado de PP. Fácil operación y mantenimiento simple. La calidad y el rendimiento comprobados hacen del TP-6000 la solución más rentable para aplicaciones generales.

### CARACTERISTICAS

- \* Cabezal de flejado sin lubricación.
- \* Control de tensión mecánico externo
- \* Múltiples métodos de inicio de ciclo
- \* Opción asequible para todos los presupuestos
- \* Sensor de avance corto
- \* Sistema de escape de humos con filtro de carbón.
- \* Mesa sin rodillo libre
- \* Ruedas PU (2 libres y 2 con freno)



### DATOS TECNICOS.

Capacidad	Hasta 27 ciclos / minuto
Ancho de la correa	8 mm, 9 mm, 12 mm, y 15.5 mm
Rango de tensión	7 a 70 kg
Peso	220 kg
Eléctrico	110 V, 220 V, 230 V, 240 V, 50/60Hz 1PH 220V, 380V, 400V, 415V 50/60Hz 3PH

## TP-6000 Economy model



The TP-6000 is an economy automatic strapping machine for PP strapping. Easy operation and simple maintenance. The proven quality and performance make TP-6000 the most cost effective solution for general applications.

### Features

- Lubrication free strapping head
- External mechanical tension control
- Multiple methods of cycle initiation
- Affordable choice for every budget

### Options

- Short feed sensor
- Smoke exhaust system with carbon filter
- Table without free roller
- PU casters (2 free and 2 with brake)

### Technical Data

Capacity	Up to 27 cycles/minute
Strap Width	8 mm, 9 mm, 12 mm, or 15.5 mm
Tension Range	10 - 70 kg (CE version: up to 45 kg)
Weight	220 kg
Electrical Requirements	110V, 220V, 230V, 240V 50/60Hz 1PH 220V, 380V, 400V, 415V 50/60Hz 3PH

Dispositivo de escape del humo con el filtro del carbono

## 2. Construction and Function of Units

### 1 Strapping head unit

This unit is the most important part of the machine for cutting and sealing of P.P. strap.

### 2 Bandway unit

This is the arch track through which P.P. strap forwards or reverses.

### 5 Feed unit

Feeding and reversing of strap.

### 4 Reel unit

Holds the strap coil.  
(If strap core is 280mm, you can take off the center drum to have core size 200mm.)

### 6 Electric control unit

### 3 Accumulator unit

This unit accumulates the quantity of strap required for smooth feeding into the arch track.

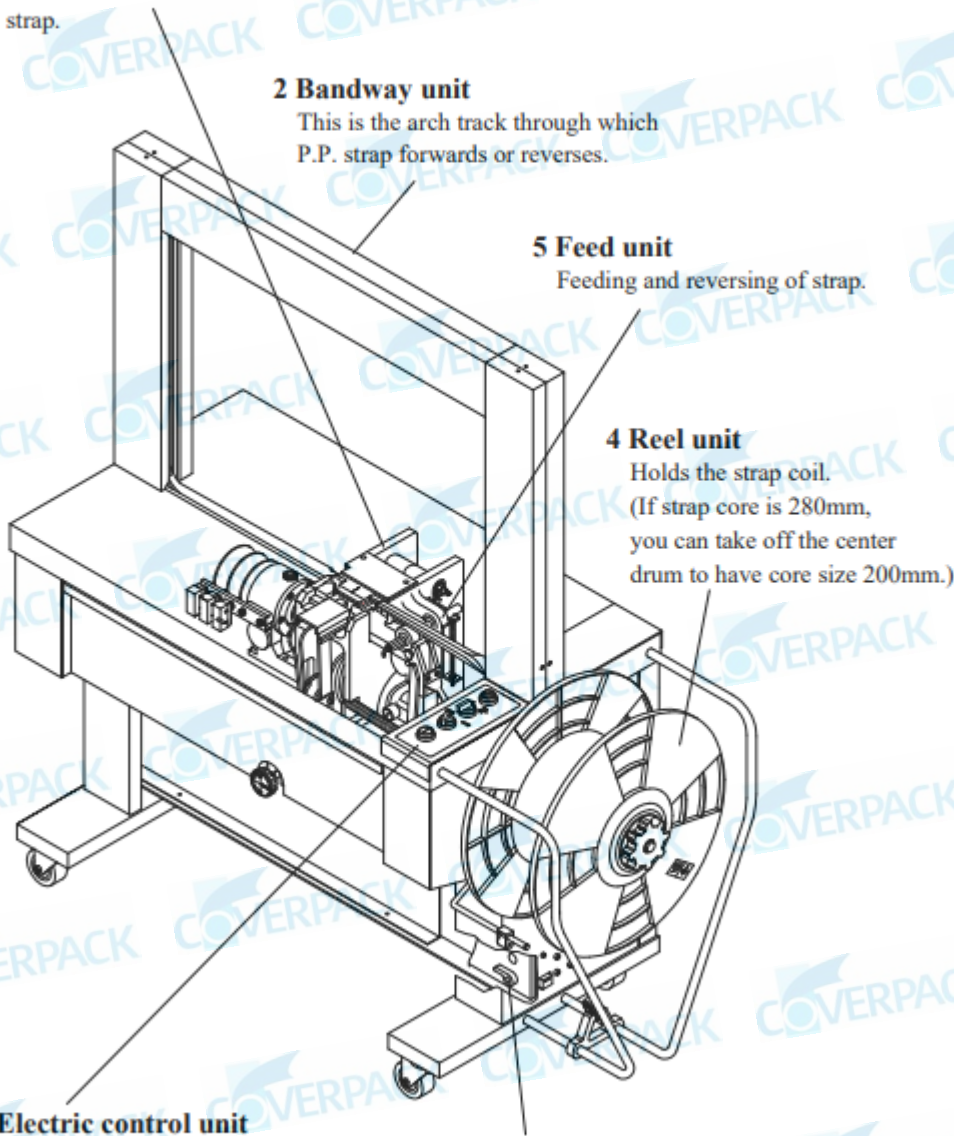

### 3. Technical Data

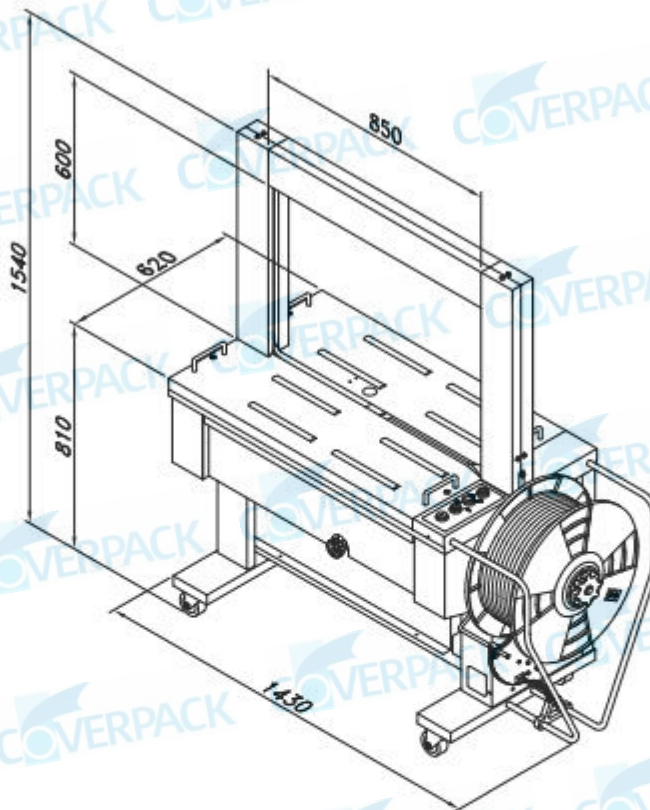

Sealing method	Heat
Strap width:	8 mm to 12 mm (3/8"-1/2")
Strap thickness:	0.55 mm up to 0.75 mm (0.022" - 0.03")
Strap reel diameter:	200 mm (8" nominal)
Width :	1430 mm (56.3")
Depth:	620 mm (24.4")
Table height:	810 mm (31.9")
Electrical connection:	AC 110V/220V/230V/240V (50/60Hz), 1PH AC 220V/380V/400V (50/60Hz), 3PH
Weight:	220 kg (341.7 lbs.)
Noise emission:	83 dB (A)
Ambient temp:	5°C ~ 40°C (41°F ~ 104°F)