



Method Rail

Architectural Specification

Method Rail is a performance safety fixture. Rail shall consume a maximum of 125mA at 24VDC. Rail shall be powder-coated black and offer an acrylic diffusion lens. Rail shall be designed to mount on standard single-gang boxes. Rail shall be designed to wire in parallel to other Method fixtures as designed by Method.

Rail has individual control over Blue and White (40k) LED diodes.

Rail control shall be achieved via constant voltage current LED dimming drivers. Controller shall have DMX input, DMX loop-thru, 0-10v, and contact closure control capabilities. A maximum of 34 feet may be connected to a single 240-watt, 24VDC power supply utilizing 14-gauge stranded wire with a total wire run of no more than 1000 feet. A standard 6-channel Method control card may be used to control up to 35 fixtures per channel with control via DMX or analog slider operation through a highest-takes-precedent protocol.

Power supplies shall be switching power supplies for maximum system efficiency with power consumption of less than 15 watts at 120VAC when the system is idle. Control cards shall be six-circuit cards capable of controlling up to 6000mA per circuit. Power supplies and control cards are optional if other control methods are to be used. Consult factor for options that include vented NEMA enclosures with DIN mounted power supplies and control cards.

US Patent

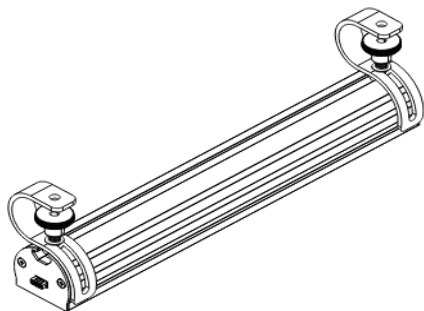

Submission Date	
Name of Firm	
Project name	

Ordering Information

Fixtures Total
Zone Total
Zone 1:
Zone 2:
Zone 3:
Zone 4:
Zone 5:
Zone 6:
Power Supply
Blank - No Supply
24 - 240-watt 24VDC
48 - 480-watt 24VDC
LV - 120VAC dimmed via magnetic transformer
Mounting
S - Surface Mount
W - Wall Mount
Accessories
F - Frosted Lens
TH - Top Hat
EB - Eyebrow
Control
ND - Non Dim Switching
DMX - DMX Controls By Others
DMX-S - Single Slider Control
DMX-D - Double Slider Control
Warranty
Warranty: Fixture carries a two year limited warranty. Fixtures wired to non-Method power supplies will not be covered. Fixtures installed in a manner unintended for use will not be covered.



Method Rail

Submission Date	
Name of Firm	
Project name	

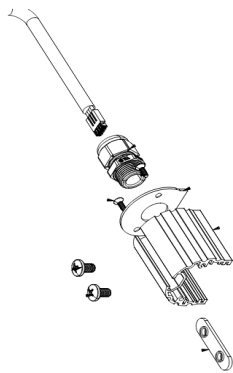

End Cap Assembly

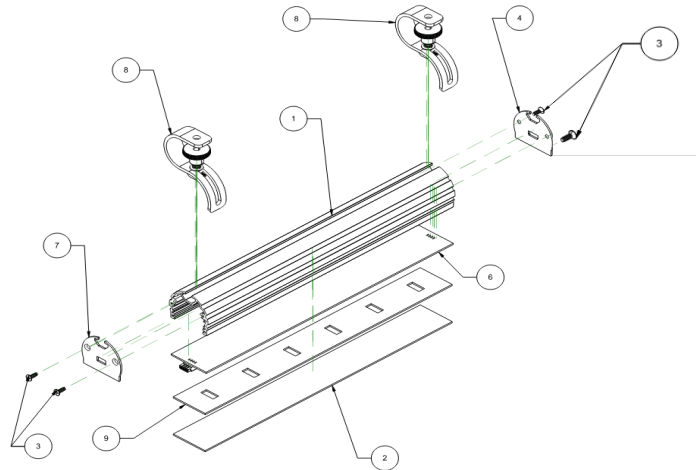

Item Number	Quantity	Part Number	Part Name
1	1	20-1001-01	Method Aluminum Extrusion 1' Length
2	1	29-1001-01	Clear Acrylic Panel- 1' Length
3	4	30-2001-00	Screw, 6-32 x 3/8, Tapfit, Flat, Undercut, PHIL., Black Oxide
4	1	25-1001-03	Male End Cap
6	1	55-1001-00	1' Linear LED PCB Assembly
7	1	25-1002-03	Female End Cap
8	2	00-LRHB-01	Single Hanging Clamp Assembly
9	1	32-100X-00	Shutter Module

Example Part Number

MP-	24-	120-	34-	EB-	DMX-S
Model	Watts	Voltage	Length	Accessories	Control

Bracket Options

Double Bracket
Single Bracket

Method Lighting There is method to our madness.

method-lighting.com
info@method-lighting.com
214-356-1954