



LEVELS RACEWAY
FRIDAY 28th FEBRUARY and SATURDAY 1ST MARCH 2025

END OF SEASON RACE DAY RACE MEETING
STANDARD SUPPLEMENTARY REGULATIONS
PART ONE

1. JURISDICTION:

This event is a Series and Clubmans Race Meeting, promoted by the South Canterbury Car Club Inc at Levels Raceway, Timaru.

The Meeting will be held under these Supplementary Regulations, the MotorSport NZ National Sporting Code and its Appendices and Schedules particularly Appendix Four, Schedule Z being the Standing Regulations for all Race Meetings and Appendix Two, Schedule A – Driver and Vehicle Safety Requirements and where necessary for pre 1978 cars, Schedule K, T&C or Cr compliance with Appendix Six Schedule AA, and the relevant Championship or Accredited Series regulations pertaining to that class.

The MotorSport NZ Permit Number is: **240363**

2. MAJOR OFFICIALS:

2.1 Organisers: South Canterbury Car Club Inc

2.2. Race Secretary: Karen Paddon

2.3 Officials of the Meeting:

Clerk of the Course: Bevin Godfrey

A list of the Officials of the Meeting will be published in Part 2 Supplementary Regulations.

For all enquiries to the event please contact

The South Canterbury Car Club Inc

P.O. Box 4008

TIMARU 7942

Phone: 03 614 7514

E Mail: sccc.secretary@xtra.co.nz

3. VEHICLE REQUIREMENTS:

The Meeting Organisers have scheduled races for the following vehicle classes or types:

Historic Formula Ford

Mini 7

2K Cup South Island

BMW Rennsport

Mazda MX5 Heritage Cup

Classes may be combined.

All classes will practice, qualify and race as per applicable articles and these details will be published in the Race Program which will be issued along with the Part 2 Supplementary Regulations, closer to the event.

4. ENTRIES:

4.1 Entries should be made through the MotorSport Online system (<https://online.motorsport.org.nz>)

Any entry will not be deemed valid until payment is received.

Organisers reserve the right to refuse any entry in accordance with the prescribed provisions of the National Sporting Code.

4.2 Opening and Closing Dates

Entries open with the publication of these regulations and close (at normal fees) on **Monday 17 February 2025** at 4.00p.m.

Entries received after the normal closing date may be subject to a late fee.

4.3 Entry Fees

4.3 (i) Historic Formula Ford, Mini 7, BMW Rennsport, Mazda MX5 Heritage Cup.

Entry fee content	Normal Closing Fee	Late closing fee
Basic fee	\$239.13	\$282.61
MotorSport NZ Participation Levy	\$69.56	\$69.56
Sub Total	\$308.69	\$352.17
GST (No. 11-086-934)	\$46.31	\$52.83
Total Entry Fees	\$355.00	\$405.00

4.3 (ii) 2K Cup S.I

Entry fee content	Normal Closing Fee	Late closing fee
Basic fee	\$239.13	\$282.61
MotorSport NZ Participation Levy	\$50.43	\$50.43
Sub Total	\$289.56	\$333.04
GST (No. 11-086-934)	\$43.44	\$49.96
Total Entry Fees	\$333.00	\$383.00

4.4 Entry Fee refunds policy.

- (1) The Organisers advise that entry fees will only be refunded in full or in part under the following conditions;
- (a) Non-acceptance of entry ----- **Full refund**
 - (b) Cancellation of the Meeting prior to the commencement of documentation ---- **Full refund.**
 - (c) Withdrawal in writing prior to the close of normal entries ---- **Full Refund.**
 - (d) Withdrawals after normal entry closing but before the start time listed for documentation ---- **75% entry refund, (25% covers tickets and administration costs).**
- (2) The Organisers confirm that entry fees will not be refunded for;
- (a) Withdrawals or failure of a competitor to advise of non-appearance at the meeting after the commencement of documentation, or
 - (b) Abandonment or cancellation of the meeting after the commencement of documentation.

5. COMPETITOR REQUIREMENTS & UNDERSTANDING:

5.1 Licence Requirements

The driver must hold as a minimum a C1 Grade Competition Licence.

If the Entrant is other than a driver, an Entrants licence in the name of the Entrant is required.

Note Under the provisions of the Trans-Tasman Visa Agreement between Motorsport Australia and MotorSport New Zealand Inc, Australian competitors holding both Motorsport Australia general competition licences and Tasman Visas may enter any of the New Zealand Race Championships and be eligible for awards.

5.2 New Drivers

Any driver(s) who are racing at one of their first three (3) race events or who have not previously competed at the circuit or who is racing for the first time after a period of 2 years or more must indicate the fact on the entry form and attend the New Competitors Briefing session. The time and place for this briefing will be detailed in Part Two of these regulations.

5.3 Competitor understanding

In signing the entry forms competitors (Entrant and Drivers) are deemed to fully understand the MotorSport NZ National Sporting Code and its relevant Appendices and Schedules.

In particular:

- The National Sporting Code Articles pertaining to protests and competitors' obligations, and
- Schedule Z articles detailing Flag signals and Code of Conduct.

6. DOCUMENTATION & SCRUTINEERING AUDIT INSPECTION:

6.1 Documentation

Will take place at the Race Secretary's office, Levels Raceway, Timaru on Friday 28th February 2025 between 9.00am and 4.00pm and again on Saturday 1st March 2025 between 7.30a.m. and 9.00a.m.

6.2 Scrutineering Audit Inspection

Will take place at the Race Secretary's office, Levels Raceway, Timaru on Friday 28th February 2025 between 9.00am and 4.00pm and again on Saturday 1st March 2025 between 7.30a.m. and 9.00a.m.

7. POSTPONEMENT CANCELLATION ABANDONMENT & ORGANISERS' RIGHTS:

Pursuant to national Sporting Code Article 13, the organisers advise that if less than **50** entries are received by the entry closing date the meeting may be postponed or cancelled.

Should there be less than **15** entries received for any of the classes proposed in Article 3 of these Supplementary Regulations by the entry closing date, the organisers reserve the right to cancel that class or amalgamate it with another class at their sole discretion.

8. CIRCUIT DESCRIPTION:

The circuit to be used will be Circuit One as depicted on schedule one of the Motorsport New Zealand Inc Circuit licence.

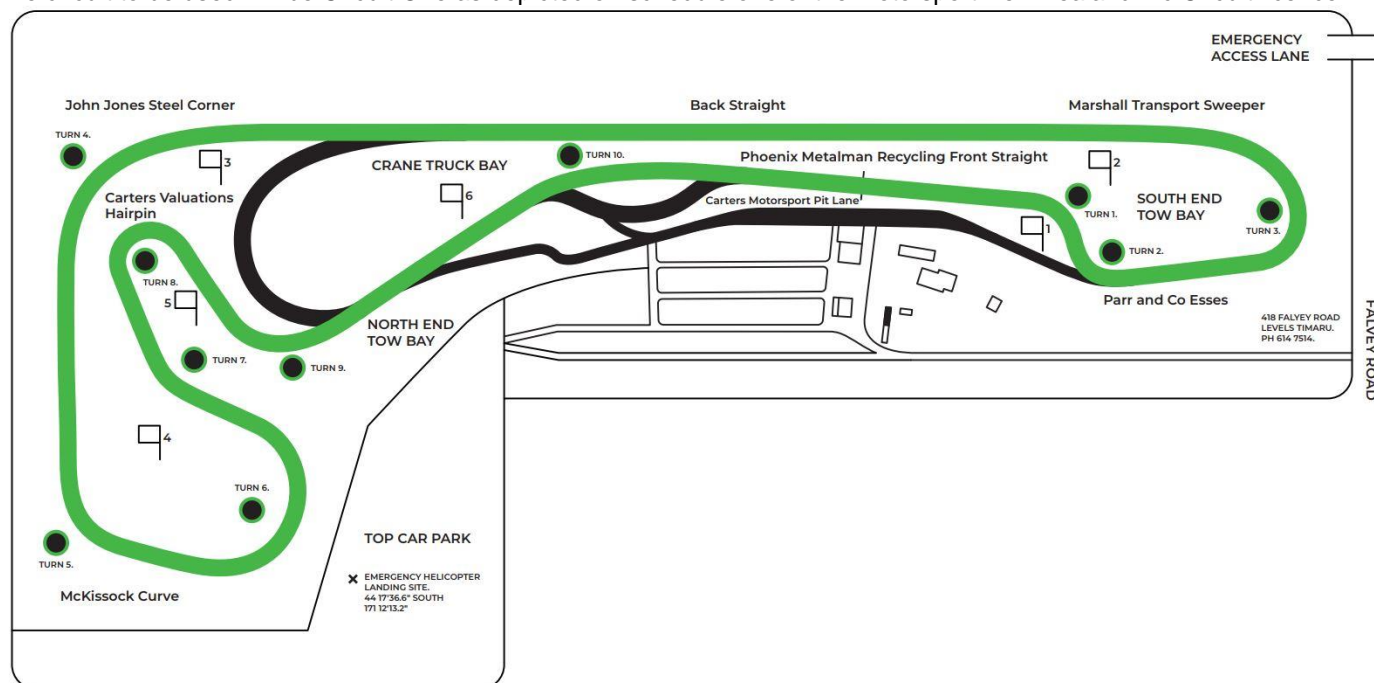

9. FLAG SIGNAL LIGHT SYSTEM:

As per Appendix Four Schedule Z art 14 of the Motorsport NZ Manual, Drivers will be signalled by a Motorsport NZ approved signal light system, at the Circuit's six Flag points. Should an issue or fault with the signal light system develop, signalling to Drivers will revert to flags. Levels Raceway is also equipped with an Alitrax Circuit Control MegaViz Screen. This screen will be used at the Start/Finish Line in-conjunction with the Start Lights. It will be used to communicate messages, penalties and warnings to Drivers.

10. NOISE LIMIT:

MAXIMUM PERMITTED NOISE LEVEL

The maximum permitted noise level is 95db(A). Appendix 2 Schedule A, 3.8 Noise levels NZ MotorSport Manual. It is the policy of the South Canterbury Car Club Inc to Black Flag off the circuit any competition vehicle exceeding this level. These vehicles may not resume competition until such time as repairs are carried out to the satisfaction of the appropriate official. Any further breach of the noise level will result in the competition vehicle being penalised further and excluded from the Meeting. The Clerk of Course will be Judge of Fact in these matters.

The running of competition engines is PROHIBITED outside the hours of before 8-00a.m. and after 6-00p.m.

The South Canterbury Car Club Inc stipulates that competitors are not to drive competition vehicles outside the pit proper or race circuit proper for any form of testing activity once the meeting has commenced. Competitors and or their teams found to be doing so will be penalised.

11. FUEL HANDLING & STORAGE:

Competitors are reminded that they are required to be familiar with the MotorSport New Zealand Code of Practice – Fuel. It is the Competitors responsibility to meet all requirements whilst at the circuit, in particular but not limited to,

- compliance with fuel quantities,
- availability of and size of fire extinguishers,
- correct labelling of fuel containers,
- correct refueling practices.

The Clerk of the Course and/or his nominated delegate may carry out random inspections at any time during a meeting.

Details are available on the MotorSport New Zealand website.

The Club has available for 'storage only' a bunded secure container, for Competitors to use.

12. LOCATION OF PARC FERME AND MEASURING PAD:

Parc ferme is located directly behind the Control Tower Building. The Measuring pad area is located on the north side of the Technical Centre. Access to this area is through consultation with the Scrutineers.

13. LOCATION OF OFFICIAL NOTICEBOARD:

The official noticeboard is in the Race Secretary's office.

14. MAXIMUM NUMBER OF STARTERS:

The maximum number of starters in a race will be 38 Saloons, or 30 Single Seaters on Circuit 1.

15. TIMEKEEPING:

All classes will be electronically timed using the South Canterbury Car Club's MyLaps X2 Timing System.

For those competitors who do not own their own AMB Tx260 transponder, a limited supply of hire units are available from the Race Secretary's office for \$40.00. This charge is additional to the Entry Fee.

Any competitor who has their own Tx260 transponder but who fails to advise their transponder number in the appropriate box on the event entry form will be allocated a hire transponder and hire fees charged.

Operational Tx260 transponders must be fitted for all testing, qualifying sessions, and races.

All competitors need to be aware that if there is high demand on the club's hire transponders, then it may be necessary for the club to also allocate that transponder to another competitor from a different class/register. In this instance the club will provide the personnel to retrieve the transponder from one vehicle and assist placing it on the other and so on throughout the event.

16. DRIVE THROUGH PENALTIES:

Appendix Four, Schedule Z article 13.10. The time penalty commensurate with a Drive Through Penalty shall be 30 seconds.

GENERAL INFORMATION

A. Circuit Hire - Testing

The circuit is available for private hire by contacting Karen Paddon (phone 03 614 7514) for a schedule of dates, hire conditions and applicable fees. This information is also available at www.southcanterburycarclub.org.nz

In support of this meeting testing practice sessions have been organised for **Friday 28th February 2025** from 9.00am until 4.00pm. All competitors who wish to avail themselves of this opportunity must report to the Administration Office to sign the terms and conditions testing indemnity form and pay the \$75.00 fee **before** using the circuit.

B. Programme of Events

Will be sent out with the Part 2 Supplementary Regulations-Acceptance of Entry.